

Stepping Motors

M10LS-2N

OUTLINE

Developed as a model with 10-mm external diameter, high-torque, and low detent torque characteristics.

As an application, it is suitable for disc drive thread uses and digital movie camera zoom focus.

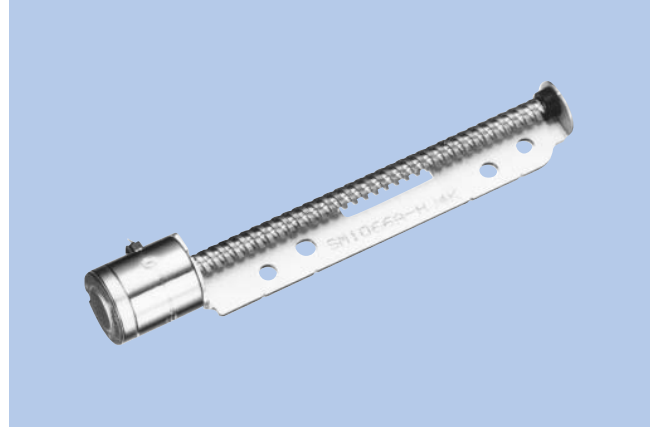

FEATURES

1. Small size, high output.
2. Low detent
3. High linearity
4. Step angle 18°

USES

1. For disk drives (half height) pick feed.
2. For digital still cameras zoom focus.

SPECIFICATIONS

Items	M10LS-2N
Rated Voltage	DC 6.5V
Working Voltage	3~8V
Rated Current/Phase	450mA
No. of Phase	2 Phase
Coil DC Resistance	13.5
Step Angle	18°/step
Excitation Method	2-2 Phase excitation
Insulation Class	Class E insulation
Holding Torque	1.95mN·m
Pull-out Torque	0.7mN·m/1800pps
Pull-in Torque	1.3mN·m/400pps
Max. Pull-out Pulse Rate	2900pps
Max. Pull-in Pulse Rate	1050pps

CHARACTERISTICS

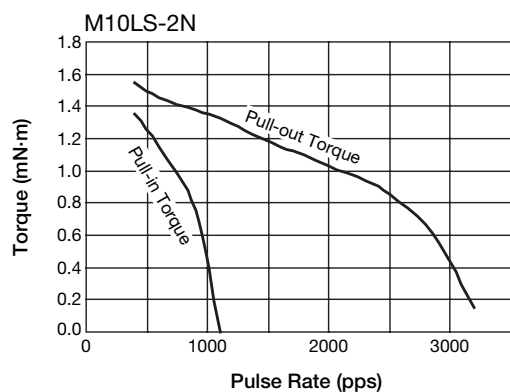

DIMENSIONS

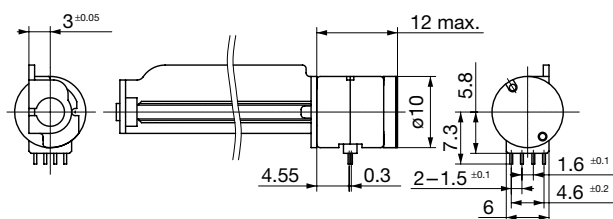

Unit : mm, General tolerance : ±0.5