

BAW M18MG-UAC16F-S04G-K
Inductive Distance Sensors

4...16 mm
0...10 V

BALLUFF
sensors worldwide

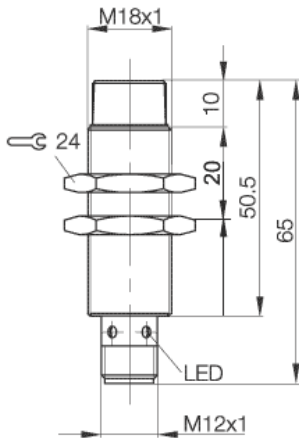

P1592

Electrical data:

Connection	connector
Rated operational voltage DC	24 V
Rated insulation voltage (Ui)	250 AC
Electrical type	DC
No-load supply current I _o at I _e	10 mA
Supply voltage ripple	15 %
Switching element function	0...10 V
Supply voltage max. (U _b)	30 V
Supply voltage min. (U _b)	15 V
Output voltage s _I max	10 V
Output voltage s _I min	0 V
Cutoff frequency (-3dB output amplitude)	500 Hz
Load resistance min (R _L)	2000 Ohm
Output voltage at se	5 V
Load resistance min (R _L)	2000 Ohm
Temperature compensation	yes
UTemp typ at 25 °C	3.3 V
Linear range max (s _I)	16 mm
Linear range min (s _I)	4 mm
Non-linearity	±360 µm
Output signal	0...10 V

General data:

Supply voltage indicator	no
Degree of protection IP	IP 67
Insulation class	2
Polarity reversal resistant	yes
Protected against reversal	yes

Mechanical data:

Midpoint of linear range (se)	10 mm
Connection type	M12x1-S04
Mounting	non flush mountable
Surface treatment	nickel plated
Ambient temperature max (T _a)	60 °C
Ambient temperature min (T _a)	10 °C
Sensing face material	PBT
Housing material	CuZn
Repeatability	3 %
Working area max (s _a)	16 mm
Working area min (s _a)	4 mm
Measurement velocity	5 m/s
Opt. working temperature max.	50 °C
Opt. working temperature min.	10 °C
Temperature coefficient max.	30,0 µm/K
Temperature coefficient min.	1,0 µm/K
Temperature coefficient typ.	8,0 µm/K
Temp. drift typ.	-9 mV/K
Repeat accuracy	±200,0 µm
Adjustment indicator	yes
Working range	4...16 mm

Wiring:

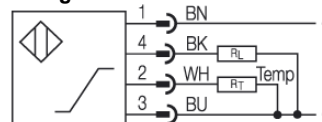

Pinout:



www.balluff.com

Balluff Europe: +49 7158 173 -0
Balluff USA: 1-800-54 3-83 90
Balluff Asia: +86 21-50 64 41 31

Online Productinformation
2008-09-11