

V _{RSM} V _{RRM} V	I _D (T _{case} = ...)			
	17 A = (75 °C)		20 A (73 °C)	
	Types	R _{min} Ω	Types	R _{min} Ω
100	SKB 25/01	0,1	–	–
200	SKB 25/02	0,15	SKD 25/02	0,15
400	SKB 25/04	0,3	SKD 25/04	0,3
600	SKB 25/06	0,5	–	–
800	SKB 25/08	0,7	SKD 25/08	0,7
1200	SKB 25/12	1	SKD 25/12	1
1400	SKB 25/14	1,2	SKD 25/14	1,2
1600	SKB 25/16	1,5	SKD 25/16	1,5

Power Bridge Rectifiers

SKB 25 SKD 25

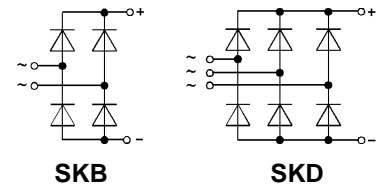
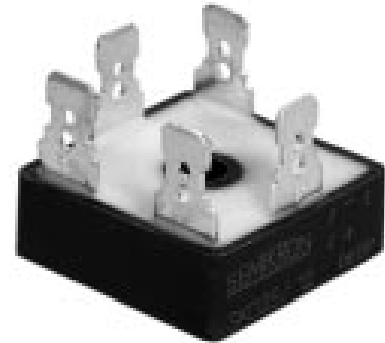

Symbol	Conditions	SKB 25	SKD 25	Units
I _D	T _{amb} = 45 °C; isolated ¹⁾ chassis ²⁾ R4A/120 P1A/120	3,5	3,5	A
		10	12	A
		14	15	A
		17	20	A
I _{DCL}	T _{amb} = 45 °C; isolated ¹⁾ chassis ²⁾ R4A/120 P1A/120	3	3,5	A
		9,5	12	A
		12	15	A
		14	20	A
I _{FSM}	T _{vj} = 25 °C, 10 ms	370		A
i ² t	T _{vj} = 150 °C, 10 ms	320		A
	T _{vj} = 25 °C, 8,3...10 ms	680		A ² s
V _F	T _{vj} = 25 °C; I _F = 150 A	2,2		V
		0,85		V
V _(TO)	T _{vj} = 150 °C			V
r _T	T _{vj} = 150 °C	12		mΩ
I _{RD}	T _{vj} = 25 °C; V _{RD} = V _{RRM}	0,3		mA
		5		mA
t _{rr}	T _{vj} = 25 °C	typ. 10		μs
f _G		2000		Hz
R _{thjc}	total	2	1,75	°C/W
R _{thch}	total	0,15		°C/W
R _{thja}	isolated ¹⁾	15		°C/W
	chassis ²⁾	4,7		°C/W
	R4A/120	3,6		°C/W
	P1A/120	2,75		°C/W
T _{vj}		– 40...+ 150		°C
T _{stg}		– 55...+ 150		°C
V _{isol}	a.c. 50...60 Hz; r.m.s.; 1 s/ 1 min	3000 / 2500		V~
RC	P _R = 1 W	50		Ω
		0,1		μF
		20		A
F _u		2 ± 15 %		Nm
M ₁	to heatsink	SI units		Nm
		US units	18 ± 15 %	lb. in.
w		24	26	g
Case		G 10	G 11	

Features

- Square plastic case with isolated metal base plate and fast-on connectors
- Blocking voltage to 1600 V
- High surge currents
- **SKB** = single phase bridge rectifier
- **SKD** = three phase bridge rectifier
- Easy chassis mounting
- UL recognized, file no. E 63 532

Typical Applications

- Single and three phase rectifiers for power supplies
- Input rectifiers for variable frequency drives
- Rectifiers for DC motor field supplies
- Battery charger rectifiers

¹⁾ Freely suspended or mounted on an insulator

²⁾ Mounted on a painted metal sheet of min. 250 x 250 x 1 mm

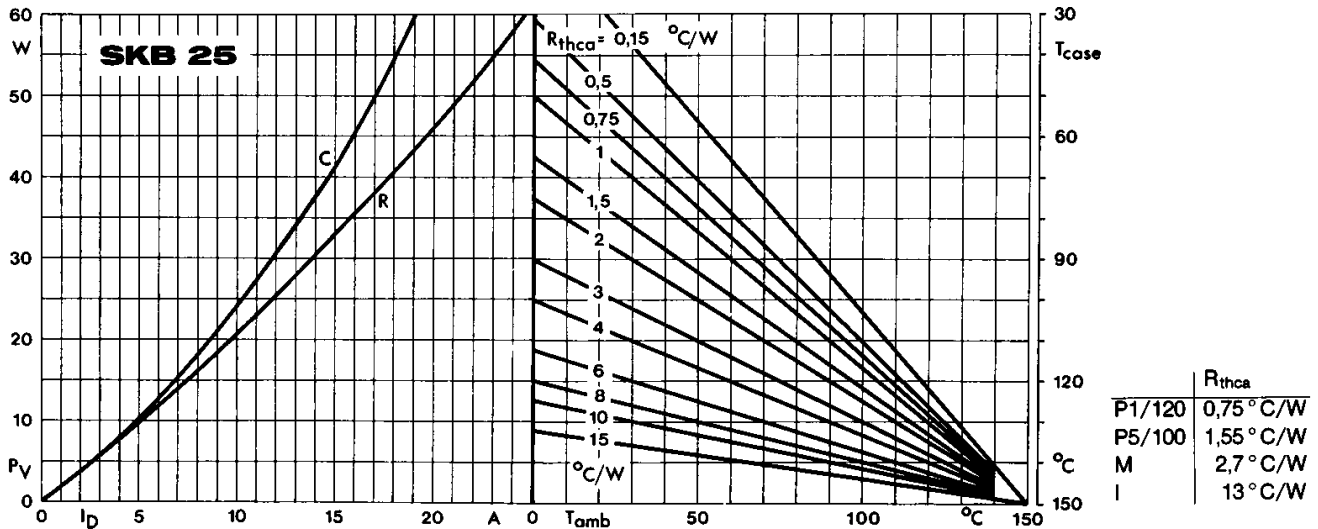

Fig. 3 a Power dissipation vs. output current and case temperature

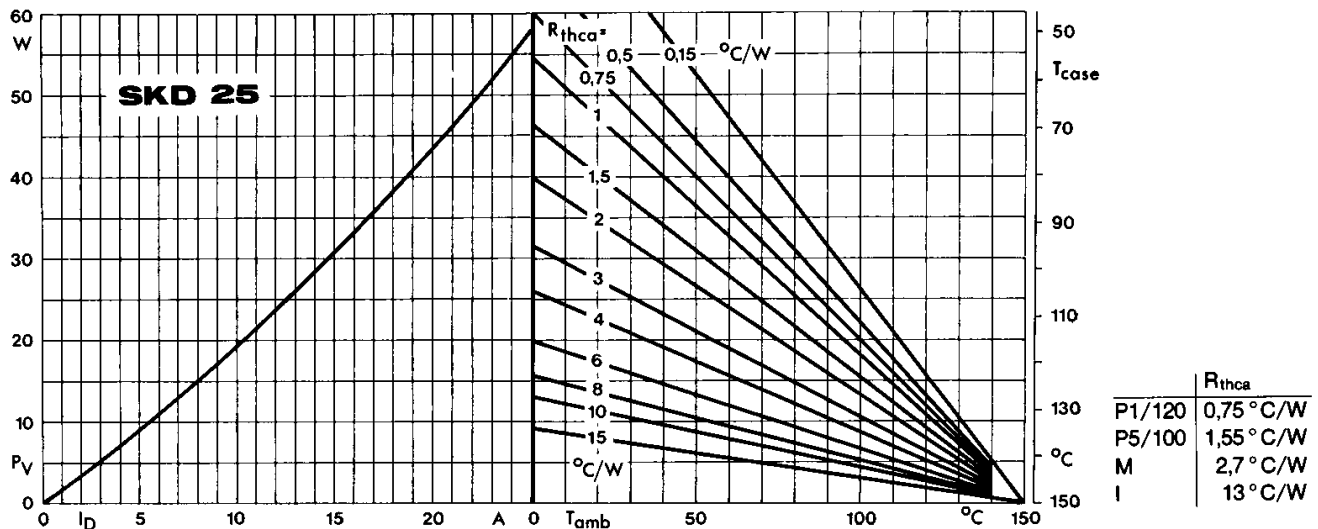

Fig. 3 b Power dissipation vs. output current and case temperature

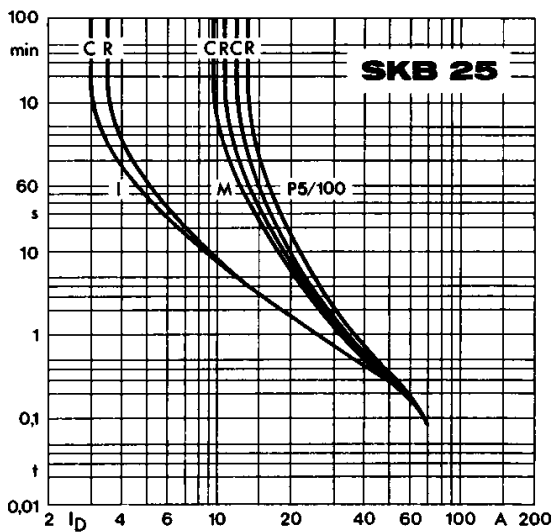

Fig. 6 a Rated overload current vs. time

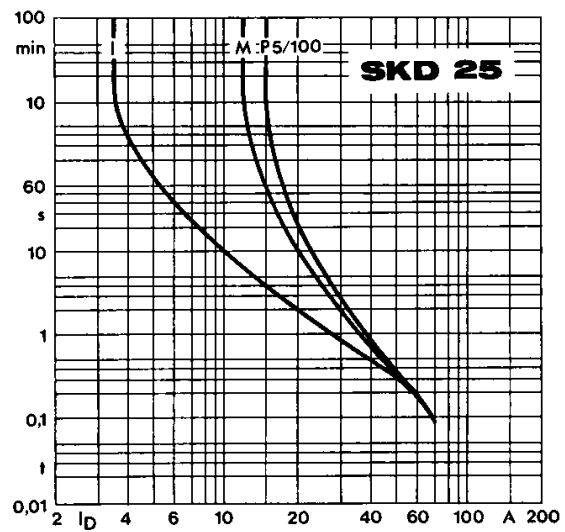

Fig. 6 b Rated overload current vs. time

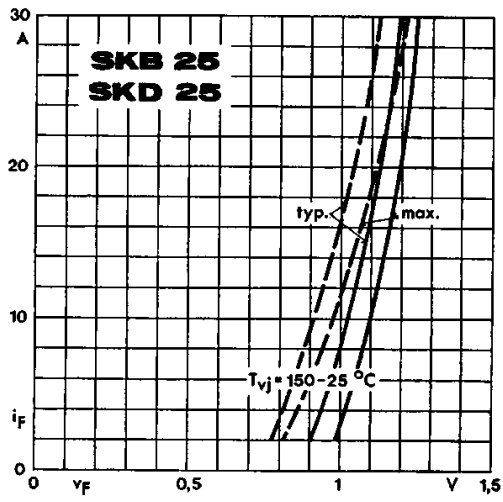
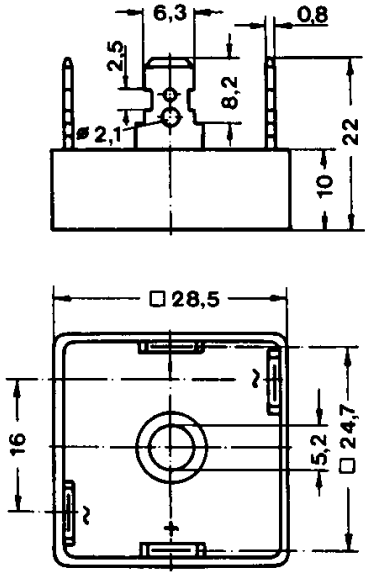

Fig. 9 Forward characteristics of a single diode

SKB 25
Case G 10



SKD 25
Case G 11

