

Silicon PNP Power Transistors

2SB1192

DESCRIPTION

- With TO-220Fa package
- High  $V_{CEO}$
- Large  $P_C$
- Complement to type 2SD1770

APPLICATIONS

- Power amplifier
- TV vertical deflection output

PINNING

PIN	DESCRIPTION
1	Emitter
2	Collector
3	Base

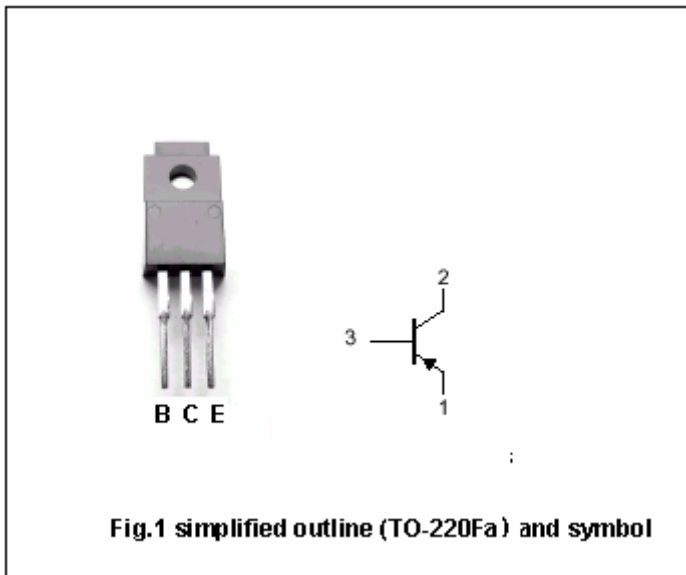

Absolute maximum ratings( $T_a=25^\circ\text{C}$ )

SYMBOL	PARAMETER	CONDITIONS	VALUE	UNIT
$V_{CBO}$	Collector-base voltage	Open emitter	-200	V
$V_{CEO}$	Collector-emitter voltage	Open base	-150	V
$V_{EBO}$	Emitter-base voltage	Open collector	-6	V
$I_C$	Collector current		-1	A
$I_{CM}$	Collector current-peak		-2	A
$P_C$	Collector power dissipation	$T_a=25^\circ\text{C}$	2	W
		$T_C=25^\circ\text{C}$	25	
$T_j$	Junction temperature		150	$^\circ\text{C}$
$T_{stg}$	Storage temperature		-55~150	$^\circ\text{C}$

## Silicon PNP Power Transistors

2SB1192

## CHARACTERISTICS

T<sub>j</sub>=25 °C unless otherwise specified

SYMBOL	PARAMETER	CONDITIONS	MIN	TYP.	MAX	UNIT
V <sub>(BR)CEO</sub>	Collector-emitter breakdown voltage	I <sub>C</sub> =-5mA, I <sub>B</sub> =0	-150			V
V <sub>(BR)EBO</sub>	Emitter-base breakdown voltage	I <sub>E</sub> =-0.5mA, I <sub>C</sub> =0	-6			V
V <sub>CEsat</sub>	Collector-emitter saturation voltage	I <sub>C</sub> =-500mA; I <sub>B</sub> =-50mA			-1.0	V
V <sub>BE</sub>	Base-emitter on voltage	I <sub>C</sub> =-300mA; V <sub>CE</sub> =-10V			-1.0	V
I <sub>CBO</sub>	Collector cut-off current	V <sub>CB</sub> =-200V; I <sub>E</sub> =0			-50	μA
I <sub>EBO</sub>	Emitter cut-off current	V <sub>EB</sub> =-4V; I <sub>C</sub> =0			-50	μA
h <sub>FE-1</sub>	DC current gain	I <sub>C</sub> =-100mA; V <sub>CE</sub> =-10V	60		240	
h <sub>FE-2</sub>	DC current gain	I <sub>C</sub> =-300mA; V <sub>CE</sub> =-10V	50			
C <sub>OB</sub>	Output capacitance	I <sub>E</sub> =0; V <sub>CB</sub> =-10V, f=1MHz		35		pF
f <sub>T</sub>	Transition frequency	I <sub>C</sub> =-100mA; V <sub>CE</sub> =-10V		20		MHz

◆ h<sub>FE-1</sub> Classifications

Q	P
60-140	100-240

Silicon PNP Power Transistors

2SB1192

PACKAGE OUTLINE

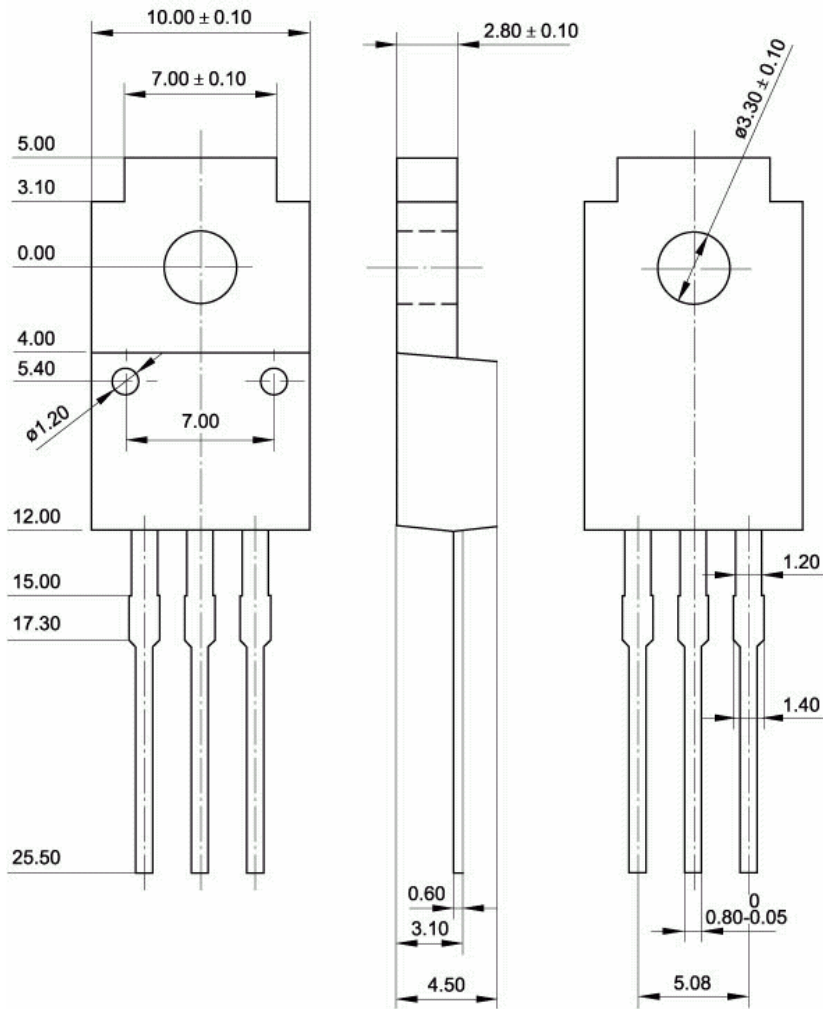

Fig.2 Outline dimensions(unindicated tolerance: $\pm 0.15$  mm)