

# KS SERIES KEY SWITCHES

*New!*

## FEATURES

- Single pole single throw momentary action.
- Excellent tactile feed-back (Snap dome).
- Compact size.
- Long operating life for high reliability.
- Available in choice of 7 cosmetic colors.
- Textured actuator surface for non-slip operation.
- Molded-in terminals minimize wicking of flux or solder.

## MATERIALS

Base: ABS 777, color white.  
 Actuator: Polycarbonate, 7 optional colors  
 (see model tabulations).  
 Terminals: Silver plated brass.  
 Shorting Contact: Silver plated phosphor bronze.

SPECIFICATIONS SUBJECT TO CHANGE WITHOUT NOTICE.

## GENERAL SPECIFICATIONS

### ELECTRICALS

Contact rating: 10 mA @ 35 VDC  
 Insulation resistance: 100 megohms min. (500 VDC)  
 Dielectric withstanding voltage: 500 VAC for 1 minute  
 Contact resistance: < 20 milliohms  
 Electrical life: 100,000 cycles min.  
 Contact bounce: less than 10 msec.

### MECHANICALS, THERMALS

Plunger travel: .031" (0.8mm)  
 Actuation force: 130 grams ± 30 grams  
 Operating temperature range: -20°C to +65°C

### SOLDERING

Wave or hand soldering: 235°C max. for 5 seconds max..  
 Solvent washing: Non-washable.

## KSL

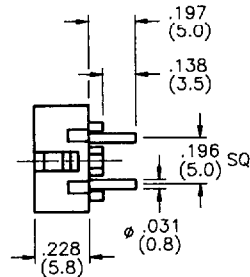
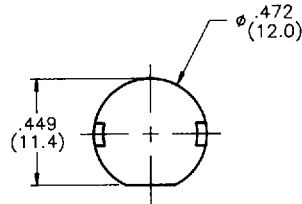

Model No.	Actuator Color
KSL1	Blue
KSL2	Black
KSL3	Green
KSL4	Gray
KSL5	Yellow
KSL6	Red
KSL8	White

## KSP

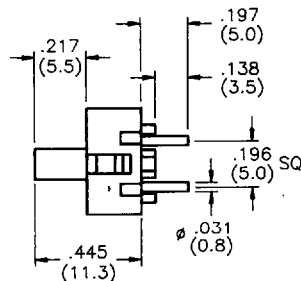
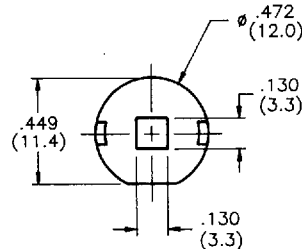

Model No.	Actuator Color
KSP1	Blue
KSP2	Black
KSP3	Green
KSP4	Gray
KSP5	Yellow
KSP6	Red
KSP8	White

SPECIFICATIONS SUBJECT TO CHANGE WITHOUT NOTICE.

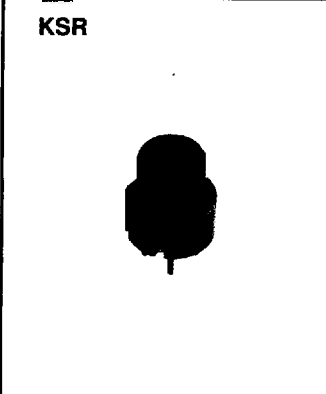

**KSR**

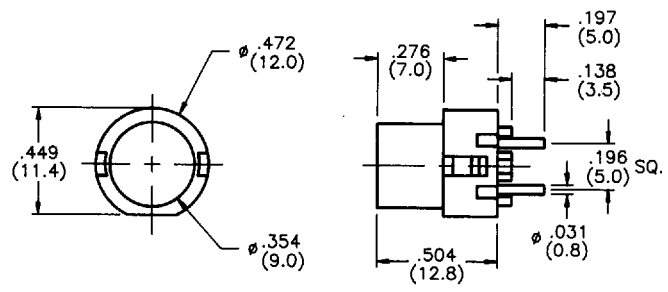

Model No.	Actuator Color
KSR1	Blue
KSR2	Black
KSR3	Green
KSR4	Gray
KSR5	Yellow
KSR6	Red
KSR8	White

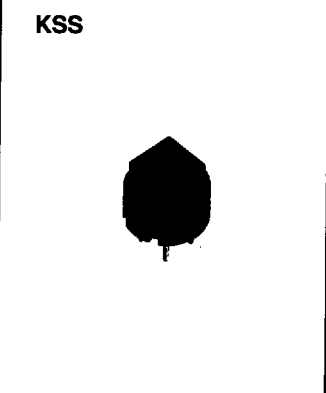

**KSS**

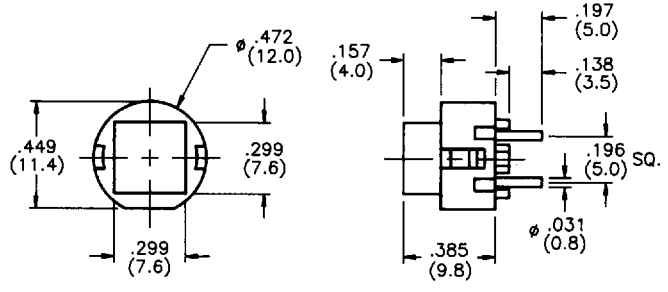

Model No.	Actuator Color
KSS1	Blue
KSS2	Black
KSS3	Green
KSS4	Gray
KSS5	Yellow
KSS6	Red
KSS8	White

**SCHEMATIC (ALL MODELS)**

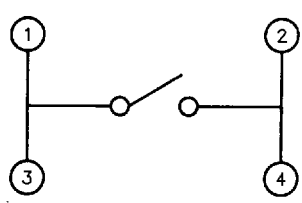

**PRINTED CIRCUIT BOARD LAYOUT (ALL MODELS)**

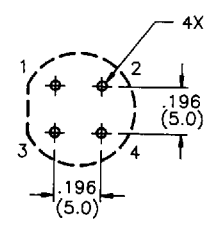

Tolerances:  
Linear,  $\pm .004$   
Holes,  $+.004/- .000$

**KEY SWITCH CAPS**  
Material: ABS thermoplastic

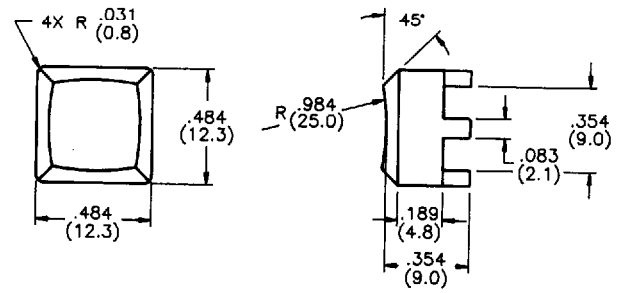
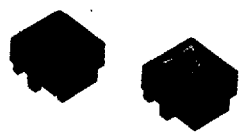

Caps are supplied without marking.  
Consult factory for custom marking requirements.

Model No.	Cap Color
K1	Blue
K2	Black
K3	Green
K4	Gray
K5	Yellow
K6	Red
K8	White

(Fits KSL & KSS models only)