

The FSLU2520 Series is a ferrite core wirewound surface mount chip inductor which conforms to the EIA standard 1008 footprint. Its proprietary welded termination architecture offers superior reliability and high heat-resistance for flow and reflow soldering capability. It is recommended for general signal conditioning, RF or IF filtering applications, or as matching elements.

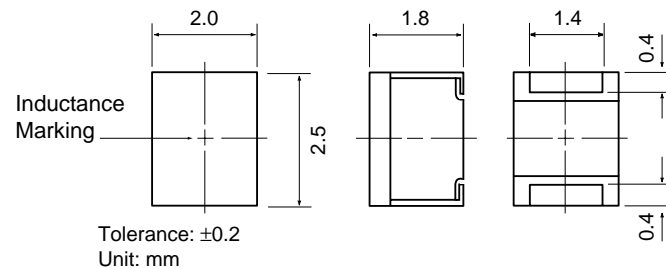

Features

- Inductance Range: 0.010 μ H ~ 0.082 μ H
- Temperature Range: -40° C to $+85^{\circ}$ C
- Typical max Q: 40 ~ 50
- Proprietary wire-wound structure with welded terminations offers high reliability
- Superior solderability and high heat-resistance for flow and reflow soldering
- Miniature size: 1008 footprint (2.0mm x 2.5mm)
- S-parameter data available upon request
- Packaged on tape and reel in 2,000 piece quantity

Q-Frequency Characteristics

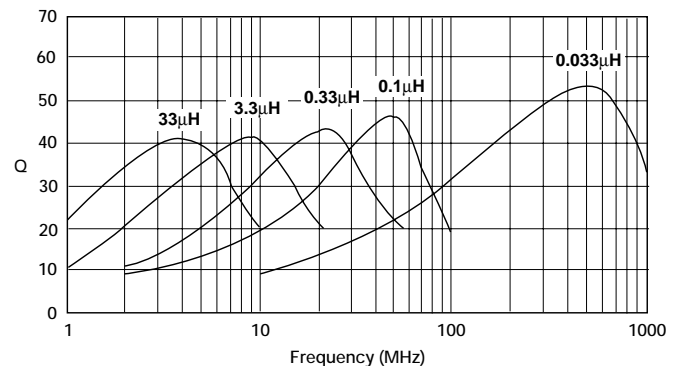

Part Numbering

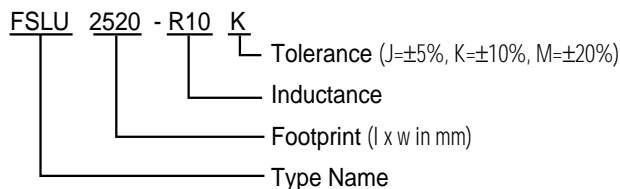

Recommended patterns:

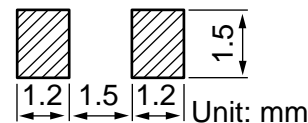

STANDARD PARTS SELECTION GUIDE

TYPE FSLU2520

| TOKO Part Number | Lo (μ H) | Inductance Tolerance * | Q Min. | Test Frequency (MHz) | DC Resistance (Ω) Max. | Rated DC Current (mA) Max | Self Resonant Frequency (MHz) Min. |
|------------------|---------------|------------------------|--------|----------------------|---------------------------------|---------------------------|------------------------------------|
| FSLU2520-10N_* | 0.010 | M, K | 15 | 100 | 0.15 | 730 | 2300 |
| FSLU2520-12N_* | 0.012 | M, K | 15 | 100 | 0.17 | 690 | 2100 |
| FSLU2520-15N_* | 0.015 | M, K | 15 | 100 | 0.19 | 660 | 2000 |
| FSLU2520-18N_* | 0.018 | M, K | 15 | 100 | 0.20 | 600 | 1750 |
| FSLU2520-22N_* | 0.022 | M, K | 15 | 100 | 0.21 | 550 | 1550 |
| FSLU2520-27N_* | 0.027 | M, K | 15 | 100 | 0.25 | 520 | 1400 |
| FSLU2520-33N_* | 0.033 | M, K | 20 | 100 | 0.29 | 480 | 1200 |
| FSLU2520-39N_* | 0.039 | M, K | 20 | 100 | 0.32 | 460 | 1100 |
| FSLU2520-47N_* | 0.047 | M, K | 20 | 100 | 0.34 | 440 | 1000 |
| FSLU2520-56N_* | 0.056 | M, K | 20 | 100 | 0.37 | 420 | 900 |
| FSLU2520-68N_* | 0.068 | M, K | 20 | 100 | 0.41 | 400 | 850 |
| FSLU2520-82N_* | 0.082 | M, K | 20 | 100 | 0.42 | 390 | 700 |

* Add tolerance to part number: K = $\pm 10\%$, M = $\pm 20\%$

Note: Add **P2** to part number for tape and reel.