

LED – Light Emitting Diode

Module No.: W10351RHD-O

Features:

Ø10mm
 RED
 Diffuse
 High Bright
 PIN=26mm

Dimensions

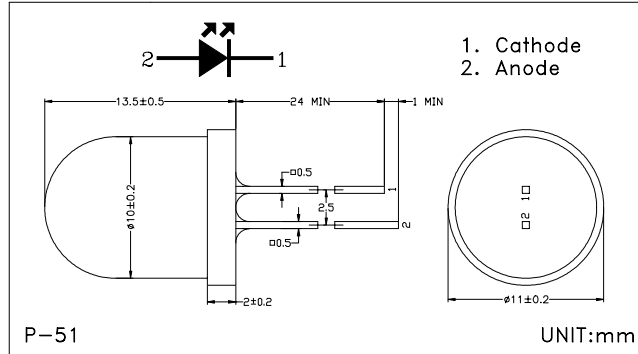

Absolute Maximum Ratings

(Ta=25°C)

| Descriptions | Symbol | Value | Unit |
|----------------------------|--------|-----------|------|
| Continuous Forward Current | IF | 30 | mA |
| Peak Forward Current *1 | IFM | 35 | mA |
| Reverse Voltage | VR | 5 | V |
| Operating Temperature | Topr | -25 ~ +65 | °C |
| Storage Temperature | Tstg | -25 ~ +85 | °C |
| Soldering Temperature *2 | Tsol | 260 | °C |

*1 Duty ratio = 1/10, Pulse width = 0.1ms.

*2 At the position of 2mm from the bottom face of resin package within 5 sec.

Electro-optical Characteristics

(Ta=25°C)

| Descriptions | Symbol | Conditions | Min. | Typ. | Max. | Unit |
|------------------------------|-----------------|----------------------|------|------|------|------|
| Forward Voltage | V _{F1} | I _F =10μA | 1.5 | 1.6 | | V |
| | V _{F2} | I _F =20mA | | 2.0 | 2.8 | V |
| Luminous Intensity *3 | I _v | I _F =20mA | 150 | 320 | | mcd |
| Peak Emission Wavelength | λ _p | I _F =20mA | | 635 | | nm |
| Spectrum Radiation Bandwidth | Δλ | I _F =20mA | | 45 | | nm |
| Half Power Beam Angle | Δθ | | | ±30 | | deg. |
| Terminal Capacitance | C _t | | | 25 | | pF |
| Response Frequency | f _c | | | 8 | | MHz |

*3 Tolerance: ± 30%

Luminous Intensity vs
Forward Current

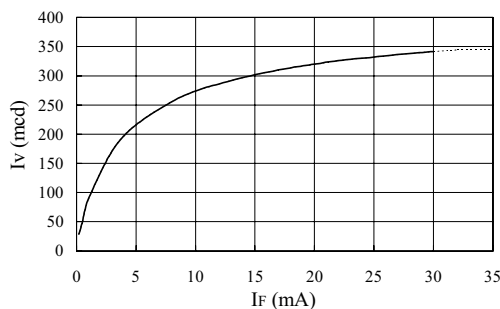

Radiation Diagram

