



EVERLIGHT ELECTRONICS CO.,LTD.

Device Number : CDAE-021-013 REV: 1

MODEL NO : A214B/G/S746 ECN : _____ Page: 1/7

■ Package Dimensionas:

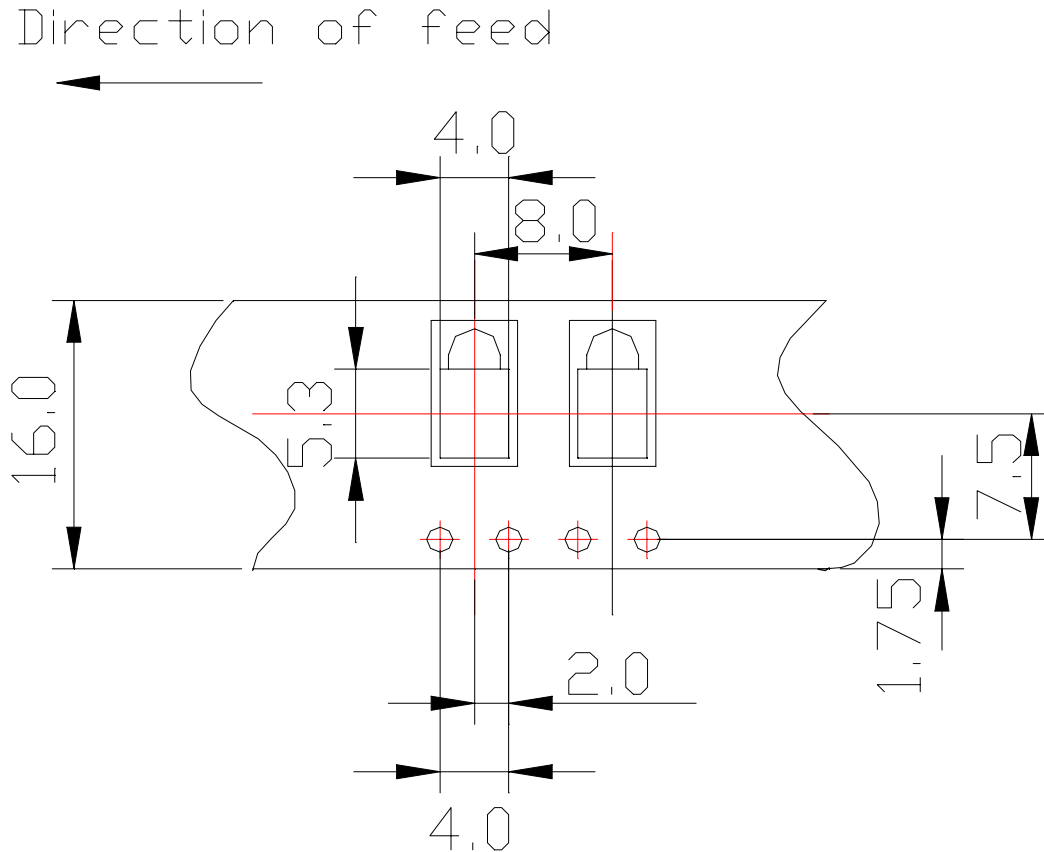

■ Notes:

- 1.All dimensions are in millimeters, tolerance is 0.25mm except be specified
- 2.Lead spacing is measured where the lead emerge from the package

LED PART NO	CHIP		Lens Color
	Material	Emitted Color	
234-10UGD	GaP	Super Green	Green Diffused

Office : 7C Building, Lian Hua Port Industrial District, Lian Hua Shan
 Bonded Pricessing Zone Pan Yu, Guang Zhou, China

TEL : (020)84860913,84860914

FAX : (020)84860600

http : //www.everlight.com

T00098,B89030518



EVERLIGHT ELECTRONICS CO.,LTD.

Device Number : CDAE-021-013 REV: 1

MODEL NO : A214B/G/S746 ECN : _____ Page: 2/7

■ Package Dimensionas:

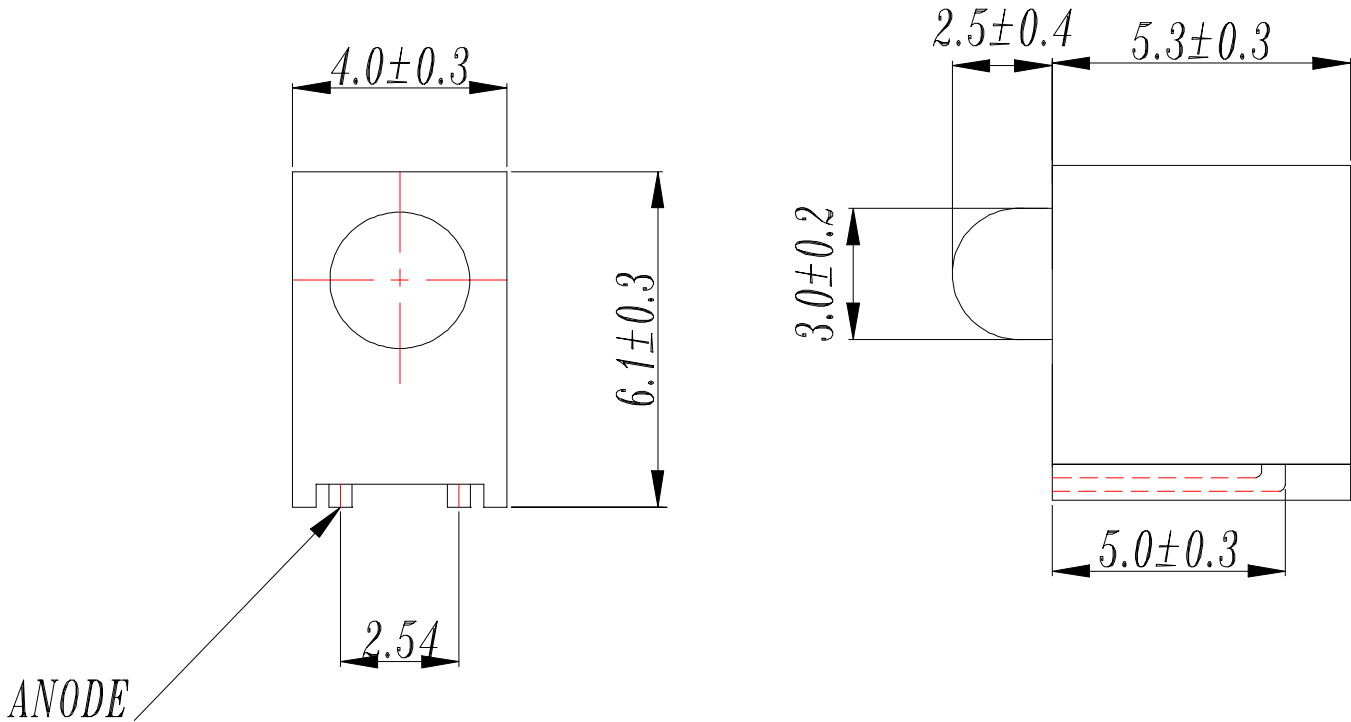

■ Notes:

- 1.All dimensions are in millimeters, tolerance is 0.25mm except be specified
- 2.Lead spacing is measured where the lead emerge from the package

LED PART NO	CHIP		Lens Color
	Material	Emitted Color	
234-10UGD	GaP	Super Green	Green Diffused

Office : 7C Building, Lian Hua Port Industrial District, Lian Hua Shan
 Bonded Pricessing Zone Pan Yu, Guang Zhou, China

TEL : (020)84860913,84860914

FAX : (020)84860600

http : //www.everlight.com

T00098,B89030518



■ Descriptions:

- 1.ARRAY=Plastic Holder+Combinations of Lamp
- 2.The array will easily mount the applicable lamps on any panel up to

■ Features:

- 1.Low power consumption
- 2.High efficiency and low cost
- 3.Good control and free combinations on the colors of LED lamps
- 5.Good lock and easy to assembly
- 6.Stackable and easy to assembly
- 7.Stackable vertically and easy to assembly
- 8.Versatile mounting on P.C board or panel
- 9.Stackable horizontally and easy to assembly

■ Applications:

- 1.Used as indicators of indicating the Degree, Functions, Positions etc, in electronic instruments.



EVERLIGHT ELECTRONICS CO.,LTD.

Device Number : CDAE-021-013 REV: 1

MODEL NO : A214B/G/S746 ECN : _____ Page: 4/7

■ LED LAMP ARRAYS SELECTION GUIDE:

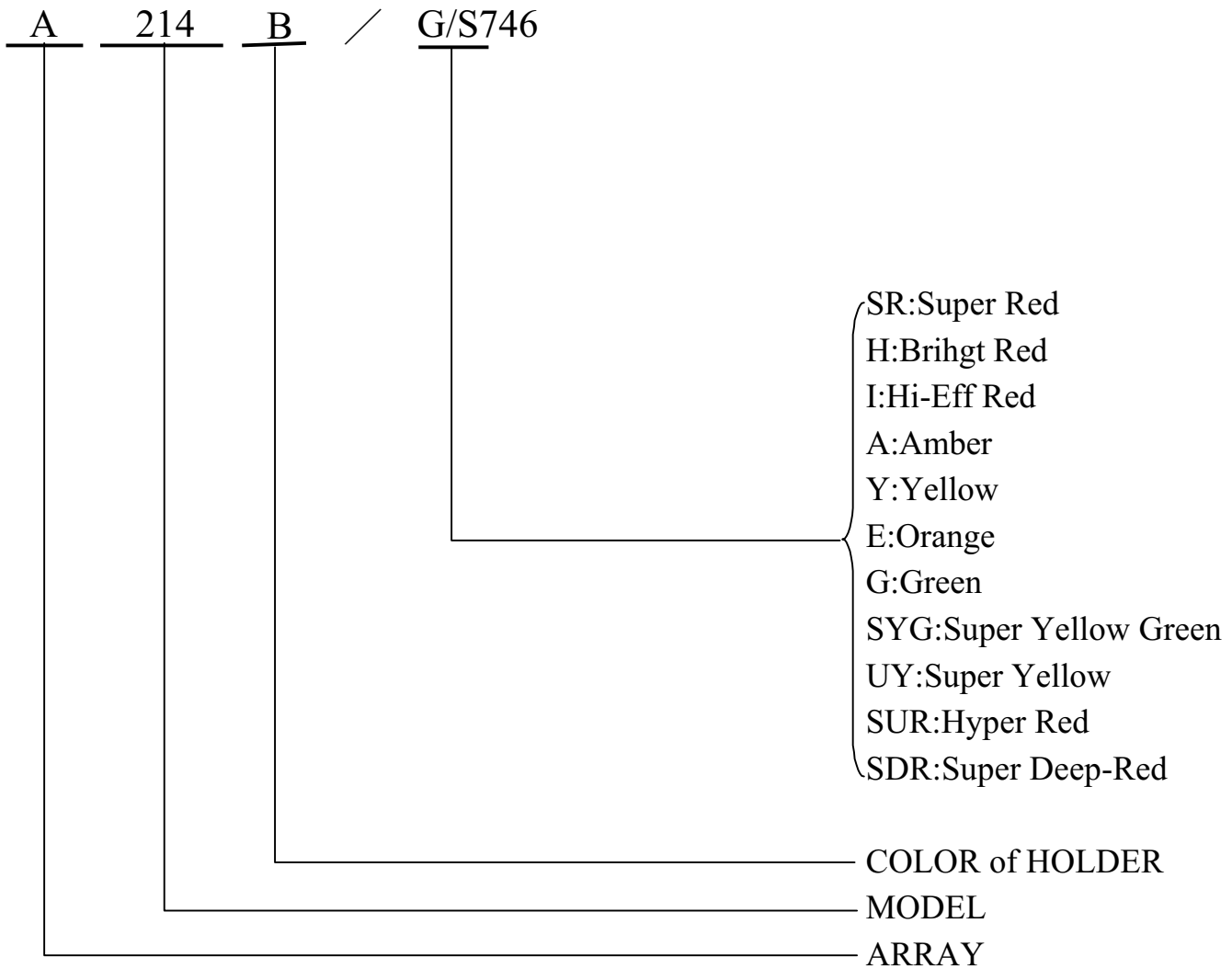



Device Number : _____ REV: _____

2.4*5.0mm Rectangle Type LED Lamps

MODEL NO : _____ A214B/G/S746 _____ ECN : _____ Page: _____ 5/7

Absolute Maximum Ratings at Ta = 25°C

Parameter	Symbol	Rating	Unit
Forward Current	If	30	mA
Operating Temperature	Topr	-40 to +85	°C
Storage Temperature	Tstg	-40 to +100	°C
Soldering Temperature	Tsol	260 ± 5	°C
Power Dissipation	Pd	100	mW
Peak Forward Current(Duty 1/10 @ 1KHZ)	If(Peak)	160	mA
Reverse Voltage	Vr	5	V

Electronic Optical Characteristics :

Parameter	Symbol	MIN.	TYP.	MAX.	Unit	Condition
Luminous intensity	Iv	16.00	32.00	/	mcd	If= 10 mA
Viewing Angle	2θ 1/2	/	90	/	deg	If= 20 mA
Peak Wavelength	λ p	/	570	/	nm	If= 20 mA
Dominant Wavelength	λ d	/	571	/	nm	If= 20 mA
Spectrum Radiation Bandwidth	Δ λ	/	30	/	nm	If= 20 mA
Forward Voltage	Vf	1.7	2.1	2.4	V	If= 20 mA
Reverse Current	Ir	/	/	10	μA	Vr= 5 V



■ Typical Electro-Optical Characteristic Curves:

(U G)

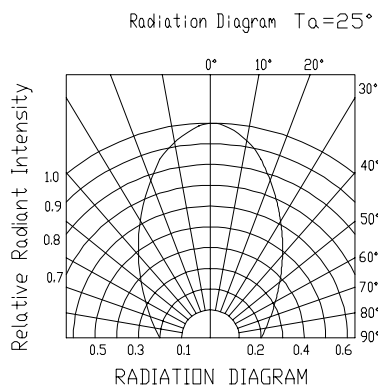
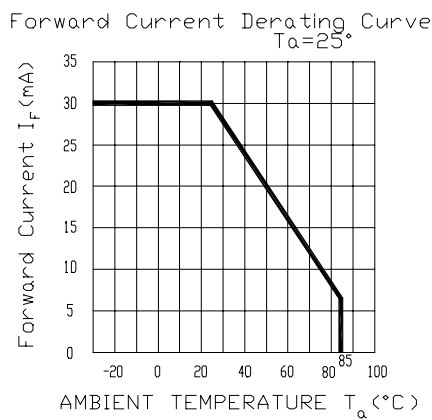
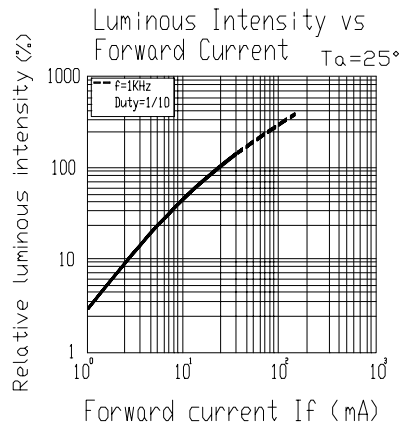
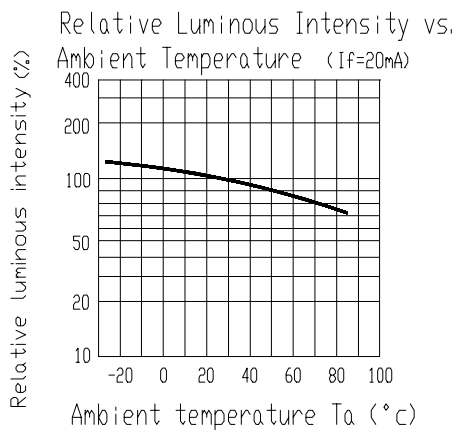
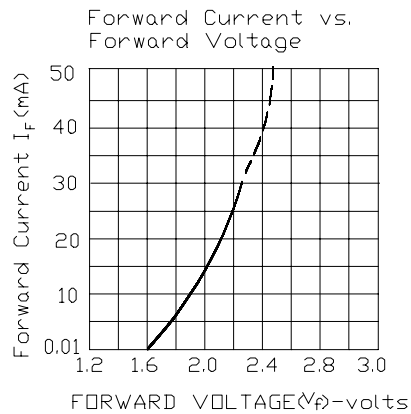
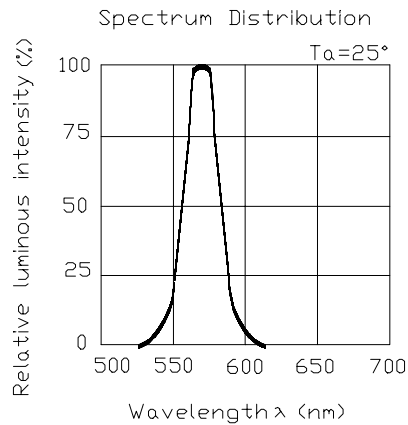



EVERLIGHT ELECTRONICS CO.,LTD.

Device Number : CDAE-021-013 REV: 1

MODEL NO : A214B/G/S746 ECN : Page: 7/7

■ Reliability test item and condition

No	Item	Test Conditions	Test Hours/Cycle	Sample Size	Ac/Re
1	Solder Heat	TEMP : 260°C ± 5 °C	5 SEC	76 Pcs	0/1
2	Temperature Cycle	H : +85°C 30min ∫ 5 min L : -55°C 30min	50 CYCLE	76 Pcs	0/1
3	Thermal Shock	H : +100°C 5min ∫ 10 sec L : -10°C 5min	50 CYCLE	76 Pcs	0/1
4	High Temperature Storage	TEMP : 100°C	1000 HRS	76 Pcs	0/1
5	Low Temperature Storage	TEMP : -55°C	1000 HRS	76 Pcs	0/1
6	DC Operating Life	If = 20 mA	1000 HRS	76 Pcs	0/1
7	High Temperature / High Humidity	85°C/85% RH	1000 HRS	76 Pcs	0/1