

SMD INDUCTORS

MODEL NO. : SMI-40 / SMI-50 SERIES

FEATURES:

- * SUPERIOR QUALITY FROM AN AUTOMATED PRODUCTION LINE.
- * PICK AND PLACE COMPATIBLE.
- * TAPE AND REEL PACKING.

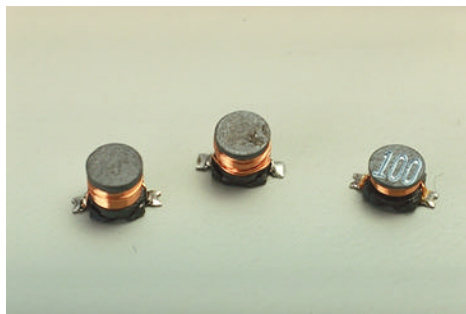

APPLICATION :

- * NOTEBOOK COMPUTERS.
- * DC-DC CONVERTORS.
- * DC-AC INVERTERS.
- * SIGNAL CONDITIONING
- * CELLULAR TELEPHONES
- * FILTERING.
- * HYBRIDS
- * PAGERS.

ELECTRICAL SPECIFICATION:

(UNIT:mm)

SMI-40 SERIES

SMI-50 SERIES

| MODEL NO. | L (uH) | DCR MAX (OHMS) | RATED DC CURRENT (mA) | MODEL NO. | L (uH) | DCR MAX (OHMS) | RATED DC CURRENT (mA) |
|------------|--------|----------------|-----------------------|------------|--------|----------------|-----------------------|
| SMI-40-1R0 | 1.0 | 0.04 | 500 | SMI-50-3R3 | 3.3 | 0.054 | 500 |
| SMI-40-1R5 | 1.5 | 0.06 | 450 | SMI-50-4R7 | 4.7 | 0.064 | 500 |
| SMI-40-2R2 | 2.2 | 0.07 | 400 | SMI-50-6R8 | 6.8 | 0.075 | 500 |
| SMI-40-3R3 | 3.3 | 0.10 | 300 | SMI-50-8R2 | 8.2 | 0.094 | 450 |
| SMI-40-4R7 | 4.7 | 0.15 | 250 | SMI-50-100 | 10 | 0.12 | 420 |
| SMI-40-6R8 | 6.8 | 0.17 | 220 | SMI-50-120 | 12 | 0.15 | 400 |
| SMI-40-100 | 10 | 0.24 | 200 | SMI-50-150 | 15 | 0.16 | 400 |
| SMI-40-120 | 12 | 0.30 | 180 | SMI-50-220 | 22 | 0.22 | 400 |
| SMI-40-150 | 15 | 0.36 | 160 | SMI-50-330 | 33 | 0.35 | 250 |
| SMI-40-180 | 18 | 0.41 | 160 | SMI-50-470 | 47 | 0.50 | 250 |
| SMI-40-220 | 22 | 0.55 | 130 | SMI-50-560 | 56 | 0.60 | 200 |
| SMI-40-270 | 27 | 0.64 | 130 | SMI-50-680 | 68 | 0.65 | 200 |
| SMI-40-330 | 33 | 0.75 | 100 | SMI-50-820 | 82 | 0.83 | 160 |
| SMI-40-390 | 39 | 0.83 | 100 | SMI-50-101 | 100 | 0.90 | 160 |
| SMI-40-470 | 47 | 1.10 | 100 | SMI-50-151 | 150 | 1.50 | 120 |
| SMI-40-560 | 56 | 1.50 | 80 | SMI-50-221 | 220 | 2.20 | 100 |
| SMI-40-680 | 68 | 1.60 | 80 | SMI-50-331 | 330 | 3.20 | 100 |
| SMI-40-820 | 82 | 2.10 | 70 | SMI-50-471 | 470 | 4.70 | 100 |
| SMI-40-101 | 100 | 2.40 | 70 | SMI-50-681 | 680 | 7.00 | 50 |
| SMI-40-121 | 120 | 3.20 | 50 | SMI-50-102 | 1000 | 11.0 | 40 |
| SMI-40-151 | 150 | 4.50 | 45 | | | | |
| SMI-40-181 | 180 | 5.10 | 40 | | | | |
| SMI-40-221 | 220 | 6.00 | 40 | | | | |
| SMI-40-271 | 270 | 6.80 | 40 | | | | |
| SMI-40-331 | 330 | 8.00 | 40 | | | | |
| SMI-40-471 | 470 | 14.0 | 40 | | | | |
| SMI-40-681 | 680 | 18.0 | 40 | | | | |
| SMI-40-821 | 820 | 24.0 | 40 | | | | |
| SMI-40-102 | 1000 | 27.0 | 40 | | | | |

PHYSICAL DIMENSION :

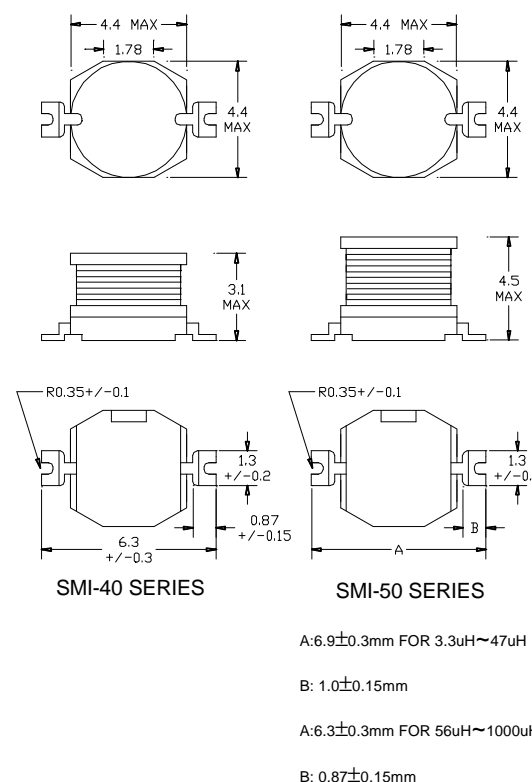

NOTE(1): TEST FREQUENCY: 100KHz, 1VRMS.
 NOTE(2): 1.0uH~8.2uH $\pm 20\%$, 10uH~1000uH $\pm 10\%$.

PACKING

Tape and Reel Orientation

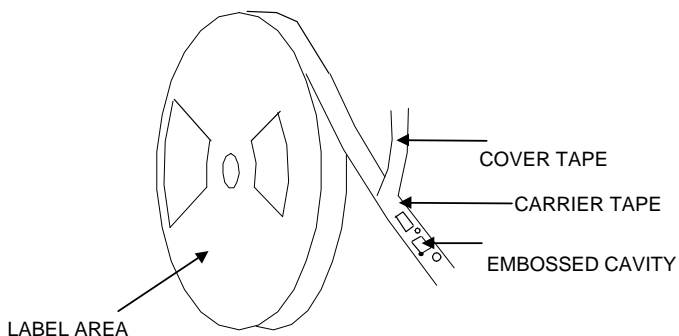
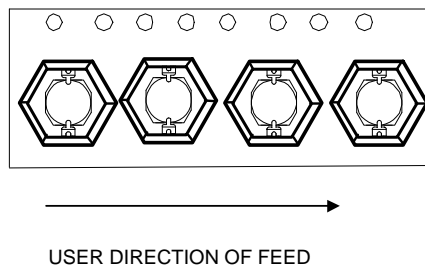

NOTE : Top view shown with cover tape removed.

| MODEL | TYPE WIDTH | REEL WIDTH | COMPONENT PITCH | UNITS PER REEL |
|---------------|------------|------------|-----------------|----------------|
| SMI-40 SERIES | 12 mm | 18.4 mm | 8 mm | 2500 |
| SMI-50 SERIES | 16 mm | 22.4 mm | 8mm | 1000 |

TAPE SPECIFICATIONS:

Carrier Tape Type: Conductive.

Cover Tape Type: Antistatic.

Cover Tape Adhesion to Carrier: 10 –70 grams.

REEL SPECIFICATIONS:

Non-antistatic.

Diameter (flange) : 13" (330.2mm)

STANDARDS : All embossed carrier tape packaging will be accomplished in compliance with latest revision of EIA-481

"Taping of surface Mount Components for Automatic Placement".

ENVIRONMENTAL PERFORMANCE

| ITEM | TEST | CONDITION |
|------|---------------------|---|
| 1 | Thermal Shock | Ten cycles of 30 minutes @ -55°C, 15 seconds maximum @ room ambient, 30 minutes @ + 125°C, 15 seconds maximum @ room ambient. |
| 2 | Vibration | 1 cycle of 30 minutes duration per the following: 5-7 Hz constant displacement of .75 inch, 5 minutes, 7-30 Hz constant acceleration of 1.5 g's. 10 minutes, 30-50 Hz constant displacement of 0.033 inch, 5 minutes, 50-500 Hz constant acceleration of 4.2 g's, 10 minutes. |
| 3 | Solderability | Per MIL-STD-202, Method 208, except steam aging is omitted and pads are dipped 30 from vertical. Solder temperature: + 245°C ±5°C. Immersion dwell time: 5±1/2 seconds. |
| 4 | Storage Life | Subject the component to 168 hours at + 85°C and 85% relative humidity. |
| 5 | Moisture Resistance | Precondition at + 40°C for 60 minutes. Subject the component to 240 hours at + 40°C and 90 to 95% relative humidity. |
| 6 | Mechanical Shock | One-half sine pulse (8700 g's for 0.3 milliseconds) in each direction along 3 mutually perpendicular axes in each direction (total of 6 shocks). |

SMD POWER INDUCTORS

MODEL NO. : SMI-42 SERIES (DO1608C COMPATIBLE)

FEATURES:

- * SUPERIOR QUALITY FROM AN AUTOMATED PRODUCTION LINE.
- * PICK AND PLACE COMPATIBLE.
- * TAPE AND REEL PACKING.



APPLICATION :

- * NOTEBOOK COMPUTERS.
- * DIGITAL STILL CAMERAS.
- * DC-AC INVERTERS.
- * ELECTRONICS DICTIONARIES
- * CABLE MODEM

ELECTRICAL SPECIFICATION:

PHYSICAL DIMENSION :

(UNIT:mm)

| PART NO. | INDUCTANCE ($\mu\text{H} \pm 20\%$) | D.C.R. MAX (Ω) | Isat (ADC) | Irms (Arms) |
|------------|--|-------------------------------|---------------|----------------|
| SMI-42-1R0 | 1.0 | 0.05 | 2.90 | 2.9 |
| SMI-42-1R5 | 1.5 | 0.05 | 2.60 | 2.8 |
| SMI-42-2R2 | 2.2 | 0.07 | 2.30 | 2.4 |
| SMI-42-3R3 | 3.3 | 0.08 | 2.00 | 2.0 |
| SMI-42-4R7 | 4.7 | 0.09 | 1.50 | 1.5 |
| SMI-42-6R8 | 6.8 | 0.13 | 1.20 | 1.4 |
| SMI-42-100 | 10 | 0.16 | 1.10 | 1.1 |
| SMI-42-150 | 15 | 0.23 | 0.90 | 1.2 |
| SMI-42-220 | 22 | 0.37 | 0.70 | 0.8 |
| SMI-42-330 | 33 | 0.51 | 0.58 | 0.6 |
| SMI-42-470 | 47 | 0.64 | 0.50 | 0.5 |
| SMI-42-680 | 68 | 0.86 | 0.40 | 0.4 |
| SMI-42-101 | 100 | 1.27 | 0.31 | 0.3 |
| SMI-42-151 | 150 | 2.00 | 0.27 | 0.25 |
| SMI-42-221 | 220 | 2.65 | 0.22 | 0.2 |
| SMI-42-331 | 330 | 3.80 | 0.18 | 0.16 |
| SMI-42-471 | 470 | 5.06 | 0.16 | 0.15 |
| SMI-42-681 | 680 | 9.20 | 0.14 | 0.12 |
| SMI-42-102 | 1000 | 13.8 | 0.10 | 0.07 |

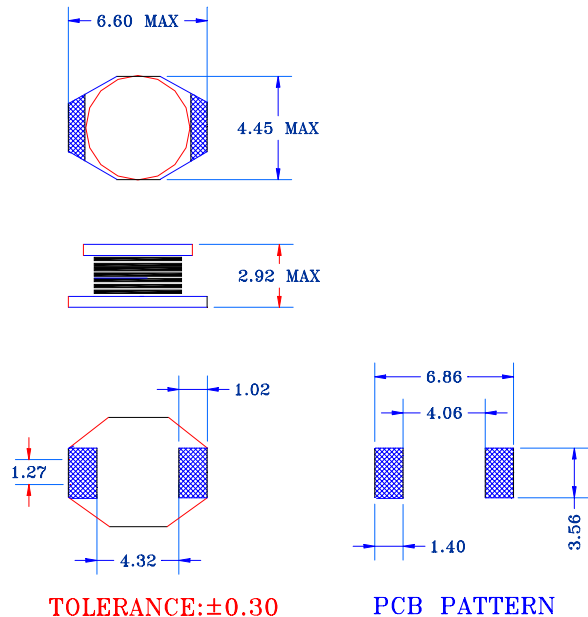

NOTE(1):TEST FREQUENCY: 100KHZ,0.1VRMS.

NOTE(2):THIS INDICATES THE VALUE OF CURRENT WHEN THE INDUCTANCE IS 10% LOWER THAN ITS INITIAL VALUE AT D.C. CURRENT WHEN AT $\Delta T=40^{\circ}\text{C}$ WHICHEVER IS LOWER.



台北沛波電子股份有限公司
TAIPEI MULTIPower ELECTRONICS CO.,LTD
2ND. FL.,542-7, CHUNG-CHENG ROAD,
HSIN-TIEN CITY, TAIPEI, TAIWAN, R.O.C
TEL : (02)8667-2078 FAX: (02) 8667-2080

SMD POWER INDUCTORS

MODEL NO. : SMI-43 SERIES (CD43 COMPATIBLE)

FEATURES:

- * SUPERIOR QUALITY FOR AN AUTOMATED PRODUCTION LINE.
- * PICK AND PLACE COMPATIBLE.
- * TAPE AND REEL PACKING.



APPLICATION :

- * NOTEBOOK COMPUTERS.
- * DC-DC CONVERTORS.
- * DC-AC INVERTERS.
- * ELECTRONICS DICTIONARIES
- * DIGITAL STILL CAMERAS.

ELECTRICAL SPECIFICATION:

(UNIT:mm)

| PART NO. | INDUCTANCE (uH) | D.C.R. MAX (Ω) | RATED CURRENT (A) |
|------------|-----------------|----------------|-------------------|
| SMI-43-1R0 | 1.0 | 0.0487 | 2.56 |
| SMI-43-1R4 | 1.4 | 0.0562 | 2.52 |
| SMI-43-1R8 | 1.8 | 0.0637 | 1.95 |
| SMI-43-2R2 | 2.2 | 0.0712 | 1.75 |
| SMI-43-2R7 | 2.7 | 0.0787 | 1.58 |
| SMI-43-3R3 | 3.3 | 0.0862 | 1.44 |
| SMI-43-3R9 | 3.9 | 0.0937 | 1.33 |
| SMI-43-4R7 | 4.7 | 0.1087 | 1.15 |
| SMI-43-5R6 | 5.6 | 0.1257 | 0.99 |
| SMI-43-6R8 | 6.8 | 0.1312 | 0.95 |
| SMI-43-8R2 | 8.2 | 0.1462 | 0.84 |
| SMI-43-100 | 10 | 0.182 | 1.04 |
| SMI-43-120 | 12 | 0.210 | 0.97 |
| SMI-43-150 | 15 | 0.235 | 0.85 |
| SMI-43-180 | 18 | 0.338 | 0.74 |
| SMI-43-220 | 22 | 0.378 | 0.68 |
| SMI-43-270 | 27 | 0.522 | 0.62 |
| SMI-43-330 | 33 | 0.540 | 0.56 |
| SMI-43-390 | 39 | 0.587 | 0.52 |
| SMI-43-470 | 47 | 0.844 | 0.44 |
| SMI-43-560 | 56 | 0.937 | 0.42 |
| SMI-43-680 | 68 | 1.117 | 0.37 |

PHYSICAL DIMENSION :

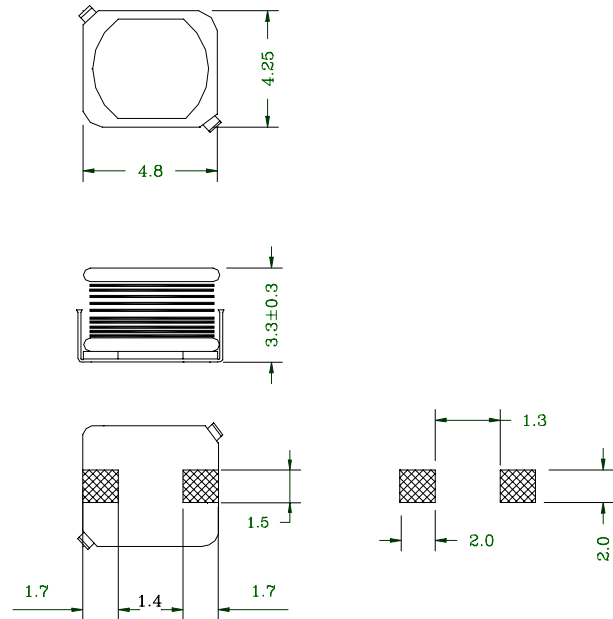

TOLERANCE : ±0.3

PCB PATTERN

NOTE (1): TEST FREQUENCY: 100KHz,1VRMS.

NOTE (2): 1.0 ~ 27uH± 20% , 33~68uH ± 10%.

NOTE (3): THIS INDICATES THE VALUE OF DC CURRENT WHICH THE INDUCTANCE IS 10% LOWER THAN ITS INITIAL VALUE AND/OR ΔT=40°C UNDER THIS DC CURRENT BIAS.



台北沛波電子股份有限公司
TAIPEI MULTIPower ELECTRONICS CO.,LTD
2ND. FL.,542-7, CHUNG-CHENG ROAD,
HSIN-TIEN CITY, TAIPEI, TAIWAN, R.O.C
TEL : (02)8667-2078 FAX: (02) 8667-2080

SMD POWER INDUCTORS

MODEL NO. : SMI-54 SERIES (CD54 COMPATIBLE)

FEATURES:

- * SUPERIOR QUALITY FROM AN AUTOMATED PRODUCTION LINE.
- * PICK AND PLACE COMPATIBLE.
- * TAPE AND REEL PACKING.



APPLICATION :

- * NOTEBOOK COMPUTERS.
- * DC-DC CONVERTORS.
- * DC-AC INVERTER.
- * PDA
- * DIGITAL STILL CAMERA
- * PC CAMERA

ELECTRICAL SPECIFICATION:

PHYSICAL DIMENSION : (UNIT:mm)

| PART NO. | INDUCTANCE (uH) | D.C.R. MAX (Ω) | RATED CURRENT (A) |
|------------|-----------------|----------------|-------------------|
| SMI-54-100 | 10 | 0.10 | 1.44 |
| SMI-54-120 | 12 | 0.12 | 1.40 |
| SMI-54-150 | 15 | 0.14 | 1.30 |
| SMI-54-180 | 18 | 0.15 | 1.23 |
| SMI-54-220 | 22 | 0.18 | 1.11 |
| SMI-54-270 | 27 | 0.20 | 0.97 |
| SMI-54-330 | 33 | 0.23 | 0.88 |
| SMI-54-390 | 39 | 0.32 | 0.80 |
| SMI-54-470 | 47 | 0.37 | 0.72 |
| SMI-54-560 | 56 | 0.42 | 0.68 |
| SMI-54-680 | 68 | 0.46 | 0.61 |
| SMI-54-820 | 82 | 0.60 | 0.58 |
| SMI-54-101 | 100 | 0.70 | 0.52 |
| SMI-54-121 | 120 | 0.93 | 0.48 |
| SMI-54-151 | 150 | 1.10 | 0.40 |
| SMI-54-181 | 180 | 1.38 | 0.38 |
| SMI-54-221 | 220 | 1.57 | 0.35 |

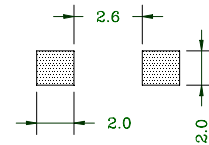
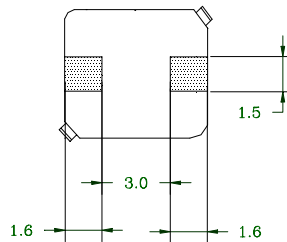
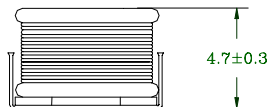
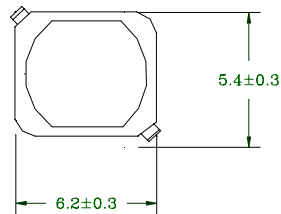

TOLERANCE: ± 0.3

PCB PATTERN

NOTE (1): TEST FREQUENCY: 100KHz,1VRMS.

NOTE (2): 10~27uH ± 20% ,33 ~ 47uH ± 15%(L),56~220uH± 10%(K).

NOTE (3): THIS INDICATES THE VALUE OF DC CURRENT WHICH THE INDUCTANCE IS 10% LOWER THAN ITS INITIAL VALUE AND/OR ΔT=40°C UNDER THIS DC CURRENT BIAS.



台北沛波電子股份有限公司
 TAIPEI MULTIPower ELECTRONICS CO.,LTD
 2ND. FL.,542-7, CHUNG-CHENG ROAD,
 HSIN-TIEN CITY, TAIPEI, TAIWAN, R.O.C
 TEL : (02)8667-2078 FAX: (02) 8667-2080

SMD INDUCTORS

MODEL NO. : SMI-60 SERIES
FEATURES:

- * SUPERIOR QUALITY FROM AN AUTOMATED PRODUCTION LINE.
- * PICK AND PLACE COMPATIBLE.
- * TAPE AND REEL PACKING.

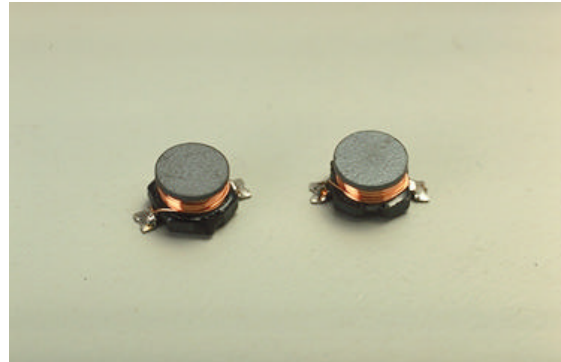

APPLICATION :

- * NOTEBOOK COMPUTERS.
- * DC-DC CONVERTORS.
- *DC-AC INVERTERS.
- * SIGNAL CONDITIONING
- * CELLULAR TELEPHONES
- *FILTERING.
- * HYBRIDS
- * PAGERS.
- *PDA.

ELECTRICAL SPECIFICATION:

| MODEL NO. | L (uH) | DCR MAX (OHMS) | RATED DC CURRENT (mA) |
|------------|--------|----------------|-----------------------|
| SMI-60-3R3 | 3.3 | 0.065 | 1000 |
| SMI-60-4R7 | 4.7 | 0.075 | 1000 |
| SMI-60-6R8 | 6.8 | 0.12 | 750 |
| SMI-60-100 | 10 | 0.16 | 600 |
| SMI-60-120 | 12 | 0.21 | 500 |
| SMI-60-150 | 15 | 0.23 | 500 |
| SMI-60-180 | 18 | 0.30 | 450 |
| SMI-60-220 | 22 | 0.35 | 400 |
| SMI-60-270 | 27 | 0.50 | 300 |
| SMI-60-330 | 33 | 0.60 | 250 |
| SMI-60-390 | 39 | 0.63 | 250 |
| SMI-60-470 | 47 | 0.74 | 250 |
| SMI-60-560 | 56 | 0.95 | 200 |
| SMI-60-680 | 68 | 1.0 | 200 |
| SMI-60-820 | 82 | 1.5 | 200 |
| SMI-60-101 | 100 | 1.5 | 180 |
| SMI-60-121 | 120 | 1.8 | 180 |
| SMI-60-151 | 150 | 2.2 | 150 |
| SMI-60-181 | 180 | 2.3 | 150 |
| SMI-60-221 | 220 | 3.3 | 130 |
| SMI-60-271 | 270 | 3.8 | 120 |
| SMI-60-331 | 330 | 4.8 | 100 |
| SMI-60-471 | 470 | 8.3 | 50 |
| SMI-60-681 | 680 | 10.5 | 50 |
| SMI-60-821 | 820 | 11.5 | 50 |
| SMI-60-102 | 1000 | 15 | 50 |

PHYSICAL DIMENSION : (UNIT:mm)

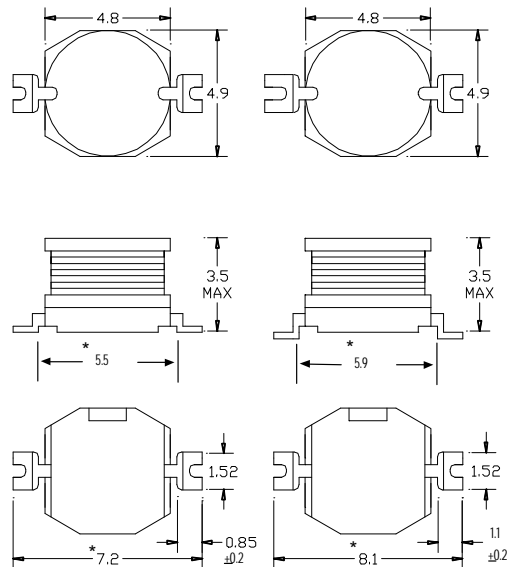

22uH-1000uH

3.3uH-18uH

TOLERANCE +/- 0.3

NOTE(1):TEST FREQUENCY: 100KHz,1VRMS.

NOTE(2):3.3uH-6.8uH ±20%, 10uH-1000uH ±10%.

PACKING

Tape and Reel Orientation

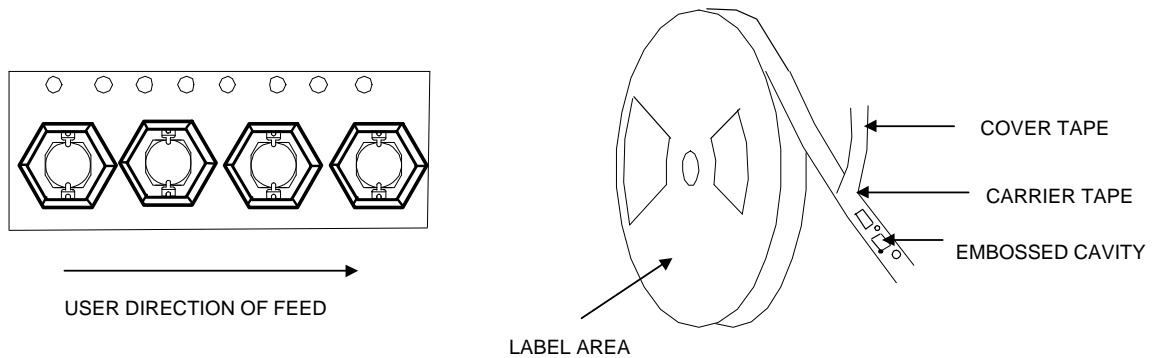

NOTE : Top view shown with cover tape removed.

| TAPE | WIDTH | REEL | WIDTH | COMPONENT | PITCH | UNITS | PER | REEL |
|------|-------|------|--------|-----------|-------|-------|-----|------|
| | 16mm | | 22.4mm | | 8mm | | | 2500 |

TAPE SPECIFICATIONS:

- Carrier Tape Type : Conductive.
- Cover Tape Type : Antistatic.
- Cover Tape Adhesion to Carrier : 10 - 70 grams.

REEL SPECIFICATIONS:

- Diameter (flange) : 13" (330.2mm)

STANDARDS : All embossed carrier tape packaging will be accomplished in compliance with latest revision of EIA-481
"Taping of surface Mount Components for Automatic Placement".

ENVIRONMENTAL PERFORMANCE

| ITEM | TEST | CONDITION |
|------|-----------------------|--|
| 1 | Thermal Shock | One cycle shall consist of: (1) 30minutes at temperature -30°C (2) 15 seconds maximum at room ambient. (3) 30 minutes at temperature +85°C (4) 15 seconds maximum at room ambient. Subject samples to 10 cycles. Test per applicable devices specification after a 4 hours stabilization at room ambient. |
| 2 | Vibration | Inductance deviation within $\pm 3.0\%$ after vibration for 1 hour. In each of three orientations at sweep vibration (10~50~10Hz) with 1.5mm P-P amplitude. |
| 3 | Solderability | Solder pot at $230^{\circ}\text{C} \pm 5^{\circ}\text{C}$, with kester 1544 solder flux. Dip parts into solder pot containing 63/37 molten alloy for 5 second ± 1 second. Wetting must occur on a minimum of 90% of the terminations. |
| 4 | Operating Temperature | -25°C ~ +80°C (coil contain heat) |
| 5 | Humidity | Inductance deviation within $\pm 5.0\%$ After 96 hour in 90~95% relative humidity at $40 \pm 2^{\circ}\text{C}$ and 1 hour drying under normal condition. |
| 6 | Mechanical Shock | One-half sine pulse (8700 g' s for 0.3 milliseconds) in each direction along 3 mutually perpendicular axes in each direction (total of 6 shocks). |

SMD POWER INDUCTORS

MODEL NO. : SMI-70 SERIES (CD73 COMPATIBLE)

FEATURES:

- * SUPERIOR QUALITY FROM AN AUTOMATED PRODUCTION LINE.
- * PICK AND PLACE COMPATIBLE.
- * TAPE AND REEL PACKING.

APPLICATION :

- * NOTEBOOK COMPUTERS.
- * DC-DC CONVERTORS.
- *DC-AC INVERTERS.



ELECTRICAL SPECIFICATION:

| PART NO. | INDUCTANCE (uH) | DCR MAX (Ω) | RATED CURRENT (A) |
|------------|-----------------|-------------|-------------------|
| SMI-70-100 | 10 | 0.08 | 1.44 |
| SMI-70-120 | 12 | 0.09 | 1.39 |
| SMI-70-150 | 15 | 0.10 | 1.24 |
| SMI-70-180 | 18 | 0.11 | 1.12 |
| SMI-70-220 | 22 | 0.13 | 1.07 |
| SMI-70-270 | 27 | 0.15 | 0.94 |
| SMI-70-330 | 33 | 0.17 | 0.85 |
| SMI-70-390 | 39 | 0.22 | 0.74 |
| SMI-70-470 | 47 | 0.25 | 0.68 |
| SMI-70-560 | 56 | 0.28 | 0.64 |
| SMI-70-680 | 68 | 0.33 | 0.59 |
| SMI-70-820 | 82 | 0.41 | 0.54 |
| SMI-70-101 | 100 | 0.48 | 0.51 |
| SMI-70-121 | 120 | 0.54 | 0.49 |
| SMI-70-151 | 150 | 0.75 | 0.40 |
| SMI-70-181 | 180 | 1.02 | 0.36 |
| SMI-70-221 | 220 | 1.20 | 0.31 |
| SMI-70-271 | 270 | 1.31 | 0.29 |
| SMI-70-331 | 330 | 1.50 | 0.28 |

NOTE(1):TEST FREQUENCY: 100KHz,1VRMS.

NOTE(2):10~47uH ±20%, 56~330uH ±10%.

NOTE(3):THIS INDICATES THE VALUE OF CURRENT WHEN THE INDUCTANCE IS 10% LOWER THAN ITS INITIAL VALUE AT D.C. CURRENT WHEN ATΔT=40°C WHICHEVER IS LOWER.

PHYSICAL DIMENSION : (UNIT:mm)

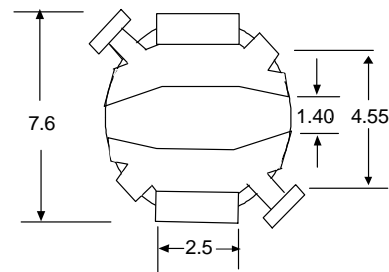
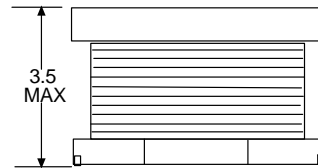
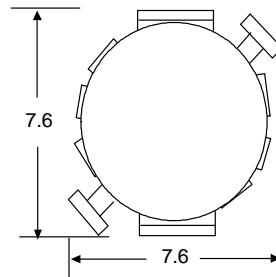

TOLERANCE: ±0.3

PACKING

Tape and Reel Orientation

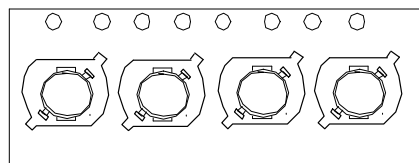

USER DIRECTION OF FEED

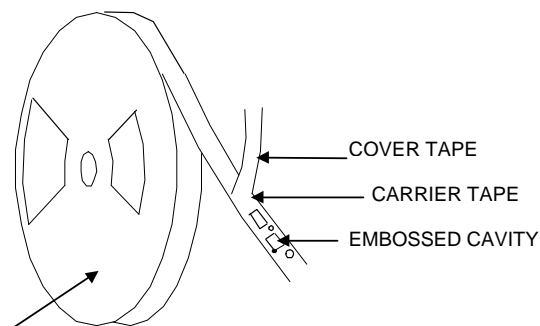

LABEL AREA

NOTE : Top view shown with cover tape removed.

| TAPE WIDTH | REEL WIDTH | COMPONENT PITCH | UNITS PER REEL |
|------------|------------|-----------------|----------------|
| 16mm | 22.4mm | 12mm | 1500 |

TAPE SPECIFICATIONS:

Carrier Tape Type : Conductive.

Cover Tape Type : Antistatic.

Cover Tape Adhesion to Carrier : 10 - 70 grams.

REEL SPECIFICATIONS:

Diameter (flange) : 13" (330.2mm)

STANDARDS : All embossed carrier tape packaging will be accomplished in compliance with latest revision of EIA-481
"Taping of surface Mount Components for Automatic Placement".

ENVIRONMENTAL PERFORMANCE

| ITEM | TEST | CONDITION |
|------|-----------------------|--|
| 1 | Thermal Shock | One cycle shall consist of: (1) 30minutes at temperature -30°C (2) 15 seconds maximum at room ambient. (3) 30 minutes at temperature +85°C (4) 15 seconds maximum at room ambient. Subject samples to 10 cycles. Test per applicable devices specification after a 4 hours stabilization at room ambient. |
| 2 | Vibration | Inductance deviation within $\pm 3.0\%$ after vibration for 1 hour. In each of three orientations at sweep vibration (10-50-10Hz) with 1.5mm P-P amplitude. |
| 3 | Solderability | Solder pot at $230^{\circ}\text{C} \pm 5^{\circ}\text{C}$, with kester 1544 solder flux. Dip parts into solder pot containing 63/37 molten alloy for 5 second ± 1 second. Wetting must occur on a minimum of 90% of the terminations. |
| 4 | Operating Temperature | -25°C~ +80°C(coil contain heat) |
| 5 | Humidity | Inductance deviation within $\pm 5.0\%$ After 96 hour in 90-95% relative humidity at $40 \pm 2^{\circ}\text{C}$ and 1 hour drying under normal condition. |
| 6 | Mechanical Shock | Inductance deviation within $\pm 5.0\%$ after drop down with 981m/s^2 (100G) shock. Attitude upon a rubber block method shock testing machine, for 1 time, in each of three orientations. |



台北沛波電子股份有限公司

TAIPEI MULTIPower ELECTRONIC CO., LTD.
2ND. FL., 542-7, CHUNG-CHENG ROAD,
HSIN-TIEN CITY, TAIPEI, TAIWAN, R.O.C.
TEL: (02)8667-2078 FAX: (02)8667-2080

SMD POWER INDUCTORS

MODEL NO. : SMI-75 SERIES (CD75 COMPATIBLE)

FEATURES:

- * SUPERIOR QUALITY FROM AN AUTOMATED PRODUCTION LINE.
- * PICK AND PLACE COMPATIBLE.
- * TAPE AND REEL PACKING.

APPLICATION :

- * NOTEBOOK COMPUTERS.
- * DC-DC CONVERTORS.
- * DC-AC INVERTERS.

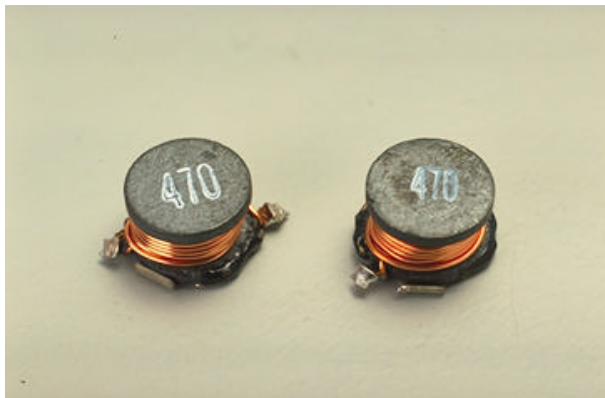

ELECTRICAL SPECIFICATION:

| PART NO. | INDUCTANCE (uH) | D.C.R. MAX (Ω) | RATED CURRENT (A) |
|------------|-----------------|----------------|-------------------|
| SMI-75-100 | 10 | 0.07 | 2.30 |
| SMI-75-120 | 12 | 0.08 | 2.00 |
| SMI-75-150 | 15 | 0.09 | 1.80 |
| SMI-75-180 | 18 | 0.10 | 1.60 |
| SMI-75-220 | 22 | 0.11 | 1.50 |
| SMI-75-270 | 27 | 0.12 | 1.30 |
| SMI-75-330 | 33 | 0.13 | 1.20 |
| SMI-75-390 | 39 | 0.16 | 1.10 |
| SMI-75-470 | 47 | 0.18 | 1.00 |
| SMI-75-560 | 56 | 0.24 | 0.94 |
| SMI-75-680 | 68 | 0.28 | 0.85 |
| SMI-75-820 | 82 | 0.37 | 0.78 |
| SMI-75-101 | 100 | 0.43 | 0.72 |
| SMI-75-121 | 120 | 0.47 | 0.66 |
| SMI-75-151 | 150 | 0.64 | 0.58 |
| SMI-75-181 | 180 | 0.71 | 0.51 |
| SMI-75-221 | 220 | 0.96 | 0.49 |
| SMI-75-271 | 270 | 1.11 | 0.42 |
| SMI-75-331 | 330 | 1.26 | 0.40 |
| SMI-75-391 | 390 | 1.77 | 0.36 |
| SMI-75-471 | 470 | 1.96 | 0.34 |

PHYSICAL DIMENSION : (UNIT:mm)

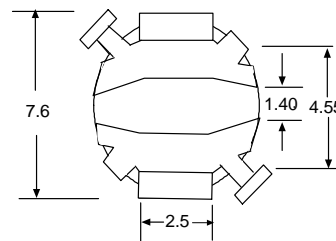
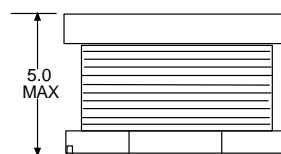
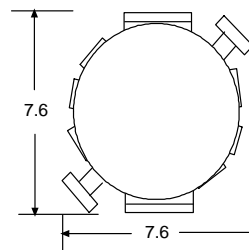

NOTE(1):TEST FREQUENCY: 100KHz,1VRMS.

NOTE(2):10~470uH ±10%.

NOTE(3):THIS INDICATES THE VALUE OF CURRENT WHEN THE INDUCTANCE IS 10% LOWER THAN ITS INITIAL VALUE AT D.C. CURRENT WHEN ATΔT=40°C WHICHEVER IS LOWER.

TOLERANCE: ±0.3

TNP

台北沛波電子股份有限公司
TAIPEI MULTIPower ELECTRONIC CO., LTD.
2ND. FL., 542-7, CHUNG-CHENG ROAD,
HSIN-TIEN CITY, TAIPEI, TAIWAN, R.O.C.
TEL: (02)8667-2078 FAX: (02)8667-2080

PACKING

Tape and Reel Orientation

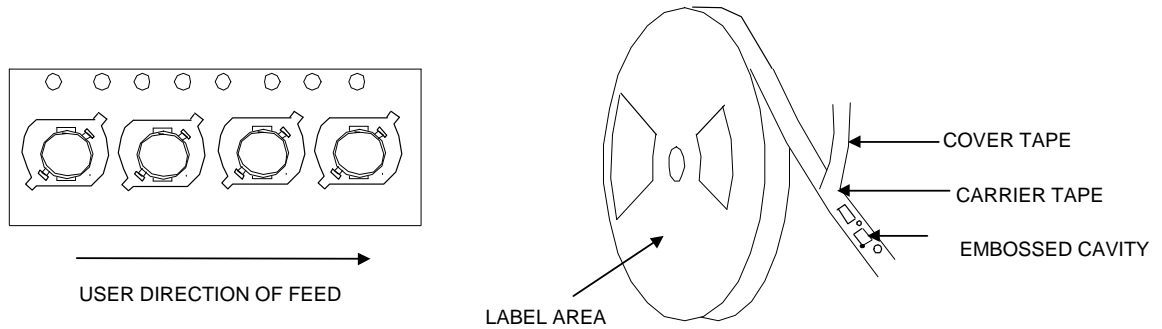

NOTE : Top view shown with cover tape removed.

| TAPE WIDTH | REEL WIDTH | COMPONENT PITCH | UNITS PER REEL |
|------------|------------|-----------------|----------------|
| 16mm | 22.4mm | 12mm | 1000 |

TAPE SPECIFICATIONS:

- Carrier Tape Type : Conductive.
- Cover Tape Type : Antistatic.
- Cover Tape Adhesion to Carrier : 10 - 70 grams.

REEL SPECIFICATIONS:

- Diameter (flange) : 13" (330.2mm)

STANDARDS : All embossed carrier tape packaging will be accomplished in compliance with latest revision of EIA-481
"Taping of surface Mount Components for Automatic Placement".

ENVIRONMENTAL PERFORMANCE

| ITEM | TEST | CONDITION |
|------|-----------------------|--|
| 1 | Thermal Shock | One cycle shall consist of: (1) 30minutes at temperature -30°C (2) 15 seconds maximum at room ambient. (3) 30 minutes at temperature +85°C (4) 15 seconds maximum at room ambient. Subject samples to 10 cycles. Test per applicable devices specification after a 4 hours stabilization at room ambient. |
| 2 | Vibration | Inductance deviation within $\pm 3.0\%$ after vibration for 1 hour. In each of three orientations at sweep vibration (10~50~10Hz) with 1.5mm P-P amplitude. |
| 3 | Solderability | Solder pot at $230^{\circ}\text{C} \pm 5^{\circ}\text{C}$, with kester 1544 solder flux. Dip parts into solder pot containing 63/37 molten alloy for 5 second ± 1 second. Wetting must occur on a minimum of 90% of the terminations. |
| 4 | Operating Temperature | $-25^{\circ}\text{C} \sim +80^{\circ}\text{C}$ (coil contain heat) |
| 5 | Humidity | Inductance deviation within $\pm 5.0\%$ After 96 hour in 90~95% relative humidity at $40 \pm 2^{\circ}\text{C}$ and 1 hour drying under normal condition. |
| 6 | Mechanical Shock | Inductance deviation within $\pm 5.0\%$ after drop down with 981m/s^2 (100G) shock. Attitude upon a rubber block method shock testing machine, for 1 time, in each of three orientations. |

SMD POWER INDUCTORS

MODEL NO. : SMI-74 SERIES

FEATURES:

- * SUPERIOR QUALITY FROM AN AUTOMATED PRODUCTION LINE.
- * PICK AND PLACE COMPATIBLE.
- * TAPE AND REEL PACKING.

APPLICATION :

- * NOTEBOOK COMPUTERS.
- * DC-DC CONVERTORS.
- * DC-AC INVERTER.

ELECTRICAL SPECIFICATION:

(UNIT:mm)

| PART NO. | INDUCTANCE (uH) | D.C.R. MAX (Ω) | RATED CURRENT (A) |
|------------|-----------------|----------------|-------------------|
| SMI-74-100 | 10 | 0.07 | 2.30 |
| SMI-74-120 | 12 | 0.08 | 2.00 |
| SMI-74-150 | 15 | 0.09 | 1.80 |
| SMI-74-180 | 18 | 0.10 | 1.60 |
| SMI-74-220 | 22 | 0.11 | 1.50 |
| SMI-74-270 | 27 | 0.12 | 1.30 |
| SMI-74-330 | 33 | 0.13 | 1.20 |
| SMI-74-390 | 39 | 0.16 | 1.10 |
| SMI-74-470 | 47 | 0.18 | 1.00 |
| SMI-74-560 | 56 | 0.24 | 0.94 |
| SMI-74-680 | 68 | 0.28 | 0.85 |
| SMI-74-820 | 82 | 0.37 | 0.78 |
| SMI-74-101 | 100 | 0.43 | 0.72 |
| SMI-74-121 | 120 | 0.47 | 0.66 |
| SMI-74-151 | 150 | 0.64 | 0.58 |
| SMI-74-181 | 180 | 0.71 | 0.51 |
| SMI-74-221 | 220 | 0.96 | 0.49 |
| SMI-74-271 | 270 | 1.11 | 0.42 |
| SMI-74-331 | 330 | 1.26 | 0.40 |
| SMI-74-391 | 390 | 1.77 | 0.36 |
| SMI-74-471 | 470 | 1.96 | 0.34 |

PHYSICAL DIMENSION :

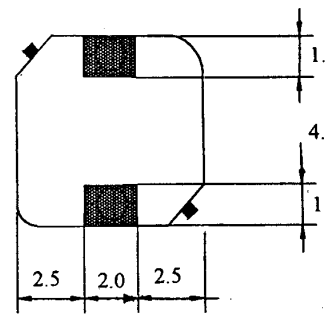
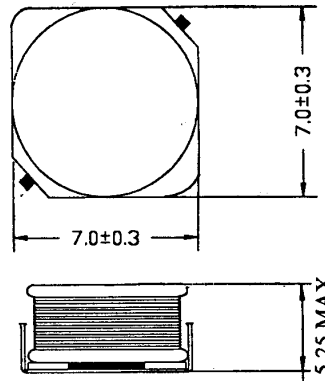

TOLERANCE : ± 0.3

NOTE (1): TEST FREQUENCY: 100KHz,1VRMS.

NOTE (2): 10 ~ 470uH ± 10%.

NOTE (3): THIS INDICATES THE VALUE OF DC CURRENT WHICH THE INDUCTANCE IS 10% LOWER THAN ITS INITIAL VALUE AND/OR ΔT=40°C UNDER THIS DC CURRENT BIAS.

台北沛波電子股份有限公司
 TAIPEI MULTIPOWER ELECTRONICS CO.,LTD
 2ND. FL.,542-7, CHUNG-CHENG ROAD,
 HSIN-TIEN CITY, TAIPEI, TAIWAN, R.O.C
 TEL : (02)8667-2078 FAX: (02) 8667-2080

SMD POWER INDUCTORS

MODEL NO. : SMI-75 SERIES (CD75 COMPATIBLE)

FEATURES:

- * SUPERIOR QUALITY FROM AN AUTOMATED PRODUCTION LINE.
- * PICK AND PLACE COMPATIBLE.
- * TAPE AND REEL PACKING.

APPLICATION :

- * NOTEBOOK COMPUTERS.
- * DC-DC CONVERTORS.
- * DC-AC INVERTERS.



ELECTRICAL SPECIFICATION:

| PART NO. | INDUCTANCE (uH) | D.C.R. MAX (Ω) | RATED CURRENT (A) |
|------------|-----------------|----------------|-------------------|
| SMI-75-100 | 10 | 0.07 | 2.30 |
| SMI-75-120 | 12 | 0.08 | 2.00 |
| SMI-75-150 | 15 | 0.09 | 1.80 |
| SMI-75-180 | 18 | 0.10 | 1.60 |
| SMI-75-220 | 22 | 0.11 | 1.50 |
| SMI-75-270 | 27 | 0.12 | 1.30 |
| SMI-75-330 | 33 | 0.13 | 1.20 |
| SMI-75-390 | 39 | 0.16 | 1.10 |
| SMI-75-470 | 47 | 0.18 | 1.00 |
| SMI-75-560 | 56 | 0.24 | 0.94 |
| SMI-75-680 | 68 | 0.28 | 0.85 |
| SMI-75-820 | 82 | 0.37 | 0.78 |
| SMI-75-101 | 100 | 0.43 | 0.72 |
| SMI-75-121 | 120 | 0.47 | 0.66 |
| SMI-75-151 | 150 | 0.64 | 0.58 |
| SMI-75-181 | 180 | 0.71 | 0.51 |
| SMI-75-221 | 220 | 0.96 | 0.49 |
| SMI-75-271 | 270 | 1.11 | 0.42 |
| SMI-75-331 | 330 | 1.26 | 0.40 |
| SMI-75-391 | 390 | 1.77 | 0.36 |
| SMI-75-471 | 470 | 1.96 | 0.34 |

PHYSICAL DIMENSION : (UNIT:mm)

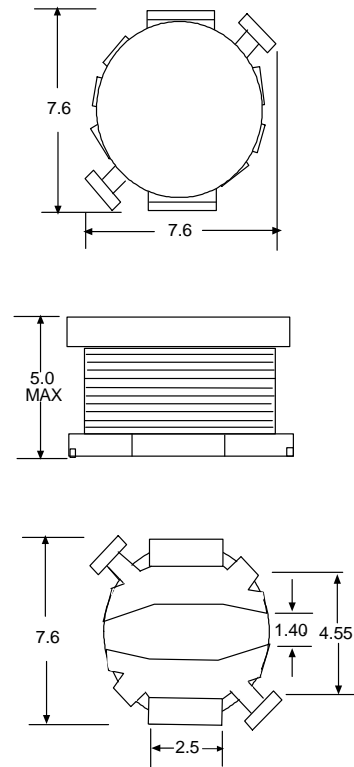

NOTE(1):TEST FREQUENCY: 100KHz,1VRMS.

NOTE(2):10~470uH ±10%.

NOTE(3):THIS INDICATES THE VALUE OF CURRENT WHEN THE INDUCTANCE IS 10% LOWER THAN ITS INITIAL VALUE AT D.C. CURRENT WHEN ATΔT=40°C WHICHEVER IS LOWER.

TOLERANCE: ±0.3

TNP

台北沛波電子股份有限公司
TAIPEI MULTIPower ELECTRONIC CO., LTD.
2ND. FL., 542-7, CHUNG-CHENG ROAD,
HSIN-TIEN CITY, TAIPEI, TAIWAN, R.O.C.
TEL: (02)8667-2078 FAX: (02)8667-2080

PACKING

Tape and Reel Orientation

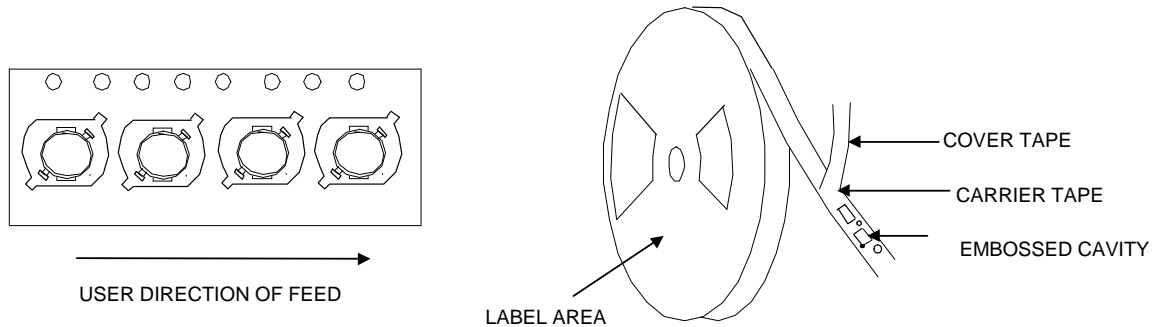

NOTE : Top view shown with cover tape removed.

| TAPE WIDTH | REEL WIDTH | COMPONENT PITCH | UNITS PER REEL |
|------------|------------|-----------------|----------------|
| 16mm | 22.4mm | 12mm | 1000 |

TAPE SPECIFICATIONS:

Carrier Tape Type : Conductive.

Cover Tape Type : Antistatic.

Cover Tape Adhesion to Carrier : 10 - 70 grams.

REEL SPECIFICATIONS:

Diameter (flange) : 13" (330.2mm)

STANDARDS : All embossed carrier tape packaging will be accomplished in compliance with latest revision of EIA-481
"Taping of surface Mount Components for Automatic Placement".

ENVIRONMENTAL PERFORMANCE

| ITEM | TEST | CONDITION |
|------|-----------------------|--|
| 1 | Thermal Shock | One cycle shall consist of: (1) 30minutes at temperature -30°C (2) 15 seconds maximum at room ambient. (3) 30 minutes at temperature +85°C (4) 15 seconds maximum at room ambient. Subject samples to 10 cycles. Test per applicable devices specification after a 4 hours stabilization at room ambient. |
| 2 | Vibration | Inductance deviation within $\pm 3.0\%$ after vibration for 1 hour. In each of three orientations at sweep vibration (10~50~10Hz) with 1.5mm P-P amplitude. |
| 3 | Solderability | Solder pot at $230^{\circ}\text{C} \pm 5^{\circ}\text{C}$, with kester 1544 solder flux. Dip parts into solder pot containing 63/37 molten alloy for 5 second ± 1 second. Wetting must occur on a minimum of 90% of the terminations. |
| 4 | Operating Temperature | $-25^{\circ}\text{C} \sim +80^{\circ}\text{C}$ (coil contain heat) |
| 5 | Humidity | Inductance deviation within $\pm 5.0\%$ After 96 hour in 90~95% relative humidity at $40 \pm 2^{\circ}\text{C}$ and 1 hour drying under normal condition. |
| 6 | Mechanical Shock | Inductance deviation within $\pm 5.0\%$ after drop down with 981m/s^2 (100G) shock. Attitude upon a rubber block method shock testing machine, for 1 time, in each of three orientations. |

SMD INDUCTORS

MODEL NO. : SMI-90 SERIES
FEATURES:

- * SUPERIOR QUALITY FROM AN AUTOMATED PRODUCTION LINE.
- * PICK AND PLACE COMPATIBLE.
- * TAPE AND REEL PACKING.

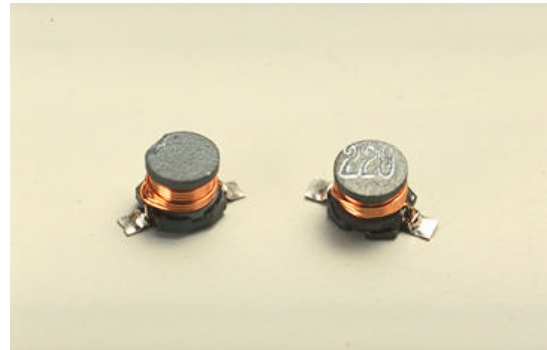

APPLICATION :

- * NOTEBOOK COMPUTERS.
- * DC-DC CONVERTORS.
- * DC-AC INVERTERS.
- * SIGNAL CONDITIONING
- * CELLULAR TELEPHONES
- * FILTERING.
- *PDA.

ELECTRICAL SPECIFICATION:

| MODEL NO. | L (uH) | D.C.R. MAX (OHMS) | RATED DC CURRENT (mA) |
|------------|--------|-------------------|-----------------------|
| SMI-90-3R3 | 3.3 | 0.037 | 1100 |
| SMI-90-4R7 | 4.7 | 0.050 | 1100 |
| SMI-90-6R8 | 6.8 | 0.075 | 900 |
| SMI-90-100 | 10 | 0.13 | 700 |
| SMI-90-120 | 12 | 0.14 | 700 |
| SMI-90-150 | 15 | 0.17 | 700 |
| SMI-90-180 | 18 | 0.20 | 700 |
| SMI-90-220 | 22 | 0.23 | 600 |
| SMI-90-270 | 27 | 0.29 | 550 |
| SMI-90-330 | 33 | 0.33 | 550 |
| SMI-90-390 | 39 | 0.40 | 550 |
| SMI-90-470 | 47 | 0.45 | 500 |
| SMI-90-560 | 56 | 0.55 | 450 |
| SMI-90-680 | 68 | 0.65 | 400 |
| SMI-90-820 | 82 | 0.80 | 350 |
| SMI-90-101 | 100 | 1.05 | 300 |
| SMI-90-121 | 120 | 1.4 | 250 |
| SMI-90-151 | 150 | 1.7 | 200 |
| SMI-90-181 | 180 | 1.9 | 200 |
| SMI-90-221 | 220 | 2.4 | 180 |
| SMI-90-271 | 270 | 2.8 | 180 |
| SMI-90-331 | 330 | 3.7 | 150 |
| SMI-90-471 | 470 | 5.0 | 120 |
| SMI-90-681 | 680 | 6.4 | 100 |
| SMI-90-821 | 820 | 8.8 | 80 |
| SMI-90-102 | 1000 | 11.5 | 75 |

NOTE(1):TEST FREQUENCY: 100KHz,1VRMS.

NOTE(2):3.3uH~6.8uH ±20%, 10uH~1000uH ±10%.

PHYSICAL DIMENSION : (UNIT:mm)

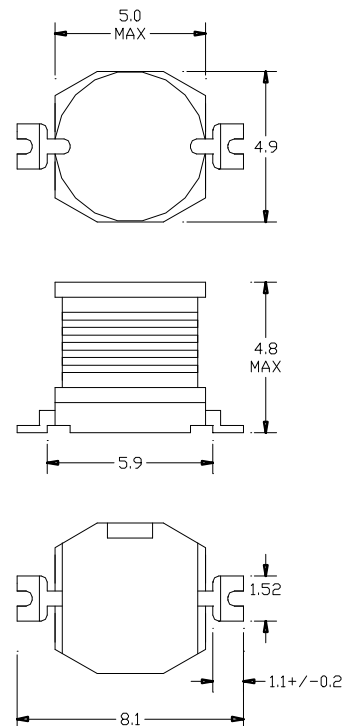

TOLERANCE +/- 0.3

TMP 台北沛波電子股份有限公司
TAIPEI MULTIPower ELECTRONIC CO., LTD.
 2ND. FL., 542-7, CHUNG-CHENG ROAD,
 HSIN-TIEN CITY, TAIPEI, TAIWAN, R.O.C.
 TEL: (02)8667-2078 FAX: (02)8667-2080

PACKING

Tape and Reel Orientation

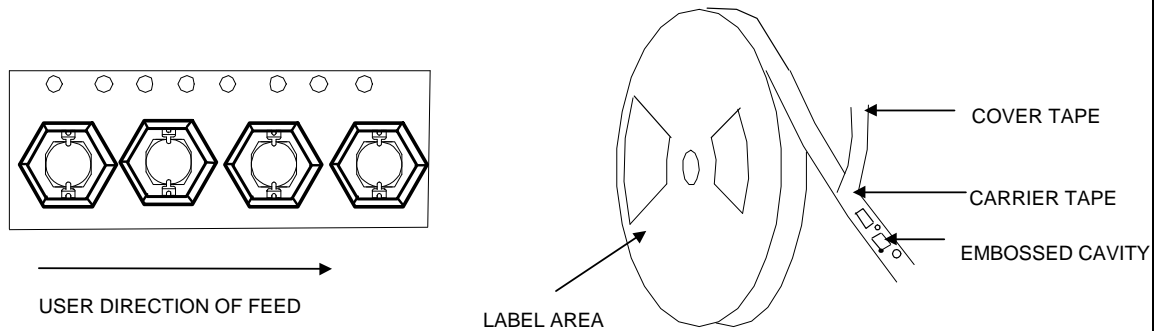

NOTE : Top view shown with cover tape removed.

| TAPE WIDTH | REEL WIDTH | COMPONENT PITCH | UNITS PER REEL |
|------------|------------|-----------------|----------------|
| 16mm | 22.4mm | 8mm | 1500 |

TAPE SPECIFICATIONS:

Carrier Tape Type : Conductive.

Cover Tape Type : Antistatic.

Cover Tape Adhesion to Carrier : 10 - 70 grams.

REEL SPECIFICATIONS:

Diameter (flange) : 13" (330.2mm)

STANDARDS : All embossed carrier tape packaging will be accomplished in compliance with latest revision of EIA-481 "Taping of surface Mount Components for Automatic Placement".

ENVIRONMENTAL PERFORMANCE

| ITEM | TEST | CONDITION |
|------|-----------------------|--|
| 1 | Thermal Shock | one cycle shall consist of : (1) 30 minutes at temperature -30°C. (2) 15 seconds maximum at room ambient. (3) 30 minutes at temperature +85°C. (4) 15 seconds maximum at room ambient. Subject samples to 10 cycles. Test per applicable devices specification after a 4 hours stabilization at room ambient. |
| 2 | Vibration | Inductance deviation within±3.0% after vibration for 1 hour. In each of three orientations at sweep vibration (10~50~10Hz) with 1.5mm P-P amplitude. |
| 3 | Solderability | Solder pot at 230°C±5°C, with kester 1544 solder flux. Dip parts into solder pot containing 63/37 molten alloy for 5 second±1 second. Wetting must occur on a minimum of 90% of the terminations. |
| 4 | Operating Temperature | -25°C ~ +80°C (coil contain heat). |
| 5 | Humidity | Inductance deviation within±5.0%. After 96 hour in 90~95% relative humidity at 40±2°C and 1 hour drying under normal condition. |
| 6 | Mechanical Shock | One-half sine pulse (8700 g' s for 0.3 milliseconds) in each direction along 3 mutually perpendicular axes in each direction (total of 6 shocks). |

SMD POWER INDUCTORS

MODEL NO. : SMI-0805 SERIES (DO3316P COMPATIBLE)

FEATURES:

- * SUPERIOR QUALITY FOR AN AUTOMATED PRODUCTION LINE.
- * PICK AND PLACE COMPATIBLE.
- * TAPE AND REEL PACKING.

APPLICATION :

- * NOTEBOOK COMPUTERS.
- * DC-DC CONVERTORS.
- *DC-AC INVERTERS.
- *CABLE MODEM

ELECTRICAL SPECIFICATION:

(UNIT:mm)

| PART NO. | INDUCTANCE ($\mu\text{H} \pm 20\%$) | D.C.R. MAX (Ω) | Isat (ADC) | Irms (Arms) |
|--------------|--|-------------------------------|---------------|----------------|
| SMI-0805-1R0 | 1.0 | 0.009 | 9.0 | 6.8 |
| SMI-0805-1R5 | 1.5 | 0.010 | 8.0 | 6.4 |
| SMI-0805-2R2 | 2.2 | 0.012 | 7.0 | 6.1 |
| SMI-0805-3R3 | 3.3 | 0.015 | 6.4 | 5.4 |
| SMI-0805-4R7 | 4.7 | 0.018 | 5.4 | 4.8 |
| SMI-0805-6R8 | 6.8 | 0.027 | 4.6 | 4.4 |
| SMI-0805-100 | 10 | 0.038 | 3.8 | 3.9 |
| SMI-0805-150 | 15 | 0.046 | 3.0 | 3.1 |
| SMI-0805-220 | 22 | 0.085 | 2.6 | 2.7 |
| SMI-0805-330 | 33 | 0.10 | 2.0 | 2.1 |
| SMI-0805-470 | 47 | 0.14 | 1.6 | 1.8 |
| SMI-0805-680 | 68 | 0.20 | 1.4 | 1.5 |
| SMI-0805-101 | 100 | 0.28 | 1.2 | 1.3 |
| SMI-0805-151 | 150 | 0.40 | 1.0 | 1.0 |
| SMI-0805-221 | 220 | 0.61 | 0.8 | 0.8 |
| SMI-0805-331 | 330 | 1.02 | 0.6 | 0.6 |
| SMI-0805-471 | 470 | 1.27 | 0.5 | 0.5 |
| SMI-0805-681 | 680 | 2.02 | 0.4 | 0.4 |
| SMI-0805-102 | 1000 | 3.00 | 0.3 | 0.3 |

PHYSICAL DIMENSION :

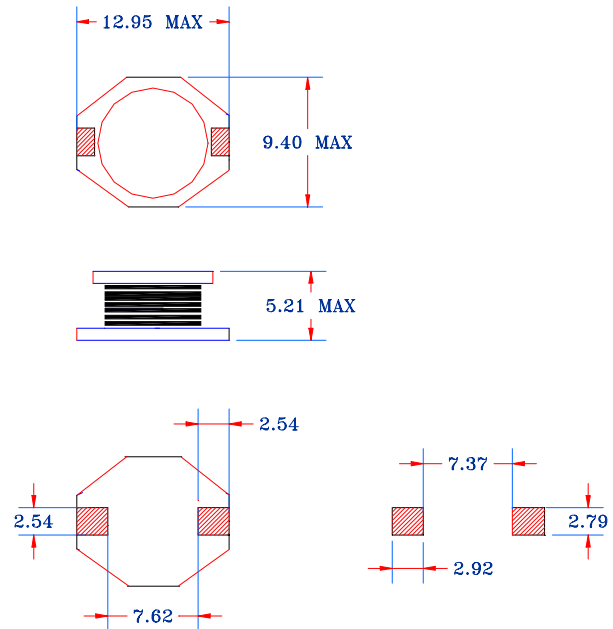

TOLERANCE: ± 0.30

PCB PATTERN

NOTE(1):TEST FREQUENCY: 100KHZ , 0.1 VRMS

NOTE(2):THIS INDICATES THE VALUE OF DC CURRENT WHICH THE INDUCTANCE IS 10% LOWER THAN ITS INITIAL VALUE AND/OR $\Delta T=40^{\circ}\text{C}$ UNDER THIS DC CURRENT BIAS.



台北沛波電子股份有限公司
TAIPEI MULTIPower ELECTRONICS CO.,LTD
2ND. FL.,542-7, CHUNG-CHENG ROAD,
HSIN-TIEN CITY, TAIPEI, TAIWAN, R.O.C
TEL : (02)8667-2078 FAX: (02) 8667-2080

SMD POWER INDUCTORS

MODEL NO. : SMI-1607 SERIES (D05022P COMPATIBLE)

FEATURES:

- * SUPERIOR QUALITY FOR AN AUTOMATED PRODUCTION LINE.
- * PICK AND PLACE COMPATIBLE.
- * TAPE AND REEL PACKING.



APPLICATION :

- * NOTEBOOK COMPUTERS.
- * DC-DC CONVERTORS.
- *DC-AC INVERTERS.

ELECTRICAL SPECIFICATION:

(UNIT:mm)

| PART NO. | INDUCTANCE ($\mu\text{H} \pm 20\%$) | D.C.R. MAX (Ω) | I _{rms} (A) | I _{sat} (ADC) |
|--------------|--|-------------------------------|-------------------------|---------------------------|
| SMI-1607-1R1 | 1.0 | 0.009 | 8.6 | 20 |
| SMI-1607-2R2 | 2.2 | 0.014 | 7.1 | 16 |
| SMI-1607-3R2 | 3.3 | 0.015 | 6.2 | 14 |
| SMI-1607-5R6 | 5.6 | 0.020 | 5.3 | 12 |
| SMI-1607-100 | 10 | 0.031 | 4.3 | 10 |
| SMI-1607-150 | 15 | 0.036 | 4.0 | 8.0 |
| SMI-1607-220 | 22 | 0.047 | 3.5 | 7.0 |
| SMI-1607-330 | 33 | 0.066 | 3.0 | 5.5 |
| SMI-1607-470 | 47 | 0.086 | 2.6 | 4.5 |
| SMI-1607-680 | 68 | 0.13 | 2.3 | 3.5 |
| SMI-1607-101 | 100 | 0.19 | 1.8 | 3.0 |
| SMI-1607-151 | 150 | 0.25 | 1.5 | 2.6 |
| SMI-1607-221 | 220 | 0.38 | 1.2 | 2.4 |
| SMI-1607-331 | 330 | 0.56 | 1.0 | 1.9 |
| SMI-1607-471 | 470 | 0.85 | 0.82 | 1.4 |
| SMI-1607-681 | 680 | 1.10 | 0.72 | 1.2 |
| SMI-1607-102 | 1000 | 1.80 | 0.56 | 1.0 |

PHYSICAL DIMENSION :

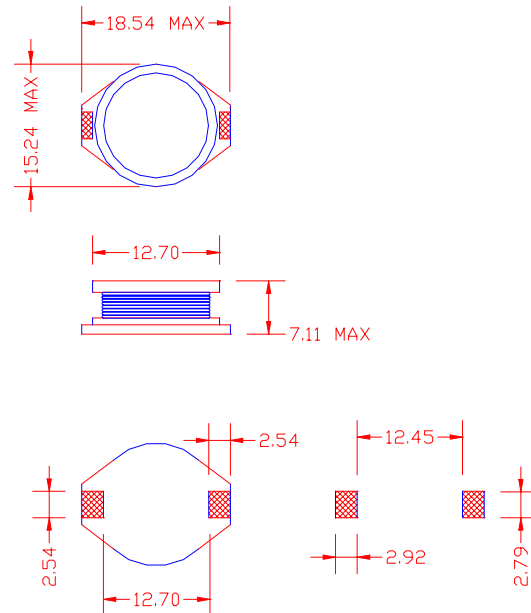

TOLERANCE : ± 0.3 PCB PATTERN

NOTE (1): TEST FREQUENCY: 100 kHz, 1 VRMS.

NOTE (2): THIS INDICATES THE VALUE OF DC CURRENT WHICH THE INDUCTANCE IS 10% LOWER THAN ITS INITIAL VALUE AND/OR $\Delta T=40^{\circ}\text{C}$ UNDER THIS DC CURRENT BIAS.

TMP 台北沛波電子股份有限公司
 TAIPEI MULTIPOWER ELECTRONICS CO.,LTD
 2ND. FL.,542-7, CHUNG-CHENG ROAD,
 HSIN-TIEN CITY, TAIPEI, TAIWAN, R.O.C
 TEL : (02) 8667-2078 FAX: (02) 8667-2080

SMD POWER INDUCTORS

MODEL NO. : SPC-0602 SERIES

FEATURES:

- * SUPERIOR QUALITY FOR AN AUTOMATED PRODUCTION LINE.
- * PICK AND PLACE COMPATIBLE.
- * TAPE AND REEL PACKING.



APPLICATION :

- * NOTEBOOK COMPUTERS.
- * DC-DC CONVERTORS.
- *DC-AC INVERTERS.
- *PDA
- *DIGITAL STILL CAMERAS.
- * PC CAMERAS.

ELECTRICAL SPECIFICATION:

PHYSICAL DIMENSION :

(UNIT:mm)

| PART NO. | INDUCTANCE (uH) ± 20% | D.C.R. MAX (Ω) | RATED CURRENT (A) |
|--------------|--------------------------|----------------|-------------------|
| SPC-0602-1R0 | 1.0 | 0.021 | 3.12 |
| SPC-0602-1R5 | 1.5 | 0.026 | 2.85 |
| SPC-0602-2R2 | 2.2 | 0.030 | 2.66 |
| SPC-0602-3R3 | 3.3 | 0.040 | 2.26 |
| SPC-0602-4R7 | 4.7 | 0.048 | 1.96 |
| SPC-0602-6R8 | 6.8 | 0.060 | 1.76 |
| SPC-0602-100 | 10 | 0.090 | 1.68 |
| SPC-0602-120 | 12 | 0.11 | 1.52 |
| SPC-0602-150 | 15 | 0.14 | 1.33 |
| SPC-0602-180 | 18 | 0.15 | 1.20 |
| SPC-0602-220 | 22 | 0.23 | 1.07 |
| SPC-0602-270 | 27 | 0.26 | 0.96 |
| SPC-0602-330 | 33 | 0.30 | 0.91 |
| SPC-0602-390 | 39 | 0.33 | 0.77 |
| SPC-0602-470 | 47 | 0.40 | 0.76 |
| SPC-0602-560 | 56 | 0.48 | 0.68 |
| SPC-0602-680 | 68 | 0.57 | 0.61 |
| SPC-0602-820 | 82 | 0.65 | 0.57 |
| SPC-0602-101 | 100 | 0.75 | 0.50 |
| SPC-0602-121 | 120 | 0.90 | 0.49 |
| SPC-0602-151 | 150 | 1.30 | 0.43 |
| SPC-0602-181 | 180 | 1.50 | 0.39 |
| SPC-0602-221 | 220 | 1.80 | 0.35 |
| SPC-0602-271 | 270 | 2.40 | 0.32 |
| SPC-0602-331 | 330 | 2.60 | 0.28 |
| SPC-0602-391 | 390 | 2.80 | 0.26 |
| SPC-0602-471 | 470 | 3.70 | 0.24 |
| SPC-0602-561 | 560 | 4.00 | 0.22 |
| SPC-0602-681 | 680 | 4.40 | 0.19 |
| SPC-0602-821 | 820 | 6.30 | 0.18 |
| SPC-0602-102 | 1000 | 7.50 | 0.16 |

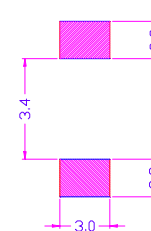
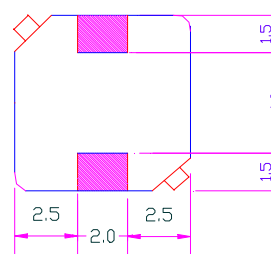
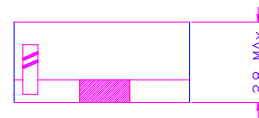
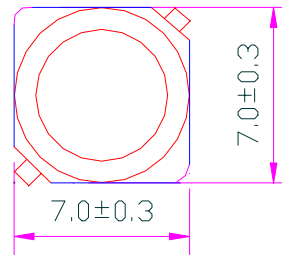

TOLERANCE : ± 0.3 PCB PATTERN

NOTE(1):TEST FREQUENCY: 10 KHZ,1 VRMS.

NOTE (2): THIS INDICATES THE VALUE OF DC CURRENT WHICH THE INDUCTANCE IS 25% LOWER THAN ITS INITIAL VALUE AND/OR ΔT=40°C UNDER THIS DC CURRENT BIAS.



台北沛波電子股份有限公司
 TAIPEI MULTIPower ELECTRONICS CO.,LTD
 2ND. FL.,542-7, CHUNG-CHENG ROAD,
 HSIN-TIEN CITY, TAIPEI, TAIWAN, R.O.C
 TEL : (02)8667-2078 FAX: (02) 8667-2080

SMD POWER INDUCTORS

MODEL NO. : SPC-0603 SERIES (636CY COMPATIBLE)

FEATURES:

- * SUPERIOR QUALITY FOR AN AUTOMATED PRODUCTION LINE.
- * PICK AND PLACE COMPATIBLE.
- * TAPE AND REEL PACKING.

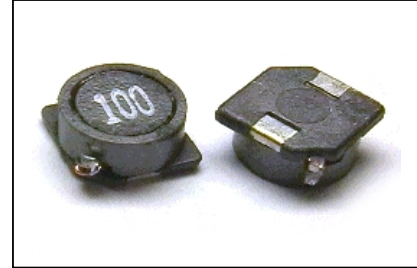

APPLICATION :

- * NOTEBOOK COMPUTERS.
- * DC-DC CONVERTORS.
- * DC-AC INVERTERS.
- * PDA
- * DIGITAL STILL CAMERAS.
- * PC CAMERAS.

ELECTRICAL SPECIFICATION:

| PART NO. | INDUCTANCE (uH) ± 20% | D.C.R. MAX (Ω) | RATED CURRENT (A) |
|--------------|--------------------------|----------------|-------------------|
| SPC-0603-1R0 | 1.0 | 0.019 | 3.12 |
| SPC-0603-1R5 | 1.5 | 0.023 | 2.85 |
| SPC-0603-2R2 | 2.2 | 0.028 | 2.66 |
| SPC-0603-3R3 | 3.3 | 0.035 | 2.26 |
| SPC-0603-4R7 | 4.7 | 0.043 | 1.96 |
| SPC-0603-6R8 | 6.8 | 0.055 | 1.76 |
| SPC-0603-100 | 10 | 0.080 | 1.68 |
| SPC-0603-120 | 12 | 0.090 | 1.52 |
| SPC-0603-150 | 15 | 0.12 | 1.33 |
| SPC-0603-180 | 18 | 0.13 | 1.20 |
| SPC-0603-220 | 22 | 0.18 | 1.07 |
| SPC-0603-270 | 27 | 0.21 | 0.96 |
| SPC-0603-330 | 33 | 0.25 | 0.91 |
| SPC-0603-390 | 39 | 0.28 | 0.77 |
| SPC-0603-470 | 47 | 0.35 | 0.76 |
| SPC-0603-560 | 56 | 0.43 | 0.68 |
| SPC-0603-680 | 68 | 0.52 | 0.61 |
| SPC-0603-820 | 82 | 0.60 | 0.57 |
| SPC-0603-101 | 100 | 0.70 | 0.50 |
| SPC-0603-121 | 120 | 0.89 | 0.49 |
| SPC-0603-151 | 150 | 1.10 | 0.43 |
| SPC-0603-181 | 180 | 1.30 | 0.39 |
| SPC-0603-221 | 220 | 1.60 | 0.35 |
| SPC-0603-271 | 270 | 2.20 | 0.32 |
| SPC-0603-331 | 330 | 2.40 | 0.28 |
| SPC-0603-391 | 390 | 2.60 | 0.26 |
| SPC-0603-471 | 470 | 3.50 | 0.24 |
| SPC-0603-561 | 560 | 3.70 | 0.22 |
| SPC-0603-681 | 680 | 4.20 | 0.19 |
| SPC-0603-821 | 820 | 6.00 | 0.18 |
| SPC-0603-102 | 1000 | 7.20 | 0.16 |

PHYSICAL DIMENSION : (UNIT:mm)

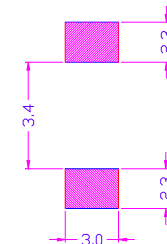
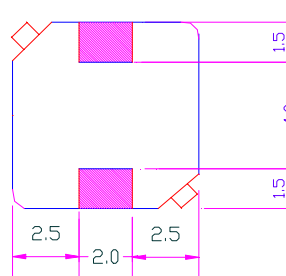
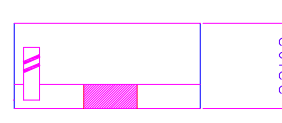
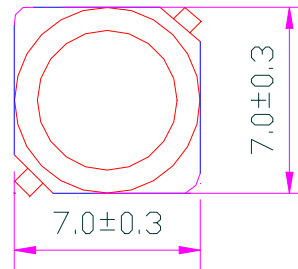

TOLERANCE : ± 0.3

PCB PATTERN

NOTE (1): TEST FREQUENCY: 10 kHz, 1 VRMS.

NOTE (2): THIS INDICATES THE VALUE OF DC CURRENT WHICH THE INDUCTANCE IS 25% LOWER THAN ITS INITIAL VALUE AND/OR ΔT=40°C UNDER THIS DC CURRENT BIAS.



台北沛波電子股份有限公司
 TAIPEI MULTIPower ELECTRONICS CO.,LTD
 2ND. FL.,542-7, CHUNG-CHENG ROAD,
 HSIN-TIEN CITY, TAIPEI, TAIWAN, R.O.C
 TEL : (02)8667-2078 FAX: (02) 8667-2080

SMD POWER INDUCTORS

MODEL NO. : SPC-0605 SERIES (646CY COMPATIBLE)

FEATURES:

- * SUPERIOR QUALITY FOR AN AUTOMATED PRODUCTION LINE.
- * PICK AND PLACE COMPATIBLE.
- * TAPE AND REEL PACKING.



APPLICATION :

- * NOTEBOOK COMPUTERS.
- * DC-DC CONVERTORS.
- * DC-AC INVERTERS.
- * PDA
- * DIGITAL STILL CAMERAS.
- * PC CAMERAS.

ELECTRICAL SPECIFICATION:

PHYSICAL DIMENSION : (UNIT:mm)

| PART NO. | INDUCTANCE (μ H) $\pm 20\%$ | D.C.R. MAX (Ω) | RATED CURRENT (A) |
|--------------|--|-------------------------------|-------------------------|
| SPC-0605-1R0 | 1.0 | 0.020 | 2.88 |
| SPC-0605-1R5 | 1.5 | 0.020 | 2.61 |
| SPC-0605-2R2 | 2.2 | 0.025 | 2.46 |
| SPC-0605-3R3 | 3.3 | 0.035 | 2.28 |
| SPC-0605-4R7 | 4.7 | 0.041 | 2.08 |
| SPC-0605-6R8 | 6.8 | 0.047 | 1.94 |
| SPC-0605-100 | 10 | 0.050 | 1.68 |
| SPC-0605-120 | 12 | 0.055 | 1.54 |
| SPC-0605-150 | 15 | 0.060 | 1.39 |
| SPC-0605-180 | 18 | 0.090 | 1.26 |
| SPC-0605-220 | 22 | 0.11 | 1.13 |
| SPC-0605-270 | 27 | 0.15 | 1.02 |
| SPC-0605-330 | 33 | 0.17 | 0.84 |
| SPC-0605-390 | 39 | 0.18 | 0.80 |
| SPC-0605-470 | 47 | 0.22 | 0.76 |
| SPC-0605-560 | 56 | 0.28 | 0.64 |
| SPC-0605-680 | 68 | 0.32 | 0.60 |
| SPC-0605-820 | 82 | 0.39 | 0.57 |
| SPC-0605-101 | 100 | 0.46 | 0.50 |
| SPC-0605-121 | 120 | 0.52 | 0.47 |
| SPC-0605-151 | 150 | 0.73 | 0.40 |
| SPC-0605-181 | 180 | 0.78 | 0.39 |
| SPC-0605-221 | 220 | 0.94 | 0.33 |
| SPC-0605-271 | 270 | 1.25 | 0.31 |
| SPC-0605-331 | 330 | 1.40 | 0.27 |
| SPC-0605-391 | 390 | 1.52 | 0.27 |
| SPC-0605-471 | 470 | 1.70 | 0.25 |
| SPC-0605-561 | 560 | 2.39 | 0.23 |
| SPC-0605-681 | 680 | 2.50 | 0.21 |
| SPC-0605-821 | 820 | 3.00 | 0.20 |
| SPC-0605-102 | 1000 | 3.50 | 0.18 |

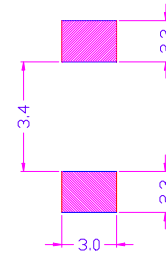
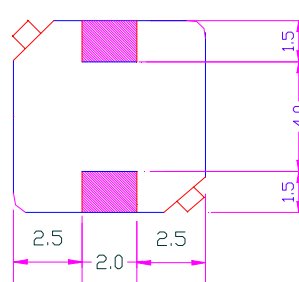
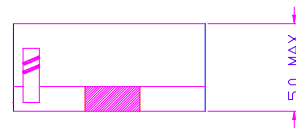
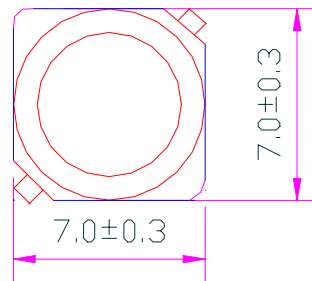

TOLERANCE : ± 0.3

PCB PATTERN

NOTE (1): TEST FREQUENCY: 10 kHz, 1 VRMS.

NOTE (2): THIS INDICATES THE VALUE OF DC CURRENT WHICH THE INDUCTANCE IS 25% LOWER THAN ITS INITIAL VALUE AND/OR $\Delta T=40^{\circ}\text{C}$ UNDER THIS DC CURRENT BIAS.



台北沛波電子股份有限公司
 TAIPEI MULTIPower ELECTRONICS CO.,LTD
 2ND. FL.,542-7, CHUNG-CHENG ROAD,
 HSIN-TIEN CITY, TAIPEI, TAIWAN, R.O.C
 TEL : (02)8667-2078 FAX: (02) 8667-2080

SMD POWER INDUCTORS

MODEL NO. : SPC-06502 SERIES (A918CY COMPATIBLE)

FEATURES:

- * SUPERIOR QUALITY FOR AN AUTOMATED PRODUCTION LINE.
- * PICK AND PLACE COMPATIBLE.
- * TAPE AND REEL PACKING.



APPLICATION :

- * CELLULAR TELEPHONES
- * PDA.
- * DIGITAL STILL CAMERAS.
- * PC CAMERAS. .

ELECTRICAL SPECIFICATION:

(UNIT:mm)

| PART NO | INDUCTANCE (μ H) \pm 20 % | D.C.R. MAX (Ω) | RATED CURRENT (ADC) |
|---------------|--|-------------------------------|---------------------------|
| SPC-06502-1R0 | 1.0 | 0.016 | 3.48 |
| SPC-06502-1R5 | 1.5 | 0.021 | 2.94 |
| SPC-06502-2R0 | 2.0 | 0.028 | 2.33 |
| SPC-06502-3R3 | 3.3 | 0.047 | 1.97 |
| SPC-06502-4R7 | 4.7 | 0.065 | 1.54 |
| SPC-06502-6R2 | 6.2 | 0.074 | 1.45 |
| SPC-06502-8R2 | 8.2 | 0.102 | 1.23 |
| SPC-06502-100 | 10 | 0.118 | 1.09 |
| SPC-06502-120 | 12 | 0.153 | 0.99 |
| SPC-06502-150 | 15 | 0.179 | 0.82 |
| SPC-06502-180 | 18 | 0.207 | 0.83 |
| SPC-06502-220 | 22 | 0.280 | 0.74 |
| SPC-06502-270 | 27 | 0.330 | 0.65 |
| SPC-06502-330 | 33 | 0.368 | 0.61 |
| SPC-06502-390 | 39 | 0.473 | 0.55 |
| SPC-06502-470 | 47 | 0.542 | 0.50 |

PHYSICAL DIMENSION :

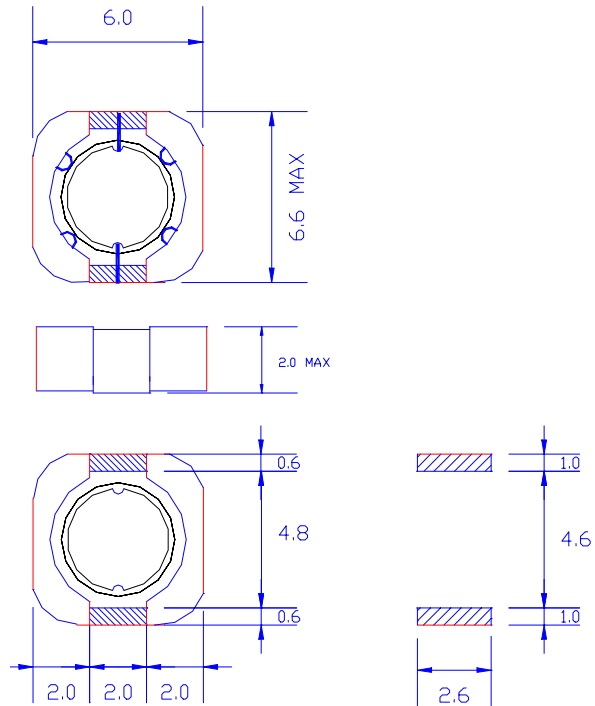

TOLERANCE : \pm 0.3

PCB PATTERN

NOTE (1): TEST FREQUENCY: 100KHZ,1VRMS.

NOTE (2): THIS INDICATES THE VALUE OF DC CURRENT WHICH THE INDUCTANCE IS 30% LOWER THAN ITS INITIAL VALUE AND/OR $\Delta T=40^{\circ}\text{C}$ UNDER THIS DC CURRENT BIAS.



台北沛波電子股份有限公司
 TAIPEI MULTIPOWER ELECTRONICS CO.,LTD
 2ND. FL.,542-7, CHUNG-CHENG ROAD,
 HSIN-TIEN CITY, TAIPEI, TAIWAN, R.O.C
 TEL : (02)8667-2078 FAX: (02) 8667-2080

SMD POWER INDUCTORS

MODEL NO. : SPC-06503 SERIES (A920CY COMPATIBLE)

FEATURES:

- * SUPERIOR QUALITY FOR AN AUTOMATED PRODUCTION LINE.
- * PICK AND PLACE COMPATIBLE.
- * TAPE AND REEL PACKING.

APPLICATION :

- * NOTEBOOK COMPUTERS.
- * DC-DC CONVERTORS.
- * PDA.
- * DIGITAL STILL CAMERAS.



ELECTRICAL SPECIFICATION:

(UNIT:mm)

| PART NO | INDUCTANCE (uH) ± 20 % | D.C.R. MAX (Ω) | RATED CURRENT (ADC) | TEMPERATURE RISE CURRENT (ADC) MAX |
|---------------|------------------------------|----------------------|---------------------------|--|
| SPC-06503-1R0 | 1.0 | 0.013 | 3.48 | 3.84 |
| SPC-06503-1R5 | 1.5 | 0.017 | 2.93 | 3.40 |
| SPC-06503-2R0 | 2.0 | 0.020 | 2.44 | 3.10 |
| SPC-06503-3R3 | 3.3 | 0.028 | 2.00 | 2.55 |
| SPC-06503-4R3 | 4.3 | 0.037 | 1.65 | 2.23 |
| SPC-06503-6R2 | 6.2 | 0.050 | 1.50 | 1.85 |
| SPC-06503-100 | 10 | 0.074 | 1.16 | 1.48 |
| SPC-06503-120 | 12 | 0.086 | 1.05 | 1.35 |
| SPC-06503-150 | 15 | 0.100 | 0.87 | 1.24 |
| SPC-06503-180 | 18 | 0.125 | 0.88 | 1.11 |
| SPC-06503-220 | 22 | 0.150 | 0.80 | 1.00 |
| SPC-06503-270 | 27 | 0.195 | 0.70 | 0.86 |
| SPC-06503-330 | 33 | 0.224 | 0.66 | 0.80 |
| SPC-06503-390 | 39 | 0.280 | 0.60 | 0.70 |
| SPC-06503-470 | 47 | 0.330 | 0.55 | 0.63 |
| SPC-06503-560 | 56 | 0.395 | 0.50 | 0.58 |
| SPC-06503-680 | 68 | 0.450 | 0.45 | 0.53 |
| SPC-06503-820 | 82 | 0.530 | 0.40 | 0.49 |

PHYSICAL DIMENSION :

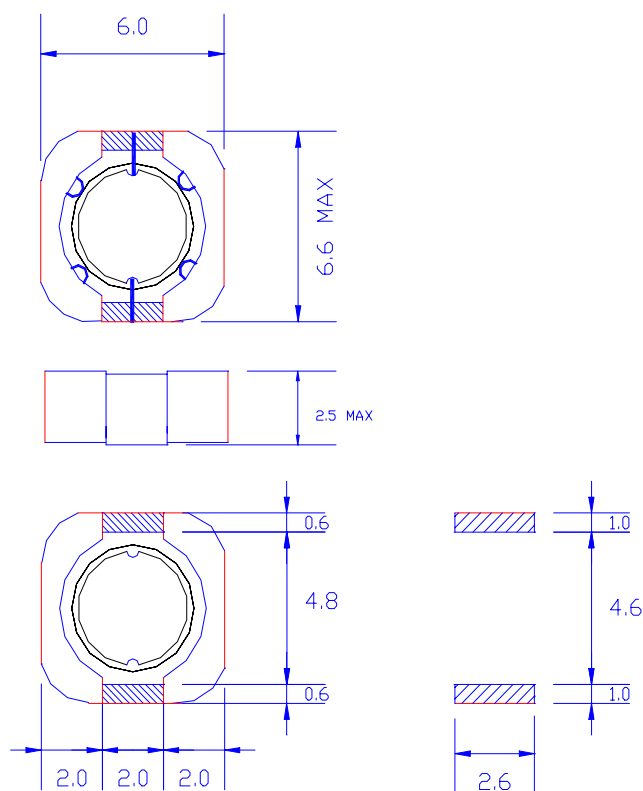

TOLERANCE : ± 0.3

PCB PATTERN

NOTE (1): TEST FREQUENCY: 100KHZ,1VRMS.

NOTE (2): THIS INDICATES THE VALUE OF DC CURRENT WHICH THE INDUCTANCE IS 30% LOWER THAN ITS INITIAL VALUE AND/OR ΔT=40°C UNDER THIS DC CURRENT BIAS.

台北沛波電子股份有限公司
 TAIPEI MULTIPower ELECTRONICS CO.,LTD
 2ND. FL.,542-7, CHUNG-CHENG ROAD,
 HSIN-TIEN CITY, TAIPEI, TAIWAN, R.O.C
 TEL : (02)8667-2078 FAX: (02) 8667-2080

SMD POWER INDUCTORS

MODEL NO. : SPC-06703 SERIES(CDRH6D28 COMPATIBLE)

FEATURES:

- * SUPERIOR QUALITY FOR AN AUTOMATED PRODUCTION LINE.
- * PICK AND PLACE COMPATIBLE.
- * TAPE AND REEL PACKING.



APPLICATION :

- * NOTEBOOK COMPUTERS . * DC-DC CONVERTORS. * DC-AC INVERTERS.
- * PDA * DIGITAL STILL CAMERAS. * PC CAMERAS.

ELECTRICAL SPECIFICATION:

| PART NO | INDUCTANCE (uH) ± 20% | DCR MAX (Ω) | RATED CURRENT (A) |
|---------------|-----------------------|-------------|-------------------|
| SPC-06703-100 | 10 | 0.054 | 1.83 |
| SPC-06703-220 | 22 | 0.125 | 1.24 |
| SPC-06703-470 | 47 | 0.250 | 0.85 |
| SPC-06703-101 | 100 | 0.510 | 0.58 |

PHYSICAL DIMENSION : (UNIT:mm)

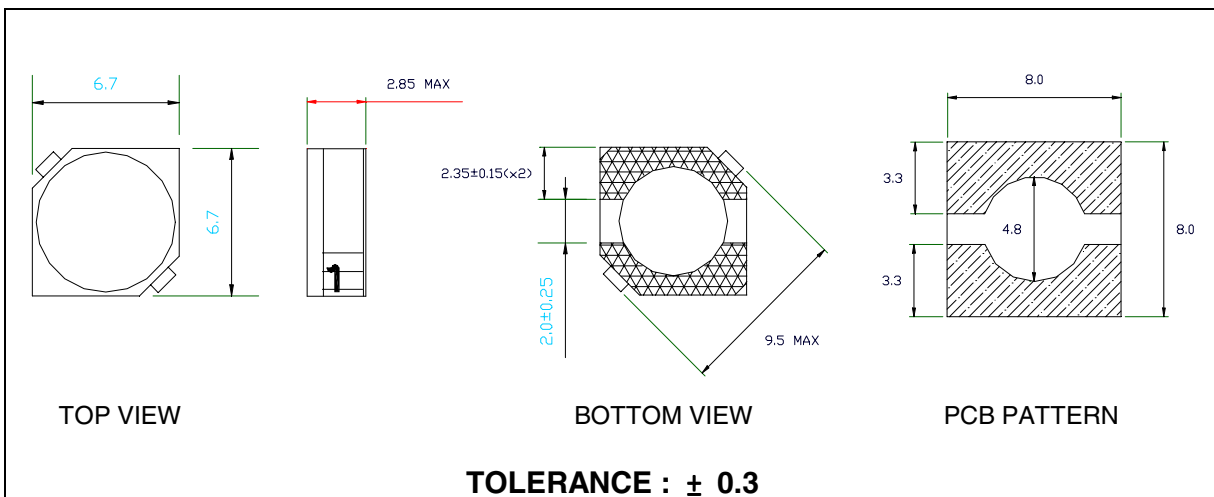

NOTE(1): TEST FREQUENCY:100 KHZ ,1VRMS.

NOTE (2): THIS INDICATES THE VALUE OF DC CURRENT WHICH THE INDUCTANCE IS 25% LOWER THAN ITS INITIAL VALUE AND/OR ΔT=40°C UNDER THIS DC CURRENT BIAS.

TMP 台北沛波電子股份有限公司
 TAIPEI MULTIPower ELECTRONICS CO.,LTD
 2ND. FL.,542-7, CHUNG-CHENG ROAD,
 HSIN-TIEN CITY, TAIPEI, TAIWAN, R.O.C
 TEL : (02)8667-2078 FAX: (02) 8667-2080

SMD POWER INDUCTORS

MODEL NO. : SPC-06704 SERIES(CDRH6D38 COMPATIBLE)

FEATURES:

- * SUPERIOR QUALITY FOR AN AUTOMATED PRODUCTION LINE.
- * PICK AND PLACE COMPATIBLE.
- * TAPE AND REEL PACKING.



APPLICATION :

- * NOTEBOOK COMPUTERS . * DC-DC CONVERTORS. * DC-AC INVERTERS.
- * PDA * DIGITAL STILL CAMERAS. * PC CAMERAS.

ELECTRICAL SPECIFICATION:

| PART NO | INDUCTANCE (uH) \pm 30% | DCR MAX (Ω) | RATED CURRENT (A) |
|---------------|------------------------------|----------------------------|-------------------------|
| SPC-06704-5R0 | 5.0 | 0.025 | 2.90 |
| SPC-06704-100 | 10 | 0.038 | 2.20 |
| SPC-06704-220 | 22 | 0.100 | 1.50 |
| SPC-06704-470 | 47 | 0.230 | 1.00 |
| SPC-06704-101 | 100 | 0.358 | 0.62 |

PHYSICAL DIMENSION : (UNIT:mm)

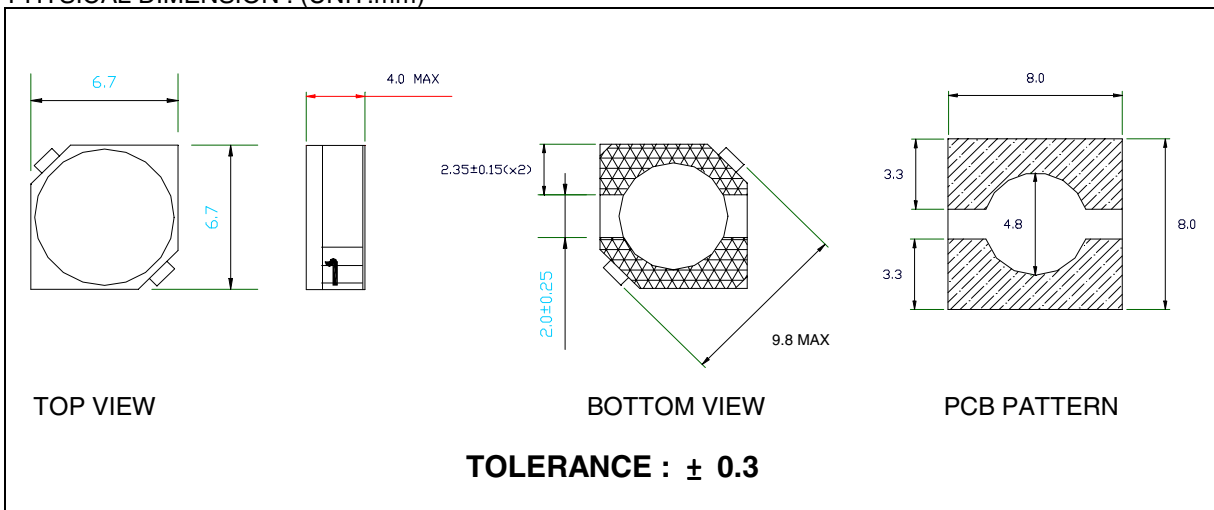

NOTE (1): TEST FREQUENCY: 100KHZ,1VRMS.

NOTE (2): THIS INDICATES THE VALUE OF DC CURRENT WHICH THE INDUCTANCE IS 35% LOWER THAN ITS INITIAL VALUE AND/OR $\Delta T=40^{\circ}C$ UNDER THIS DC CURRENT BIAS.



台北沛波電子股份有限公司
 TAIPEI MULTIPower ELECTRONICS CO.,LTD
 2ND. FL.,542-7, CHUNG-CHENG ROAD,
 HSIN-TIEN CITY, TAIPEI, TAIWAN, R.O.C
 TEL : (02)8667-2078 FAX: (02) 8667-2080

SMD POWER INDUCTORS

MODEL NO. : SPC-0703 SERIES (CDRH73 COMPATIBLE)

FEATURES:

- * SUPERIOR QUALITY FROM AN AUTOMATED PRODUCTION LINE.
- * PICK AND PLACE COMPATIBLE.
- * TAPE AND REEL PACKING.

APPLICATION :

- * NOTEBOOK COMPUTERS.
- * DC-DC CONVERTORS.
- *DC-AC INVERTERS.

ELECTRICAL SPECIFICATION:

| PART NO. | INDUCTANCE (uH) $\pm 20\%$ | D.C.R. MAX (Ω) | RATED CURRENT (A) |
|--------------|----------------------------|-------------------------|-------------------|
| SPC-0703-100 | 10 | 0.072 | 1.68 |
| SPC-0703-120 | 12 | 0.098 | 1.52 |
| SPC-0703-150 | 15 | 0.13 | 1.33 |
| SPC-0703-180 | 18 | 0.14 | 1.2 |
| SPC-0703-220 | 22 | 0.19 | 1.07 |
| SPC-0703-270 | 27 | 0.21 | 0.96 |
| SPC-0703-330 | 33 | 0.24 | 0.91 |
| SPC-0703-390 | 39 | 0.32 | 0.77 |
| SPC-0703-470 | 47 | 0.36 | 0.76 |
| SPC-0703-560 | 56 | 0.47 | 0.68 |
| SPC-0703-680 | 68 | 0.52 | 0.61 |
| SPC-0703-820 | 82 | 0.69 | 0.57 |
| SPC-0703-101 | 100 | 0.79 | 0.50 |
| SPC-0703-121 | 120 | 0.89 | 0.49 |
| SPC-0703-151 | 150 | 1.27 | 0.43 |
| SPC-0703-181 | 180 | 1.45 | 0.39 |
| SPC-0703-221 | 220 | 1.65 | 0.35 |
| SPC-0703-271 | 270 | 2.31 | 0.32 |
| SPC-0703-331 | 330 | 2.62 | 0.28 |
| SPC-0703-391 | 390 | 2.94 | 0.26 |
| SPC-0703-471 | 470 | 4.18 | 0.24 |
| SPC-0703-561 | 560 | 4.67 | 0.22 |
| SPC-0703-681 | 680 | 5.73 | 0.19 |
| SPC-0703-821 | 820 | 6.54 | 0.18 |
| SPC-0703-102 | 1000 | 9.44 | 0.16 |

PHYSICAL DIMENSION : (UNIT:mm)

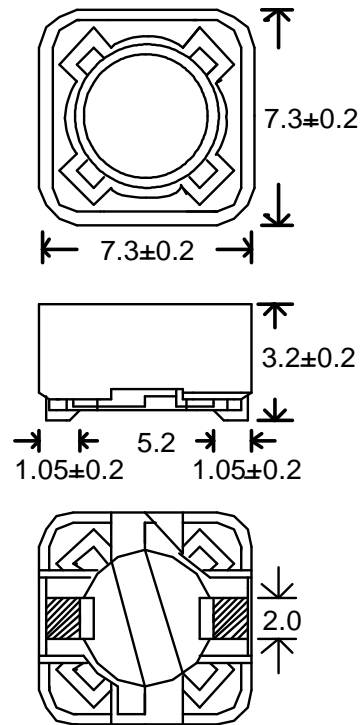

TOLERANCE: ± 0.3

NOTE(1):TEST FREQUENCY: 1KHz,1VRMS.

NOTE(2):AT VALUE OF INDUCTANCE WHEN IS 75% DOWN FROM FIRST VALUE AS CHARACTERISTICS OF D.C. CURRENT WHEN TEMPERATURE OF COIL INCREASED UP TO 40°C.(Ta=20°C)



台北沛波電子股份有限公司

TAIPEI MULTIPower ELECTRONIC CO., LTD.

2ND. FL., 542-7, CHUNG-CHENG ROAD,
HSIN-TIEN CITY, TAIPEI, TAIWAN, R.O.C.

TEL: (02)8667-2078 FAX: (02)8667-2080

PACKING

Tape and Reel Orientation

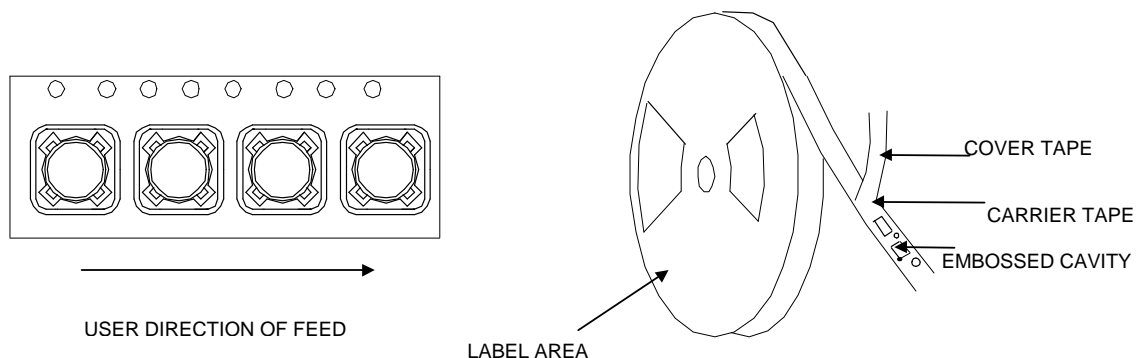

NOTE : Top view shown with cover tape removed.

| TAPE WIDTH | REEL WIDTH | COMPONENT PITCH | UNITS PER REEL |
|------------|------------|-----------------|----------------|
| 16mm | 22.4mm | 12mm | 1500 |

TAPE SPECIFICATIONS:

Carrier Tape Type : Conductive.

Cover Tape Type : Antistatic.

Cover Tape Adhesion to Carrier : 10 - 70 grams.

REEL SPECIFICATIONS:

Diameter (flange) : 13" (330.2mm)

STANDARDS : All embossed carrier tape packaging will be accomplished in compliance with latest revision of EIA-481 "Taping of surface Mount Components for Automatic Placement".

ENVIRONMENTAL PERFORMANCE

| ITEM | TEST | CONDITION |
|------|-----------------------|--|
| 1 | Thermal Shock | one cycle shall consist of : (1) 30 minutes at temperature -30°C. (2) 15 seconds maximum at room ambient. (3) 30 minutes at temperature +85°C. (4) 15 seconds maximum at room ambient. Subject samples to 10 cycles. Test per applicable devices specification after a 4 hours stabilization at room ambient. |
| 2 | Vibration | Inductance deviation within $\pm 3.0\%$ after vibration for 1 hour. In each of three orientations at sweep vibration (10~50~10Hz) with 1.5mm P-P amplitude. |
| 3 | Solderability | Solder pot at $230^{\circ}\text{C} \pm 5^{\circ}\text{C}$, with kester 1544 solder flux. Dip parts into solder pot containing 63/37 molten alloy for 5 second ± 1 second. Wetting must occur on a minimum of 90% of the terminations. |
| 4 | Operating Temperature | -25°C ~ +80°C (coil contain heat). |
| 5 | Humidity | Inductance deviation within $\pm 5.0\%$. After 96 hour in 90~95% relative humidity at $40 \pm 2^{\circ}\text{C}$ and 1 hour drying under normal condition. |
| 6 | Mechanical Shock | Inductance deviation within $\pm 3.0\%$ after drop down with 981m/s^2 (100G) shock. Attitude upon a rubber block method shock testing machine, for 1 time, in each of three orientations. |

SMD POWER INDUCTORS

MODEL NO. : SPC-0704P ERIES (CDRH74 COMPATIBLE)

FEATURES:

- * SUPERIOR QUALITY FOR AN AUTOMATED PRODUCTION LINE.
- * PICK AND PLACE COMPATIBLE.
- * TAPE AND REEL PACKING.



APPLICATION :

- * NOTEBOOK COMPUTERS.
- * DC-DC CONVERTORS.
- * DC-AC INVERTERS.
- * PDA.
- * DIGITAL STILL CAMERAS.
- * PC CAMERAS.

ELECTRICAL SPECIFICATION:

PHYSICAL DIMENSION :

(UNIT:mm)

| PART NO. | INDUCTANCE (uH) ± 20% | D.C.R. MAX (Ω) | RATED CURRENT (A) |
|---------------|-----------------------------|----------------------|-------------------------|
| SPC-0704P-100 | 10 | 0.049 | 1.84 |
| SPC-0704P-120 | 12 | 0.058 | 1.71 |
| SPC-0704P-150 | 15 | 0.081 | 1.47 |
| SPC-0704P-180 | 18 | 0.090 | 1.31 |
| SPC-0704P-220 | 22 | 0.11 | 1.23 |
| SPC-0704P-270 | 27 | 0.15 | 1.12 |
| SPC-0704P-330 | 33 | 0.17 | 0.96 |
| SPC-0704P-390 | 39 | 0.23 | 0.91 |
| SPC-0704P-470 | 47 | 0.26 | 0.88 |
| SPC-0704P-560 | 56 | 0.35 | 0.75 |
| SPC-0704P-680 | 68 | 0.38 | 0.69 |
| SPC-0704P-820 | 82 | 0.43 | 0.61 |
| SPC-0704P-101 | 100 | 0.61 | 0.60 |
| SPC-0704P-121 | 120 | 0.66 | 0.52 |
| SPC-0704P-151 | 150 | 0.88 | 0.46 |
| SPC-0704P-181 | 180 | 0.98 | 0.42 |
| SPC-0704P-221 | 220 | 1.17 | 0.36 |
| SPC-0704P-271 | 270 | 1.64 | 0.34 |
| SPC-0704P-331 | 330 | 1.86 | 0.32 |
| SPC-0704P-391 | 390 | 2.85 | 0.29 |
| SPC-0704P-471 | 470 | 3.01 | 0.26 |
| SPC-0704P-561 | 560 | 3.62 | 0.23 |
| SPC-0704P-681 | 680 | 4.63 | 0.22 |
| SPC-0704P-821 | 820 | 5.20 | 0.20 |
| SPC-0704P-102 | 1000 | 6.00 | 0.18 |

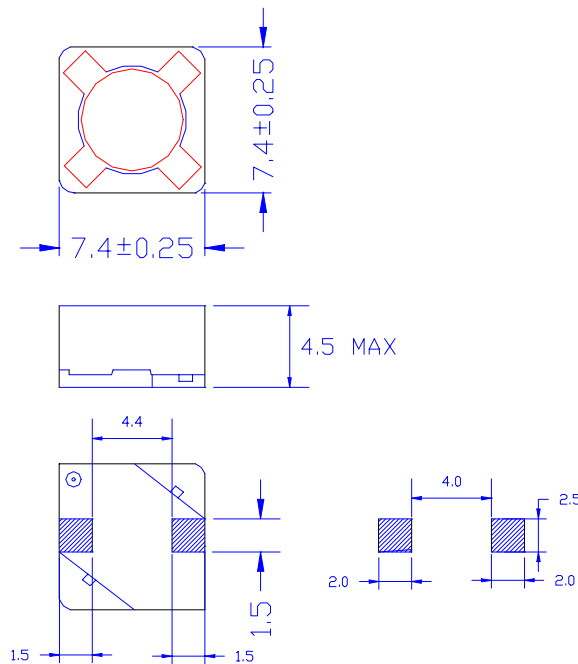

TOLERANCE : ± 0.3

PCB PATTERN

NOTE(1):TEST FREQUENCY: 1 kHz,1 VRMS.

NOTE(2):THIS INDICATES THE VALUE OF DC CURRENT WHICH THE INDUCTANCE IS 10% LOWER THAN ITS INITIAL VALUE AND/OR • T = 40°C UNDER THIS DC CURRENT BIAS.



台北沛波電子股份有限公司
 TAIPEI MULTIPOWER ELECTRONICS CO.,LTD
 2ND. FL.,542-7, CHUNG-CHENG ROAD,
 HSIN-TIEN CITY, TAIPEI, TAIWAN, R.O.C
 TEL : (02)8667-2078 FAX: (02) 8667-2080

SMD POWER INDUCTORS

MODEL NO. : SPC-0905 SERIES (CDR105B COMPATIBLE)

FEATURES:

* SUPERIOR QUALITY FROM AN
AUTOMATED PRODUCTION LINE.

* PICK AND PLACE COMPATIBLE.

* TAPE AND REEL PACKING.

APPLICATION :

* NOTEBOOK COMPUTERS.

* DC-DC CONVERTORS. *DC-AC INVERTERS.



ELECTRICAL SPECIFICATION:

| PART NO. | INDUCTANCE (uH) | D.C.R. MAX (Ω) | RATED CURRENT (A) |
|--------------|-----------------|----------------|-------------------|
| SPC-0905-100 | 10 | 0.06 | 2.06 |
| SPC-0905-120 | 12 | 0.07 | 1.94 |
| SPC-0905-150 | 15 | 0.07 | 1.72 |
| SPC-0905-180 | 18 | 0.08 | 1.58 |
| SPC-0905-220 | 22 | 0.08 | 1.42 |
| SPC-0905-270 | 27 | 0.10 | 1.32 |
| SPC-0905-330 | 33 | 0.11 | 1.16 |
| SPC-0905-390 | 39 | 0.12 | 1.10 |
| SPC-0905-470 | 47 | 0.14 | 1.00 |
| SPC-0905-560 | 56 | 0.19 | 0.93 |
| SPC-0905-680 | 68 | 0.21 | 0.85 |
| SPC-0905-820 | 82 | 0.28 | 0.79 |
| SPC-0905-101 | 100 | 0.34 | 0.72 |
| SPC-0905-121 | 120 | 0.37 | 0.63 |
| SPC-0905-151 | 150 | 0.51 | 0.55 |
| SPC-0905-181 | 180 | 0.57 | 0.50 |
| SPC-0905-221 | 220 | 0.78 | 0.47 |
| SPC-0905-271 | 270 | 0.87 | 0.41 |
| SPC-0905-331 | 330 | 1.20 | 0.37 |
| SPC-0905-391 | 390 | 1.34 | 0.35 |
| SPC-0905-471 | 470 | 1.50 | 0.33 |

PHYSICAL DIMENSION : (UNIT:mm)

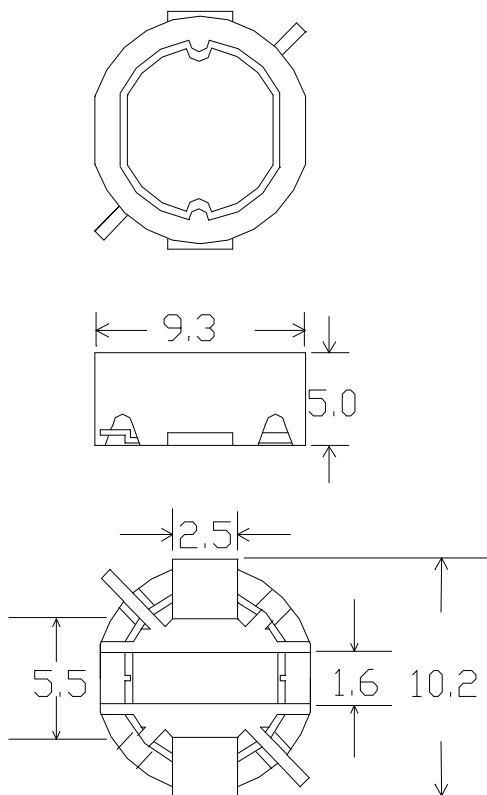

TOLERANCE: ±0.3

NOTE(1):TEST FREQUENCY: 100KHz,1VRMS.

NOTE(2):10~27uH ±20%, 33~82uH ±15%, 100~470uH ±10%.

NOTE(3):THIS INDICATES THE VALUE OF CURRENT WHEN THE INDUCTANCE IS 10% LOWER THAN ITS INITIAL VALUE AT D.C. CURRENT WHEN AT ΔT=40°C WHICHEVER IS LOWER.

TMP

台北沛波電子股份有限公司

TAIPEI MULTIPower ELECTRONIC CO., LTD.
2ND. FL., 542-7, CHUNG-CHENG ROAD,
HSIN-TIEN CITY, TAIPEI, TAIWAN, R.O.C.
TEL: (02)8667-2078 FAX: (02)8667-2080

PACKING

Tape and Reel Orientation

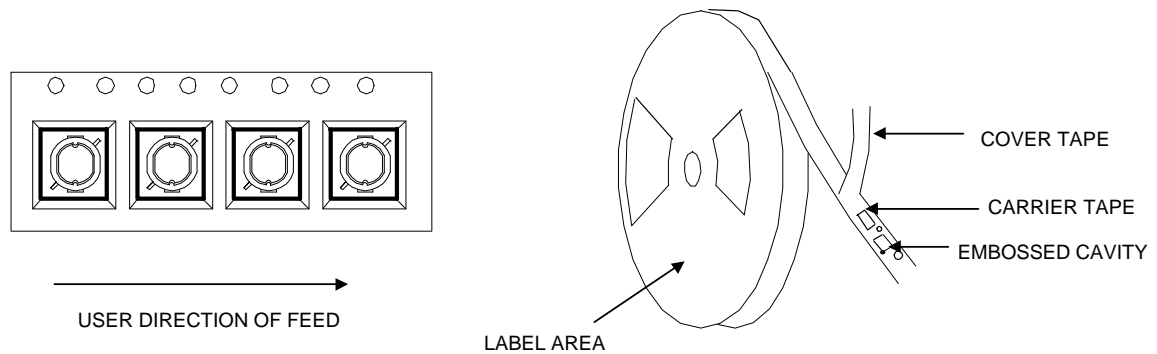

NOTE : Top view shown with cover tape removed.

| TAPE WIDTH | REEL WIDTH | COMPONENT PITCH | UNITS PER REEL |
|------------|------------|-----------------|----------------|
| 24mm | 32mm | 16mm | 800 |

TAPE SPECIFICATIONS:

Carrier Tape Type : Conductive.

Cover Tape Type : Antistatic.

Cover Tape Adhesion to Carrier : 10 - 70 grams.

REEL SPECIFICATIONS:

Diameter (flange) : 13" (330.2mm)

STANDARDS : All embossed carrier tape packaging will be accomplished in compliance with latest revision of EIA-481 "Taping of surface Mount Components for Automatic Placement".

ENVIRONMENTAL PERFORMANCE

| ITEM | TEST | CONDITION |
|------|-----------------------|--|
| 1 | Thermal Shock | one cycle shall consist of : (1) 30 minutes at temperature -30°C. (2) 15 seconds maximum at room ambient. (3) 30 minutes at temperature +85°C. (4) 15 seconds maximum at room ambient. Subject samples to 10 cycles. Test per applicable devices specification after a 4 hours stabilization at room ambient. |
| 2 | Vibration | Inductance deviation within $\pm 3.0\%$ after vibration for 1 hour. In each of three orientations at sweep vibration (10-50-10Hz) with 1.5mm P-P amplitude. |
| 3 | Solderability | Solder pot at $230^{\circ}\text{C} \pm 5^{\circ}\text{C}$, with kester 1544 solder flux. Dip parts into solder pot containing 63/37 molten alloy for 5 second ± 1 second. Wetting must occur on a minimum of 90% of the terminations. |
| 4 | Operating Temperature | -25°C ~ +80°C (coil contain heat). |
| 5 | Humidity | Inductance deviation within $\pm 5.0\%$. After 96 hour in 90-95% relative humidity at $40 \pm 2^{\circ}\text{C}$ and 1 hour drying under normal condition. |
| 6 | Mechanical Shock | Inductance deviation within $\pm 5.0\%$ after drop down with 981m/s^2 (100G) shock. Attitude upon a rubber block method shock testing machine, for 1 time, in each of three orientations. |

SMD POWER INDUCTORS

MODEL NO. : SPC-1002 SERIES

FEATURES:

- * SUPERIOR QUALITY FOR AN AUTOMATED PRODUCTION LINE.
- * PICK AND PLACE COMPATIBLE.
- * TAPE AND REEL PACKING.

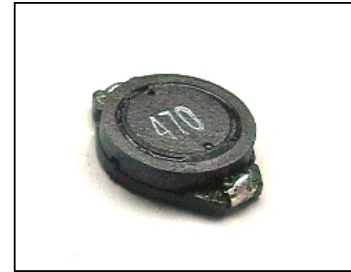

APPLICATION :

- * NOTEBOOK COMPUTERS.
- * DC-DC CONVERTORS.
- *DC-AC INVERTERS.

ELECTRICAL SPECIFICATION:

| PART NO. | INDUCTANCE (μH) \pm 20% | D.C.R. MAX (Ω) | Isat (ADC) | Irms (Arms) |
|--------------|---|-------------------------------|---------------|----------------|
| SPC-1002-2R2 | 2.2 | 0.045 | 3.40 | 2.76 |
| SPC-1002-4R7 | 4.7 | 0.078 | 2.30 | 1.90 |
| SPC-1002-7R5 | 7.5 | 0.100 | 1.70 | 1.44 |
| SPC-1002-100 | 10 | 0.145 | 1.50 | 1.24 |
| SPC-1002-150 | 15 | 0.200 | 1.20 | 1.02 |
| SPC-1002-220 | 22 | 0.300 | 1.00 | 0.80 |
| SPC-1002-330 | 33 | 0.450 | 0.85 | 0.70 |
| SPC-1002-470 | 47 | 0.650 | 0.72 | 0.60 |
| SPC-1002-680 | 68 | 0.800 | 0.58 | 0.48 |
| SPC-1002-101 | 100 | 1.400 | 0.48 | 0.40 |
| SPC-1002-151 | 150 | 1.800 | 0.40 | 0.32 |
| SPC-1002-221 | 220 | 2.200 | 0.32 | 0.26 |

PHYSICAL DIMENSION : (UNIT:mm)

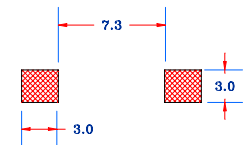
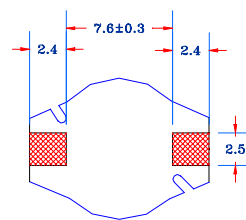
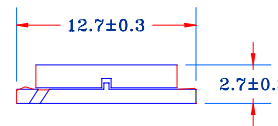
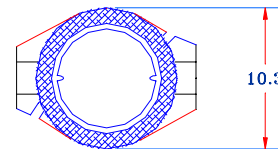

TOLERANCE : \pm 0.20

PCB PATTERN

NOTE (1): TEST FREQUENCY: 1 kHz, 1 VRMS.

NOTE (2): THIS INDICATES THE VALUE OF DC CURRENT WHICH THE INDUCTANCE IS 10% LOWER THAN ITS INITIAL VALUE AND/OR $\Delta T=40^{\circ}\text{C}$ UNDER THIS DC CURRENT BIAS.



台北沛波電子股份有限公司
 TAIPEI MULTIPower ELECTRONICS CO.,LTD
 2ND. FL.,542-7, CHUNG-CHENG ROAD,
 HSIN-TIEN CITY, TAIPEI, TAIWAN, R.O.C
 TEL : (02)8667-2078 FAX: (02) 8667-2080

SMD POWER INDUCTORS

MODEL NO. : SPC-1003P SERIES

FEATURES:

- * SUPERIOR QUALITY FOR AN AUTOMATED PRODUCTION LINE.
- * PICK AND PLACE COMPATIBLE.
- * TAPE AND REEL PACKING.



APPLICATION :

- * NOTEBOOK COMPUTERS.
- * DC-DC CONVERTORS.
- *DC-AC INVERTERS.

ELECTRICAL SPECIFICATION:

PHYSICAL DIMENSION :

(UNIT:mm)

| PART NO. | INDUCTANCE (uH) ± 20% | D.C.R. MAX (Ω) | RATED CURRENT (A) |
|---------------|-----------------------|----------------|-------------------|
| SPC-1003P-100 | 10 | 0.11 | 2.4 |
| SPC-1003P-150 | 15 | 0.15 | 2.0 |
| SPC-1003P-220 | 22 | 0.23 | 1.6 |
| SPC-1003P-330 | 33 | 0.30 | 1.4 |
| SPC-1003P-470 | 47 | 0.39 | 1.0 |
| SPC-1003P-560 | 56 | 0.40 | 0.9 |
| SPC-1003P-680 | 68 | 0.50 | 0.9 |
| SPC-1003P-101 | 100 | 0.90 | 0.7 |
| SPC-1003P-151 | 150 | 1.2 | 0.6 |
| SPC-1003P-221 | 220 | 1.9 | 0.5 |
| SPC-1003P-331 | 330 | 2.7 | 0.4 |
| SPC-1003P-471 | 470 | 4.0 | 0.3 |
| SPC-1003P-681 | 680 | 5.3 | 0.2 |
| SPC-1003P-102 | 1000 | 8.4 | 0.1 |

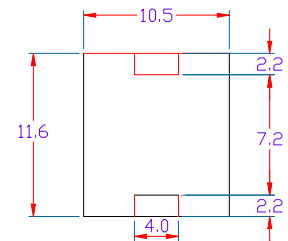
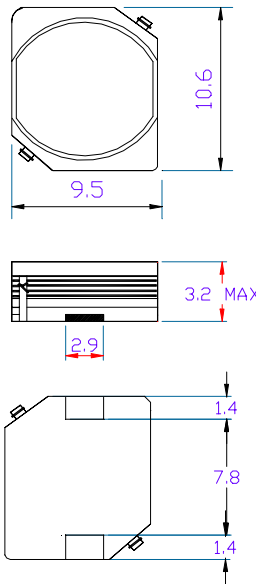

TOLERANCE : ± 0.3

PCB PATTERN

NOTE(1):TEST FREQUENCY: 100 kHz,1 VRMS.

NOTE (2): THIS INDICATES THE VALUE OF DC CURRENT WHICH THE INDUCTANCE IS 10% LOWER THAN ITS INITIAL VALUE AND/OR ΔT=40°C UNDER THIS DC CURRENT BIAS.



台北沛波電子股份有限公司
 TAIPEI MULTIPower ELECTRONICS CO.,LTD
 2ND. FL.,542-7, CHUNG-CHENG ROAD,
 HSIN-TIEN CITY, TAIPEI, TAIWAN, R.O.C
 TEL : (02)8667-2078 FAX: (02) 8667-2080

SMD POWER INDUCTORS

MODEL NO. : SPC-1004P SERIES (CD104 COMPATIBLE)

FEATURES:

- * SUPERIOR QUALITY FOR AN AUTOMATED PRODUCTION LINE.
- * PICK AND PLACE COMPATIBLE.
- * TAPE AND REEL PACKING.



APPLICATION :

- * NOTEBOOK COMPUTERS.
- * DC-DC CONVERTORS.
- *DC-AC INVERTERS.

ELECTRICAL SPECIFICATION:

(UNIT:mm)

| PART NO. | INDUCTANCE (uH) | D.C.R. MAX (Ω) | RATED CURRENT (A) |
|---------------|-----------------|----------------|-------------------|
| SPC-1004P-100 | 10 | 0.05 | 2.38 |
| SPC-1004P-120 | 12 | 0.06 | 2.13 |
| SPC-1004P-150 | 15 | 0.07 | 1.87 |
| SPC-1004P-180 | 18 | 0.08 | 1.73 |
| SPC-1004P-220 | 22 | 0.09 | 1.60 |
| SPC-1004P-270 | 27 | 0.12 | 1.44 |
| SPC-1004P-330 | 33 | 0.15 | 1.26 |
| SPC-1004P-390 | 39 | 0.17 | 1.20 |
| SPC-1004P-470 | 47 | 0.19 | 1.10 |
| SPC-1004P-560 | 56 | 0.22 | 1.01 |
| SPC-1004P-680 | 68 | 0.25 | 0.91 |
| SPC-1004P-820 | 82 | 0.30 | 0.85 |
| SPC-1004P-101 | 100 | 0.37 | 0.74 |
| SPC-1004P-121 | 120 | 0.45 | 0.69 |
| SPC-1004P-151 | 150 | 0.54 | 0.61 |
| SPC-1004P-181 | 180 | 0.62 | 0.56 |
| SPC-1004P-221 | 220 | 0.72 | 0.53 |
| SPC-1004P-271 | 270 | 0.95 | 0.45 |
| SPC-1004P-331 | 330 | 1.10 | 0.42 |
| SPC-1004P-391 | 390 | 1.24 | 0.38 |
| SPC-1004P-471 | 470 | 1.53 | 0.35 |
| SPC-1004P-561 | 560 | 1.90 | 0.32 |

PHYSICAL DIMENSION :

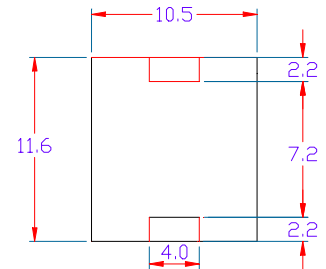
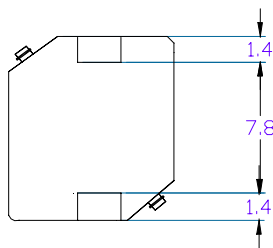
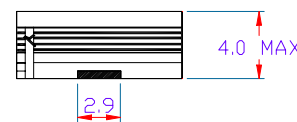
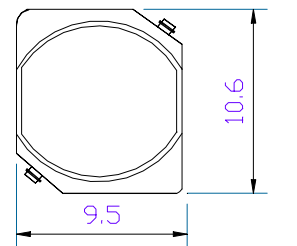

TOLERANCE :± 0.3

PCB PATTERN

NOTE(1) :TEST FREQUENCY: 100 kHz,1 VRMS.

NOTE(2) : 10~47uH ± 20% , 56~560uH ± 10%.

NOTE (3): THIS INDICATES THE VALUE OF DC CURRENT WHICH THE INDUCTANCE IS 10% LOWER THAN ITS INITIAL VALUE AND/OR ΔT=40°C UNDER THIS DC CURRENT BIAS.



台北沛波電子股份有限公司
TAIPEI MULTIPOWER ELECTRONICS CO.,LTD
2ND. FL.,542-7, CHUNG-CHENG ROAD,
HSIN-TIEN CITY, TAIPEI, TAIWAN, R.O.C
TEL : (02)8667-2078 FAX: (02) 8667-2080

SMD POWER INDUCTORS

MODEL NO. : SPC-1005P SERIES (CD105 COMPATIBLE)

FEATURES:

- * SUPERIOR QUALITY FOR AN AUTOMATED PRODUCTION LINE.
- * PICK AND PLACE COMPATIBLE.
- * TAPE AND REEL PACKING.

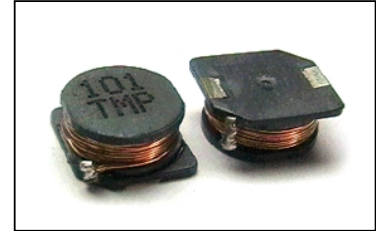

APPLICATION :

- * NOTEBOOK COMPUTERS.
- * DC-DC CONVERTORS.
- *DC-AC INVERTERS.

ELECTRICAL SPECIFICATION: PHYSICAL DIMENSION : (UNIT:mm)

| PART NO. | INDUCTANCE (uH) | D.C.R. MAX (Ω) | RATED CURRENT (A) |
|---------------|-----------------|----------------|-------------------|
| SPC-1005P-100 | 10 | 0.06 | 2.60 |
| SPC-1005P-120 | 12 | 0.07 | 2.45 |
| SPC-1005P-150 | 15 | 0.08 | 2.27 |
| SPC-1005P-180 | 18 | 0.09 | 2.15 |
| SPC-1005P-220 | 22 | 0.10 | 1.95 |
| SPC-1005P-270 | 27 | 0.11 | 1.76 |
| SPC-1005P-330 | 33 | 0.12 | 1.50 |
| SPC-1005P-390 | 39 | 0.14 | 1.37 |
| SPC-1005P-470 | 47 | 0.17 | 1.28 |
| SPC-1005P-560 | 56 | 0.19 | 1.17 |
| SPC-1005P-680 | 68 | 0.22 | 1.11 |
| SPC-1005P-820 | 82 | 0.25 | 1.00 |
| SPC-1005P-101 | 100 | 0.35 | 0.97 |
| SPC-1005P-121 | 120 | 0.40 | 0.89 |
| SPC-1005P-151 | 150 | 0.47 | 0.78 |
| SPC-1005P-181 | 180 | 0.63 | 0.72 |
| SPC-1005P-221 | 220 | 0.73 | 0.66 |
| SPC-1005P-271 | 270 | 0.97 | 0.57 |
| SPC-1005P-331 | 330 | 1.15 | 0.52 |
| SPC-1005P-391 | 390 | 1.30 | 0.48 |
| SPC-1005P-471 | 470 | 1.48 | 0.42 |
| SPC-1005P-561 | 560 | 1.90 | 0.33 |
| SPC-1005P-681 | 680 | 2.25 | 0.28 |
| SPC-1005P-821 | 820 | 2.55 | 0.24 |

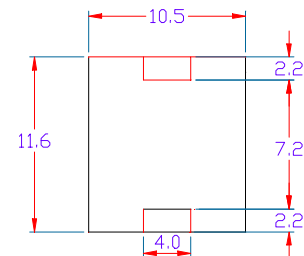
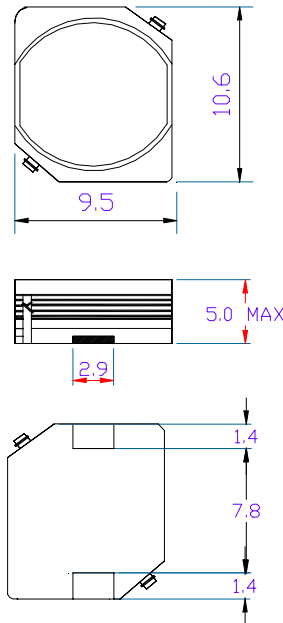

TOLERANCE :± 0.3

PCB PATTERN

NOTE(1) :TEST FREQUENCY: 100 kHz,1 VRMS.

NOTE(2) :10~39uH ± 20%,47~820uH ± 10%.

NOTE (3): THIS INDICATES THE VALUE OF DC CURRENT WHICH THE INDUCTANCE IS 10% LOWER THAN ITS INITIAL VALUE AND/OR ΔT=40°C UNDER THIS DC CURRENT BIAS.

TNP

台北沛波電子股份有限公司
 TAIPEI MULTIPower ELECTRONICS CO.,LTD
 2ND. FL., 542-7, CHUNG-CHENG ROAD,
 HSIN-TIEN CITY, TAIPEI, TAIWAN, R.O.C
 TEL : (02)8667-2078 FAX: (02) 8667-2080

SMD POWER INDUCTORS

MODEL NO. : SPC-1204P SERIES (CDRH124 COMPATIBLE)

FEATURES:

- * SUPERIOR QUALITY FROM AN AUTOMATED PRODUCTION LINE.
- * PICK AND PLACE COMPATIBLE.
- * TAPE AND REEL PACKING.



APPLICATION :

- * NOTEBOOK COMPUTERS.
- * DC-DC CONVERTORS.
- *DC-AC INVERTER.

ELECTRICAL SPECIFICATION:

(UNIT:mm)

| PART NO. | INDUCTANCE ($\mu\text{H} \pm 20\%$) | D.C.R. MAX ($\text{m}\Omega$) | RATED CURRENT (ADC) |
|---------------|--|---------------------------------------|---------------------------|
| SPC-1204P-3R9 | 3.9 | 15 | 6.50 |
| SPC-1204P-4R7 | 4.7 | 18 | 5.70 |
| SPC-1204P-6R8 | 6.8 | 23 | 4.90 |
| SPC-1204P-8R2 | 8.2 | 26 | 4.60 |
| SPC-1204P-100 | 10 | 34 | 4.50 |
| SPC-1204P-120 | 12 | 38 | 4.00 |
| SPC-1204P-150 | 15 | 52 | 3.20 |
| SPC-1204P-180 | 18 | 57 | 3.10 |
| SPC-1204P-220 | 22 | 66 | 2.90 |
| SPC-1204P-270 | 27 | 80 | 2.80 |
| SPC-1204P-330 | 33 | 97 | 2.70 |
| SPC-1204P-390 | 39 | 132 | 2.10 |
| SPC-1204P-470 | 47 | 150 | 1.90 |
| SPC-1204P-560 | 56 | 190 | 1.80 |
| SPC-1204P-680 | 68 | 220 | 1.50 |
| SPC-1204P-820 | 82 | 260 | 1.30 |
| SPC-1204P-101 | 100 | 308 | 1.20 |
| SPC-1204P-121 | 120 | 380 | 1.10 |
| SPC-1204P-151 | 150 | 530 | 0.95 |
| SPC-1204P-181 | 180 | 620 | 0.85 |
| SPC-1204P-221 | 220 | 700 | 0.80 |
| SPC-1204P-271 | 270 | 870 | 0.60 |
| SPC-1204P-331 | 330 | 990 | 0.50 |

PHYSICAL DIMENSION :

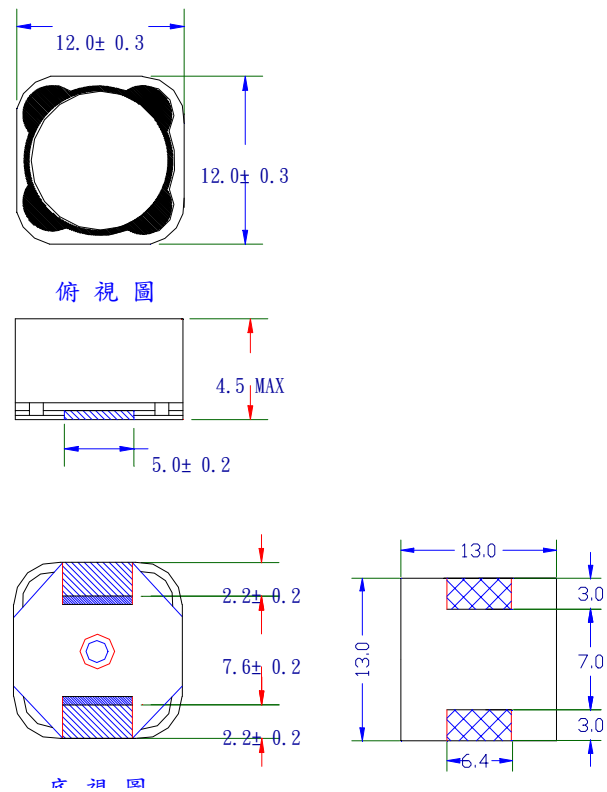

TOLERANCE : ± 0.3

NOTE(1):TEST FREQUENCY: 1 kHz,1 VRMS.

NOTE(2):AT VALUE OF INDUCTANCE WHEN IS 10% DOWN FROM FIRST VALUE AS CHARACTERISTICS OF D.C. CURRENT WHEN TEMPERATURE OF COIL INCREASED UP TO 40°C.($T_a=20^\circ\text{C}$)



台北沛波電子股份有限公司
TAIPEI MULTIPower ELECTRONICS CO.,LTD
2ND. FL.,542-7, CHUNG-CHENG ROAD,
HSIN-TIEN CITY, TAIPEI, TAIWAN, R.O.C
TEL : (02)8667-2078 FAX: (02) 8667-2080

SMD POWER INDUCTORS

MODEL NO. : SPC-1205P SERIES (CDRH125 COMPATIBLE)

FEATURES:

- * SUPERIOR QUALITY FROM AN AUTOMATED PRODUCTION LINE.
- * PICK AND PLACE COMPATIBLE.
- * TAPE AND REEL PACKING.

APPLICATION :

- * NOTEBOOK COMPUTERS.
- * DC-DC CONVERTORS.
- * DC-AC INVERTER.

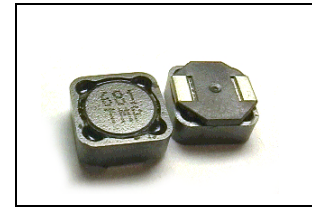

ELECTRICAL SPECIFICATION:

PHYSICAL DIMENSION :

(UNIT:mm)

| PART NO. | INDUCTANCE (uH) | D.C.R. MAX (Ω) | RATED CURRENT (ADC) |
|---------------|-----------------|----------------|---------------------|
| SPC-1205P-2R2 | 2.2 | 0.011 | 7.00 |
| SPC-1205P-4R7 | 4.7 | 0.014 | 5.00 |
| SPC-1205P-8R2 | 8.2 | 0.023 | 4.80 |
| SPC-1205P-100 | 10 | 0.027 | 4.50 |
| SPC-1205P-120 | 12 | 0.027 | 3.50 |
| SPC-1205P-150 | 15 | 0.030 | 3.30 |
| SPC-1205P-180 | 18 | 0.034 | 3.00 |
| SPC-1205P-220 | 22 | 0.043 | 2.80 |
| SPC-1205P-270 | 27 | 0.055 | 2.30 |
| SPC-1205P-330 | 33 | 0.060 | 2.10 |
| SPC-1205P-390 | 39 | 0.068 | 2.00 |
| SPC-1205P-470 | 47 | 0.075 | 1.80 |
| SPC-1205P-560 | 56 | 0.11 | 1.70 |
| SPC-1205P-680 | 68 | 0.14 | 1.50 |
| SPC-1205P-820 | 82 | 0.19 | 1.40 |
| SPC-1205P-101 | 100 | 0.22 | 1.30 |
| SPC-1205P-121 | 120 | 0.23 | 1.10 |
| SPC-1205P-151 | 150 | 0.25 | 1.00 |
| SPC-1205P-181 | 180 | 0.29 | 0.90 |
| SPC-1205P-221 | 220 | 0.40 | 0.80 |
| SPC-1205P-271 | 270 | 0.46 | 0.75 |
| SPC-1205P-331 | 330 | 0.51 | 0.68 |
| SPC-1205P-391 | 390 | 0.69 | 0.65 |
| SPC-1205P-471 | 470 | 0.77 | 0.58 |
| SPC-1205P-561 | 560 | 0.86 | 0.54 |
| SPC-1205P-681 | 680 | 1.20 | 0.48 |
| SPC-1205P-821 | 820 | 1.34 | 0.43 |
| SPC-1205P-102 | 1000 | 1.53 | 0.40 |

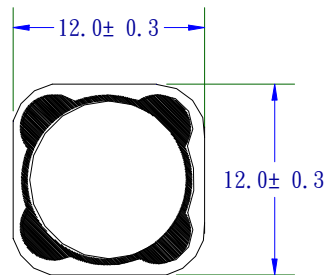

俯視圖

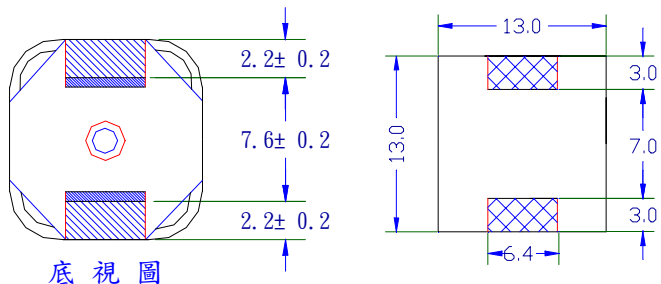
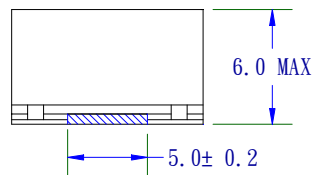

底視圖

TOLERANCE : ± 0.3

NOTE(1): TEST FREQUENCY: 2.2uH~4.7uH:100KHZ,1VRMS,10uH~1000uH:1 KHZ ,1VRMS.

NOTE(2): 2.2uH~8.2uH +40%-20%,10uH~1000uH± 20%.

NOTE(3):AT VALUE OF INDUCTANCE WHEN IS 10% DOWN FROM FIRST VALUE AS CHARACTERISTICS OF D.C. CURRENT WHEN TEMPERATURE OF COIL INCREASED UP TO 40°C.(Ta=20°C)



台北沛波電子股份有限公司
 TAIPEI MULTIPower ELECTRONICS CO.,LTD
 2ND. FL.,542-7, CHUNG-CHENG ROAD,
 HSIN-TIEN CITY, TAIPEI, TAIWAN, R.O.C
 TEL : (02)8667-2078 FAX: (02) 8667-2080

SMD POWER INDUCTORS

MODEL NO. : SPC-1207P SERIES (CDRH127 COMPATIBLE)

FEATURES:

- * SUPERIOR QUALITY FROM AN AUTOMATED PRODUCTION LINE.
- * PICK AND PLACE COMPATIBLE.
- * TAPE AND REEL PACKING.

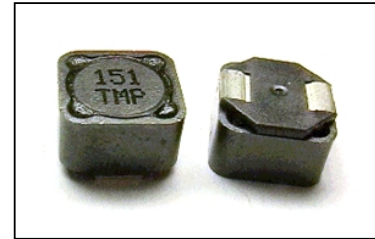

APPLICATION :

- * NOTEBOOK COMPUTERS.
- * DC-DC CONVERTORS.
- *DC-AC INVERTER.

ELECTRICAL SPECIFICATION:

PHYSICAL DIMENSION :

(UNIT:mm)

| PART NO. | INDUCTANCE (uH) | D.C.R. MAX (Ω) | RATED CURRENT (ADC) |
|---------------|-----------------|----------------|---------------------|
| SPC-1207P-1R2 | 1.2 | 0.007 | 9.80 |
| SPC-1207P-2R4 | 2.4 | 0.0115 | 8.00 |
| SPC-1207P-3R5 | 3.5 | 0.0135 | 7.50 |
| SPC-1207P-4R7 | 4.7 | 0.0158 | 6.80 |
| SPC-1207P-6R1 | 6.1 | 0.0176 | 6.60 |
| SPC-1207P-8R2 | 8.2 | 0.0210 | 5.40 |
| SPC-1207P-100 | 10 | 0.0216 | 5.40 |
| SPC-1207P-120 | 12 | 0.0243 | 4.90 |
| SPC-1207P-150 | 15 | 0.0270 | 4.50 |
| SPC-1207P-180 | 18 | 0.0392 | 3.90 |
| SPC-1207P-220 | 22 | 0.0432 | 3.60 |
| SPC-1207P-270 | 27 | 0.0459 | 3.40 |
| SPC-1207P-330 | 33 | 0.0648 | 3.00 |
| SPC-1207P-390 | 39 | 0.0729 | 2.75 |
| SPC-1207P-470 | 47 | 0.10 | 2.50 |
| SPC-1207P-560 | 56 | 0.11 | 2.35 |
| SPC-1207P-680 | 68 | 0.14 | 2.10 |
| SPC-1207P-820 | 82 | 0.16 | 1.95 |
| SPC-1207P-101 | 100 | 0.22 | 1.70 |
| SPC-1207P-121 | 120 | 0.25 | 1.60 |
| SPC-1207P-151 | 150 | 0.28 | 1.42 |
| SPC-1207P-181 | 180 | 0.35 | 1.30 |
| SPC-1207P-221 | 220 | 0.39 | 1.16 |
| SPC-1207P-271 | 270 | 0.56 | 1.06 |
| SPC-1207P-331 | 330 | 0.64 | 0.95 |
| SPC-1207P-391 | 390 | 0.70 | 0.88 |
| SPC-1207P-471 | 470 | 0.98 | 0.79 |
| SPC-1207P-561 | 560 | 1.07 | 0.73 |
| SPC-1207P-681 | 680 | 1.46 | 0.67 |
| SPC-1207P-821 | 820 | 1.64 | 0.60 |
| SPC-1207P-102 | 1000 | 1.82 | 0.55 |

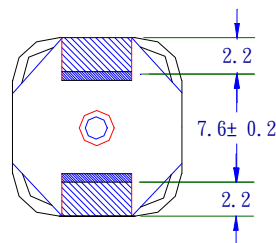
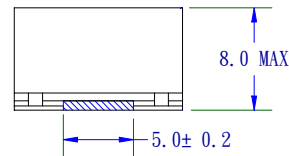
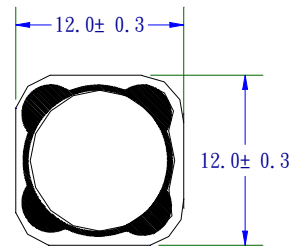

TOLERANCE : ± 0.3

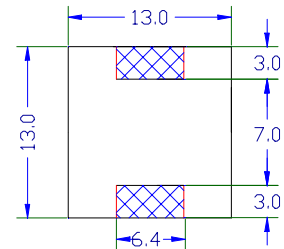

PCB PATTERN

NOTE(1):TEST FREQUENCY: 1.2uH~ 8.2uH:100KHZ,1 VRMS.10uH~1mH :1 KHZ,1VRMS.

NOTE(2):1.2uH~8.2uH:+40%/-20%,10uH~1000uH ± 20%

NOTE (3): THIS INDICATES THE VALUE OF DC CURRENT WHICH THE INDUCTANCE IS 10% LOWER THAN ITS INITIAL VALUE AND/OR ΔT=40°C UNDER THIS DC CURRENT BIAS.



台北沛波電子股份有限公司
 TAIPEI MULTIPower ELECTRONICS CO.,LTD
 2ND. FL.,542-7, CHUNG-CHENG ROAD,
 HSIN-TIEN CITY, TAIPEI, TAIWAN, R.O.C
 TEL : (02)8667-2078 FAX: (02) 8667-2080

SMD POWER INDUCTORS

MODEL NO. : SDT-1204P SERIES (CDRH124B COMPATIBLE)

FEATURES:

- * SUPERIOR QUALITY FOR AN AUTOMATED PRODUCTION LINE.
- * PICK AND PLACE COMPATIBLE.
- * TAPE AND REEL PACKING.

APPLICATION :

- * NOTEBOOK COMPUTERS. * PDA. * LOGIC IC POWER SUPPLY

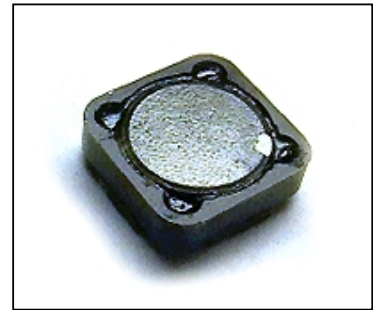

ELECTRICAL SPECIFICATION:

| MODEL NO | INDUCTANCE ($\mu\text{H} \pm 30\%$) PRI | TURN RATIO PRI : SEC | RATED CURRENT (ADC) | | DCR MAX (Ω) | |
|-------------------|---|-------------------------|------------------------|------|----------------------------|------|
| | | | PRI | SEC | PRI | SEC |
| SDT-1204P-9R0-121 | 9.0 | 1:2.1 | 3.6 | 0.20 | 0.040 | 0.45 |

NOTE(1):TEST FREQUENCY: 1 kHz,1 VRMS.

PHYSICAL DIMENSION(UNIT : mm)

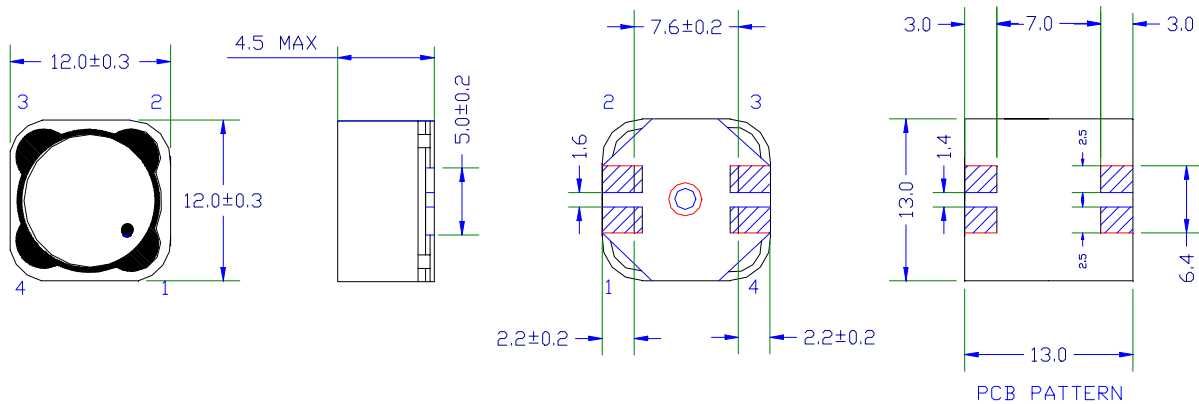

TEST CIRCUIT :

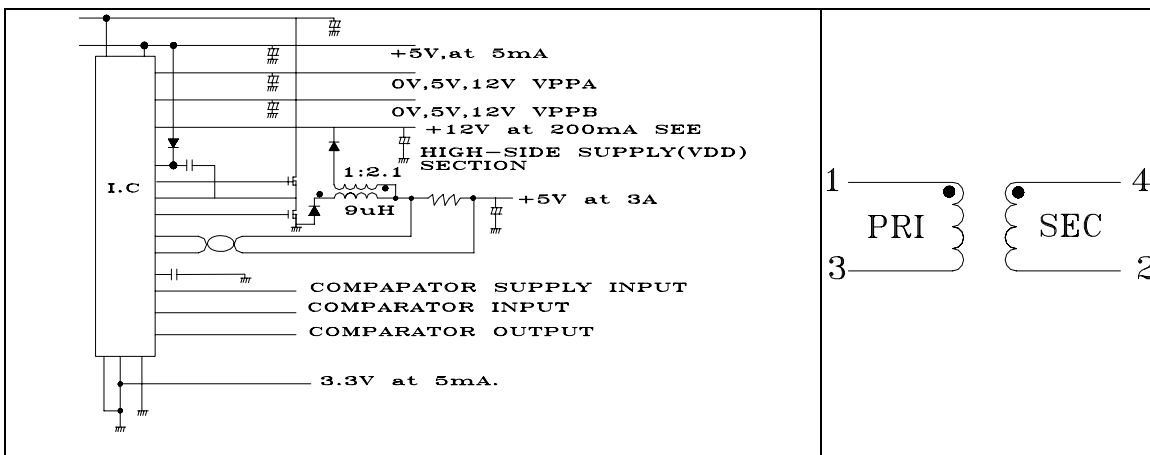

台北沛波電子股份有限公司
 TAIPEI MULTIPower ELECTRONICS CO.,LTD
 2ND. FL.,542-7, CHUNG-CHENG ROAD,
 HSIN-TIEN CITY, TAIPEI, TAIWAN, R.O.C
 TEL : (02)8667-2078 FAX: (02) 8667-2080

SMD POWER INDUCTORS

MODEL NO. : SDT-1205P SERIES (CDRH125B COMPATIBLE)

FEATURES:

- * SUPERIOR QUALITY FOR AN AUTOMATED PRODUCTION LINE.
- * PICK AND PLACE COMPATIBLE.
- * TAPE AND REEL PACKING.



APPLICATION :

- * NOTEBOOK COMPUTERS. * PDA. *ROGIC IC POWER SUPPLY

ELECTRICAL SPECIFICATION:

| MODEL NO | INDUCTANCE ($\mu\text{H} \pm 30\%$) PRI | TURN RATIO PRI : SEC | RATED CURRENT (ADC) | | DCR MAX (Ω) | |
|-------------------|---|-------------------------|------------------------|------|----------------------------|------|
| | | | PRI | SEC | PRI | SEC |
| SDT-1205P-100-122 | 10 | 1:2.2 | 4.5 | 0.20 | 0.035 | 0.29 |

NOTE(1):TEST FREQUENCY: 1 kHz,1 VRMS.

PHYSICAL DIMENSION(UNIT : mm)

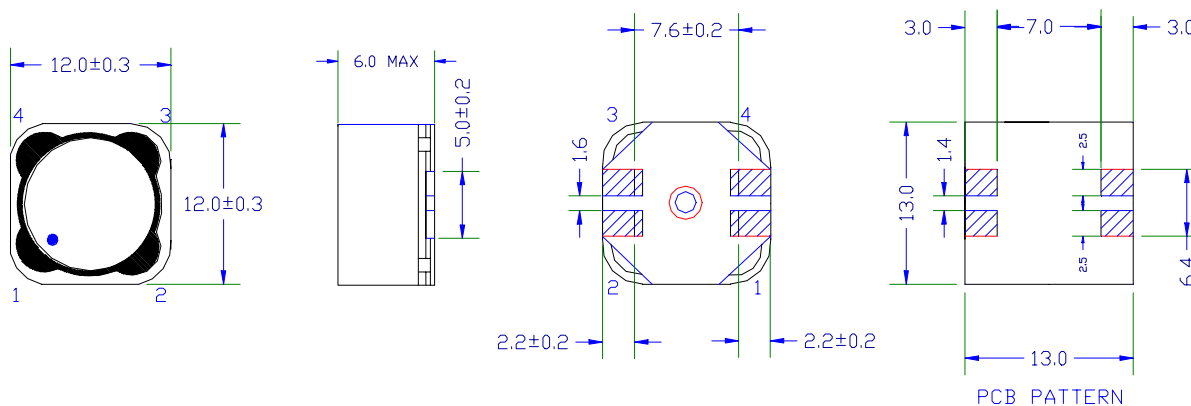

TEST CIRCUIT :

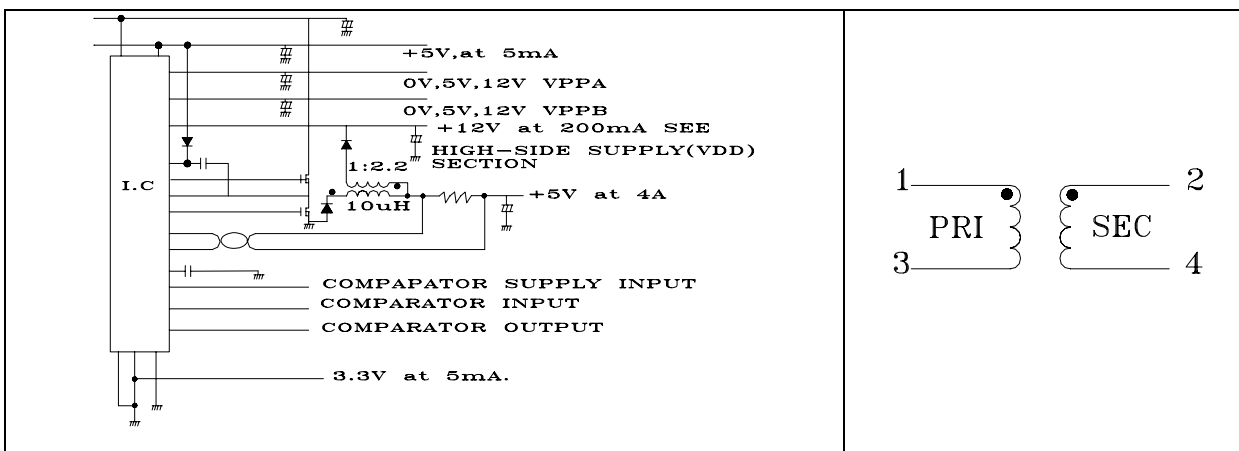

台北沛波電子股份有限公司
 TAIPEI MULTIPower ELECTRONICS CO.,LTD
 2ND. FL.,542-7, CHUNG-CHENG ROAD,
 HSIN-TIEN CITY, TAIPEI, TAIWAN, R.O.C
 TEL : (02)8667-2078 FAX: (02) 8667-2080

SMD POWER INDUCTORS

MODEL NO. : SDT-1207P SERIES (CDRH127B COMPATIBLE)

FEATURES:

- * SUPERIOR QUALITY FOR AN AUTOMATED PRODUCTION LINE.
- * PICK AND PLACE COMPATIBLE.
- * TAPE AND REEL PACKING.



APPLICATION :

- * NOTEBOOK COMPUTERS. * PDA. *ROGIC IC POWER SUPPLY

ELECTRICAL SPECIFICATION:

| MODEL NO | INDUCTANCE ($\mu\text{H} \pm 30\%$) PRI | TURN RATIO PRI : SEC | RATED CURRENT (ADC) | | DCR MAX (Ω) | |
|-------------------|---|-------------------------|------------------------|------|----------------------------|------|
| | | | PRI | SEC | PRI | SEC |
| SDT-1207P-4R7-122 | 4.7 | 1:2.2 | 6.5 | 0.30 | 0.025 | 0.10 |
| SDT-1207P-100-122 | 10 | 1:2.2 | 6.5 | 0.30 | 0.035 | 0.30 |

NOTE(1):TEST FREQUENCY: 1 kHz,1 VRMS.

PHYSICAL DIMENSION(UNIT : mm)

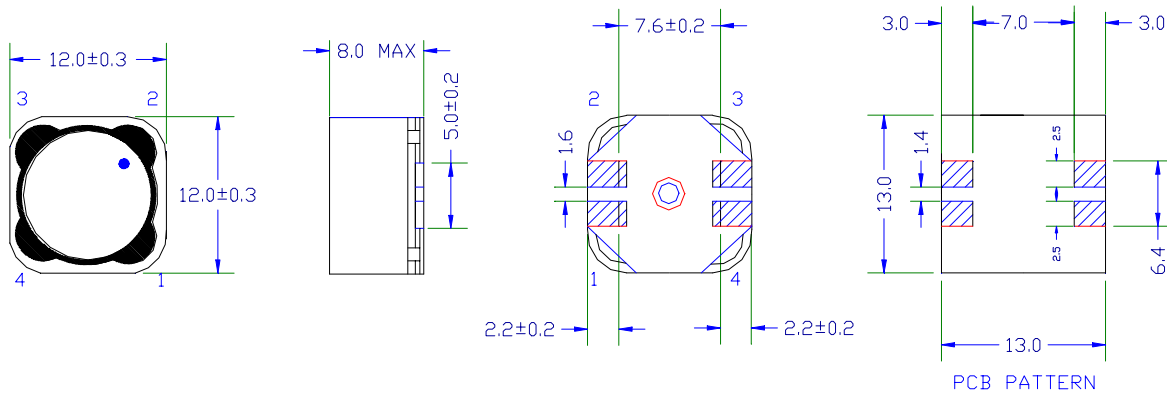

TEST CIRCUIT :

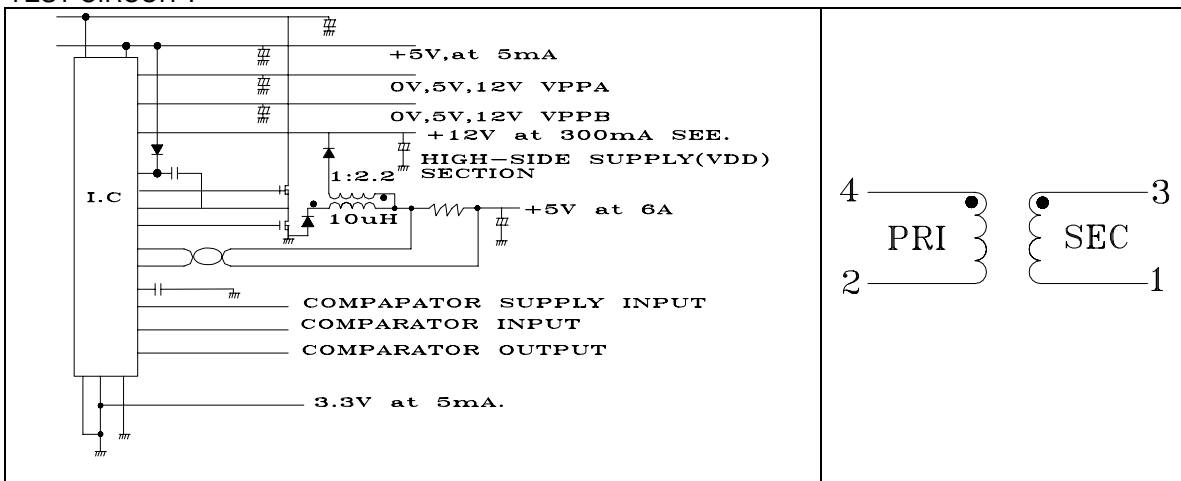

台北沛波電子股份有限公司
TAIPEI MULTIPower ELECTRONICS CO.,LTD
2ND. FL.,542-7, CHUNG-CHENG ROAD,
HSIN-TIEN CITY, TAIPEI, TAIWAN, R.O.C
TEL : (02)8667-2078 FAX: (02) 8667-2080

SMD POWER INDUCTORS

MODEL NO. : STC-1506-2R4 / STC-1606-2R4

FEATURES:

- * SUPERIOR QUALITY FOR AN AUTOMATED PRODUCTION LINE.
- * PICK AND PLACE COMPATIBLE.
- * TAPE AND REEL PACKING.



APPLICATION :

* NOTEBOOK COMPUTERS (FOR CPU DRIVE 5V/3.3V LINES,BATTERY CHARGE LINE).

ELECTRICAL SPECIFICATION:

| PART NO | INDUCTANCE (uH) $\pm 15\%$ | DCR MAX (m Ω) | RATED CURRENT (A) |
|--------------|----------------------------|-----------------------|-------------------|
| STC-1506-2R4 | 2.4 | 5.4 | 14.0A |
| STC-1606-2R4 | 2.4 | 4.0 | 15.6A |

NOTE : TEST FREQUENCY: 300 KHZ,1VRMS.

PHYSICAL DIMENSION : (UNIT:mm)

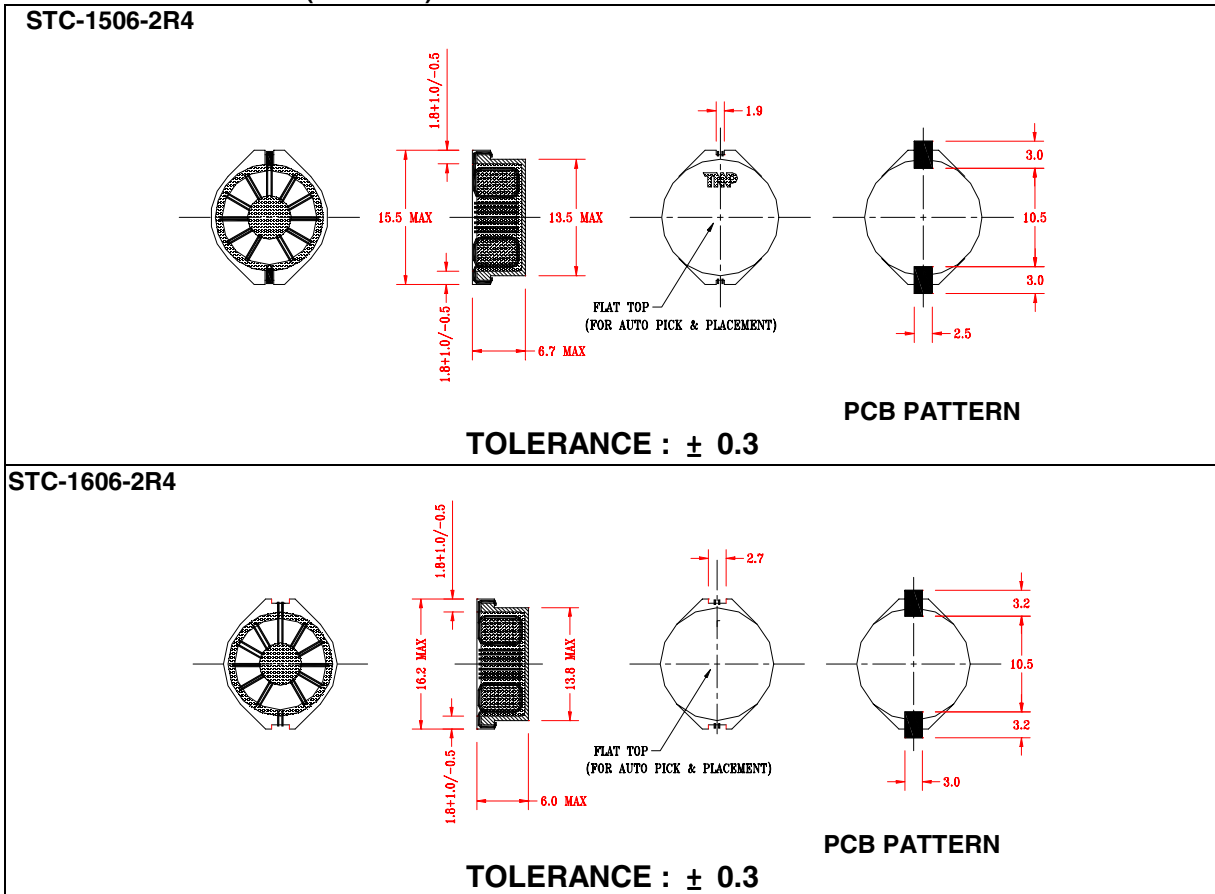

台北沛波電子股份有限公司
 TAIPEI MULTIPower ELECTRONICS CO.,LTD
 2ND. FL.,542-7, CHUNG-CHENG ROAD,
 HSIN-TIEN CITY, TAIPEI, TAIWAN, R.O.C
 TEL : (02)8667-2078 FAX: (02) 8667-2080

DC TO DC CONVERTER TRANSFORMER FOR DIGITAL STILL CAMERA

MODEL NO : T06378

FEATURES:

- *EASY SURFACE MOUNTING AND COMPATIBLE WITH IR REFLOW SOLDERING
- *LOW PROFILE (6mm HEIGHT)

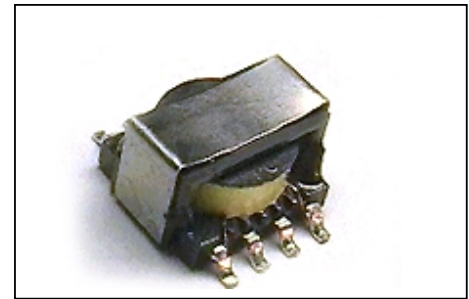

ELECTRICAL SPECIFICATION :

| MODEL NO | INPUT VOLTAGE | MAX. OUTPUT WATTAGE | OPERATIONAL FREQUENCY | INDUCTANCE (uH ± 15%) PRI |
|----------|---------------|---------------------|-----------------------|----------------------------|
| T06378 | 3 VDC | 2.0 | 40KHZ~300KHZ | 6.2 |

SCHEMATICS:

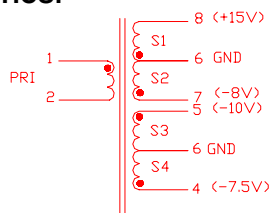

PHYSICAL DIMENSION : (UNIT:mm)

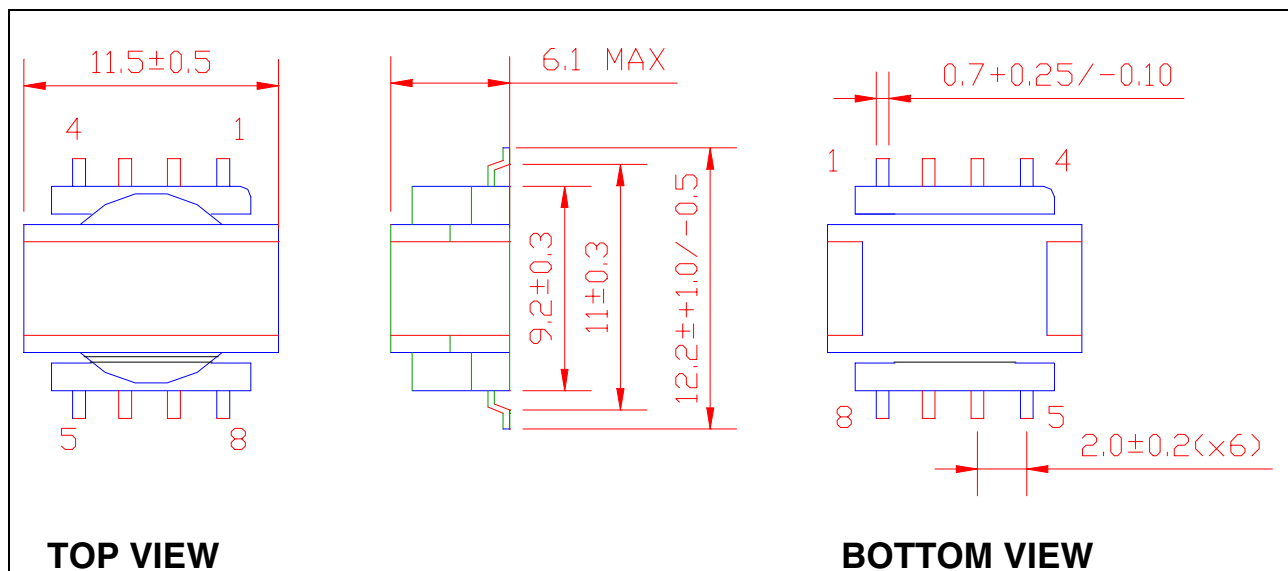

台北沛波電子股份有限公司
TAIPEI MULTIPower ELECTRONICS CO.,LTD
2ND. FL.,542-7, CHUNG-CHENG ROAD,
HSIN-TIEN CITY, TAIPEI, TAIWAN, R.O.C
TEL : (02)8667-2078 FAX: (02) 8667-2080

DC TO DC CONVERTER TRANSFORMER FOR PC CAMERA

MODEL NO : T06487

FEATURES:

*EASY SURFACE MOUNTING AND COMPATIBLE WITH

IR REFLOW SOLDERING

*LOW PROFILE (5.7mm HEIGHT)

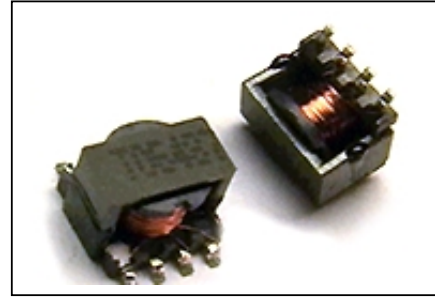

ELECTRICAL SPECIFICATION:

| MODEL NO | INPUT VOLTAGE | MAX. OUTPUT WATTAGE | OPERATIONAL FREQUENCY | OUTPUT VOLTAGE | |
|----------|---------------|---------------------|-----------------------|----------------|--------|
| | | | | SEC1 | SEC2 |
| T06487 | 5 VDC | 0.8 W | 40KHZ~300KHZ | +15VDC | -8 VDC |

| MODEL NO | TURNS | | | | INDUCTANCE SEC 1-8 (mH± 15%) |
|----------|-------|------|-------|----|------------------------------------|
| | P1 | P2 | S1 | S2 | |
| T06487 | 39.5 | 27.5 | 149.5 | 65 | 2.97 |

SCHEMATICS :

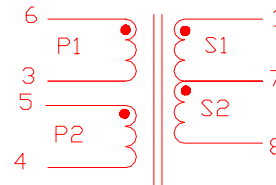

PHYSICAL DIMENSION : (UNIT:mm)

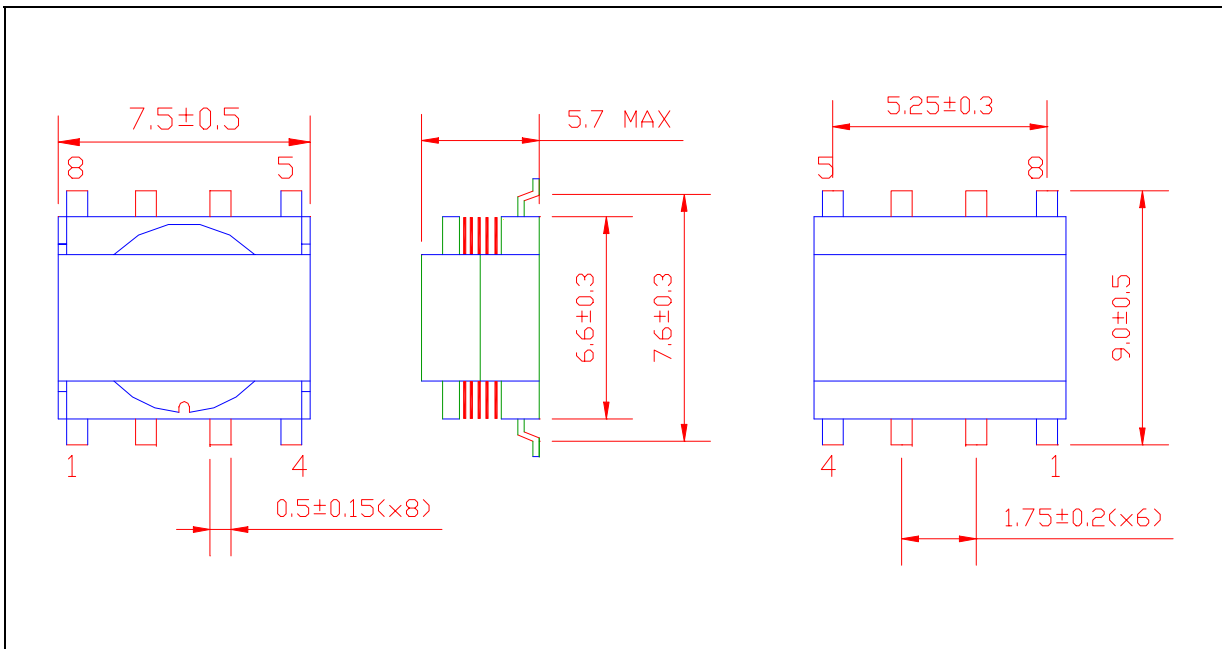

台北沛波電子股份有限公司
TAIPEI MULTIPower ELECTRONICS CO.,LTD
2ND. FL.,542-7, CHUNG-CHENG ROAD,
HSIN-TIEN CITY, TAIPEI, TAIWAN, R.O.C
TEL : (02)8667-2078 FAX: (02) 8667-2080

PAGKING SPEC

| PART NO | TAPE WIDTH | REEL WIDTH | COMPONENT PITCH | UNITS PER REEL |
|---------------------------|------------|------------|-----------------|----------------|
| SDT-1204P-XXX | 24mm | 32mm | 16mm | 700 |
| SDT-1205P-XXX | 24mm | 32mm | 16mm | 500 |
| SDT-1207P-XXX | 24mm | 32mm | 16mm | 450 |
| SMI-1607-XXX | 32mm | 38.4mm | 24mm | 250 |
| SMI-42-XXX | 12mm | 18.4mm | 8mm | 2500 |
| SMI-43-XXX | 16mm | 22.4mm | 12mm | 1500 |
| SMI-54-XXX | 16mm | 22.4mm | 12mm | 1000 |
| SPC-0602-XXX | 16mm | 22.4mm | 12mm | 1500 |
| SPC-0603-XXX | 16mm | 22.4mm | 12mm | 1500 |
| SPC-0605-XXX | 16mm | 22.4mm | 12mm | 1000 |
| SPC-06502-XXX | 16mm | 22.4mm | 12mm | 2000 |
| SPC-06503-XXX | 16mm | 22.4mm | 12mm | 2000 |
| SPC-06703-XXX | 16mm | 22.4mm | 12mm | 1500 |
| SPC-06704-XXX | 16mm | 22.4mm | 12mm | 1000 |
| SPC-0704P-XXX | 24mm | 32mm | 16mm | 800 |
| SPC-1002-XXX | 24mm | 32mm | 16mm | 1000 |
| SPC-1003P-XXX | 24mm | 32mm | 16mm | 1000 |
| SPC-1004P-XXX | 24mm | 32mm | 16mm | 1000 |
| SPC-1005P-XXX | 24mm | 32mm | 16mm | 800 |
| SPC-1204P-XXX | 24mm | 32mm | 16mm | 700 |
| SPC-1205P-XXX | 24mm | 32mm | 16mm | 500 |
| SPC-1207P-XXX | 24mm | 32mm | 16mm | 450 |
| STC-1506-2R4/STC-1606-2R4 | 24mm | 32mm | 24mm | 400 |
| T06378 | 24mm | 32mm | 16mm | 500 |
| T06487 | 24mm | 32mm | 16mm | 700 |



台北沛波電子股份有限公司
 TAIPEI MULTIPower ELECTRONICS CO., LTD
 2ND. FL. 542-7, CHUNG-CHENG ROAD,
 HSIN-TIEN CITY, TAIPEI, TAIWAN, R.O.C
 TEL: (02) 8667-2078 FAX: (02) 8667-2080