

F1808 Lumped Element Drop-In Circulators

Key Features:

- Frequency range: 40~110MHz, 2-20MHz bandwidth
- Drop-in configuration
- Small size, low cost
- Power handling +10 Watts
- Operating temperature 0~+50°C
- Customer specify center frequency and bandwidth

Electrical Specifications

Part No.	Freq Range MHz	Insertion Loss, dB	Reverse Isolation, dB	VSWR	Forward Power, Watts	Reverse Power Watts	Temp. Range, °C
F1808-0004-05	39.5-41.5	1.2 Max	≥ 18	≤ 1.3	≥ 10	≥ 10	0 ~ +50
F1808-0010-20	88~108	1.2 Max	≥ 18	≤ 1.3	≥ 10	≥ 10	0 ~ +50

Mechanical Structure:

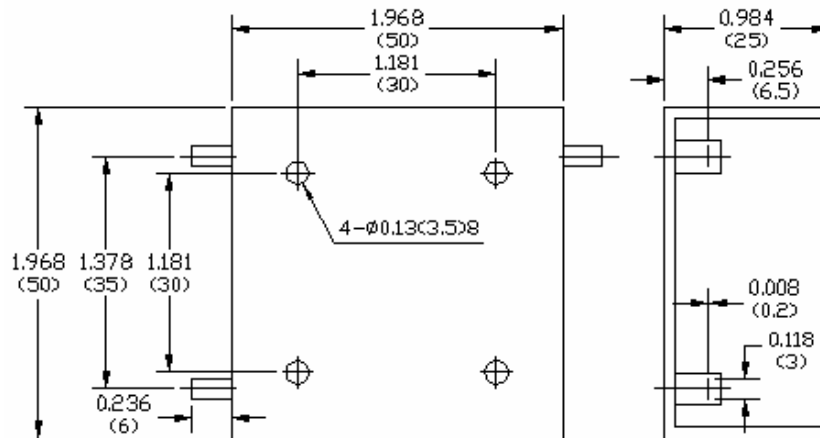

Note: All units in inches (mm).

Ordering Information:

F1808-XXXX-XX
 ↓
 Bandwidth, XX%,
 ↓
 Frequency XX.XX GHz,