



Gold Box LINEAR REGULATED AC-DC single output Series A & B

- Shipped Within 3 Days
- All Models U.L. Recognized
- CE Certified
- Five Year Warranty



Don't forget these facts about Acopian....

1. We ship within 3 Days (see our 3 Day Shipping Promise below).
2. Acopian power supplies last a *very long time*.
3. The Voltage Finder is the quickest way to find a power supply with the specs you need.
4. The Online System builder (www.acopian.com/SystemBuilder) is a convenient way to get your own custom Power System (and they ship within 9 Days).
5. You always talk to a real person when you call Acopian.
6. You can order your Acopian power supplies factory direct.
7. You can order your Acopian power supplies online.
8. All Acopian products are made in the USA.



Acopian Technical Company • Easton, PA
 1-800-523-9478 • www.acopian.com
 Order Factory Direct   
 Made in USA 





Gold Box SINGLE OUTPUT

LINEAR REGULATED
AC-DC

SERIES A (High Performance)

- Shipped Within 3 Days
- All Models U.L. Recognized
- CE
- Five Year Warranty



Series A power supplies offer unusually high performance—many models have regulation of $\pm 0.005\%$. Electronic current limiting and provision for remote voltage sensing are standard features; overvoltage

protection is available as a built-in option. Rugged extruded aluminum cases include threaded mounting holes on bottom, back, and side, permitting mounting in any position.

SERIES A: HIGH PERFORMANCE POWER SUPPLIES

STANDARD FEATURES

- Provision for remote sensing and/or external output adjustment
- Short circuit proof with automatic recovery (electronic current limiting)
- Can be mounted on any of three surfaces (case sizes H8, H11 and H16; two surfaces)

SPECIFICATIONS

Input Voltage: 105-125 VAC, 50-400 Hz, single phase.

Output Specifications: See pages 48 and 49. Series A supplies have model numbers beginning with the letter A.

Remote Voltage Adjustment/Sensing: Provision for sensing the output voltage across the load, so that drops in the load line are compensated, is a standard feature. This feature also permits the use of an externally located potentiometer to adjust output voltage.

Polarity: Output is floating; either positive or negative terminal may be grounded or floated up to 300 volts above ground.

Temperature Coefficient: 0.015%/°C (Typical).

Ambient Operating Temperature: -20 to +71°C.

Storage Temperature: -55 to +85°C.

Response Time: Less than 20 microseconds.

OPTIONS

Under/Overvoltage Alarm Contacts: To control a horn or light, or to signal your PLC. Available on models with nominal outputs of 5 Vdc to 125 Vdc. SPDT contacts switch if the power supply's output deviates by

- 1.0 volt or more: 5 volt models.
- 2.0 volts or more: 6 to 48 volt models.
- 3.0 volts or more: 50 to 125 volt models.

Contact ratings: 120 VAC, 8A / 60 Vdc, 1A. (To comply with SELV requirements, limit switched voltage to 60Vdc/42 VAC.) To order, add suffix "L" to model number and \$35.00 to price. Models with this option are not yet UL Recognized/CE certified.

Overvoltage Protection: An internal preset overvoltage protector is available. To order, add prefix "V" to the model number, and increase standard price as follows:

Outputs of	1.5-70V	75-150V
All case sizes except H16 . . .	\$25.00	\$35.00
Case size H16	75.00	85.00

Terminal Strip Cover: Clips on. To order, add suffix "M" to model number and \$5.00 to price.

230 Volt Input: All models can be alternately furnished for operation on inputs of 210-250 VAC, 50-400 Hz. To order, add suffix "-230" to model number and \$25.00 to price. (For models in case sizes H8, H11 and H16, add \$40.00.) The "-230" option requires two additional days.

Mounting: Threaded mounting holes permit mounting to a chassis, cabinet wall or bracket. To mount from the power supply side of the mounting surface or for DIN rail mounting, see accessory Mounting Kits on page 91.

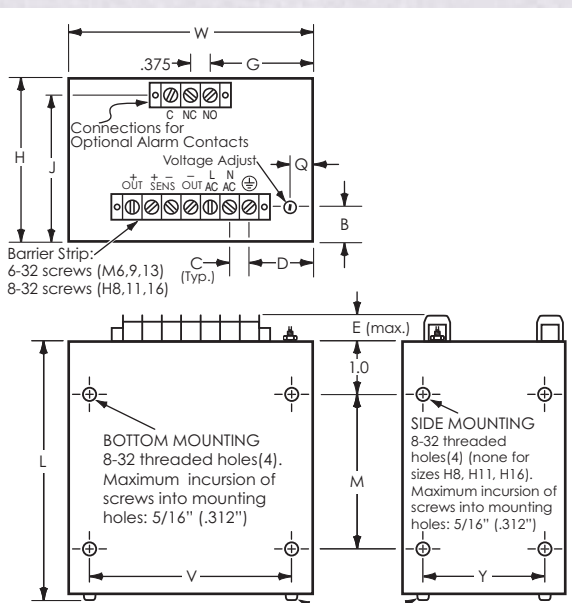

For REAR MOUNTING, remove original screws(4) and use 8-32 Type F self-tapping screws. They should extend at least 5/16" (0.312") into the power supply case.

Case Size	L	W	H	M	V	Y	Q	B	E	C	D	G	J	Approx. Weight
M6	6.59	5.12	3.44	4.0	4.5	3.0	.5	.75	.58	.375	1.44	2.19	3.09	4 lb. 4 oz.
M9	9.25	5.12	3.44	6.0	4.5	3.0	.5	.75	.58	.375	1.44	2.19	3.09	7 lb. 4 oz.
M13	13.25	5.12	3.44	10.0	4.5	3.0	.5	.75	.58	.375	1.44	2.19	3.09	11 lb.
H8	8.75	7.37	5.12	6.0	6.75	4.56	1.12	1.25	.78	.562	2.25	3.57	4.72	15 lb. 8 oz.
H11	11.25	7.37	5.12	8.0	6.75	4.56	1.12	1.25	.78	.562	2.25	3.57	4.72	18 lb. 4 oz.
H16	16.00	7.37	5.12	11.0	6.75	4.56	1.12	1.25	.78	.562	2.25	3.57	4.72	26 lb.

Gold Box
SINGLE OUTPUT
 LINEAR REGULATED
 AC-DC

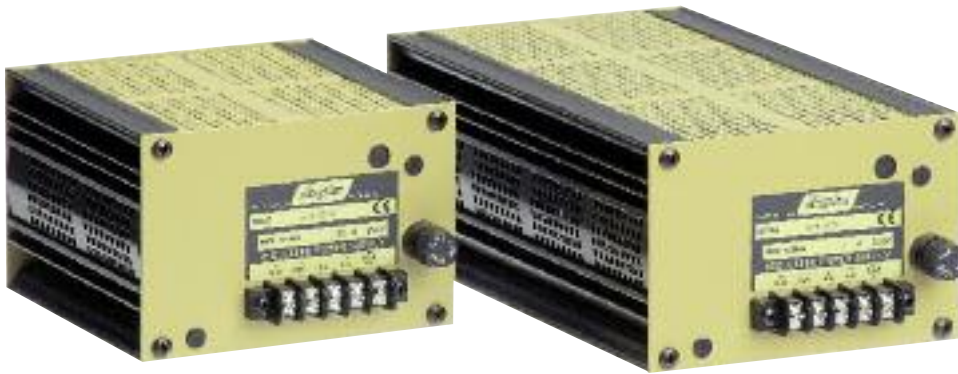

SERIES B (General Purpose)

- Shipped Within 3 Days
- All Models U.L. Recognized
- CE
- Five Year Warranty

Series B power supplies are ideal for powering digital circuitry, test sets, instrument bridges, and process control transmitters. Many models have regulation of $\pm 0.1\%$ or better. All components are generously derated

to insure a long and trouble-free life, and they use the same rugged construction as the Series A line. Overvoltage protection and other options are available.

SERIES B: GENERAL PURPOSE POWER SUPPLIES

STANDARD FEATURES

- Short circuit proof (electronic current limiting)
- May be mounted on any of three surfaces
- Completely serviceable

SPECIFICATIONS

Input Voltage: 105-125 VAC, 50-400 Hz, single phase.

Output Specifications: See pages 48 and 49. Series B supplies have model numbers beginning with the letter B.

Remote Voltage Adjustment/Sensing: Available as an option. See below.

Polarity: Output is floating; either positive or negative terminal may be grounded or floated up to 300 volts above ground.

Temperature Coefficient: 0.02%/°C (Typical).

Ambient Operating Temperature: 0 to +71°C.

Storage Temperature: -55 to +85°C.

OPTIONS

Under/Overvoltage Alarm Contacts: To control a horn or light, or to signal your PLC. Available on models with nominal outputs of 5 Vdc to 125 Vdc. SPDT contacts switch if the power supply's output deviates by

- 1.0 volt or more: 5 volt models.
- 2.0 volts or more: 6 to 48 volt models.
- 3.0 volts or more: 50 to 125 volt models.

Contact ratings: 120 VAC, 8A / 60 Vdc, 1A. (To comply with SELV requirements, limit switched voltage to 60Vdc/42 VAC.) To order, add suffix "L" to model number and \$35.00 to price. Models with this option are not yet UL Recognized/CE certified.

Overvoltage Protection: An internal preset overvoltage protector is available. To order, add prefix "V" to the model number, and add \$25.00 to the standard price of models with outputs of 1.5 to 70 volts; \$35.00, for 75 to 200 volt outputs.

Remote Voltage Sensing: Provision for sensing the output voltage across the load, so that drops in the load lines are compensated, is available on all models. (This option also permits the use of an externally located potentiometer to adjust output voltage.) To order, add prefix "R" to the model number. No increase in price.

Terminal Strip Cover: Clips on. To order, add suffix "M" to model number and \$5.00 to price.

230 Volt Input: All models can be alternately furnished for operation on inputs of 210-250 VAC, 50-400 Hz. To order, add suffix "-230" to model number and \$25.00 to price. The "-230" option requires two additional days.

Mounting: Threaded mounting holes permit mounting to a chassis, cabinet wall or bracket. To mount from the power supply side of the mounting surface or for DIN rail mounting, see accessory Mounting Kits on page 91.

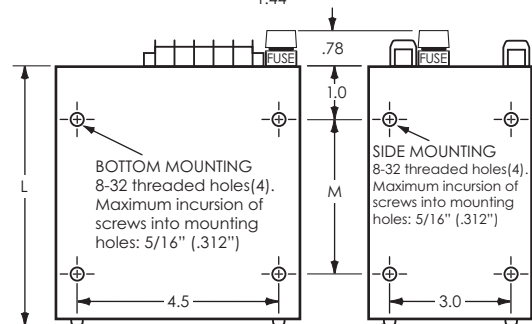
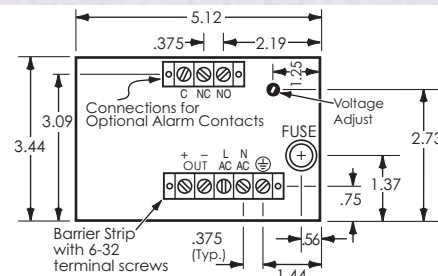

For REAR MOUNTING, remove original screws(4) and use 8-32 Type F self-tapping screws. They should extend at least 5/16" (0.312") into the power supply case.

Case Size	L	M	Approx. Weight
G3	3.71	1.62	3 lb. 2 oz.
G5	5.09	3.0	4 lb. 14 oz.
G6	6.59	4.0	5 lb. 8 oz.
G9	9.25	6.0	7 lb. 4 oz.
G13	13.25	10.0	11 lb.

SERIES A & B

Nominal Output Voltage	Ad-just ±V	Output Current Amps. at			Regulation		Ripple mV RMS	Price (\$)	Model	Case Size
		40°C	55°C	71°C	Load ± %*	Line ± %*				
1.5	.5	6.0	4.3	3.5	.005	.005	.250	\$245	A1.5MT600	M6
1.5	.5	9.0	7.2	5.5	.005	.005	.250	\$280	A1.5MT900	M9
1.5	.5	12.0	10.0	8.0	.005	.005	.250	\$335	A1.5MT1200	M13
1.5	.5	22.0	18.5	15.5	.005	.005	.250	\$415	A1.5H2200	H11
1.5	.5	32.0	27.0	22.5	.005	.005	.250	\$495	A1.5H3200	H16
2	.5	6.0	4.3	3.5	.005	.005	.250	\$245	A2MT600	M6
2	.5	12.0	10.0	8.0	.005	.005	.250	\$335	A2MT1200	M13
3	.5	.500	.500	.500	.2	.1	1	\$115	B3G50	G3
3	.5	1.2	1.1	1.0	.2	.1	1	\$140	B3G120	G3
3	.5	2.1	2.1	2.0	.5	.1	1	\$160	B3G210	G5
3	.5	4.0	3.5	3.0	.5	.1	1.5	\$200	B3G400	G6
3	.5	6.0	4.3	3.5	.005	.005	.250	\$245	A3MT600	M6
3	.5	9.0	7.2	5.5	.005	.005	.250	\$280	A3MT900	M9
3	.5	12.0	10.0	8.0	.005	.005	.250	\$335	A3MT1200	M13
3	.5	17.0	14.5	12.0	.005	.005	.250	\$370	A3H1700	H8
3	.5	20.0	16.5	13.5	.005	.005	.250	\$415	A3H2000	H11
3	.5	30.0	25.0	20.0	.005	.005	.250	\$495	A3H3000	H16
3.3	.5	.500	.500	.500	.2	.1	1	\$115	B3.3G50	G3
3.3	.5	1.2	1.1	1.0	.2	.1	1	\$140	B3.3G120	G3
3.3	.5	2.1	2.1	2.0	.5	.1	1.5	\$160	B3.3G210	G5
3.3	.5	4.0	3.5	3.0	.5	.1	1.5	\$200	B3.3G400	G6
3.3	.5	6.0	4.3	3.5	.005	.005	.250	\$245	A3.3MT600	M6
3.3	.5	7.0	5.9	4.9	.5	.1	1.5	\$250	B3.3G700	G9
3.3	.5	9.0	7.2	5.5	.005	.005	.250	\$285	A3.3MT900	M9
3.3	.5	12.0	10.0	8.0	.005	.005	.250	\$335	A3.3MT1200	M13
3.3	.5	17.0	14.5	12.0	.005	.005	.250	\$370	A3.3H1700	H8
3.3	.5	22.0	18.5	15.5	.005	.005	.250	\$415	A3.3H2000	H11
3.3	.5	32.0	27.0	22.5	.005	.005	.250	\$495	A3.3H3200	H16
5	.5	.500	.500	.500	.1	.1	1	\$115	B5G50	G3
5	.5	1.2	1.1	1.0	.1	.1	1	\$140	B5G120	G3
5	.5	1.7	1.5	1.3	.2	.1	1.5	\$150	B5G170	G3
5	.5	2.1	2.1	2.0	.2	.1	1.5	\$160	B5G210	G5
5	.5	4.0	3.5	3.0	.3	.1	1.5	\$190	B5G400	G6
5	.5	5.0	4.4	3.0	.4	.1	1.5	\$205	B5G500	G6
5	.5	5.1	3.6	2.6	.005	.005	.250	\$230	A5MT510	M6
5	.5	6.0	4.3	3.5	.005	.005	.250	\$250	A5MT600	M6
5	.5	8.0	7.0	5.0	.4	.1	1.5	\$255	B5G800	G9
5	.5	9.0	7.2	5.5	.005	.005	.250	\$285	A5MT900	M9
5	.5	10.0	9.0	7.0	.4	.1	1.5	\$290	B5G1000	G13
5	.5	12.0	10.0	8.0	.005	.005	.250	\$335	A5MT1200	M13
5	.5	17.0	14.5	12.0	.005	.005	.250	\$370	A5H1700	H8
5	.5	22.0	18.5	15.0	.005	.005	.250	\$415	A5H2200	H11
5	.5	32.0	27.0	22.0	.005	.005	.250	\$495	A5H3200	H16
6	1	.500	.500	.500	.1	.1	1	\$115	B6G50	G3
6	.5	1.2	1.1	1.0	.1	.1	1	\$140	B6G120	G3
6	.5	1.7	1.5	1.3	.2	.1	1.5	\$150	B6G170	G3
6	.5	3.2	3.1	3.0	.3	.1	1.5	\$185	B6G320	G6
6	.5	4.9	3.5	2.5	.005	.005	.250	\$205	A6MT490	M6
6	.5	6.0	4.5	3.5	.005	.005	.250	\$240	A6MT600	M6
6	.5	8.5	7.5	5.2	.005	.005	.250	\$285	A6MT850	M9
6	.5	11.0	9.3	7.5	.005	.005	.250	\$335	A6MT1100	M13
6	.5	16.0	13.6	11.2	.005	.005	.250	\$375	A6H1600	H8
6	.5	21.0	17.0	14.0	.005	.005	.250	\$420	A6H2100	H11
6	.5	28.0	23.0	19.0	.005	.005	.250	\$495	A6H2800	H16
7	1	.500	.500	.500	.1	.05	1	\$120	B7G50	G3
7	1	1.0	1.0	1.0	.1	.1	1	\$150	B7G100	G3
7	.5	2.0	2.0	2.0	.2	.1	1.5	\$170	B7G200	G5
7	.5	3.0	2.7	2.5	.3	.1	1.5	\$195	B7G300	G6
7	.5	5.0	4.0	3.0	.005	.005	.250	\$240	A7MT500	M6
7	.5	6.5	5.2	4.0	.4	.1	1.0	\$250	B7G650	G9
7	.5	8.0	6.5	5.0	.005	.005	.250	\$290	A7MT800	M9
7	.5	10.0	8.0	7.0	.4	.1	1.5	\$300	B7G1000	G13
7	.5	10.0	8.8	7.0	.005	.005	.250	\$335	A7MT1000	M13
8	1	.500	.500	.500	.1	.05	1	\$120	B8G50	G3
8	1	1.0	1.0	1.0	.1	.1	1	\$150	B8G100	G3
8	.5	2.0	2.0	2.0	.2	.1	1.5	\$170	B8G200	G5
8	.5	3.0	2.7	2.5	.2	.1	1.5	\$195	B8G300	G6
8	.5	5.0	4.0	3.5	.005	.005	.250	\$240	A8MT500	M6
8	.5	6.5	5.2	4.0	.3	.1	1.5	\$260	B8G650	G9
8	.5	8.0	6.5	5.0	.005	.005	.250	\$290	A8MT800	M9
8	.5	10.0	8.0	7.0	.4	.1	1.5	\$300	B8G1000	G13
8	.5	10.5	8.8	7.0	.005	.005	.250	\$335	A8MT1050	M13
8	.5	20.0	16.8	13.5	.005	.005	.250	\$440	A8H2000	H11
8	.5	28.0	23.0	19.0	.005	.005	.250	\$495	A8H2800	H16
9	1	.500	.500	.500	.1	.05	1	\$120	B9G50	G3
9	1	1.0	1.0	1.0	.1	.1	1	\$150	B9G100	G3
9	.5	2.0	2.0	2.0	.2	.1	1.5	\$170	B9G200	G5
9	.5	3.0	2.7	2.5	.2	.1	1.5	\$195	B9G300	G6
9	.5	5.0	4.0	3.5	.005	.005	.250	\$240	A9MT500	M6
9	.5	6.5	5.2	4.0	.3	.1	1.5	\$260	B9G650	G9
9	.5	8.0	6.5	5.0	.005	.005	.250	\$290	A9MT800	M9
9	.5	10.0	8.3	7.0	.005	.005	.250	\$335	A9MT1000	M13

*or 2 mv, whichever is greater

Nominal Output Voltage	Ad-just ±V	Output Current Amps. at			Regulation		Ripple mV RMS	Price (\$)	Model	Case Size
		40°C	55°C	71°C	Load ± %*	Line ± %*				
10	1	.500	.500	.500	.1	.05	1	\$115	B10G50	G3
10	1	1.0	1.0	1.0	.1	.1	1	\$140	B10G100	G3
10	.5	2.0	2.0	2.0	.2	.1	1.5	\$170	B10G200	G5
10	.5	3.0	2.7	2.5	.2	.1	1.5	\$195	B10G300	G6
10	.5	4.5	3.6	2.7	.005	.005	.250	\$240	A10MT450	M6
10	.5	6.0	5.0	4.0	.3	.1	1.5	\$260	B10G600	G9
10	.5	7.5	6.0	4.5	.005	.005	.250	\$295	A10MT750	M9
10	.5	10.0	8.3	7.0	.4	.1	1.5	\$300	B10G1000	G13
10	.5	10.0	8.3	7.0	.005	.005	.250	\$335	A10MT1000	M13
10	.5	14.0	11.9	9.8	.005	.005	.250	\$390	A10H1400	H8
10	.5	18.0	15.0	12.0	.005	.005	.250	\$440	A10H1800	H11
10	.5	25.0	20.0	16.5	.005	.005	.250	\$495	A10H2500	H16
12	1	.500	.500	.500	.1	.05	1	\$115	B12G50	G3
12	1	1.0	1.0	1.0	.1	.1	1	\$140	B12G100	G3
12	.5	2.0	1.7	1.5	.2	.1	1.5	\$165	B12G200	G5
12	.5	3.0	2.7	2.5	.2	.1	1.5	\$190	B12G300	G6
12	.5	3.8	3.3	2.6	.2	.1	1.5	\$200	B12G380	G6
12	.5	4.0	3.3	2.6	.005	.005	.250	\$235	A12MT400	M6
12	.5	6.5	5.3	4.0	.3	.1	1.5	\$260	B12G650	G9
12	.5	6.5	5.3	4.0	.005	.005	.250	\$290	A12MT650	M9
12	.5	9.0	7.5	6.0	.4	.1	1.5	\$300	B12G900	G13
12	.5	9.0	7.5	6.0	.005	.005	.250	\$335	A12MT900	M13
12	.5	13.0	11.0	9.1	.005	.005	.250	\$390	A12H1300	H8
12	.5	17.0	14.3	11.5	.005	.005	.250	\$440	A12H1700	H11
12	.5	21.0	17.5	14.5	.005	.005	.250	\$495	A12H2100	H16
13	1	.500	.500	.500	.1	.05	1	\$130	B13G50	G3
13	1	1.5	1.4	1.3	.1	.1	1.5	\$165	B13G150	G3
13	.5	2.0	2.0	2.0	.2	.1	1.5	\$185	B13G200	G5
13	.5	3.0	2.7	2.5	.2	.1	1.5	\$205	B13G300	G6
13	.5	3.5	3.0	2.5	.005	.005	.250	\$240	A13MT350	M6
13	.5	5.0	4.5	4.0	.2	.1	1.5	\$255	B13G500	G9
13	.5	8.0	7.5	7.0	.3	.1	1.5	\$300	B13G800	G13
13	.5	8.0	7.5	7.0	.005	.005	.250	\$335	A13MT800	M13
14	1	.500	.500	.500	.1	.05	1	\$130	B14G50	G3
14	1	1.5	1.4	1.3	.1	.1	1.5	\$165	B14G150	G3
14	.5	2.0	2.0	2.0	.2	.1	1.5	\$185	B14G200	G5
14	.5	3.0	2.7	2.5	.2	.1	1.5	\$205	B14G300	G6
14	.5	3.0	2.7	2.5	.005	.005	.250	\$235	A14MT300	M6
14	.5	5.0	4.5	4.0	.2	.1	1.5	\$250	B14G500	G9
14	.5	7.0	6.5	6.0	.3	.1	1.5	\$300	B14G700	G13
14	.5	8.0	7.5	7.0	.005	.005	.250	\$335	A14MT800	M13
15	1	.750	.750	.750	.1	.1	1	\$135	B15G75	G3
15	1	1.0	1.0	1.0	.1	.1	1	\$140	B15G100	G3
15	1	1.5	1.4	1.3	.1	.1	1.5	\$155	B15G150	G3
15	.5	2.0	1.7	1.5	.1	.1	1.5	\$170	B15G200	G5
15	.5	3.0	2.8	2.5	.1	.1	1.5	\$195	B15G300	G6
15	.5	3.0	2.8	2.5	.005	.005	.250	\$215	A15MT300	M6
15	.5	4.2	3.8	3.0	.15	.1	1.5	\$235	B15G420	G9
15	.5	5.5	4.7	4.0	.005	.005	.250	\$290	A15MT550	M9
15	.5	6.0	5.0	4.0	.2	.1	1.5	\$280	B15G600	G9
15	.5	7.0	6.0	5.0	.2	.1	1.5	\$300	B15G700	G13
15	.5	8.0	6.5	5.5	.005					



SERIES A & B

Nominal Output Voltage	Ad-just ±V	Output Current Amps. at			Regulation		Ripple mV RMS	(\$) Price	Model	Case Size
		40°C	55°C	71°C	Load ± %	Line ± %				
24	1	.300	.300	.300	.05	.05	1	\$100	B24G30	G3
24	1	.750	.750	.750	.1	.05	1	\$140	B24G75	G3
24	1	1.1	1.1	1.0	.1	.1	1.5	\$155	B24G110	G5
24	.5	1.7	1.7	1.5	.1	.1	1.5	\$170	B24G170	G5
24	.5	2.1	2.0	2.0	.1	.1	1.5	\$190	B24G210	G5
24	.5	2.1	2.0	2.0	.005	.005	.250	\$225	A24MT210	M6
24	.5	3.5	3.0	2.5	.15	.1	1.5	\$245	B24G350	G9
24	.5	3.5	3.0	2.5	.005	.005	.250	\$290	A24MT350	M9
24	.5	5.0	5.0	5.0	.15	.1	1.5	\$300	B24G500	G13
24	.5	5.5	5.0	4.5	.005	.005	.250	\$335	A24MT550	M13
24	.5	8.5	7.2	5.9	.005	.005	.250	\$390	A24H850	H8
24	.5	12.0	10.5	9.0	.005	.005	.250	\$440	A24H1200	H11
24	.5	15.0	13.0	11.0	.005	.005	.250	\$495	A24H1500	H16
25	1	.300	.300	.300	.05	.05	1	\$120	B25G30	G3
25	1	.750	.750	.750	.1	.05	1	\$145	B25G75	G3
25	1	1.1	1.1	1.1	.1	.1	1.5	\$165	B25G110	G5
25	.5	1.7	1.7	1.5	.1	.1	1.5	\$195	B25G170	G5
25	.5	2.1	2.1	2.0	.1	.1	1.5	\$200	B25G210	G5
25	.5	3.5	3.0	2.5	.15	.1	1.5	\$250	B25G350	G9
25	.5	5.0	5.0	5.0	.15	.1	1.5	\$310	B25G500	G13
28	1	.300	.300	.300	.05	.05	1	\$120	B28G30	G3
28	1	.500	.500	.500	.05	.05	1	\$135	B28G50	G3
28	1	.800	.800	.800	.1	.05	1	\$145	B28G80	G5
28	1	1.1	1.1	1.0	.1	.05	1	\$160	B28G110	G5
28	.5	1.8	1.6	1.5	.1	.1	1.5	\$190	B28G180	G5
28	.5	2.1	2.1	2.0	.1	.1	1.5	\$200	B28G210	G5
28	.5	2.1	2.1	2.0	.005	.005	.250	\$230	A28MT210	M6
28	.5	3.0	2.7	2.5	.15	.1	1.5	\$240	B28G300	G9
28	.5	3.0	2.7	2.5	.005	.005	.250	\$270	A28MT300	M9
28	.5	5.0	5.0	5.0	.15	.1	1.5	\$300	B28G500	G13
28	.5	5.0	5.0	5.0	.005	.005	.250	\$335	A28MT500	M13
28	.5	8.0	6.8	5.6	.005	.005	.250	\$390	A28H800	H8
28	.5	11.0	9.5	8.0	.005	.005	.250	\$440	A28H1100	H11
28	.5	14.0	12.0	10.0	.005	.005	.250	\$495	A28H1400	H16
30	1	.300	.300	.300	.05	.05	1	\$120	B30GT30	G3
30	1	.500	.500	.500	.05	.05	1	\$140	B30GT50	G3
30	1	1.1	1.1	1.0	.1	.1	1	\$170	B30GT110	G5
30	.5	1.7	1.6	1.5	.1	.1	1.5	\$190	B30GT170	G5
30	.5	2.1	2.1	2.0	.1	.1	1.5	\$205	B30G210	G6
30	.5	2.1	2.1	2.0	.005	.005	.250	\$235	A30MT210	M6
30	.5	3.0	2.7	2.5	.005	.005	.250	\$275	A30MT300	M9
30	.5	5.0	5.0	5.0	.15	.1	1.5	\$305	B30G500	G13
30	.5	5.0	5.0	5.0	.005	.005	.250	\$335	A30MT500	M13
30	.5	7.5	6.3	5.2	.005	.005	.250	\$395	A30H750	H8
30	.5	10.0	9.0	8.0	.005	.005	.250	\$450	A30H1000	H11
30	.5	14.0	12.0	10.0	.005	.005	.250	\$510	A30H1400	H16
32	1	.300	.300	.300	.05	.05	1	\$120	B32GT30	G3
32	1	.500	.500	.500	.05	.05	1	\$140	B32GT50	G3
32	1	1.0	1.0	1.0	.1	.1	1	\$170	B32GT100	G5
32	1	1.5	1.5	1.5	.1	.1	1.5	\$200	B32GT150	G5
32	.5	1.8	1.6	1.3	.005	.005	.250	\$245	A32MT180	M6
32	.5	2.5	2.1	1.7	.005	.005	.250	\$290	A32MT250	M9
32	.5	9.0	7.5	6.0	.005	.005	.250	\$465	A32HT900	H11
34	1	.300	.300	.300	.05	.05	1	\$120	B34GT30	G3
34	1	.800	.800	.800	.1	.1	1	\$170	B34GT80	G5
34	1	1.5	1.5	1.5	.1	.1	1.5	\$205	B34GT150	G5
35	1	.100	.100	.100	.05	.05	1	\$110	B35GT10	G3
35	1	.300	.300	.300	.05	.05	1	\$120	B35GT30	G3
35	1	.500	.500	.500	.05	.05	1	\$145	B35GT50	G3
35	1	.600	.600	.600	.1	.05	1	\$160	B35GT60	G3
35	1	.800	.800	.800	.1	.1	1.5	\$170	B35GT80	G5
36	1	.100	.100	.100	.05	.05	1	\$110	B36GT10	G3
36	1	.500	.500	.500	.05	.05	1	\$145	B36GT50	G3
36	1	.800	.750	.700	.1	.05	1	\$170	B36GT80	G5
36	.5	1.3	1.3	1.3	.1	.1	1.5	\$190	B36GT130	G6
36	.5	1.3	1.3	1.3	.005	.005	.250	\$240	A36MT130	M6
36	.5	2.3	2.0	1.8	.1	.1	1.5	\$270	B36GT230	G9
36	.5	2.3	2.0	1.8	.005	.005	.250	\$290	A36MT230	M9
36	.5	4.0	3.2	2.5	.005	.005	.250	\$345	A36MT400	M13
36	.5	8.0	6.6	5.3	.005	.005	.250	\$465	A36HT800	H11
36	.5	11.0	9.1	7.2	.005	.005	.250	\$565	A36HT1100	H16
40	1	.200	.200	.200	.05	.05	1	\$130	B40GT20	G3
40	1	.400	.400	.400	.05	.05	1	\$155	B40GT40	G3
40	1	.500	.500	.500	.1	.05	1	\$170	B40GT50	G5
40	1	1.0	1.0	1.0	.1	.1	1.5	\$195	B40GT100	G6
45	1	.200	.200	.200	.05	.05	1	\$130	B45GT20	G3
45	1	.400	.400	.400	.05	.05	1	\$165	B45GT40	G3

Nominal Output Voltage	Ad-just ±V	Output Current Amps. at			Regulation		Ripple mV RMS	(\$) Price	Model	Case Size
		40°C	55°C	71°C	Load ± %	Line ± %				
48	1	.200	.200	.200	.05	.05	1	\$130	B48GT20	G3
48	1	.400	.400	.400	.05	.05	1	\$170	B48GT40	G3
48	1	.600	.600	.600	.1	.1	1	\$205	B48GT60	G5
48	1	1.1	1.0	.600	.1	.1	1.5	\$230	B48GT110	G6
48	1	1.2	1.0	.800	.005	.005	.250	\$255	A48MT120	M6
48	1	1.8	1.6	1.2	.005	.005	.250	\$295	A48MT180	M9
48	1	3.0	2.6	2.1	.005	.005	.250	\$345	A48MT300	M13
48	1	6.0	5.0	4.0	.005	.005	.250	\$465	A48HT600	H11
48	1	8.5	7.2	5.5	.005	.005	.250	\$565	A48HT850	H16
50	1	.400	.400	.400	.05	.05	1	\$185	B50GT40	G3
50	1	.500	.500	.500	.05	.05	1	\$215	B50GT50	G5
50	1	1.0	.800	.700	.005	.005	.250	\$270	A50MT100	M6
50	1	1.5	1.3	1.0	.005	.005	.250	\$310	A50MT150	M9
50	1	2.7	2.3	1.8	.005	.005	.250	\$360	A50MT270	M13
50	1	6.0	5.0	4.0	.005	.005	.250	\$475	A50HT600	H11
50	1	8.0	6.6	5.2	.005	.005	.250	\$565	A50HT800	H16
55	1	.500	.500	.500	.05	.05	1	\$225	B55GT50	G5
60	1	.200	.200	.200	.05	.05	1	\$155	B60GT20	G3
60	1	.300	.300	.300	.05	.05	1	\$190	B60GT30	G3
60	1	.400	.400	.400	.05	.05	1	\$225	B60GT40	G5
60	1	.850	.720	.600	.005	.005	.250	\$275	A60MT85	M6
60	1	1.2	1.0	.800	.005	.005	.250	\$310	A60MT120	M9
60	1	2.5	2.1	1.7	.005	.005	.250	\$360	A60MT250	M13
60	1	5.0	4.1	3.3	.005	.005	.250	\$480	A60HT500	H11
60	1	7.0	5.8	4.6	.005	.005	.250	\$570	A60HT700	H16
65	1	.300	.300	.300	.05	.05	1	\$190	B65GT30	G3
70	1	.100	.100	.100	.05	.05	1	\$145	B70GT10	G3
70	1	.300	.300	.300	.05	.05	1	\$190	B70GT30	G3
75	1	.050	.050	.050	.05	.05	1	\$130	B75GT05	G3
75	1	.200	.200	.200	.05	.05	1	\$185	B75GT20	G3
75	1	.600	.500	.400	.005	.005	.250	\$275	A75MT60	M6
75	1	1.0	.830	.660	.005	.005	.250	\$325	A75MT100	M9
75	1	2.0	1.8	1.5	.005	.005	.250	\$360	A75MT200	M13
75	1	4.0	3.3	2.6	.01	.01	1	\$480	A75HT400	H11
75	1	5.6	4.6	3.6	.01	.01	1	\$575	A75HT560	H16
80	1	.100	.100	.100	.05	.05	1	\$160	B80GT10	G3
80	1	.200	.200	.200	.05	.05	1	\$190	B80GT20	G3
85	1	.200	.200	.200	.05	.05	1	\$190	B85GT20	G3
90	1	.200	.200	.200	.05	.05	1	\$190	B90GT20	G3
90	1	.500	.400	.300	.005	.005	.250	\$275	A90MT50	M6
90	1	.800	.700	.600	.005	.005	.250	\$325	A90MT80	M9
90	1	1.5	1.3	1.0	.005	.005	.250	\$360	A90MT150	M13
90	1	3.3	2.7	2.1	.01	.01	1	\$490	A90HT330	H11
90	1	4.4	3.6	2.9	.01	.01	1	\$580	A90HT440	H16
95	1	.200	.200	.200	.05	.05	1	\$195	B95GT20	G3
100	1	.100	.100	.100	.05	.05	1	\$180	B100GT10	G3
100	1	.200	.200	.200	.05	.05	1	\$195	B100GT20	G3
100	1	.460	.460	.340	.1	.1	1.5	\$240	B100GT46	G6
100	1	.650	.650	.650	.1	.1	1.5	\$270	B100G65	G6
100	1	.700	.600	.500	.005	.005	.250	\$310	A100M70	M6
100	1	1.3	1.2	1.0	.005	.005	.250	\$360	A100MT130	M13
100	1	3.0	2.5	2.0	.01	.01	1	\$490	A100HT300	H11
100	1	4.0	3.3	2.6	.01	.01	1	\$580	A100HT400	H16
110	1	.200	.200	.200	.05	.05	1	\$200	B110GT20	G3
120	1	.100	.100	.100	.05	.05	1	\$185	B120GT10	G3
120	1	.200	.200	.200	.05	.05	1	\$200	B120GT20	G3
120	1	.400	.400	.300	.1	.1	1.5	\$235	B120GT40	G6
120	1									

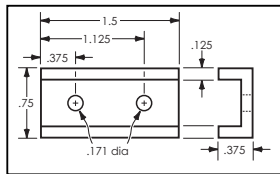

WALL MOUNTING KITS ...\$8

These kits provide a way of mounting power supplies on a wall or panel when the other side of the mounting surface is inaccessible. Each kit consists of four aluminum brackets and four machine screws for fastening them to the power supply, effectively adding mounting flanges to the power supply.

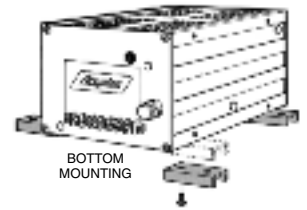

For Gold Box and modular High Voltage power supplies:

GB8 Mounting Kit (#8-32 mounting holes)

Can be used on these case sizes:

CM6, CM9, CM13, CH11, CH16, DG5, DG6, DG9, G3, G5, G5D, G6, G9, G13, GT5, GT6, GT9, GT13, H8, H11, H16, HD345, HD355, HA349, HA359, HT11, HT16, M6, M9, M13, RM6, RW6 TG5, TG6, TG9, TG13, TH11, WG7, WM6, WM9, Y3, Y5, Y6, YH11, YA

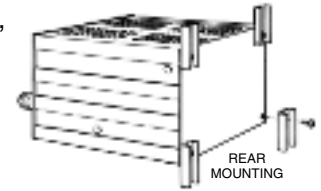

For Narrow Profile power supplies:

NP6 Mounting Kit (#6-32 mounting holes)

Can be used on these case sizes:

AMC, CN8T, DN6B, DN6A, DN8A, DN8, F6T, F8T, N8T, WL9, WN6A, WN6B, WN8, WN8A, TN6T

NP6L Mounting Kit (#6-32 mounting holes)

Model NP6L consists of two brackets 1.5" long as shown above, and two 2.5" long brackets (to extend beyond heat sink).

Can be used on these case sizes:

CN8H, N8H, TN8H

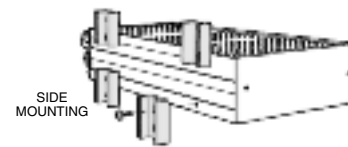

DIN RAIL MOUNTING KITS ...\$15

NPH35DIN Mounting Kit (Horizontal mounting)

Can be used on these case sizes:

CN8H	DN6A	F6T	N8H	TN6T	WN6A
CN8T	DN6B	F8T	N8T	TN8H	WN6B
	DN8				WN8
	DN8A				WN8A

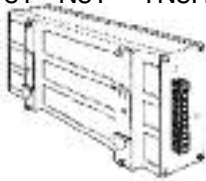

GR35DIN Mounting Kit (Rear mounting)

Can be used on these case sizes:

CM6	DG5	G3	GT5	HD345	M6	RM6	TG5	Y3
CM9	DG6	G5	GT6	HD355	M9	RW6	TG6	Y5
	DG9	G5D	GT9				TG9	Y6
		G6						
		G9						

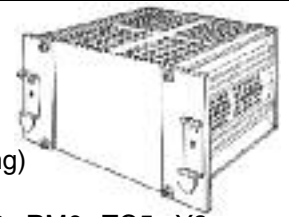

(Can be used, but not recommended on case sizes: G13, GT13, M13, TG13)

NPV35DIN Mounting Kit (Vertical mounting)

Can be used on these case sizes:

CN8H	DN6A	F6T	N8H	TN6T	WN6A
CN8T	DN6B	F8T	N8T	TN8H	WN6B
	DN8				WN8
	DN8A				WN8A



GH35DIN Mounting Kit (Horizontal mounting)

Can be used on these case sizes:

CM6	DG5	G3	GT5	M6	TG5	Y3
CM9	DG6	G5	GT6	M9	TG6	Y5
CM13	DG9	G5D	GT9	M13	TG9	Y6
		G6	GT13		TG13	
		G9				
		G13				

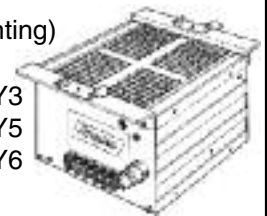

WL35DIN Mounting Kit (Vertical mounting)

Can be used on this case size: WL9

NPR35DIN Mounting Kit (Rear mounting)

Can be used on these case sizes:

CN8H	F6T	N8H	TN6T
CN8T	F8T	N8T	TN8H

CH35DIN Mounting Kit (Horizontal mounting)

Can be used on these case sizes: RM6, RW6

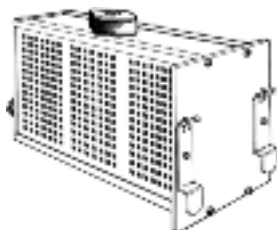

WH35DIN Mounting Kit (Horizontal mounting)

Can be used on these case sizes: WM6, WM9



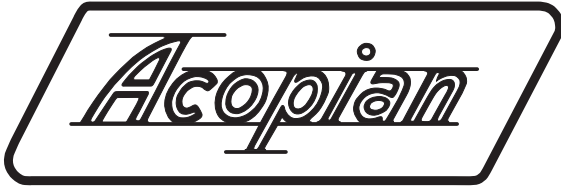

“Whenever I need a power supply for any project, I always check Acopian first. Your customer service is first rate, and I really like the fast, dependable shipping. The reliability of your products is an additional bonus – they seem to last forever.”

- Gudrun Kleist, Engineering Associate
Lawrence Berkeley National Laboratory

About Acopian’s 3 Day Shipment Guarantee:

In 1964, Acopian initiated its “3 Day Shipping Guarantee.” Since then our product offerings have expanded to include many more lines of power supplies that ship within 3 Days as well as others that ship within 6 or 9 Days. These guarantees apply to every model in the Acopian catalog.

Our unique 3-day shipping guarantee has prompted many questions. Below are some of those most often asked:

What does Acopian’s 3-day shipping promise mean?

It means that power modules listed in this catalog are shipped within 3 days after we receive your order. High Voltage, Redundant, Rack Mounting, Systems and certain Switching power supplies are shipped within 9 days.

Has Acopian ever failed to meet this promise?

Never.

Do options affect shipping time?

The 230 volt input option and moisture/fungus-proofing option require two additional days. All other options do not affect shipping time.

Is the 3-day promise affected by quantity? Suppose we need 50 or 100 pieces?

The 3-day promise applies to orders for five or less modules. (Two or less for 9-day items). If requested, Acopian will ship five pieces of a larger order in 3 days and, with consideration of your requirement, schedule the balance. (Since each shipment is processed and priced as a separate order, for lowest prices request shipment in one lot.)

What if I need four or five different models? Does the 3-day promise still apply?

Yes. Guaranteed 3-day shipment applies to one model or to a combination of models.

Do I have to ask for 3-day shipment of my order?

3-day shipment is automatic. In fact, you must tell us if you want the shipment delayed.

How long after you ship will I have the power supplies?

Transportation time varies with the carrier used. Unless otherwise requested, Acopian ships small orders by UPS Ground.

You say Acopian has never failed to meet the 3-day promise. How do you do it?

Our facilities have been designed and equipped to meet our 3-day shipment promise. When your order is received, your power supplies are built specifically for you and shipped within three days. We do not ship from stock. (For this reason, we are unable to accept returns for credit.)

I’ve seen other power supply manufacturers advertise “same-day shipment.” Isn’t that better than 3-day shipment?

A typical vendor’s “same-day shipment” advertisement can only be fulfilled if the power supplies you need are in stock. Otherwise, a four to six week delay is not unusual before inventory is replenished and your order is shipped.

Acopian’s 3-day shipment promise applies to ALL 3 Day models (larger units ship within 9 Days) and is not dependent on the quantity in stock. We build each unit after the order for that unit is received. If an order is needed faster, often times we can ship in less than 3 days.

If you require shipment even earlier than our standard promise, just let us know, we can usually ship sooner. We welcome the opportunity to work with you.

ACOPIAN...

...answers your phone call with a live salesperson

No automated menus. The person who answers your call will courteously and promptly answer your questions, quote price and delivery, expedite your urgent requirements, and offer you immediate access to our engineers.

Call toll free 800-523-9478.

...can customize power supplies for you

If a standard power supply does not meet all of your requirements, speak with one of our engineers. We can often modify the specifications, ratings and configuration of a supply. We can also combine several power supplies into a Multiple Output Power System with the operating features you specify (such as meters and switches) and ship it within 9 Days!

...has a 5-year warranty

This is typical: One of our customers sent us an old power supply with a note indicating that the supply had been in continuous use since 1972 (33 years!), but he had recently noticed that the output voltage was low. We found that the capacitors had dried up, replaced them and returned the supply to the customer, who thanked us and said he intends to keep using it. We focus on making power supplies that will last a long time. There are power supplies that cost less than ours, or that are smaller than ours, but you won’t find any that last longer than ours. All too often, low-priced supplies are densely packed, run hot, have short lifetimes and short warranties. All Acopian metal-cased power products have a 5-year warranty, but you can expect them to last a lot longer.

Purchase Acopian... 3-day shipment, long lasting power supplies, and unsurpassed customer service.

“In my business, Acopian is referred to as bulletproof. It never fails and lasts forever.”

- Steve Andrews, President
Technical Options, Inc.

“If Acopian made automobiles, I’d buy one without question.”

- David A. Price, Research Technologist
Georgia Tech Research Institute

ORDERING INFORMATION & Terms and Conditions

ACOPIAN SELLS FACTORY DIRECT WORLDWIDE: We do not use representatives or distributors. Contact Acopian for technical information or a quote.

WARRANTY: Acopian power supplies are warranted to be free from defects in material and workmanship for a period of five years (encapsulated devices, for one year) from date of original shipment. Acopian's obligation under this warranty is limited to repairing any power supply returned to the factory Service Department in Easton, PA and replacing any defective parts. Mini Encapsulated power supplies are not repairable. Authorization must be obtained from Acopian before a power supply may be returned for repair. Units must be well packed when shipping to Acopian; the repair of any damage incurred during shipment will be charged. Transportation charges are to be paid by the purchaser. A reinspection and handling charge will be applied to returned units found to have no defects. If a failure has been caused by misuse, operation in excess of specifications, or modification by the customer, repairs will be billed at cost; in such cases, a cost estimate will be submitted before work is started.

Acopian reserves the right to make changes or improvements in its products without incurring any obligation to install the same on products previously manufactured.

This warranty is in lieu of all other warranties, obligations, and liabilities, expressed or implied, and is the purchaser's exclusive remedy. Acopian makes no warranty, either express or implied, of merchantability, fitness for a particular purpose or otherwise. In no event shall Acopian be liable whether in contract, tort, or negligence, for special, indirect, incidental or consequential damages of any kind, including loss of business or profits, or any other losses incurred by the purchaser or any third party, the Customer's remedies being limited, at Acopian's option, to replacement, repair or credit at the price on the date of claim.

The validity, performance and construction of all terms and conditions and any sale made by Acopian shall be determined by the law of Pennsylvania, without regard to its conflict of law principles, and all parties to the transaction expressly consent to the jurisdiction of such courts and consent to the venue of the Court of Common Pleas for Northampton County, Pennsylvania.

PRICES: The prices shown are F.O.B. our factory; Easton, PA. or Melbourne, FL.. All prices and specifications are subject to change without notice. Minimum order is \$50.00.

TERMS: Net 30 days, subject to credit approval. Visa, MasterCard and American Express also accepted.

SHIPPING: Location permitting, small shipments are made by United Parcel Service, or by Parcel Post; larger shipments, by insured motor freight collect. Shipments can be made by air upon request. Risk of loss shall be F.O.B. Our Factory, even in cases where freight may be prepaid or allowed to destination by Acopian. If equipment is received in damaged condition, it is the customer's responsibility to contact the carrier and file a claim for damages.

TIME FOR DELIVERY: The time for delivery quoted by Acopian is the time required to ship from our plants. We will not be liable for delays in delivery caused by any reason beyond our control, including but not limited to acts of God, casualty, civil disturbance, labor disputes, transportation or supply difficulties, or any interruption of our facilities, and the quoted time for delivery shall be extended during the continuance of such conditions and for a reasonable time thereafter. In no event will Acopian be liable for any premium transportation, procurement, or similar costs incurred by the Customer as a result of conditions beyond Acopian's control resulting in Acopian's inability to deliver product in accordance with customer's requested delivery schedules.

QUANTITY DISCOUNTS: Discounts are available to quantity buyers and are dependent upon the order quantity and the manufacturing scheduling anticipated by the order, and apply only to the quantity and delivery ordered. Partial shipments are considered as separate orders for discounting purposes.

EXPORT ORDERS: A minimum export documentation charge of \$60.00 applies. (A minimum charge of \$25.00 applies on orders requiring customs forms for Canadian orders and for orders to certain U.S. territories.)

MOISTURE/FUNGUS PROOFING: Power supplies can be furnished with a moisture and fungus resistant varnish applied to interior surfaces. To order, add the suffix letter F to the model number. The additional cost is \$25.00 per output and requires two additional days. Not available on High Voltage, Mini Encapsulated, Rack Mounting, and Gold Box Switching models.

TAGGING: Maximum of 15 characters/spaces. Add \$10.00 to price.

TEST DATA: Cost, \$35.00 or 2% of order, whichever is greater.

SPECIAL MODELS/MODIFICATIONS: Cataloged models can be altered at the factory to meet special requirements. Contact the Applications Engineering Department to discuss your needs.

PARTS: The designs used in Acopian power supplies utilize standard components to the greatest practical extent. When replacements are required, the types originally used, or their equivalents, can usually be obtained most quickly from a local electronic components distributor.

Special components, such as transformers, are stocked at the factory warehouses. Contact the Applications Engineering Department for information on the parts required, referencing the model number of the power supply, the circuit designation of the component, and a description.

PURCHASE ORDER ACCEPTANCE: Orders are accepted subject to Acopian's Terms and Conditions. Any Terms and Conditions of any Purchaser's order, agreement, or understanding which are in addition to or inconsistent with Acopian's shall not be binding upon Acopian unless made in writing and accepted over the signature of an authorized officer of Acopian. Orders shall not be considered accepted until entered into production at our plant. Acopian reserves the right to refuse any order. All typographical and clerical errors are subject to correction by Acopian.

RETURNED GOODS: Acopian products are built on a per-order basis, and ordinarily no credit can be extended for their return. No goods will be accepted for return unless authorized in writing by Acopian.

CHANGES: The customer may, by a written notice, request changes within the general scope of the order, in the drawings, designs or specifications; method of shipment; and place of delivery. If any such change causes an increase or decrease in the cost, or the time required for the processing of any part of the order, an equitable adjustment shall be made in the price or delivery schedule, or both, and the order shall be modified in writing accordingly.

CANCELLATION: Suspension or cancellation of orders may be made only upon our written approval and on terms that will indemnify us against all loss.

OVERTIME: It is anticipated that any order will be processed during regular working hours on regular working days. If for any reason the Purchaser requests Acopian to process the order, or any portion of it, outside of such regular working hours, any overtime or other additional expense occasioned thereby shall be billed to and paid by the Purchaser as an extra cost. Acopian reserves the right to decline to process the order outside regular working hours.

CUSTOMER DELAY OF WORK: If the performance of all or any part of the work is delayed or interrupted by Customer's failure to act within the time specified (or within a reasonable time if no time is specified) and such act is not expressed or implied by the order, an adjustment shall be made in the cost of performance of the order caused by such delay or interruption and the order modified in writing accordingly. Adjustment will also be made in the delivery or performance dates and any other contractual provisions affected by such delay or interruption.

GOVERNMENT SPECIFICATIONS: Pricing is based upon industrial-grade construction, marking, packing, and packaging. Exception is taken to any MIL specifications, and to any requirements for the use of special forms, documentation other than quoted, and Government Source Inspection. Acopian must decline to quote on any other basis.

APPLICATIONS ASSISTANCE: *Questions regarding the specifications, features, and use of any Acopian product should be directed to the Applications Engineering Department. A staff of power supply specialists will be pleased to assist you.*

www.acopian.com - Online Ordering and Instant Quotes Online!



Since 1957

Acopian Technical Company

P.O. Box 638, Easton, PA 18044 • Phone: (610) 258-5441 • FAX: (610) 258-2842

Call toll free: (800) 523-9478 (International: Country Code 01)

**ALL ACOPIAN
POWER SUPPLIES
MADE IN U.S.A.**



PHOTO COURTESY OF THE ICECUBE PROJECT

“At Project IceCube, it’s absolutely critical to have a good power supply. The ice must be as pure and clear as possible. If the power to the ice top sensor system were to fail, we would risk the tank water freezing without being controlled, resulting in bubbles and impurities, and very much reducing the quality of ice and quality of information that we can see with our detectors. We chose Acopian power supplies to power our pumping and degassing systems because of their reputation for reliability. The people at Acopian met all of our highly demanding specifications and, despite very little time until our window to ship to the Pole, they met our schedule. We were 100% satisfied.”

Jim Baccus
Cable System Manager
Project IceCube

(the international high-energy neutrino observatory being built and installed in the ice below South Pole Station)

The world’s most demanding environments demand Acopian power systems.

Design your own Acopian power system online with the System Builder at www.acopian.com. Simply enter your requirements, and you’ll receive a quotation for fully wired multiple-output power systems, without the need for you to prepare mechanical layouts or search through a power supply catalog.

Each system will be completely wired, tested and shipped within 9 days after receipt of the order. Choose Acopian – the power supplies of choice for the world’s leading engineers.



ALL ACOPIAN POWER SUPPLIES
MADE IN U.S.A.

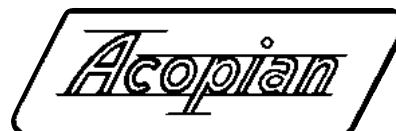

Acopian Technical Company

1-800-523-9478 • www.acopian.com