

Features

- 50A Peak Pulse Current @ 10/1000 μ s
- 250A Peak Pulse Current @ 8/20 μ s
- 58 - 320V Stand-Off Voltages
- Oxide-Glass Passivated Junction
- Bi-Directional Protection In a Single Device
- High Off-State impedance and Low On-State Voltage
- Helps Equipment Meet GR-1089-CORE, IEC 61000-4-5, FCC Part 68, ITU-T K.20/K.21, and UL497B
- UL Listed Under Recognized Component Index, File Number 156346
- **Lead Free Finish/RoHS Compliant (Note 1)**

Mechanical Data

- Case: SMB
- Case Material: Molded Plastic. UL Flammability Classification Rating 94V-0
- Moisture Sensitivity: Level 1 per J-STD-020C
- Terminals: Lead Free Plating (Matte Tin Finish). Solderable per MIL-STD-202, Method 208
- Polarity: None; Bi-Directional Devices Have No Polarity Indicator
- Marking: Date Code and Marking Code (See Page 4)
- Ordering Information: See Page 4
- Weight: 0.093 grams (approximate)

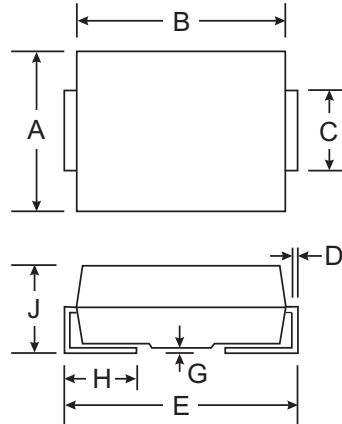

SMB		
Dim	Min	Max
A	3.30	3.94
B	4.06	4.57
C	1.96	2.21
D	0.15	0.31
E	5.00	5.59
G	0.10	0.20
H	0.76	1.52
J	2.00	2.62
All Dimensions in mm		

Maximum Ratings @ T_A = 25°C unless otherwise specified

Single phase, half wave, 60Hz, resistive or inductive load.
For capacitive load, derate current by 20%.

Characteristic	Symbol	Value	Unit
Non-Repetitive Peak Impulse Current @10/1000us	I _{pp}	50	A
Non-Repetitive Peak On-State Current @8.3ms (one-half cycle)	I _{TSM}	30	A
Junction Temperature Range	T _j	-40 to +150	°C
Storage Temperature Range	T _{STG}	-55 to +150	°C
Thermal Resistance, Junction to Lead	R _{θJL}	20	°C/W
Thermal Resistance, Junction to Ambient	R _{θJA}	100	°C/W
Typical Positive Temperature Coefficient for Breakdown Voltage	ΔVBR/ΔT _j	0.1	%/°C

Maximum Rated Surge Waveform

Waveform	Standard	I _{pp} (A)
2/10 us	GR-1089-CORE	300
8/20 us	IEC 61000-4-5	250
10/160 us	FCC Part 68	150
10/700 us	ITU-T, K.20/K.21	100
10/560 us	FCC Part 68	75
10/1000 us	GR-1089-CORE	50

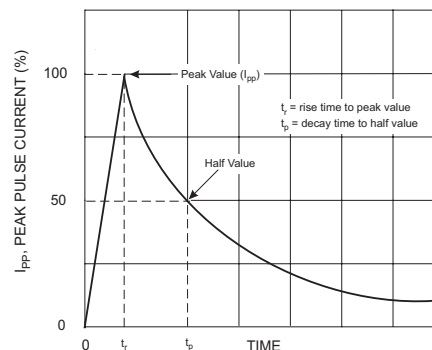

Electrical Characteristics @ $T_A = 25^\circ\text{C}$ unless otherwise specified

Part Number	Rated Repetitive Off-State Voltage	Off-State Leakage Current @ V_{DRM}	Breakover Voltage	On-State Voltage @ $I_T = 1\text{A}$	Breakover Current I_{BO}		Holding Current I_{H}		Off-State Capacitance	Marking Code
	V_{DRM} (V)	I_{DRM} (μA)	V_{BO} (V)	V_{T} (V)	Min (mA)	Max (mA)	Min (mA)	Max (mA)	C_{O} (pF)	
TB0640M	58	5	77	3.5	50	800	150	800	140	T064M
TB0720M	65	5	88	3.5	50	800	150	800	140	T072M
TB0900M	75	5	98	3.5	50	800	150	800	140	T090M
TB1100M	90	5	130	3.5	50	800	150	800	90	T110M
TB1300M	120	5	160	3.5	50	800	150	800	90	T130M
TB1500M	140	5	180	3.5	50	800	150	800	90	T150M
TB1800M	160	5	220	3.5	50	800	150	800	90	T180M
TB2300M	190	5	265	3.5	50	800	150	800	60	T230M
TB2600M	220	5	300	3.5	50	800	150	800	60	T260M
TB3100M	275	5	350	3.5	50	800	150	800	60	T310M
TB3500M	320	5	400	3.5	50	800	150	800	60	T350M

Symbol	Parameter
V_{DRM}	Stand-off Voltage
I_{DRM}	Leakage current at stand-off voltage
V_{BR}	Breakdown voltage
I_{BR}	Breakdown current
V_{BO}	Breakover voltage
I_{BO}	Breakover current
I_{H}	Holding current NOTE: 2
V_{T}	On state voltage
I_{PP}	Peak pulse current
C_{O}	Off-state capacitance NOTE: 3

- Notes:
- RoHS revision 13.2.2003. Glass and High Temperature Solder Exemptions Applied, see *EU Directive Annex Notes 5 and 7*.
 - $I_{\text{H}} > (V_{\text{L}}/R_{\text{L}})$ If this criterion is not obeyed, the TSPD triggers but does not return correctly to high-resistance state. The surge recovery time does not exceed 30ms.
 - Off-state capacitance measured at $f = 1.0\text{MHz}$, $1.0V_{\text{RMS}}$ signal, $V_{\text{R}} = 2V_{\text{DC}}$ bias.

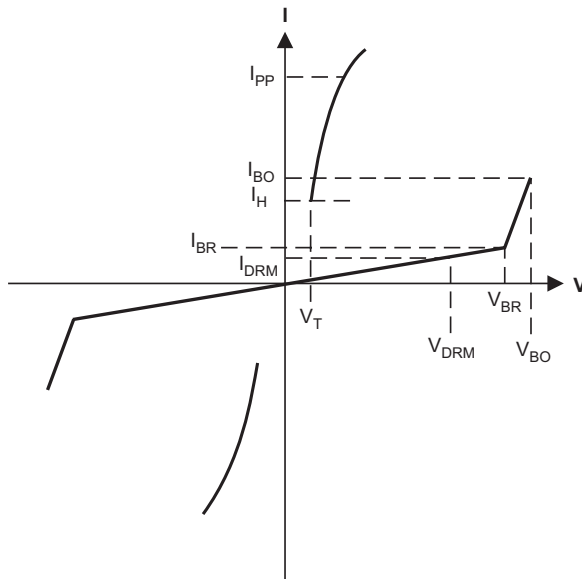

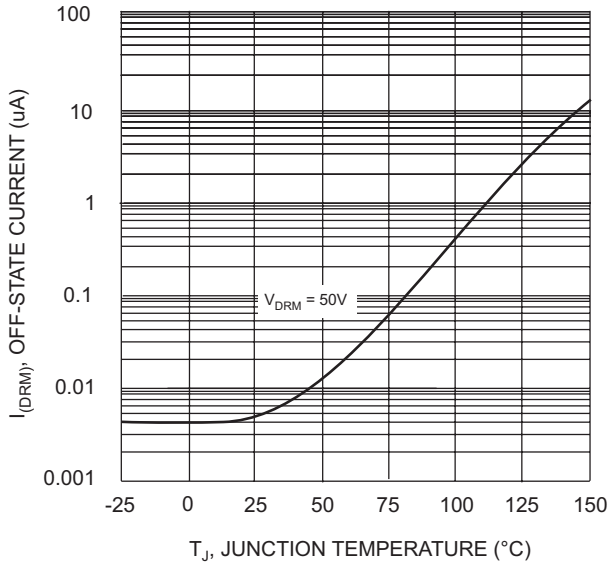

Fig. 1 Off-State Current vs. Junction Temperature

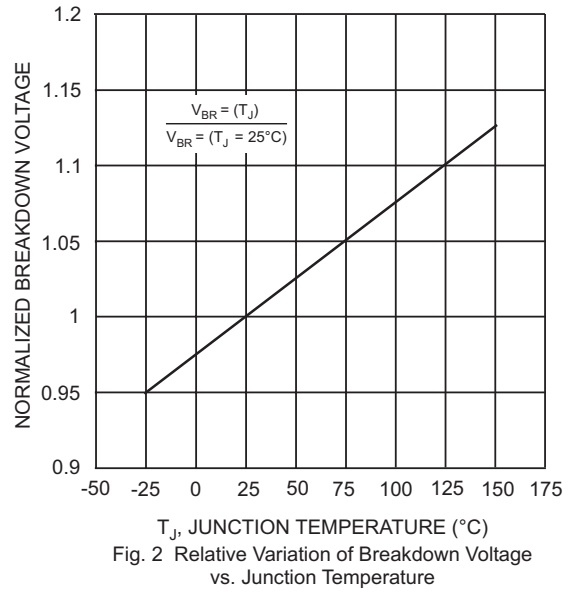

Fig. 2 Relative Variation of Breakdown Voltage vs. Junction Temperature

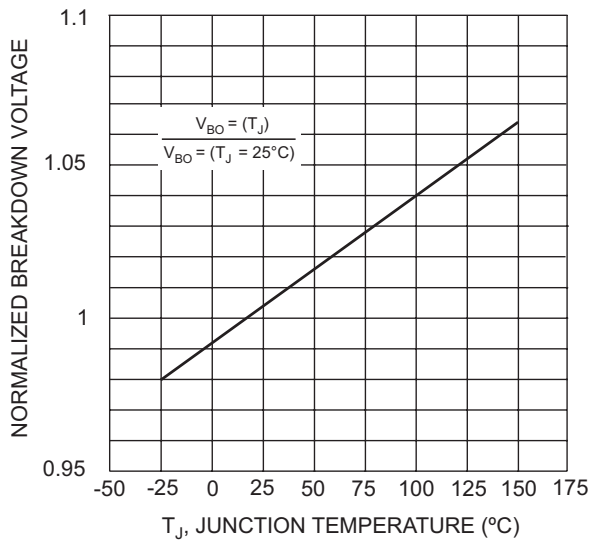

Fig. 3 Relative Variation of Breakover Voltage vs. Junction Temperature

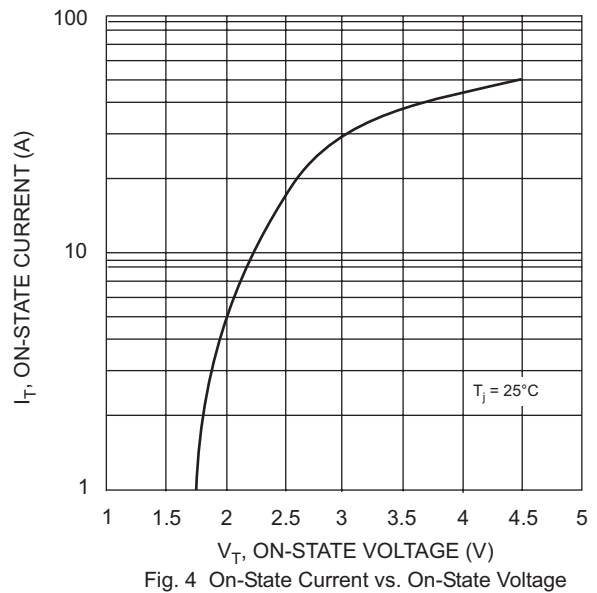

Fig. 4 On-State Current vs. On-State Voltage

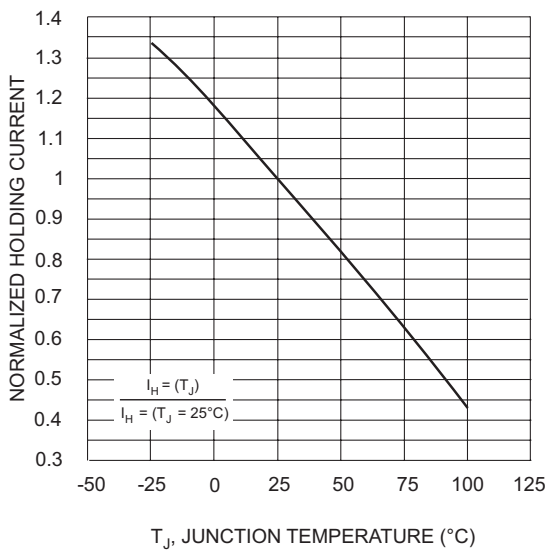

Fig. 5 Relative Variation of Holding Current vs. Junction Temperature

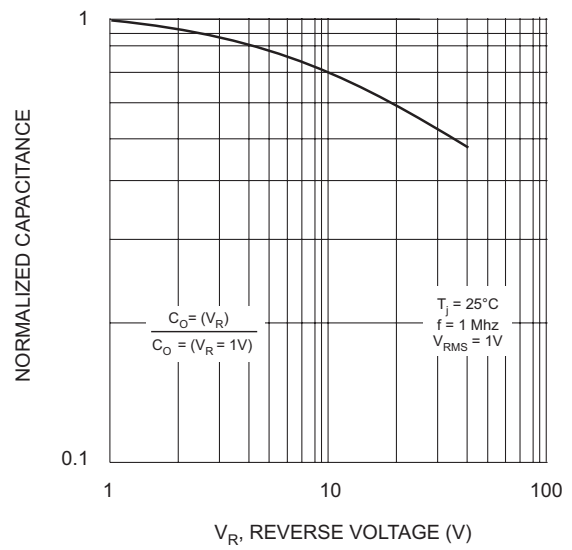

Fig. 6 Relative Variation of Junction Capacitance vs. Reverse Voltage Bias

Ordering Information (Note 4)

Device	Packaging	Shipping
TB0640M-13-F	SMB	3000/Tape & Reel
TB0720M-13-F	SMB	3000/Tape & Reel
TB0900M-13-F	SMB	3000/Tape & Reel
TB1100M-13-F	SMB	3000/Tape & Reel
TB1300M-13-F	SMB	3000/Tape & Reel
TB1500M-13-F	SMB	3000/Tape & Reel
TB1800M-13-F	SMB	3000/Tape & Reel
TB2300M-13-F	SMB	3000/Tape & Reel
TB2600M-13-F	SMB	3000/Tape & Reel
TB3100M-13-F	SMB	3000/Tape & Reel
TB3500M-13-F	SMB	3000/Tape & Reel

Notes: 4. For Packaging Details, go to our website at <http://www.diodes.com/datasheets/ap02007.pdf>.

Marking Information



XXXXX = Product Type Marking Code (See Table on Page 2)
 YWW = Date Code Marking
 Y = Year ex: 2 = 2002
 WW = Week Code 01 to 52

Date Code Key

Year	2002	2003	2004	2005	2006	2007	2008	2009
Code	2	3	4	5	6	7	8	9

IMPORTANT NOTICE

Diodes, Inc. and its subsidiaries reserve the right to make changes without further notice to any product herein to make corrections, modifications, enhancements, improvements, or other changes. Diodes, Inc. does not assume any liability arising out of the application or use of any product described herein; neither does it convey any license under its patent rights, nor the rights of others. The user of products in such applications shall assume all risks of such use and will agree to hold Diodes Incorporated and all the companies whose products are represented on our website, harmless against all damages.

LIFE SUPPORT

The products located on our website at www.diodes.com are not recommended for use in life support systems where a failure or malfunction of the component may directly threaten life or cause injury without the express written approval of Diodes Incorporated.