

Coaxial

Power Splitter/Combiner

ZCSC-3-R3

3 Way-0° 50Ω 2 to 300 MHz



CASE STYLE: UU233

Connectors	Model	Price	Qty.
SMA	ZCSC-3-R3	\$43.95	(1-9)

Maximum Ratings

Operating Temperature	-55°C to 100°C
Storage Temperature	-55°C to 100°C
Power Input (as a splitter)	1W max.
Internal Dissipation	0.375W max.

Coaxial Connections

SUM PORT	S
PORT 1	1
PORT 2	2
PORT 3	3

Outline Drawing

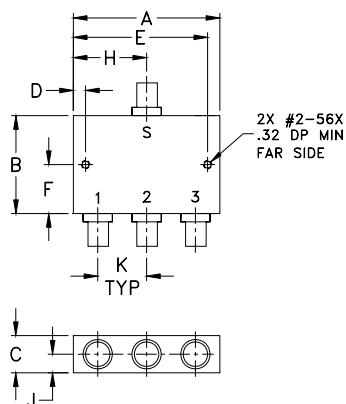

Outline Dimensions (inch/mm)

A	B	C	D	E	F	
1.50	1.00	.38	.125	1.375	5.70	
38.10	25.40	9.65	3.18	34.93	12.70	
G	H	J	K			wt
--	.75	.19	.50			grams
--	19.05	4.83	12.70			28

Features

- low insertion loss, 0.4 dB typ.
- high isolation, 31 dB typ.
- excellent VSWR, 1.1:1 typ.
- excellent phase unbalance 1 deg. typ.
- rugged shielded case

Applications

- VHF/UHF
- instrumentation
- communication system

Electrical Specifications

FREQ. RANGE (MHz)	ISOLATION (dB)						INSERTION LOSS (dB) ABOVE 4.8 dB						PHASE UNBALANCE (Degrees)			AMPLITUDE UNBALANCE (dB)		
	L		M		U		L		M		U		L	M	U	L	M	U
f_L - f_U	Typ.	Min.	Typ.	Min.	Typ.	Min.	Typ.	Max.	Typ.	Max.	Typ.	Max.	Max.	Max.	Max.	Max.	Max.	Max.
2-300	32	28	31	28	32	22	0.3	0.8	0.4	1.0	0.8	1.2	1.0	2.0	3.0	0.1	0.3	0.3

L = low range [f_L to $10 f_L$] M = mid range [$10 f_L$ to $f_U/2$] U = upper range [$f_U/2$ to f_U]

Typical Performance Data

Freq. (MHz)	Insertion Loss (dB)			Amp. Unbal. (dB)	Isolation (dB)			Phase Unbal. (deg.)	VSWR S	VSWR 1	VSWR 2	VSWR 3
	S-1	S-2	S-3		1-2	1-3	2-3					
2.00	5.07	5.06	5.07	0.00	31.14	31.55	31.03	0.03	1.11	1.09	1.09	1.09
4.00	5.05	5.04	5.05	0.01	31.99	32.25	31.85	0.02	1.11	1.07	1.07	1.07
14.00	5.05	5.04	5.05	0.01	32.30	32.50	32.24	0.05	1.11	1.06	1.06	1.06
20.00	5.05	5.04	5.05	0.01	32.17	32.44	32.21	0.04	1.10	1.05	1.05	1.05
44.00	5.08	5.07	5.08	0.01	31.81	32.22	31.97	0.09	1.09	1.04	1.04	1.04
68.00	5.10	5.09	5.11	0.01	31.49	32.04	31.82	0.23	1.08	1.03	1.03	1.03
92.00	5.11	5.11	5.12	0.01	31.25	32.01	31.79	0.32	1.07	1.03	1.03	1.02
120.00	5.13	5.13	5.16	0.03	31.15	32.15	31.93	0.33	1.07	1.04	1.04	1.04
150.00	5.18	5.18	5.25	0.06	31.34	32.56	32.42	0.42	1.06	1.04	1.05	1.05
180.00	5.17	5.17	5.26	0.09	31.91	33.29	33.26	0.45	1.04	1.03	1.03	1.04
220.00	5.19	5.20	5.33	0.14	33.67	35.24	35.57	0.56	1.04	1.04	1.04	1.04
250.00	5.30	5.31	5.47	0.18	36.27	37.44	39.06	0.68	1.10	1.07	1.07	1.09
270.00	5.28	5.30	5.48	0.21	38.73	38.61	42.11	0.76	1.14	1.08	1.08	1.10
290.00	5.29	5.31	5.51	0.23	40.66	38.38	42.54	0.72	1.17	1.07	1.08	1.11
300.00	5.29	5.31	5.54	0.25	40.04	37.45	40.72	0.81	1.18	1.07	1.07	1.10

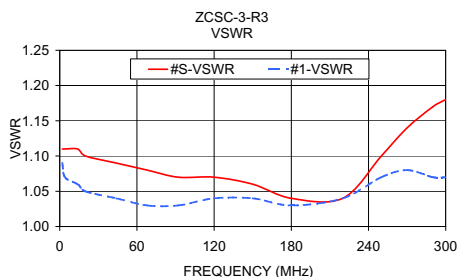
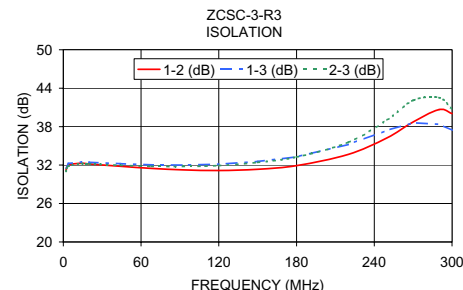
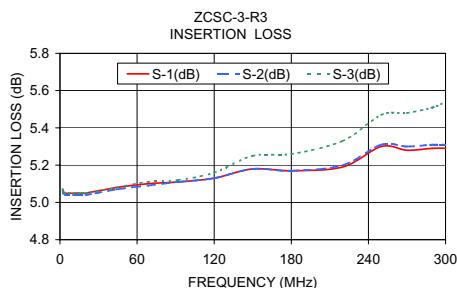

electrical schematic

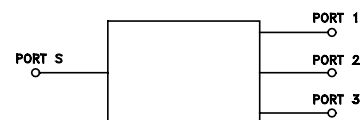

Mini-Circuits
ISO 9001 ISO 14001 CERTIFIED

ALL NEW
minicircuits.com

P.O. Box 350166, Brooklyn, New York 11235-0003 (718) 934-4500 Fax (718) 332-4661 For detailed performance specs & shopping online see Mini-Circuits web site



The Design Engineers Search Engine Provides ACTUAL Data Instantly From MINI-CIRCUITS At: www.minicircuits.com

REV. OR
M94793
ZCSC-3-R3
HY/TD/CP
080229

RF/IF MICROWAVE COMPONENTS