

SQD TYPE

SMD EMI FILTER



FEATURE

- The rated current indicates the value of current when the inductance is 10% lower than its initial value at DC superposition or DC current when $\Delta t = 45^\circ\text{C}$, whichever is lower
- Test FREQ: 100MHz

SHAPES & DIMENSION

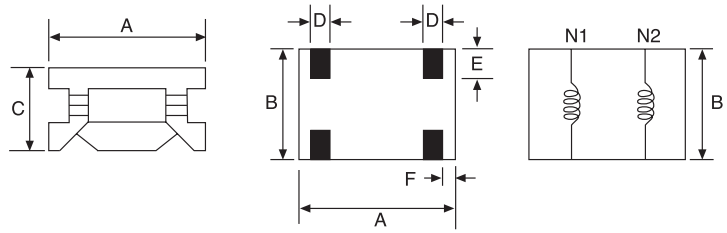

Dimension in m/m

PART NO.	A (± 0.3)	B (± 0.3)	C (± 0.3)	D (min)	E (min)	F (± 0.1)
SQD465516	4.6	5.5	1.6	0.5	1.0	0.2
SQD508505	5.0	8.5	5.0	1.0	1.5	0.2
SQD750603	7.5	6.0	3.0	1.5	1.5	0.7
SQD100805	10.0	8.0	5.0	1.8	1.5	0.8
SQD121006	12.0	10.0	6.0	2.0	1.5	1.0

APPLICATION

- DC/DC converter
- Power supplies for:
Portable communication equipment
- Camcorder
- LCD TV
- Notebook computer

STANDARD SPECIFICATION

Part Number	Impedance (Ω) at 100 MHz. Min	DC Resistance (m Ω) Max.	Rated Current (A) Max.
SQD465516-151	200	100	2A
SQD465516-351	400	100	2A
SQD508505-202	2000	75	2.5
SQD750603-601	600	45	2.0
SQD750603-701	700	50	2.0
SQD100805-701	700	45	4.0
SQD100805-901	900	50	4.0
SQD121006-801	800	30	5.0
SQD121006-751	750	40	5.0
SQD121006-701	700	45	5.0

STANDARD PACKAGING/TAPE DIMENSION

REEL DIMENSION			Dimension in m/m		
TYPE	A	B	C	D	PCS/REEL
SQD465516	330	100	16	2.4	2500
SQD508505	330	100	18	2.4	1000
SQD750603	330	100	18	2.4	1000
SQD100805	330	100	26	2.4	700
SQD121006	330	100	26	2.4	500

Dimension in m/m						
TYPE	A0	B0	K0	W	P	T
SQD465516	6.0	5.0	2.0	12.0	8.0	0.40
SQD508505	5.4	8.9	5.4	16.0	8.0	0.40
SQD750603	6.4	7.9	3.4	16.0	12.0	0.30
SQD100805	8.4	10.4	5.4	24.0	12.0	0.35
SQD121006	10.4	12.4	6.4	24.0	16.0	0.40

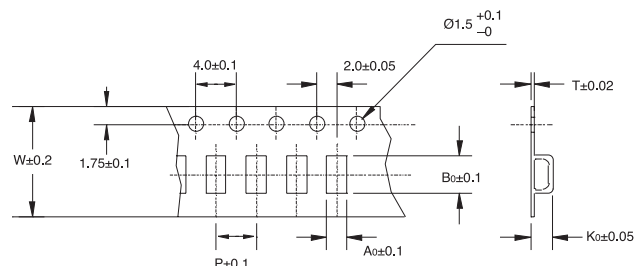
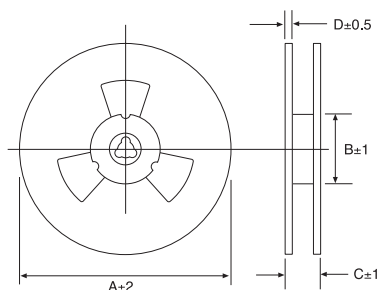

CARRIER TAPE MATERIAL: POLYSTYRENE