

SMD Tuning Fork Crystal

MCM500S Series

SMD Ultra Miniature Type

(30 - 200 KHz)

MEC Crystals

Features:

- High stability
- Low profile, plastic SM package
- Tape & Reel (3000 pcs/reel)
- Frequency: 30 - 200 KHz
- **RoHs Compliant (Pb Free)**

Applications:

- Microprocessor systems
- Consumer electronics



Electrical Specifications:

Series	MCM500S	
Item	Symbol	Specifications
Frequency	f_0	30 - 200 KHz
Frequency Tolerance	$\Delta f/f_0$ (25°C)	± 20 ppm
Turnover	TO	$25 \pm 5^\circ\text{C}$
Frequency Temp. Coefficient	beta	-0.034 ± 0.006 ppm / °C2
Operating Temperature	T	$-40^\circ\text{C} \sim +85^\circ\text{C}$
Storage Temperature	T _{stg}	$-55^\circ\text{C} \sim +125^\circ\text{C}$
Equivalent Series Resistance	R1 (25°C ref.)	50 Kohm max
Max Insulation Resistance	IR	500 Mohm Min. (DC 100V \pm 15V)
Load Capacitance	CL	12.5 pF Typical or specify
Motional Capacitance	C1	4.0 fF Max.
Shunt Capacity	Co	2.0 pF Max. (1.5 pF Typical)
Capacitance Ratio	gamma	500 Typical
Drive Level	DL	1.0 μ W Max.
Aging	fa	± 3 ppm / year (25°C \pm 3°C)
Shock Resistance	± 5 ppm Max. Drop test of 3 times on a hard board from 75cm height or shock test of 3000G x 0.3ms x 1/2sin wave x 3 directions.	

Part Numbering System:

MCM500S - **30.000** - _____
① ② ③

① Series

MCM500S-327

② Frequency

Frequency
ex. 16.000

③ Load Capacitance

Code	Load Capacitance
Nil	12.5 pF
6	6 pF
8	8 pF
or specify	

Remark: Specifications are subject to change without prior notice. Please confirm with our sales engineer.

Dimensions:

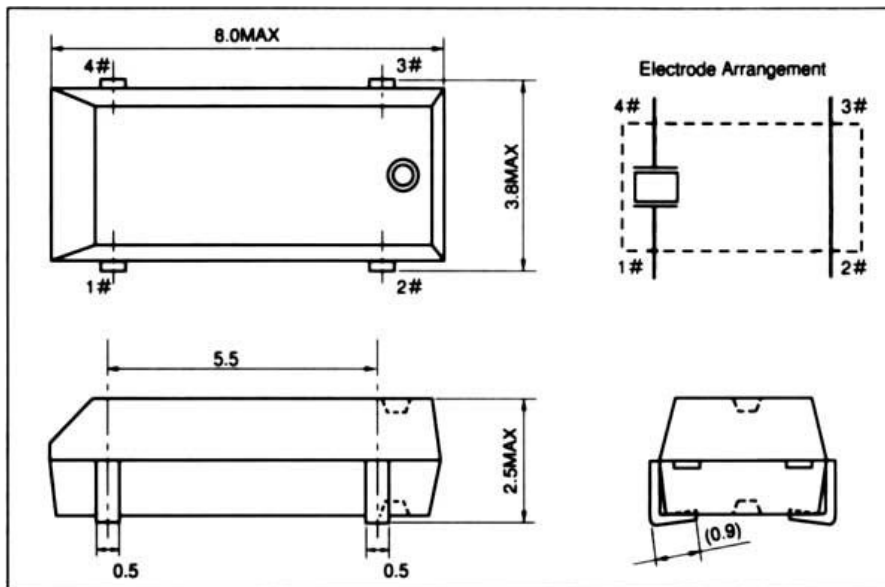

Carrier Tape Dimensions:

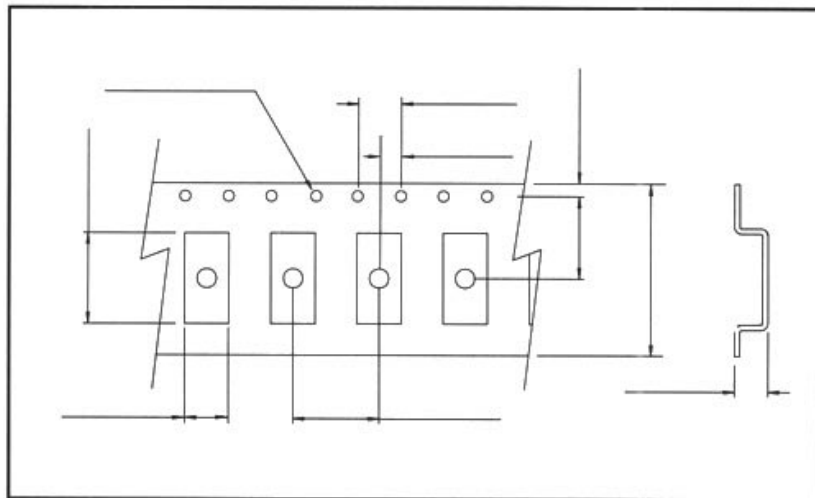

Recommended Patterning:

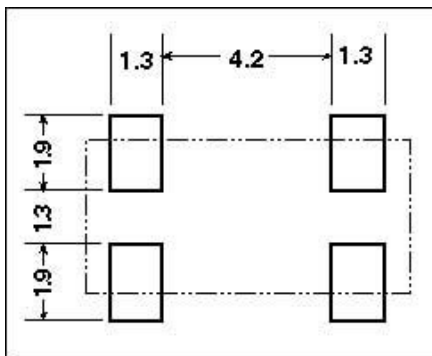

Frequency vs Temperature Curve:

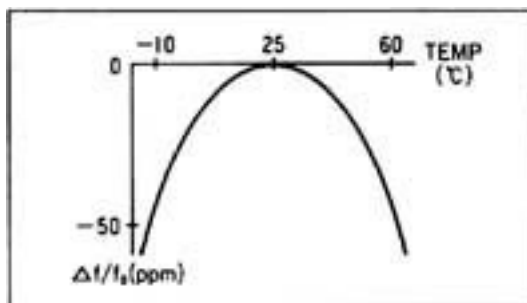

Remark: Specifications are subject to change without prior notice. Please confirm with our sales engineer.