

Through Hole Power Inductors

THAH1485 & 1411 Type

Features

- RoHS compliant.
- High current (Isat up to 40A) through hole type.
- Magnetically shielded, suitable for high density mounting.
- High energy storage and low DCR.
- Ideal for power source circuits, DC-DC converter, DC-AC inverters inductor application.
- In addition to the standard versions shown here, customized inductors are available to meet your exact requirements.

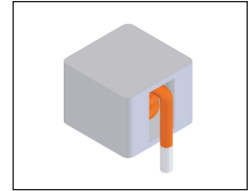

Mechanical Dimension:

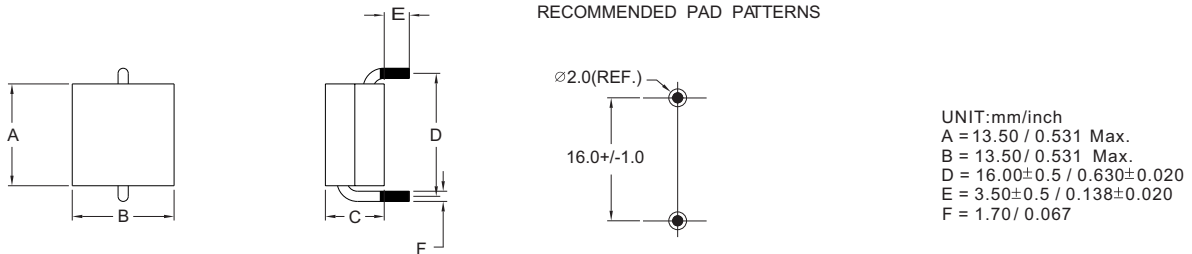

Electrical Characteristics: At 25°C: 100KHz, 1.0V

PART NO.	Lo ¹ (uH)	Li (uH) MIN	DCR (mΩ) MAX	I sat ² (A dc)	Dimension "C" (mm / inch) MAX
THAH1485-0R4	0.40	0.320	0.9	40	8.5 / 0.335
THAH1485-0R5	0.50	0.375	0.9	40	8.5 / 0.335
THAH1411-0R7	0.70	0.547	1.1	40	10.5 / 0.413
THAH1411-0R8	0.80	0.576	1.1	40	10.5 / 0.413

1. Lo is the initial inductance and the tolerance is ± 20%.
2. Isat is the DC current which cause the inductance drop not lower than Li.
3. Operating temperature : -40°C to 125°C (including self-temperature rise).



DELTA ELECTRONICS, INC.

(TAOYUAN PLANT CPBG) 252, SAN YING ROAD, KUEISAN INDUSTRIAL ZONE, TAOYUAN SHIEN, 333, TAIWAN, R.O.C.

TEL: 886-3-3591968; FAX: 886-3-3591991

<http://www.deltaww.com>