

MTPS4088BL

Point Source LED

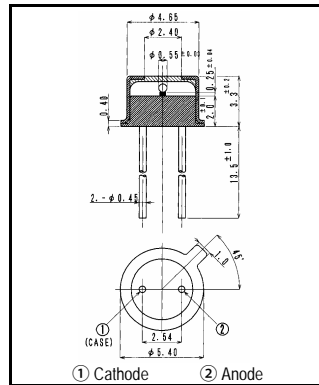
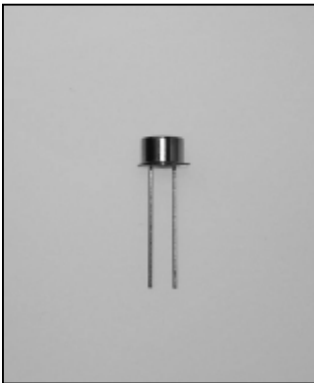

- FEATURES**
- Point-Source LED
 - Emitting Window Dia. $\phi 50 \mu m$
 - With Ball-Lens
 - High-output Power
- APPLICATIONS**
- Linear & Rotary Encoder (Measuring System)
 - Edge Sensing (Coin Dispenser)
 - Optical Communications
 - Fiber Optics

1. ABSOLUTE MAXIMUM RATINGS (Ta=25°C)

ITEM	SYMBOL	RATINGS	UNIT
Forward Current (DC)	IF	80	mA
Forward Current (Pulse)*1	I _{FP}	0.4	A
Reverse Voltage	VR	5	V
Power Dissipation	PD	150	mW
Operating Temp.	T _{opr}	-30 TO 100	°C
Storage Temp.	T _{stg}	-40 TO 125	°C
Junction Temp.	T _J	125	°C
Lead Soldering Temp.*2	T _{ls}	260	°C

*1:Tw=10uS,T=10mS

*2:Time 5 Sec max,Position:Up to 3mm from the body

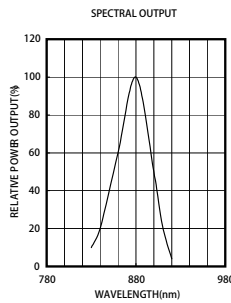

2. ELECTRICAL & OPTICAL CHARACTERISTICS (Ta=25°C)

ITEM	SYMBOL	CONDITIONS	MIN	TYP	MAX	UNIT
Power Output	PO	IF=50mA	2.5	3.5		mW
Forward Voltage	VF	IF=50mA		1.9	2.4	V
Reverse Current	IR	VR=5V			10	μA
Peak Wavelength	λ_p	IF=50mA	850	880		nm
Spectral Line Half Width	$\Delta \lambda$	IF=50mA		40		nm
Half Intensity Beam Angle	θ	IF=50mA		± 6		deg.
Band Width	fc	IF=50mA+20mA _{p-p}		20		MHz
Junction Capacitance	Cj	1MHz, V=0V		40		pF
Temp. Coefficient of PO	P/T	IF=10mA		-0.05		%/°C
Temp. Coefficient of VF	V/T	IF=10mA		-2.3		mV/°C
Fiber-Coupled-Power*1	PF	IF=50mA		600		μW

*1 200/230 NA=0.4

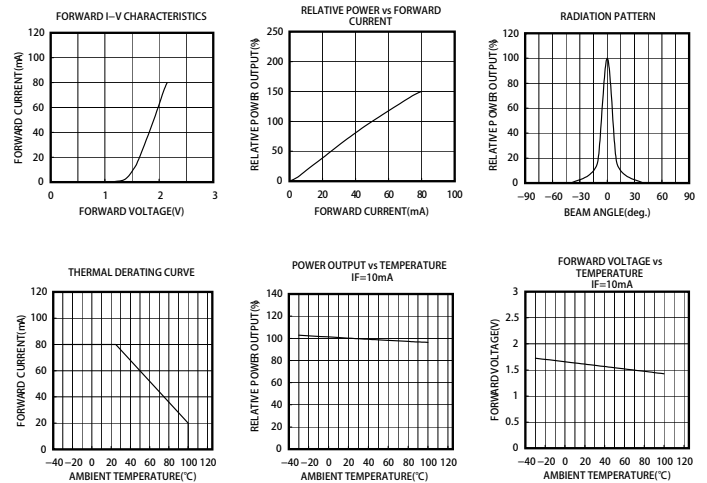

To purchase this part contact
Marktech Optoelectronics at
800.984.5337

Marktech
Optoelectronics
www.marktechopto.com

