

**Inductive Sensors**  
**BES IKU-010,23-G-S4**  
**21 x 100 x 60**  
**normally-open**  
**Sn=20mm**  
**unshielded**

PX1081

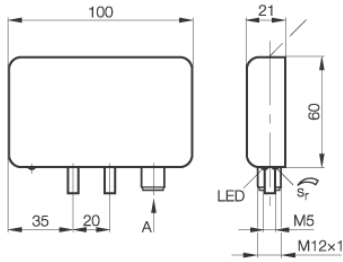

**Common Data**

Mounting in steel	unshielded
Rated operating distance Sn	20mm
Assured operating distance Sa	0...16mm
Repeatability R	<= 5%
Hysteresis	<= 15%
Function indication	yes
Ambient temperature range	-25...+70°C
Polution Degree	3
IEC-Code	I2D21AP2

**Mechanical Data**

Measurements BxHxT or DxT	21 x 100 x 60mm
Housing material	Plastic
Material of sensing face	Plastic
Degree of protection	IP65IP
Connection	Connector S4
Schock: Halfsinus, 30 gn, 11ms	
Vibration: 55 Hz, 1mm Amplitude, 3 x 30 Minutes	

**Electrical Data**

Current type	DC
Wiring	3-Wire
switching function	normally-open
Output signal	PNP
Rated operational voltage	24 DCV
Rated operational current	200mA
Supply voltage	10...30 DCV
Ripple	<= 15%
max. switching frequency	50Hz
Minimum operational current	1mA
No-load supply current	<= 10/<= 10mA
Off-state current	-µA
Voltage drop	<= 2/-V
Short circuit protection	yes
Protected against polarity reversal	yes

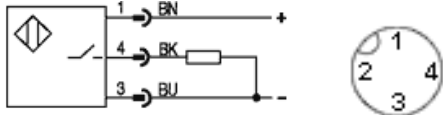

Utilization categories DC 13  
 Insulation class -

Datasheet number:

Definitions see general catalog.  
 If not otherwise noted, ratings according to IEC 60947-5-2 (DIN EN60947-5-2)

Balluff GmbH  
 P.O.Box 1160  
 73761 Neuhausen Germany  
 Phone (07158) 173-0 Fax (07158) 5010

Datenblatt by CD-ROM - 10/2004

