

PB5331 Series

Specifications:

Parameters	Units	PB5331A06AW
▶ Min Sound Pressure Level at 30cm	dBa	93
Rated Voltage	Vdc	6
Operating Voltage	Vdc	3 - 12
Resonance Frequency	Hz	2800 ± 500
▶ Max Operating Current	mA	20
Tone	-	Continuous
Operating Temperature	°C	-20 - +60
Case Material	-	ABS
Weight	g	38



▶ Value applying rated voltage

Unit: mm • Tolerance: ±0.5mm

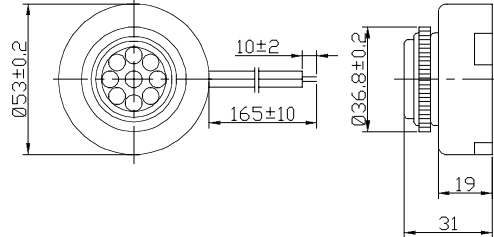

PB6038 Series

Specifications:

Parameters	Units	PB6038A12CAW	PB6038A24CAW	PB6038A42CAW	PB6038A110CAW	PB6038A220CAW
▶ Min Sound Pressure Level at 1m	dBa	110	110	110	110	110
Rated Voltage	Vdc	12	24	42	110 Vac	220 Vac
Operating Voltage	Vdc	8 - 15	15 - 30	35 - 50	90 - 130 Vac	200 - 240 Vac
Resonance Frequency	Hz	2800 ± 500	2800 ± 500	2800 ± 500	2800 ± 500	2800 ± 500
▶ Max Operating Current	mA	300	300	300	300	300
Tone	-	Continuous	Continuous	Continuous	Continuous	Continuous
Operating Temperature	°C	-20 - +60	-20 - +60	-20 - +60	-20 - +60	-20 - +60
Case Material	-	ABS	ABS	ABS	ABS	ABS
Weight	g	136	136	136	136	136



▶ Value applying rated voltage

Unit: mm • Tolerance: ±0.5mm

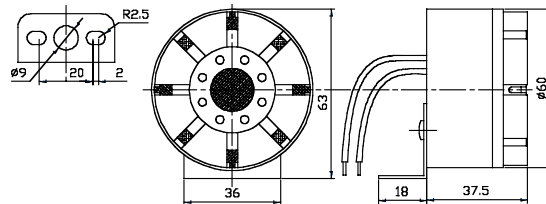

PB9911 Series

Specifications:

Parameters	Units	PB9911A12AW
▶ Min Sound Pressure Level at 1m	dBa	117
Rated Voltage	Vdc	12
Operating Voltage	Vdc	6 - 13
Resonance Frequency	Hz	-
▶ Max Operating Current	mA	1200
Tone	-	6 tones
Operating Temperature	°C	-20 - +60
Case Material	-	ABS
Weight	g	350



▶ Value applying rated voltage

Unit: mm • Tolerance: ±0.5mm

