

# Self Return Slide Switches SSA Series

## FEATURES

1. 1-pole 3-contacts self return slide switch.
2. Suitable for SMT reflow soldering.
3. Providing 6 kinds of operations and tactile feelings by unique combination of slider and cover.
4. Vertical/horizontal operation knobs are available.

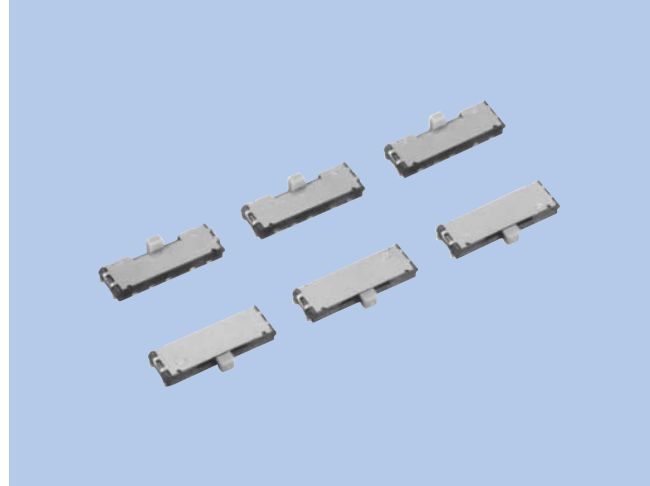

## APPLICATIONS

1. For portable audios, remote controllers, DSC, video players, mobile phones, PDAs, etc.
2. For power switches, hold switches, mode select switches.
3. For zoom function in cameras.

## MODEL NAME CODE

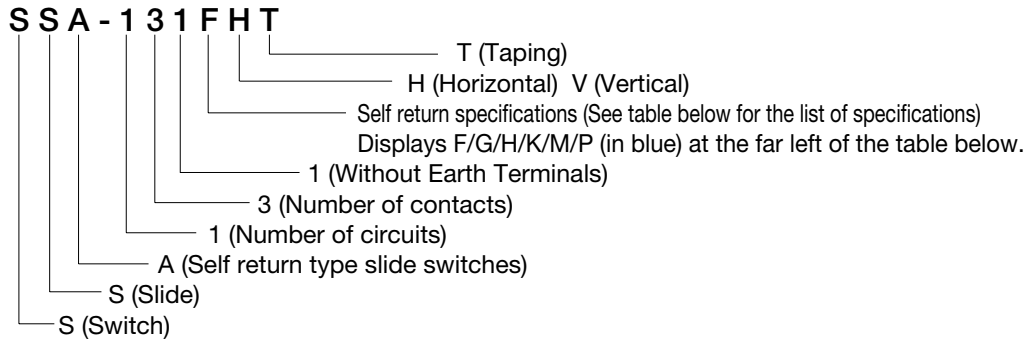

### Self return specifications

	Side A: a ↔ b		Side B: b ↔ c	
	Self Return	Detent	Self Return	Detent
<b>F</b>	○		○	
<b>G</b>	○			○
<b>H</b>	○			
<b>K</b>		○	○	
<b>M</b>			○	
<b>P</b>		○		○

## SPECIFICATIONS

Electrical Characteristics	Rating	0.3A, 4V DC
	Contact Resistance	1Ω or less
	Insulation Resistance	10MΩ or more
	Withstand Voltage	1 minute at 100V AC
Mechanical Characteristics	Operating Force	Self return section: 1.2±1.0N (120±100gf)
		Click section: 1.5±1.0N (150±100gf)
	Life	10,000cycles

## TYPE

Model Name Code	Order Number	No. of Poles	No. of Contacts	Travel (mm)	Knob Direction	Pcs/Reel
SSA-131FHT (Typical)	R66 6804	1	3	1.5	Horizontal	5,000
SSA-131FVT (Typical)	R66 6792	1	3	1.5	Vertical	4,000

## DIMENSIONS

### Horizontal

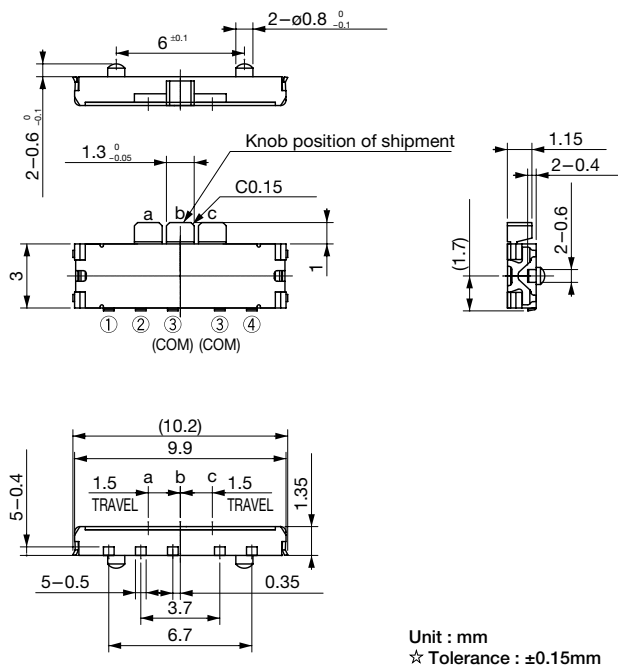

### Vertical

