

1

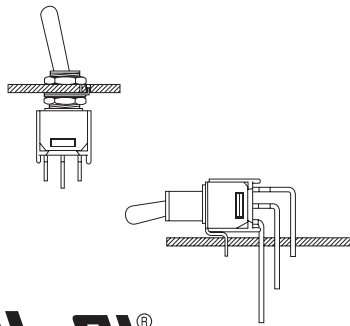

SPECIFICATIONS

CONTACT RATING: 3A @120 VAC or 28 VDC (Q Contact)
 ELECTRICAL LIFE:30,000 make-and-break cycles at full load
 CONTACT RESISTANCE: 20 m Ω max. initial @2-4 VDC,100 mA
 INSULATION RESISTANCE: 1,000 M Ω min.
 DIELECTRIC STRENGTH: 1,500 V RMS @ sea level.
 OPERATING TEMPERATURE: -30 $^{\circ}$ C to 85 $^{\circ}$ C

MATERIALS

CASE - diallyl phthalate (DAP)
 TOGGLE HANDLE - Brass , chrome plated
 BUSHING - Brass , nickel plated
 HOUSING - Stainless Steel
 CONTACT AND TERMINAL - Copper alloy , silver plated
 SWITCH SUPPORT - Brass , tin-lead

How do you build the switches you need!!

The STT-4/STT-5, please see the (A); The STT-6/STT-7/STT-8/STT-9, please see the (B)

(A) S T T 4 S E B Q E A 5 T 3 2

Switch Function	Actuator	Bushing	Termination	Vertical support Bracket	Actuator Cap/ Rubber hood Sealing
STT4 SP on-none-on	For Bushing E/E1/F/F1	The 10-48 uns thread	B solder lug	(none)	Actuator Cap
STT4B SP on-none-(on)	S 9.40	E (std.) flat 5.59	C P.C	A5 Vertical bracket	T3 -9.00 (for actuator S/N/X)
STT4A SP on-off-on	T 5.33	F key-way 5.59	D wire wrap	A5S Vertical bracket (snap-in)	Rubber hood Only for the bushing G / J
STT4H SP (on)-off-(on)	U 7.37	Non-thread			E1
STT4I SP on-off-(on)	For Bushing G/G1/J/J1	E1 flat 5.59	Contact Material		
STT5 DP on-none-on	V 10.41	F1 key-way 5.59	Q silver plated		
STT5B DP on-none-(on)	X 5.59	1/4-40 uns thread	R gold plated		
STT5A DP on-off-on		G flat 7.87	G gold over silver		
STT5H DP (on)-off-(on)		J key-way 6.60	K tin-lead		
STT5I DP on-off-(on)	Locking Lever	Non-thread			
	LK Round top	G1 flat 7.87	Epoxy seal		
	LK1 Flat top	J1 key-way 6.60	(none) none seal		
		N	E epoxy seal		
		The actuator LK/LK1No requirement to choose the bushing, unless the non-thdLKN / LK1N			
					Cap color
					1 white
					2 black
					3 red
					4 yellow
					5 blue

(B) S T T 6 T E 1 Q E S T 2 5

Horizon Right Angle	Vertical Right Angle	Switches Function	Actuator	Bushing	Contact Material	Bracket type
STT6	STT8	SP on-none-on	For Bushing E/E1/F/F1	The 10-48 uns thread	Q silver plated	(none) std. Straight
STT6B	STT8B	SP on-none-(on)	S 9.40	E flat 5.59	R gold plated	S Snap-in type
STT6A	STT8A	SP on-off-on	T 5.33	F key-way 5.59	G gold over silver	
STT6H	STT8H	SP (on)-off-(on)	U 7.37	Non-thread	K gold / tin-lead	Actuator Cap
STT6I	STT8I	SP on-off-(on)	For Bushing G/G1/J/J1	E1 (std.) flat 5.59		(none)
STT7	STT9	DP on-none-on	V 10.41	F1 key-way 5.59	Epoxy seal	T1 -9.00 (actuator S/N/X)
STT7B	STT9B	DP on-none-(on)	X 5.59	1/4-40 uns thread	(none) none seal	
STT7A	STT9A	DP on-off-on		G flat 7.87	E epoxy seal	
STT7H	STT9H	DP (on)-off-(on)		J key-way 6.60		
STT7I	STT9I	DP on-off-(on)		Non-thread		Cap color
	STT82	SP on-none-on		G1 flat 7.87		1 white
	STT82B	SP on-none-(on)		J1 key-way 6.60		2 black
	STT82A	SP on-off-on				3 red
	STT82H	SP (on)-off-(on)				4 yellow
	STT82I	SP on-off-(on)				5 blue

SPDT



Model No.	Switching position		
STT4	ON	none	ON
STT4A	ON	OFF	ON
STT4B	ON	None	(ON)
STT4H	(ON)	OFF	(ON)
STT4I	ON	OFF	(ON)
Term. Comm.	2-3	open	2-1

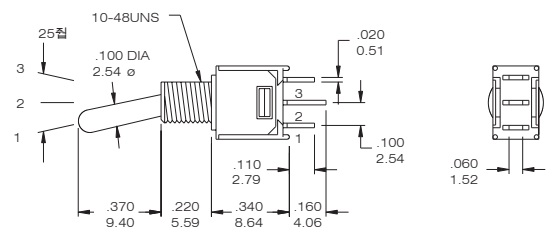
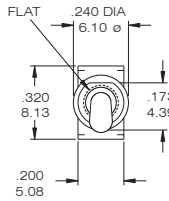

STT4SEBQ

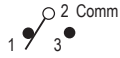

DPDT



Model No.	Switching position		
STT5	ON	none	ON
STT5A	ON	OFF	ON
STT5B	ON	None	(ON)
STT5H	(ON)	OFF	(ON)
STT5I	ON	OFF	(ON)
Term. Comm.	2-3,5-6	open	2-1,5-4

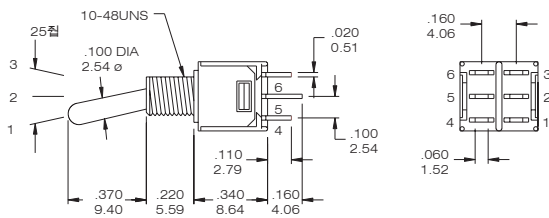
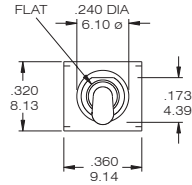

STT5SEBQ



SPDT



Model No.	Switching position		
STT6	ON	none	ON
STT6A	ON	OFF	ON
STT6B	ON	None	(ON)
STT6H	(ON)	OFF	(ON)
STT6I	ON	OFF	(ON)
Term. Comm.	2-3	open	2-1

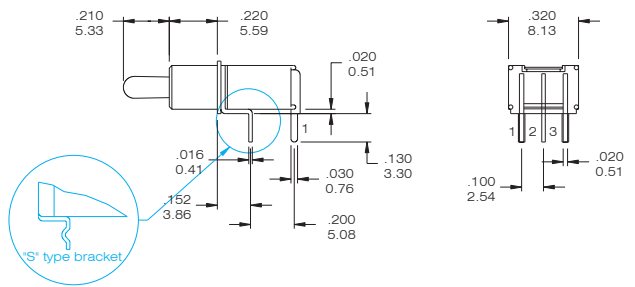
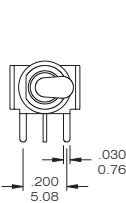

STT6TE1Q / STT6TE1QS

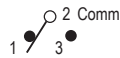

DPDT



Model No.	Switching position		
STT7	ON	none	ON
STT7A	ON	OFF	ON
STT7B	ON	None	(ON)
STT7H	(ON)	OFF	(ON)
STT7I	ON	OFF	(ON)
Term. Comm.	2-3,5-6	open	2-1,5-4

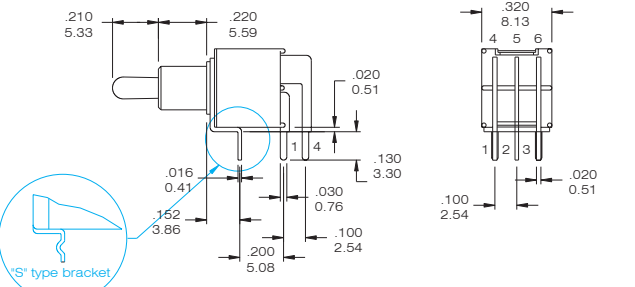
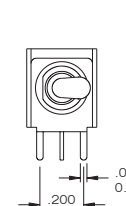

STT7TE1Q / STT7TE1QS



SPDT



Model No.	Switching position		
STT8	ON	none	ON
STT8A	ON	OFF	ON
STT8B	ON	None	(ON)
STT8H	(ON)	OFF	(ON)
STT8I	ON	OFF	(ON)
Term. Comm.	2-3	open	2-1

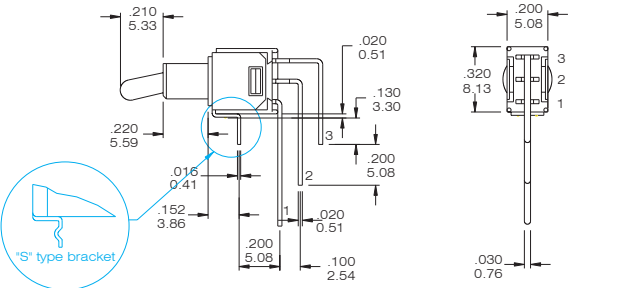
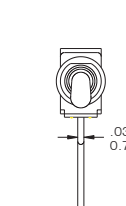

STT8TE1Q / STT8TE1QS



DPDT



Model No.	Switching position		
STT9	ON	none	ON
STT9A	ON	OFF	ON
STT9B	ON	None	(ON)
STT9H	(ON)	OFF	(ON)
STT9I	ON	OFF	(ON)
Term. Comm.	2-3,5-6	open	2-1,5-4

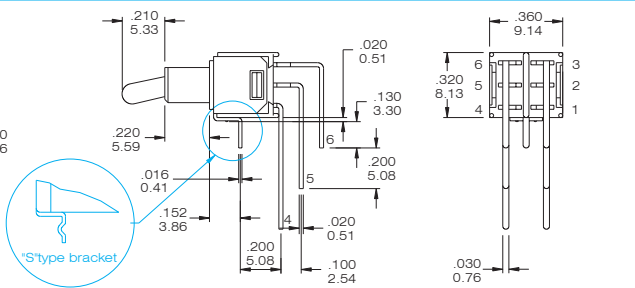
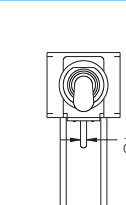

STT9TE1Q / STT9TE1QS



3

SPDT



Model No.	Switching position		
STT82	ON	none	ON
STT82A	ON	OFF	ON
STT82B	ON	None	(ON)
STT82H	ON	OFF	(ON)
STT82I	(ON)	OFF	(ON)
Term. Comm.	2-3	open	2-1

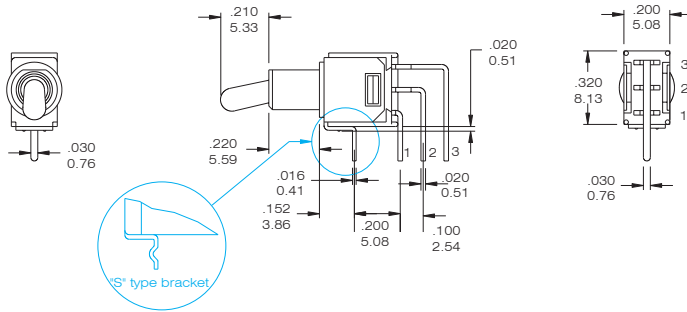

STT82TE1Q / STT82TE1QS

Actuator Option

only applied for the bushing (E/E1/F/F1)

S STD

T STD.

ON P.C.Models

U

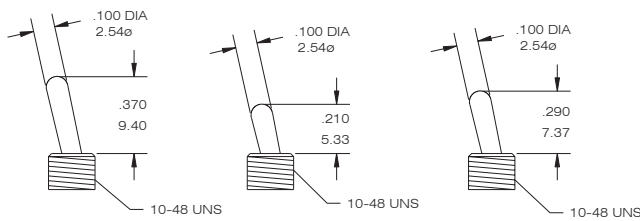

only applied for the bushing (G/G1/J/J1)

V

X

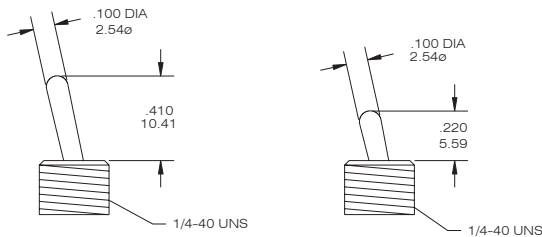

Locking Lever

LK (round top)

LK1 (flat top)

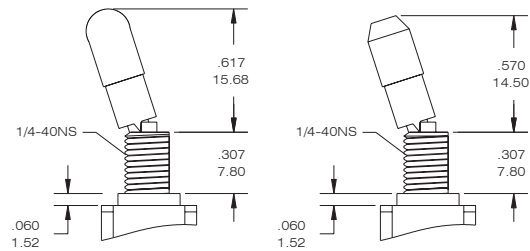

Bushing Option Code not required unless non-thread ordered, choose the bushing code "N" -- LKN / LK1N

only on-on and on-off-on are available other function are developing ,please inquiry our office

Bushing Option

E THD. STD.
E1 NON THD. STD. ON P.C.Model

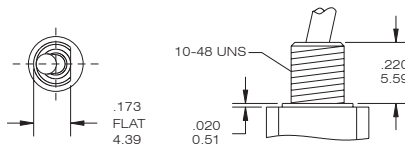

F THD
F1 NON THD

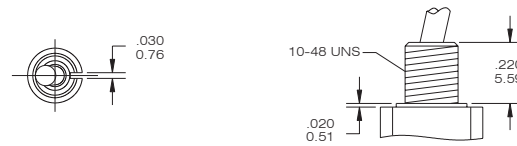

G THD
G1 NON THD

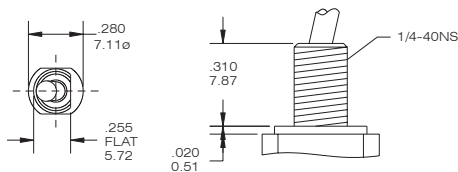

J THD
J1 NON THD

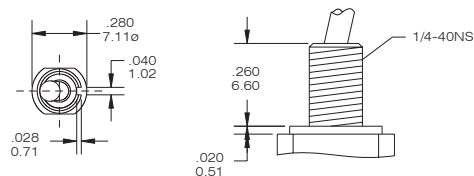

TERMINAL OPTION □ (ONLY FOR THE STT-4 / STT-5)

B Solder Lug(STD)

C PRINTED CIRCUIT

D Wire Wrap

DPDT

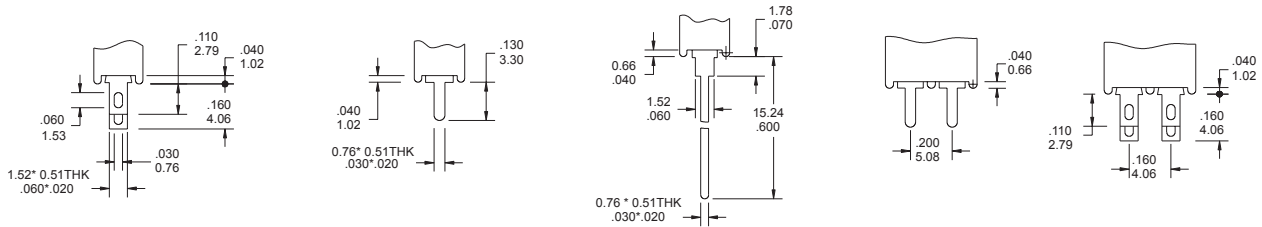

CONTACT MATERIAL OPTIONS

CODE	CONTACT MATERIAL	TERMINAL MATERIAL	RATING
Q	Silver plated	Silver plated	3 A @ 120V AC or 28 V DC; 1.5 A @ 250 VAC
R	Gold plated over nickel plated	Gold plated over nickel plated	0.4VA MAX @ 20 V AC or DC MAX
G	Gold plated over silver plated	Gold plated over silver plated	0.4 VA MAX @ 20 V AC or DC MAX or 3 A @ 120V AC or 28 V DC; 1.5 A @ 250 VAC
K	Gold plated over nickel plated	Tin-lead over nickel plated	0.4VA MAX @ 20 V AC or DC MAX

* THE K option is only for some special item. Please inquiry first when you need the "K" option

P.C.B MOUNTING DIMENSION

PANEL MOUNTING DIMENSION

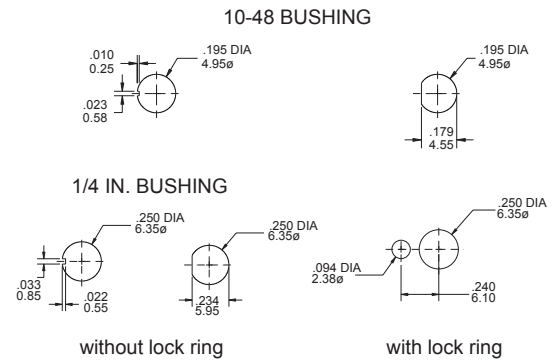
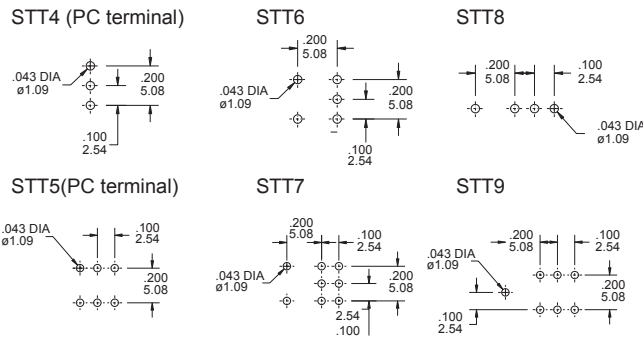

VERTICAL SUPPORT BRACKET OPTION

only for the STT4/STT5. If you need the vertical support support bracket , please build the terminal option - "C" code

A5/ A5S

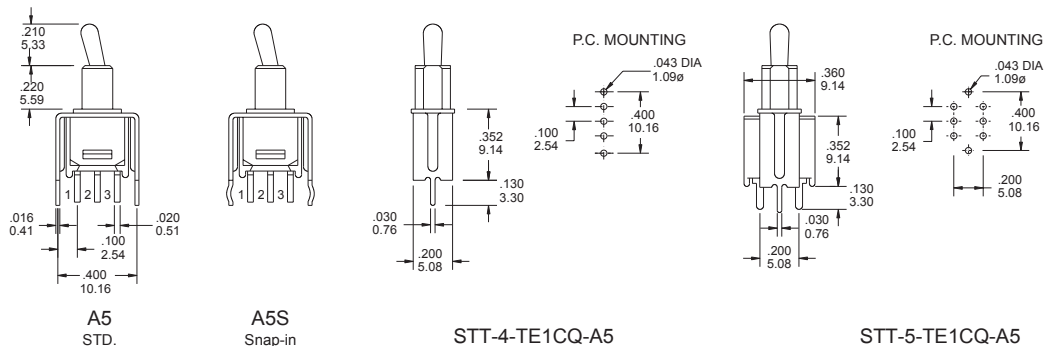

The Toggle Cap Option

The Rubber Hood Option

T3 for actuator "S" only

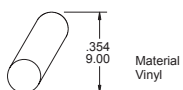

code	color	code	color
1	white	4	yellow
2	black	5	blue
3	red		

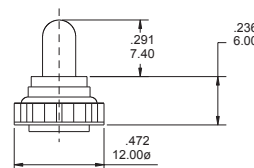

E1 Rubber hood sealing
Only for the bushing "G" "J"