

Characteristic Curves

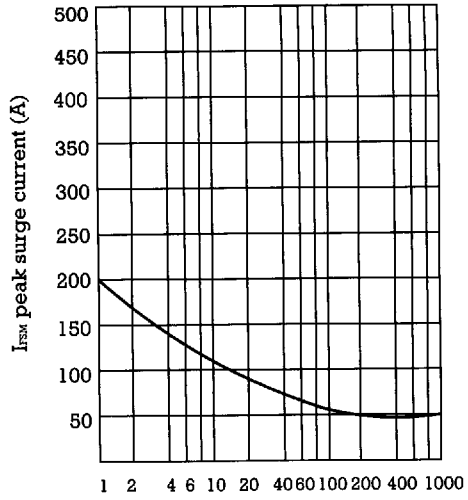

V_f instantaneous forward voltage drop per arm (V)

Number of cycles at 50Hz

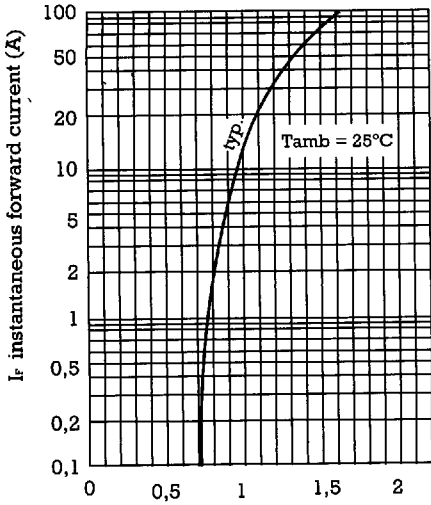
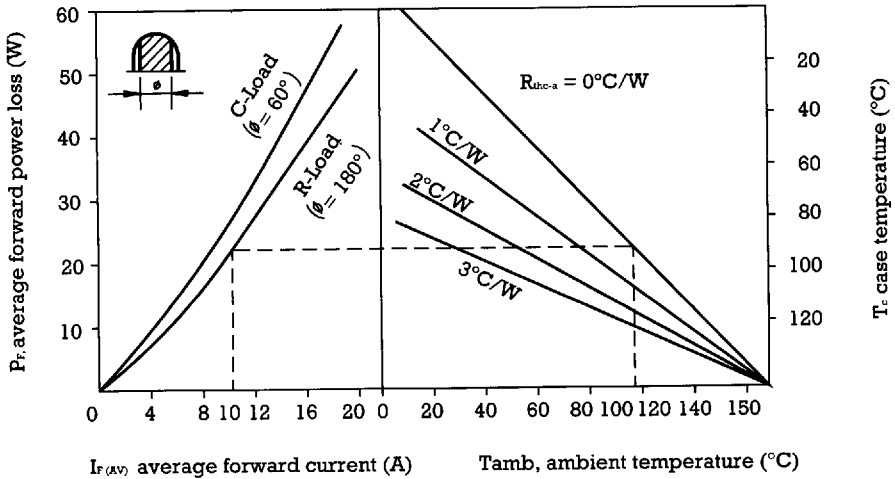

Package Outlines

Dimensions in mm.

1 DO-41
(Plastic)

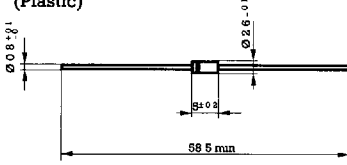

2 DO-15
F-126
58 A 2
(Plastic)

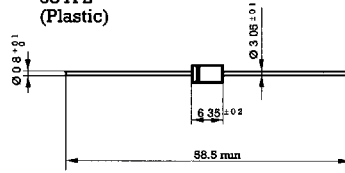

3 DO-27 A
DO-201 AD
(Plastic)

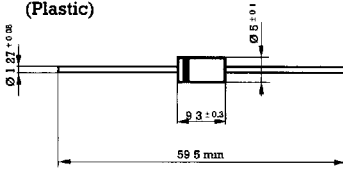

4 DO-201 AE
(Plastic)

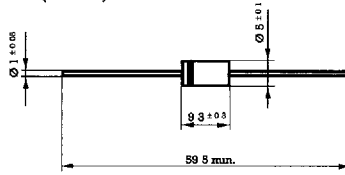

5 P-6
(Plastic)

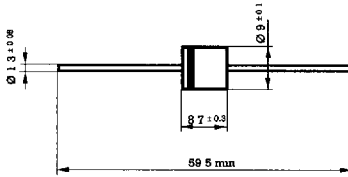

7

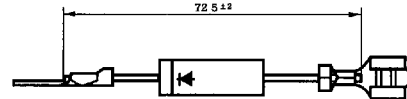
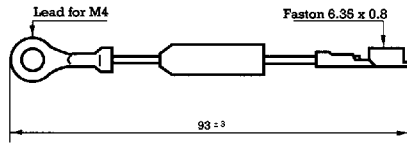

Suffix E1

6

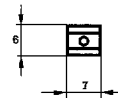
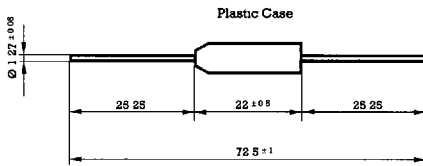

(HVR 3)
(HVR 4)

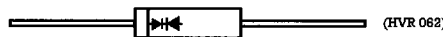

(HVR 062)

Package Outlines Dimensions in mm

8

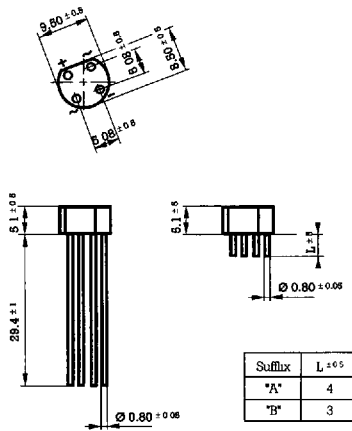

9

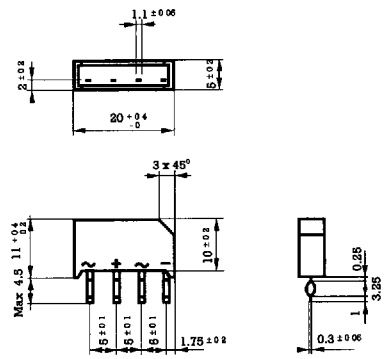

10

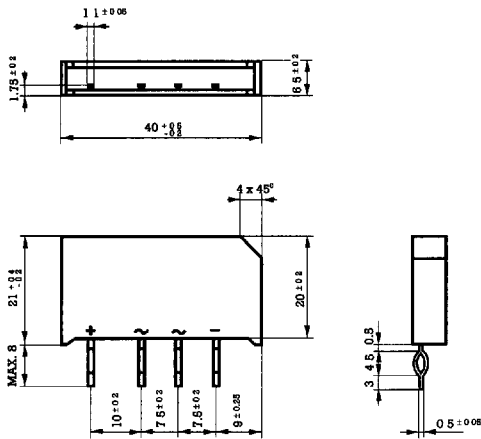

11

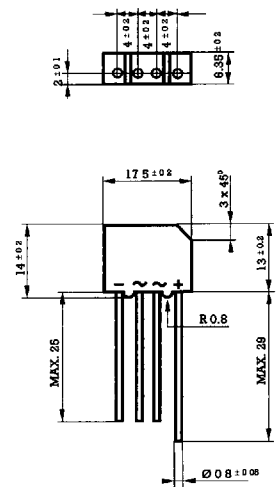

Package Outlines

Dimensions in mm.

12

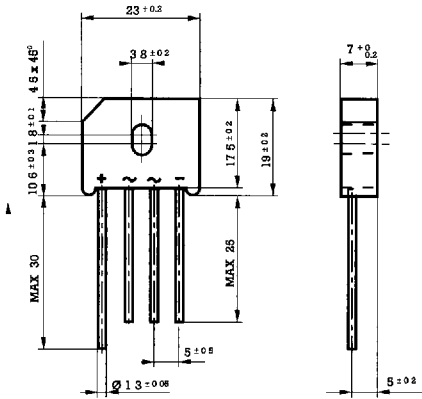

13

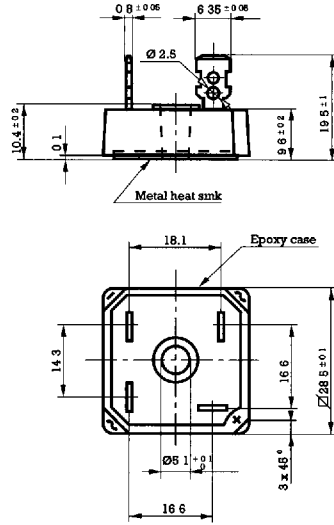

14

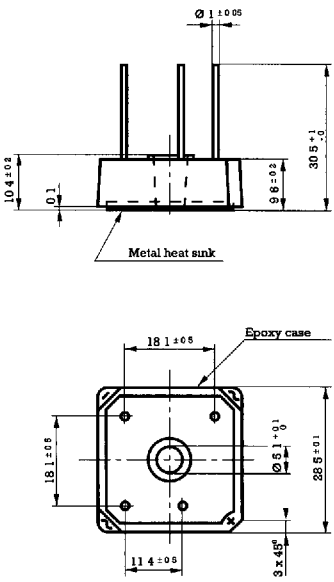

15

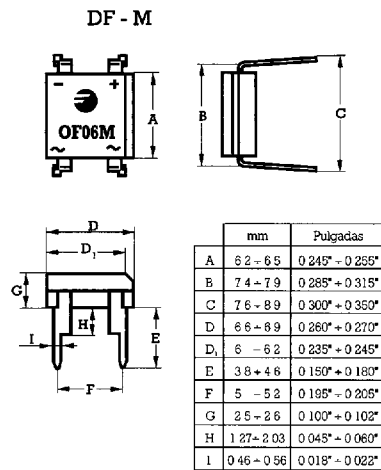

Standard lead forming specifications

Dimensions in mm.

Plastic Cases

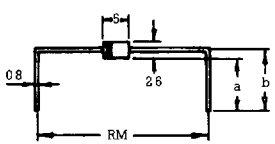
DO-41 	Type	Dimensions		
		a	b	RM
	C2-3	3 ± 0.5	43 ± 0.5	10 ± 0.5
	C2-5	10 ± 0.5	113 ± 0.5	10 ± 0.5
	C2-8	4 ± 0.5	53 ± 0.5	10 ± 0.5

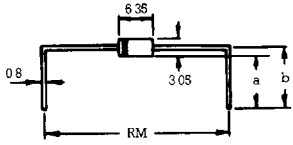
DO-15 	Type	Dimensions		
		a	b	RM
	C2-3	3 ± 0.5	45 ± 0.5	10 ± 0.5
	C2-5	10 ± 0.5	115 ± 0.5	10 ± 0.5
	C2-8	4 ± 0.5	55 ± 0.5	10 ± 0.5

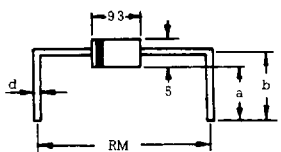
DO-201AD DO-27A (d = 1.27) 	DO-201AE (d = 1)	Type	Dimensions		
			a	b	RM
		C2-1	35 ± 0.5	6 ± 0.5	15 ± 0.5
	C2-2	4 ± 0.5	65 ± 0.5	15 ± 0.5	
	C2-4	7.5 ± 0.3	10 ± 0.3	17.8 ± 0.15	
	C2-6	3.5 ± 0.5	6 ± 0.5	17.5 ± 0.5	
	C2-7	4.5 ± 0.5	7 ± 0.5	21 ± 0.5	
	C2-11	4.5 ± 0.5	7 ± 0.5	17.5 ± 0.5	
	C2-12	12.5 ± 0.5	15 ± 0.5	17.5 ± 0.5	
	C2-13	16 ± 0.5	18.5 ± 0.5	15.2 ± 0.5	
	C2-14	7.5 ± 0.5	10 ± 0.5	15 ± 0.5	
	C2-17	4 ± 0.5	8.5 ± 0.5	20 ± 0.5	

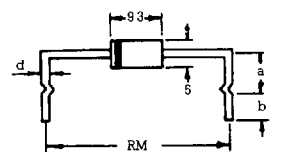
DO-201AD DO-27A (d = 1.27) 	DO-201AE (d = 1)	Type	Dimensions		
			a	b	RM
		C6-1	10 ± 0.5	5 ± 0.5	15.2 ± 0.5
	C6-2	10 ± 0.5	5 ± 0.5	17.5 ± 0.5	
	C6-3	7 ± 0.5	5 ± 0.5	21 ± 0.5	
	C6-4	13.5 ± 0.5	5 ± 0.5	15.2 ± 0.5	
	C6-5	10 ± 0.5	5 ± 0.5	20 ± 0.5	

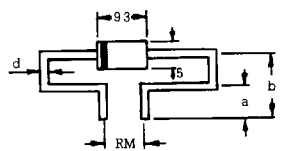
DO-201AD DO-27A (d = 1.27) 	DO-201AE (d = 1)	Type	Dimensions		
			a	b	RM
		C4-2	4.5 ± 0.3	10.5 ± 0.3	7.5 ± 0.5

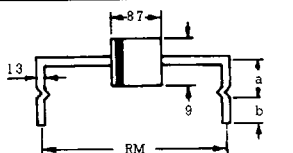
P-6 	Type	Dimensions		
		a	b	RM
		C6-1	10 ± 0.5	5 ± 0.5
	C6-2	10 ± 0.5	5 ± 0.5	17.5 ± 0.5
	C6-3	7 ± 0.5	5 ± 0.5	21 ± 0.5
	C6-4	13.5 ± 0.5	5 ± 0.5	15.2 ± 0.5