

## PB SERIES - MINIATURE MOMENTARY PUSHBUTTON SWITCHES

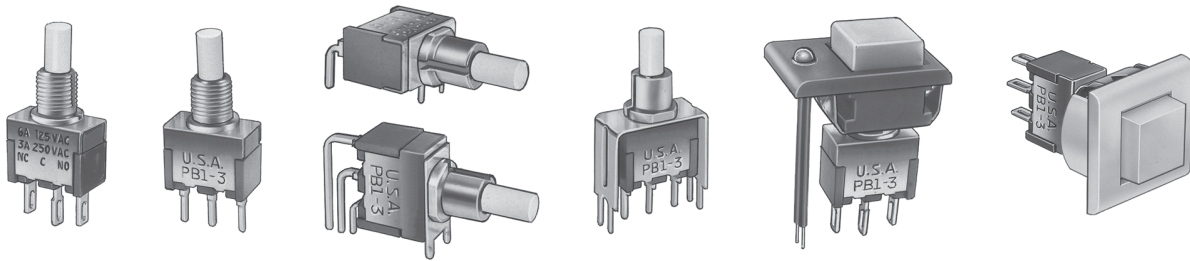

### FEATURES

- Dry circuit through power ratings .
- Rugged construction SPDT momentary models with numerous options.
- Panel, panel & p.c. and p.c. mounting models, lighted and unlighted.

### SPECIFICATIONS

<b>Contact ratings (resistive loads):</b>	(Q) power models - coin silver: 6 Amps at 125 VAC, 3 Amps at 250 VAC or 7 Amps at 30 VDC. (B) dry circuit models - gold over nickel over brass: 0.4 VA max. at 20 V max. UL models - coin silver: 6 Amps at 125 VAC or 3 Amps at 250 VAC (75% power factor). UL file no. E66367. CSA models - coin silver: same ratings as UL models. CSA file no. LR54592-1.
<b>Initial contact resistance:</b>	5 milliohms max. at 3 VDC, 0.1 Amp.
<b>Insulation resistance:</b>	Greater than 200,000 megohms between terminals & case ground.
<b>Dielectric strength:</b>	Greater than 2000 VAC for 1 minute between terminals & case ground.
<b>Electrical life (resistive loads):</b>	100,000 cycles min. at full load.
<b>Operating temperature range:</b>	-30°C to +85°C
<b>Total travel &amp; operating force:</b>	.065" (1.6mm) & 19 oz. (approximate values ).

### MATERIALS

<b>Contacts:</b>	Coin silver for power, UL & CSA models. Gold over nickel over brass for dry circuit models.
<b>Actuator:</b>	Glass filled polyester, color white
<b>Bushing:</b>	Nickel plated brass
<b>Strap:</b>	Stainless steel
<b>Case:</b>	Melamine phenolic, color red
<b>Terminal seal:</b>	Epoxy (optional)
<b>Support bracket:</b>	Brass or steel, tin plated
<b>Spring mounting bracket:</b>	Stainless steel
<b>Bezel &amp; cap:</b>	Nylon. Available in black, red or white. Consult factory for other colors.
<b>Hardware:</b>	See 'Miscellaneous' section.
<b>LED:</b>	Intensity: 2.0 mcd at 10 mA. Forward voltage: 2.0V (3.0V max.). Max. continuous forward current: 15 mA for red, 30 mA for green & 20 mA for yellow. Red is standard. Yellow & green are optional. Specifications are subject to change without notice - consult factory.

### AGENCY RECOGNITION



UL, & CSA. Marking: Switches ordered with '/UL' added at end of model no. are supplied with recognition marked. Switches ordered with '/CSA' added at end of model no. are supplied with recognition marked.

### ABOUT THIS SERIES

The material in this series is organized in the following sequence:

- Completely specified switch models
- 'build your own switch' order format
- Miscellaneous
- Option drawings & information
- Panel cut-outs & miscellaneous

# PB SERIES - MINIATURE MOMENTARY PUSHBUTTON SWITCHES

## Solder lug terminals - panel mounting



POWER CKT. MODEL NO.	DRY CKT. MODEL NO.
PB1-3P2Y1ZQ	PB1-3P2Y1ZB

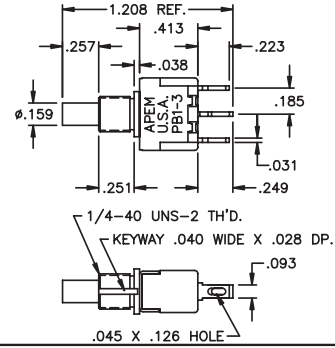
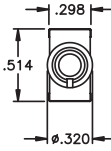
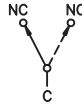

## P.C. or wirewrap terminals - panel or p.c. mounting

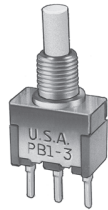

POWER CKT. MODEL NO.	DRY CKT. MODEL NO.
PB1-3P2Y1CQ	PB1-3P2Y1CB

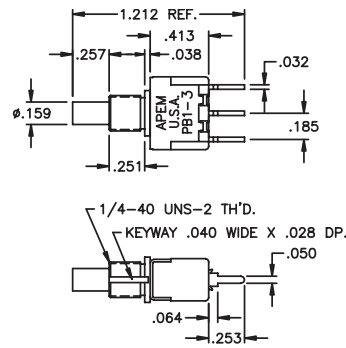
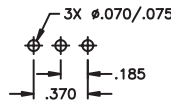
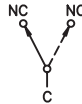

## Horizontal right angle p.c. terminals - p.c. mounting

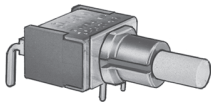

POWER CKT. MODEL NO.	DRY CKT. MODEL NO.
PB1-3P2Y2A-1Q	PB1-3P2Y2A-1B

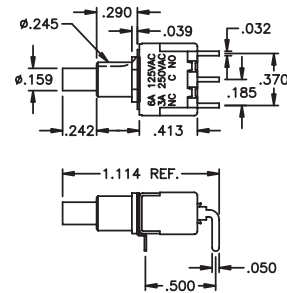
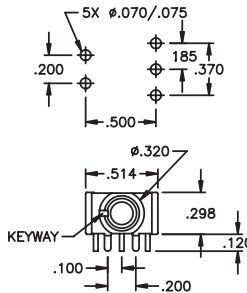
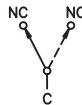

## Vertical right angle p.c. terminals - p.c. mounting

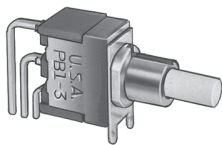

POWER CKT. MODEL NO.	DRY CKT. MODEL NO.
PB1-3P2Y2V-1Q	PB1-3P2Y2V-1B

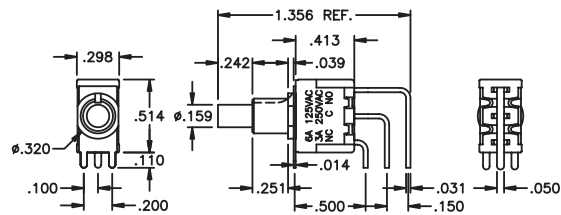
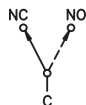
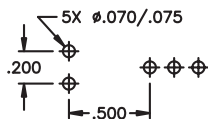

SPECIFICATIONS SUBJECT TO CHANGE WITHOUT NOTICE

# PB SERIES - MINIATURE MOMENTARY PUSHBUTTON SWITCHES

## Straight p.c. terminals with bracket - p.c. mounting

SPECIFICATIONS SUBJECT TO CHANGE WITHOUT NOTICE

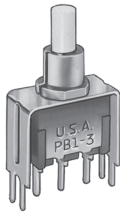

POWER CKT. MODEL NO.	DRY CKT. MODEL NO.
PB1-3P2Y2V30Q	PB1-3P2Y2V30B

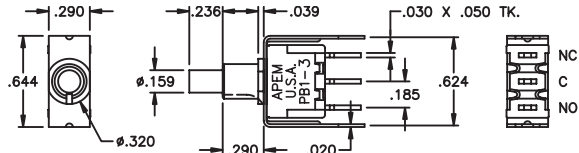
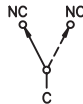

## Solder lug terminals - snap-in bezel with LED

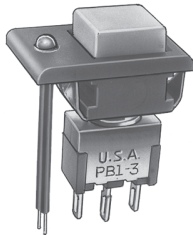

POWER CKT. MODEL NO.	DRY CKT. MODEL NO.
PB1-3P2Y1ZQJ6168	PB1-3P2Y1ZBJ6168

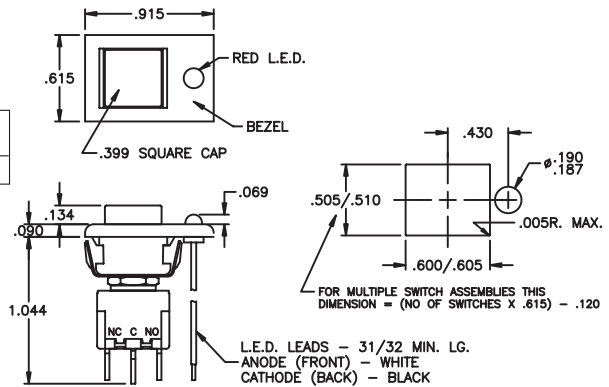

## Solder lug terminals - snap-in bezel

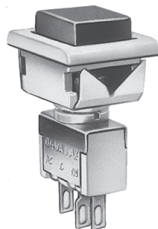

POWER CKT. MODEL NO.	DRY CKT. MODEL NO.
PB1-3P2Y1ZQJ8182	PB1-3P2Y1ZBJ8182

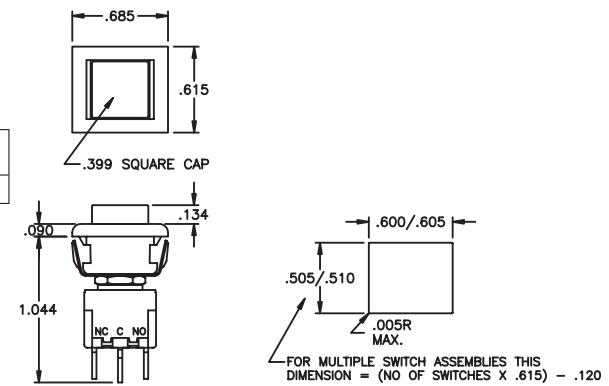
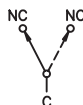

# PB SERIES - MINIATURE MOMENTARY PUSHBUTTON SWITCHES

## Straight p.c. terminals - p.c. mounting bezel

C

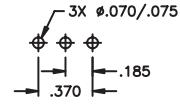

POWER CKT. MODEL NO.	DRY CKT. MODEL NO.
PB1-3P2Y1CQJ8488	PB1-3P2Y1CBJ8488

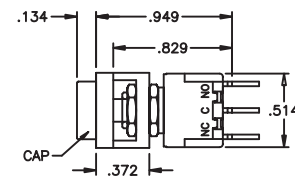
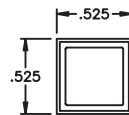
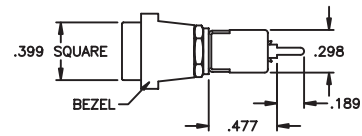
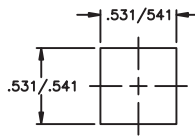

SPECIFICATIONS SUBJECT TO CHANGE WITHOUT NOTICE

## Straight p.c. terminals with bracket - p.c. mounting bezel

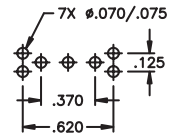
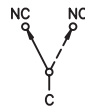

POWER CKT. MODEL NO.	DRY CKT. MODEL NO.
PB1-3P2Y1V30QJ8488	PB1-3P2Y1V30BJ8488

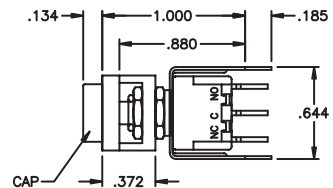
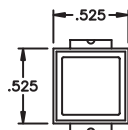
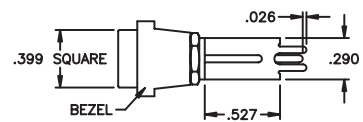
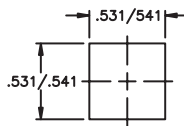

# PB SERIES - MINIATURE MOMENTARY PUSHBUTTON SWITCHES

## Horizontal right angle p.c. terminals - p.c. mounting bezel

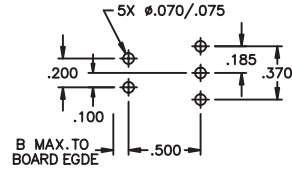
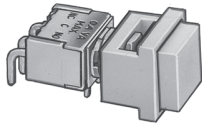

<b>POWER CKT. MODEL NO.</b>	<b>DRY CKT. MODEL NO.</b>
PB1-3P2Y1A-1QJ8488	PB1-3P2Y1A-1BJ8488

Option	Dim. A	Dim. B
A	.148	.045 max.
A-1	.164	.095 max.

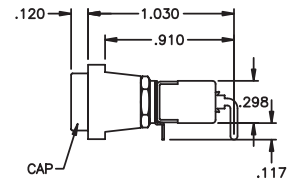
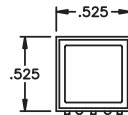
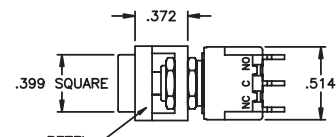
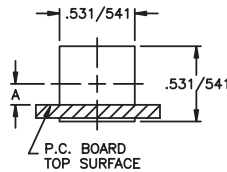

## Vertical right angle p.c. terminals - p.c. mounting bezel

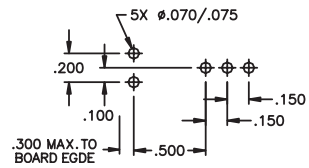
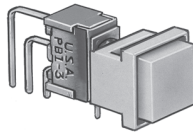

<b>POWER CKT. MODEL NO.</b>	<b>DRY CKT. MODEL NO.</b>
PB1-3P2Y1V-1QJ8488	PB1-3P2Y1V-1BJ8488

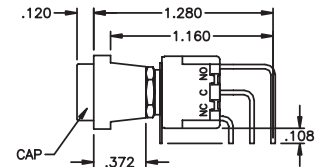
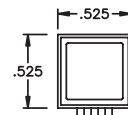
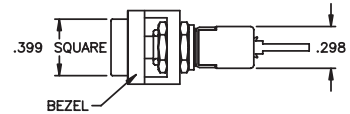
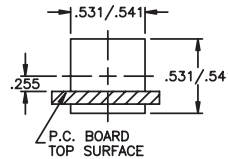

SPECIFICATIONS SUBJECT TO CHANGE WITHOUT NOTICE

C

# PB SERIES - MINIATURE MOMENTARY PUSHBUTTON SWITCHES

**Solder lug terminals - snap-in bezel for round hole mounting**  
Self-keying against rotation

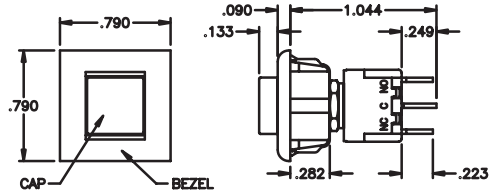
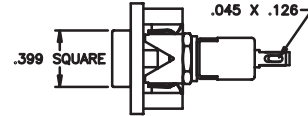
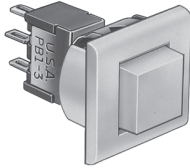

POWER CKT. MODEL NO.	DRY CKT. MODEL NO.
PB1-3P2Y1ZQJ9688	PB1-3P2Y1ZBJ9688

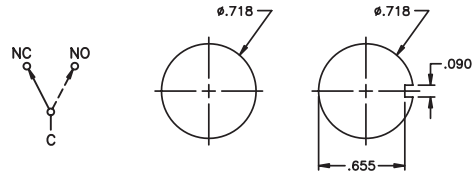

SPECIFICATIONS SUBJECT TO CHANGE WITHOUT NOTICE

**Additional ordering information:** Commonly ordered models are shown above and on prior pages with complete model numbers and specifications. Below is an order format that enables you to 'build your own switch' and specify the correct switch model number by simply selecting from all available options shown and filling in the boxes.

## 'BUILD YOUR OWN SWITCH' ORDER FORMAT

Fill in boxes with selections shown for **Model Structure**, then add **Options** selections for complete model number. Allowable options are shown below each respective box with brief description - see option dwgs. & info. following. Note: 'NONE' indicates box may be left empty.

### Model Structure:

Series	Actuators	Bushings	Terminations	Contact materials
<input type="text" value="P"/> <input type="text" value="B"/> <input type="text" value="1"/> <input type="text" value="-"/> <input type="text" value="3"/>	<input type="text" value=""/> <input type="text" value=""/>	<input type="text" value=""/> <input type="text" value=""/>	<input type="text" value=""/> <input type="text" value=""/> <input type="text" value=""/>	<input type="text" value=""/>
<p>Note: When bezel is specified, specify P2 actuator and Y1 bushing.</p>	<p>P Long P 2 Short (standard)</p>	<p>Y 1/4" thd'd. Y 1 Short 1/4" thd'd. (standard) D 1/4" thd'd. w/'D' flat Y 2 Non-threaded</p>	<p>Z Solder lug C Printed circuit W Wirewrap W 1 Lg. wirewrap W 3 Sht. wirewrap X Extra lg. wirewrap Horiz. right angle p.c. terminals:</p>	<p>B Gold Q Coin silver G Gold over coin silver N Economy gold T Economy silver</p>

### Options:

Bezel & cap	Bezel color	cap color	Approvals
<input type="text" value=""/> <input type="text" value=""/> <input type="text" value=""/>	<input type="text" value=""/>	<input type="text" value=""/>	<input type="text" value=""/> <input type="text" value=""/> <input type="text" value=""/> <input type="text" value=""/>
<p>(NONE) J 6 1 Snap-in w/LED J 8 1 Snap-in no LED J 8 4 P.C. style J 9 6 Snap-in (round hole)</p>	<p>(NONE) 2 Black 6 Red 8 White Consult factory for other colors.</p>	<p>(NONE) 2 Black 6 Red 8 White</p>	<p>(NONE) / U L / C S A</p>

Although most combinations of options are available, some may result in incompatibilities. Consult factory if there is any question.

A  
A - 1  
Vertical right angle p.c. terminals:  
V  
V - 1  
V - 2  
Straight p.c. terminals w/brkt.:  
V 3 0 or V 4 1  
V 4 0 or V 4 1  
V 7 0  
V 8 0  
V 7 1  
V 8 1

Example of completely specified model number:  
**PB1-3P2Y1ZQJ9622/UL/CSA**

# PB SERIES - MINIATURE MOMENTARY PUSHBUTTON SWITCHES

## MISCELLANEOUS

### HARDWARE SUPPLIED

(See Hardware section of catalog)

Switches with Y option bushings are supplied with (2) A112 Hex Nuts, (1) A115 Lockwasher and (1) A107 Anti-rotate Ring.

Switches with D option bushings are supplied with (2) A112 Hex Nuts and (1) A115 Lockwasher.

Switches with Y1 option bushings are supplied with (1) A112 Hex Nut and (1) A115 Lockwasher.

Note: Switches with non-threaded bushings or bezels supplied without hardware.

TYPICAL  
SWITCH  
CROSS  
SECTION

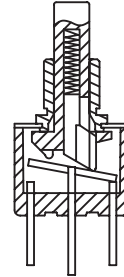

SPECIFICATIONS SUBJECT TO CHANGE WITHOUT NOTICE

## ACTUATOR/BUSHING OPTIONS

Drawings reflect allowable actuator/bushing combinations.

Note for drawings P2Y1 & P2Y2:  
Asterisk indicates .290 flats are supplied with options A, V, V30, V40, V70, V71, V80 & V81.  
For other options, .320 Dia. with no flats may be supplied

### PY

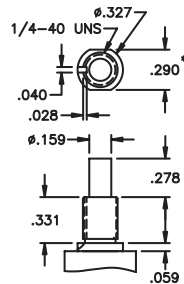

THREADED

### P2Y1

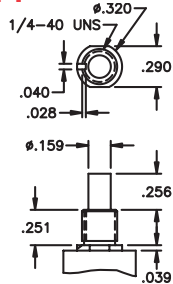

THREADED

### P2Y2

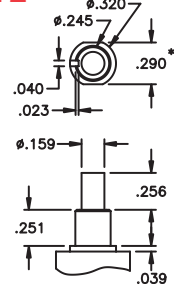

NON-THREADED

### PD

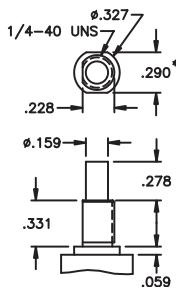

THREADED

## TERMINATION OPTIONS

### A

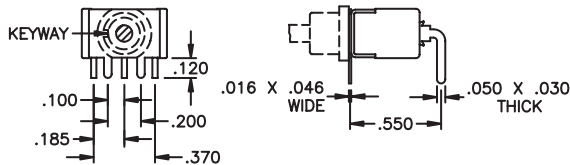

HORIZONTAL P.C. MOUNTING

### A-1

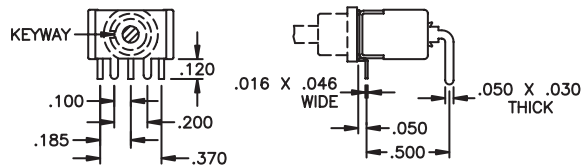

HORIZONTAL P.C. MOUNTING

# PB SERIES - MINIATURE MOMENTARY PUSHBUTTON SWITCHES

## TERMINATION OPTIONS (CONT'D.)

### V, V-1 & V-2

Option	Dim. A	Dim. B
V	.550	.150
V-1	.500	.150
V-2	.500	.100

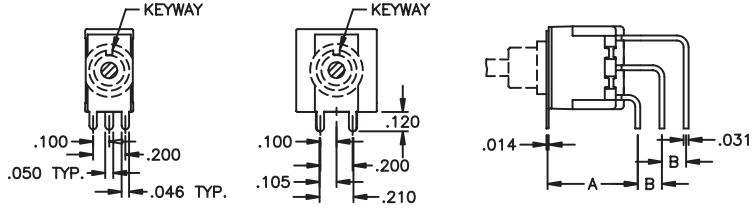

VERTICAL P.C. MOUNTING

### V30, V40, V70, V80, V31, V41, V71 & V81

PANEL LAYOUT  
V30, V31, V40 & V41

Option	Dim. A	Dim. B
V30-V31	.527	.024
V40-V41	.647	.048

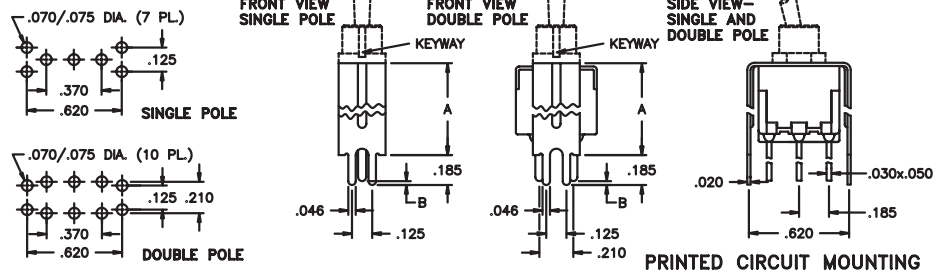

PRINTED CIRCUIT MOUNTING

PANEL LAYOUT  
V70, V71,  
V80 & V81

Option	Dim. A
V70-V71	.630
V80-V81	.953

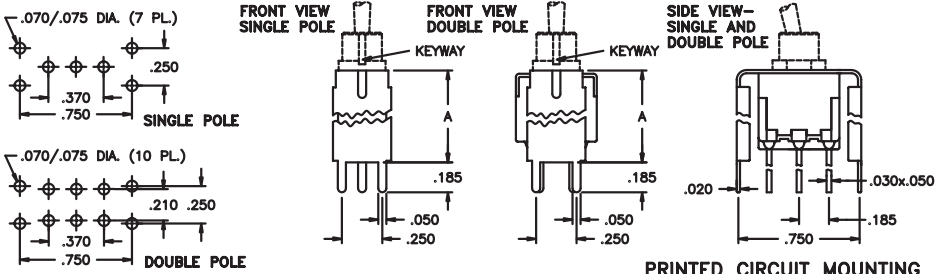

PRINTED CIRCUIT MOUNTING

V31, V41, V71 & V81 ARE THE SAME AS V30, V40, V70 & V80 RESPECTIVELY, EXCEPT WITH CRIMPED LEG DESIGN FOR P.C. BOARD RETENTION, AS SHOWN TO RIGHT.

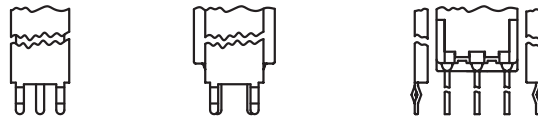

### Z

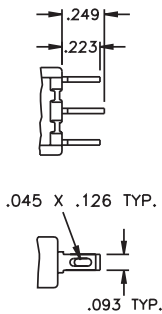

SOLDER LUG

### C

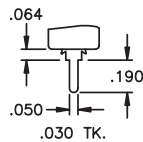

PRINTED CIRCUIT

### W

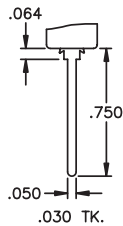

WIREWRAP

### W1

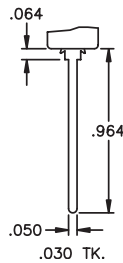

LONG WIREWRAP

### W3

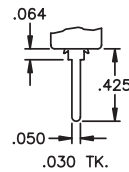

SHORT WIREWRAP

### X

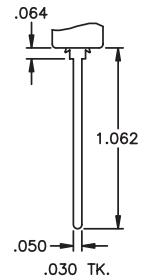

EXTRA LG. WIREWRAP



# PB SERIES - MINIATURE MOMENTARY PUSHBUTTON SWITCHES

## CONTACT MATERIAL OPTIONS

<b>B</b>	Dry circuit - gold over nickel over brass. RATING: 0.4 Volt-Amps (VA) max. at 20 V max. ELECTRIC LIFE: 60,000 cycles minimum. MECHANICAL LIFE: 500,000 cycles minimum.
<b>Q</b>	Power circuit - coin silver. RATING: 6 Amps at 125 VAC, 3 Amps at 250 VAC or 7 Amps at 30 VDC (resistive loads). ELECTRIC LIFE: 60,000 cycles minimum at full load.
<b>G</b>	Dry circuit or power circuit - gold over nickel over coin silver. RATINGS & ELECTRIC LIFE: Same as B & Q above - i.e. - can be used in either dry circuit or power circuit, however once used in power circuit, switch cannot be re-used in dry circuit. This option satisfies those customers who have both dry circuit and power circuit requirements, but prefer to inventory only one switch for both.
<b>N</b>	Dry circuit - gold over nickel over brass. Note- less gold than B option. RATING: 0.4 Volt-Amps (VA) max. at 20 V max. ELECTRIC LIFE: 10,000 cycles min. at 13 cycles per minute.
<b>T</b>	Power circuit - Silver plate over brass. RATING: 1 Amp at 125 VAC or 0.5 Amps at 250 VAC (resistive loads). ELECTRIC LIFE: 10,000 cycles min. at 13 cycles per minute.

Solder dipped terminals and custom contact plating available - contact factory.

## UL & CSA OPTIONS

<b>UL</b>	For power circuits - coin silver RATING: 6 Amps at 125 VAC or 3 Amps at 250 VAC (75% power factor). Underwriter Laboratories file no. E66367. Note - applicable only to terminations with coin silver contacts (Q or G options).
<b>CSA</b>	For power circuits - coin silver RATING: 6 Amps at 125 VAC or 3 Amps at 250 VAC (75% power factor). Canadian Standards Association file no. LR54592-1. Note - applicable only to terminations with coin silver contacts (Q or G options) as CSA recognizes switches for power applications only.

## EPOXY SEALING OPTION

<b>E</b>	Space between terminals and case hole is completely epoxy sealed to prevent flux and contaminant entry.
----------	---

## REVERSE ACTION OPTION

<b>/R</b>	To reverse the <b>NO</b> and <b>NC</b> terminals, add <b>/R</b> to the switch model number.
-----------	---

## PANEL CUT-OUTS

### Cut-outs that accept all 1/4-40 threaded bushings:

<b>Without keying</b>	<b>With A107 anti-rotate ring</b>	<b>With A158 anti-rotate ring</b>	<b>With D bushing</b>	<b>With slotted keyway bushings</b>	<b>Accepts all 1/4" non-threaded bushings</b>

## MISCELLANEOUS

**QUICK-CONNECT RECEPTACLES** that are compatible with solder lug or p.c. terminals are commercially available. Consult factory.

**FRONT PANEL SEAL:** Silicone rubber boots for front panel sealing of the switch against high pressure water or other contaminants are available. See Waterproof Switch Sealing Boots section in catalog.

**SWITCH CAPS** for switches without bezels also available - see Hardware section of catalog