

MODEL 25

1/4" Square

Single Turn

Cermet Trimming

Potentiometer

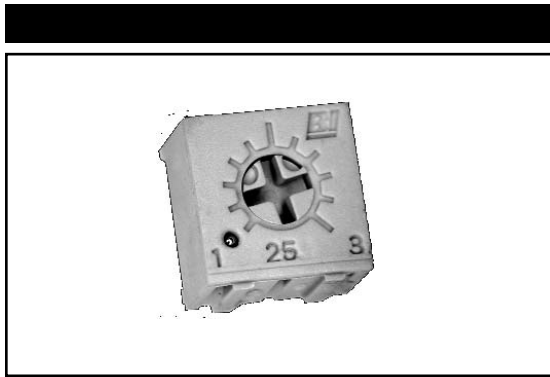

1

ELECTRICAL

| | |
|---------------------------------------|---|
| Standard Resistance Range, Ohms | 10 to 2Meg |
| Standard Resistance Tolerance | ±10% |
| Input Voltage, Maximum | 250 Vdc or rms not to exceed power rating |
| Power Rating, Watts | 0.5 at 70°C derating to 0 at 125°C |
| End Resistance, Maximum | 1% or 2 Ohm, whichever is greater |
| Actual Electrical Travel, Nominal | 210° |
| Dielectric Strength | 900Vrms |
| Insulation Resistance, Minimum | 1,000 Megohms |
| Resolution | Essentially infinite |
| Contact Resistance Variation, Maximum | 1% or 3 Ohm, whichever is greater |

ENVIRONMENTAL

| | |
|----------------------------------|--|
| Seal | 85°C Fluorinert® (No Leaks) |
| Temperature Coefficient, Maximum | ±100ppm/°C |
| Operating Temperature Range | -55°C to +125°C |
| Thermal Shock | 5 cycles, -55°C to +125°C (2% ΔRT, 2% ΔVR) |
| Moisture Resistance | Ten 24 hour cycles (3% ΔRT) |
| Shock, 6ms Sawtooth | 100G's (1% ΔRT, 1% ΔVR) |
| Vibration | 20G's, 10 to 2,000 Hz (1% ΔRT, 1% ΔVR) |
| High Temperature Exposure | 250 hours at 125°C (2% ΔRT, 2% ΔVR) |
| Rotational Life | 200 cycles (2 Ohms +3% ΔRT) |
| Load Life at 0.5 Watts | 1,000 hours at 70°C (3% ΔRT, 3% ΔVR) |
| Resistance to Solder Heat | 350°C for 3 sec. (1% ΔRT) |

MECHANICAL

| | |
|------------------------|-----------------------|
| Mechanical Stops | Solid |
| Stop Strength, Minimum | 6 oz.-in. (500 gr-cm) |
| Torque, Maximum | 3 oz.-in. (200 gr-cm) |
| Weight, Nominal | .01 oz. (0.3 grams) |

Fluorinert® is a registered trademark of 3M Company.
Specifications subject to change without notice.



TOP ADJUSTMENT (Inch/mm)

MODEL 25P

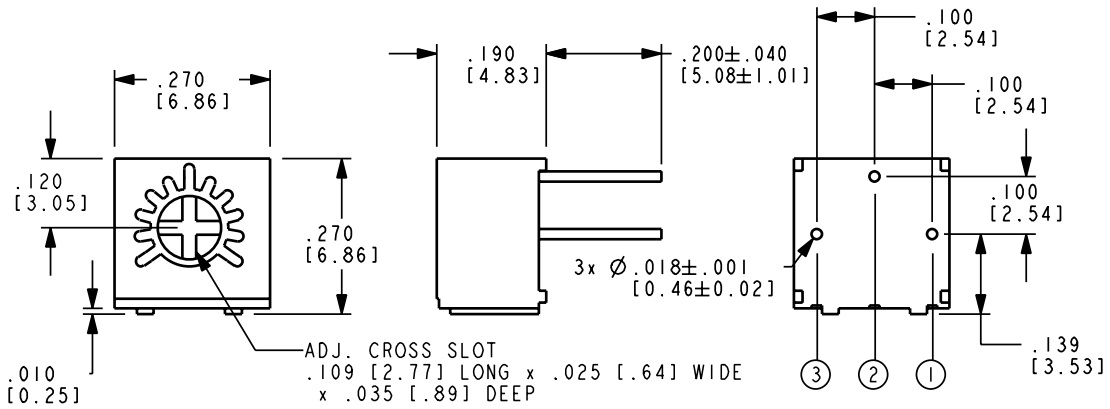

Note: Model 25P dimensions applicable to all models except as noted

MODEL 25U

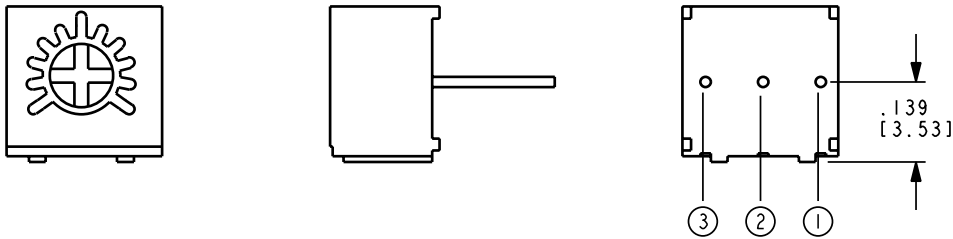

MODEL 25W

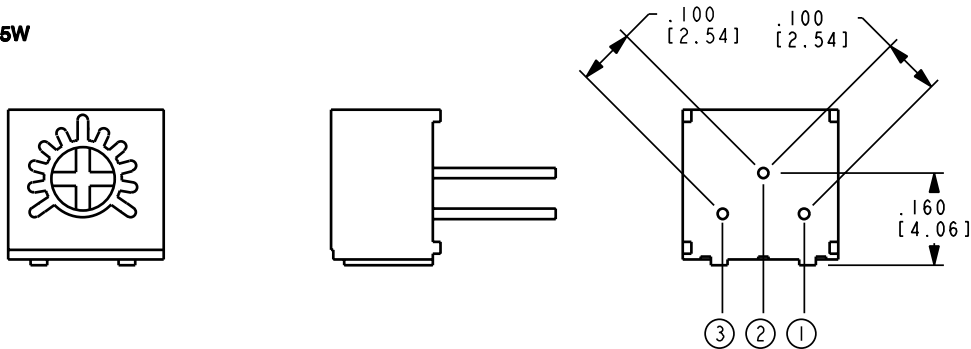

STANDARD RESISTANCE VALUES, OHMS

| | | | | | |
|----|-----|----|-----|------|------|
| 10 | 100 | 1K | 10K | 100K | 1Meg |
| 20 | 200 | 2K | 20K | 200K | 2Meg |
| 50 | 500 | 5K | 50K | 500K | |



MODEL 25S

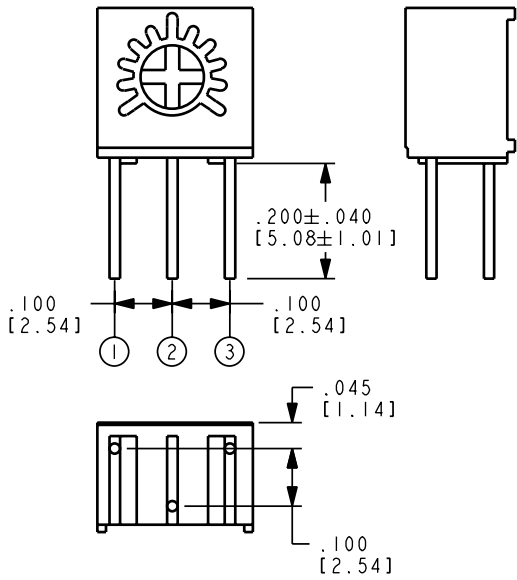

MODEL 25X

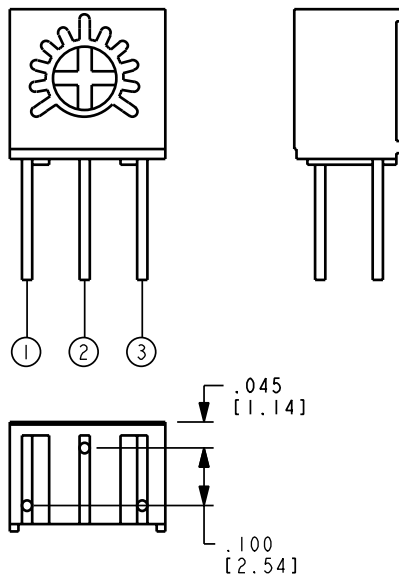

MODEL 25RX

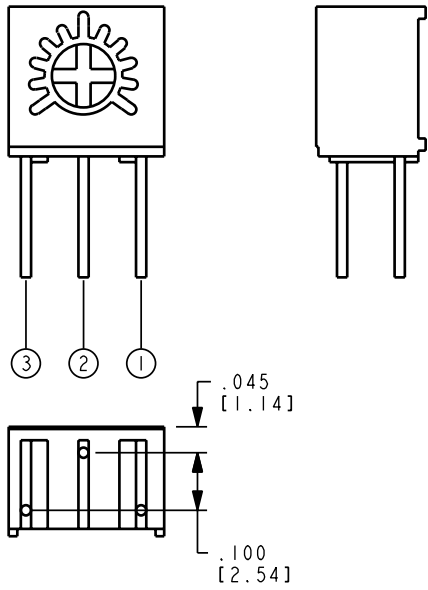

MODEL 25V

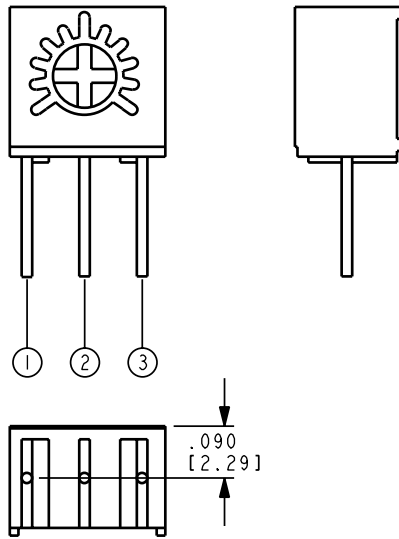

PACKAGING

Standard: Tubes, all styles, 50 units/tube
All units oriented with #1 pin to same side.

Option : Tape & Reel, Ammo Pack (Available only for 25U and 25V)
All units oriented with #3 pin towards direction of feed.

| | | | |
|------|---|---|--|
| | Seat Plane to Centerline of Sprocket Hole | = | .71" (18 mm) |
| Tape | Width | = | 18 mm |
| | Sprocket | = | Single Hole .50" spacing |
| | Capacity | = | 750 Units U style, 1000 V style |
| Reel | Diameter | = | 14" (363 mm) |
| Ammo | Tape Fold | = | 12" |
| | Box | = | 2.0" x 13.4" x 13.8" (50mm x 340mm x 350mm) |

ORDERING INFORMATION

Standard Package

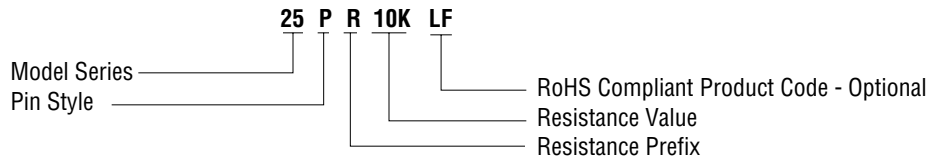

Optional Packaging

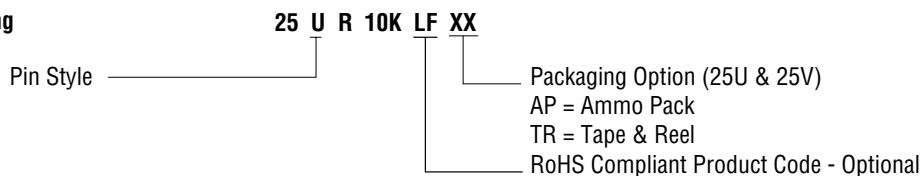

CIRCUIT DIAGRAM

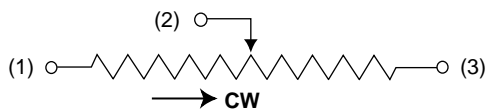

NOTES

English equivalents are based on 1 inch = 25.4mm and are provided for general information only.

Tolerances unless otherwise specified:
Linear = ± 0.3 mm (.01 in.)

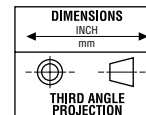

1-20

Model 25