

4

3

2

1

THIS DRAWING IS UNPUBLISHED. RELEASED FOR PUBLICATION. BY TYCO ELECTRONICS CORPORATION. ALL INTERNATIONAL RIGHTS RESERVED.

| LOC | DIST | REVISIONS |    |                          |         |     |       |
|-----|------|-----------|----|--------------------------|---------|-----|-------|
|     |      | P         | LR | DESCRIPTION              | DATE    | BY  | APP'D |
| G   | 14   | A         |    | REVISED PER 0720-0230-93 | 2/28/94 | DKS | DAP   |

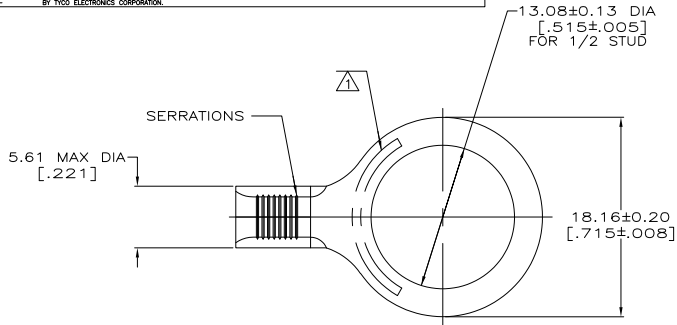

|                    |                    |
|--------------------|--------------------|
| WIRE RANGE         | Listed FILE E13288 |
| 12-10 AWG STRANDED | 12-10 AWG STRANDED |

- STAMP AMP 12-10\* APPROX AS SHOWN
- COPPER PER ASTM B-152, ANNEALED
- TIN PLATE 0.00254 [.000100] MIN THK PER ASTM B545

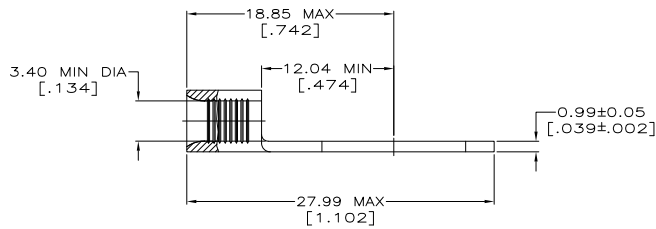

52269-1  
PART NO.

|   |  |                            |                          |   |
|---|--|----------------------------|--------------------------|---|
| MAX RECOMMENDED OPERATING TEMPERATURE:<br>170°C MAX                       | THIS DRAWING IS A CONTROLLED DOCUMENT. |                            | DR. TA. BRINKMAN 2-8-93  | Tyco Electronics Corporation<br>Harrisburg, PA 17105-3608 |
|   | VOLTAGE RATING:<br>N/A                 | DIMENSIONS:<br>MM (INCHES) | OK. DA. PATTERSON 2-8-93 |   |
| CIRCULAR MIL AREA:<br>2.62-6.64mm <sup>2</sup> [5,180-13,100]<br>STRANDED | MATERIAL:<br>COPPER                    | FINISH:<br>TIN PLATE       | APPLIC. SPEC:<br>—       | RESTRICTED TO:<br>—                                       |
|   |  |                            | PRODUCT SPEC:<br>—       | SIZE: A2  |
|   |  |                            | WEIGHT:<br>—             | CAGE CODE: C=52269  |
|   |  |                            | CUSTOMER DRAWING         | SCALE: 4:1 SHEET: 1 of 1 REV: A                           |