

4

3

2

1

THIS DRAWING IS UNPUBLISHED. RELEASED FOR PUBLICATION  
 © COPYRIGHT BY TYCO ELECTRONICS CORPORATION. ALL INTERNATIONAL RIGHTS RESERVED.

LOC		DIST		REVISIONS			
P	LR	DATE	BY	APP'D	DESCRIPTION		
G	14	D1	REV PER ECR	08-030953	05DEC08	JR	RL

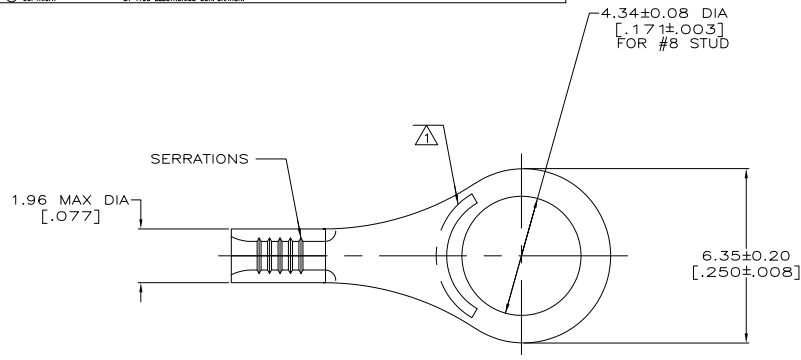

<b>AMP</b> WIRE RANGE	Listed FILE E13288	LR7189 Certified
26-22 AWG STRANDED	NOT LISTED	NOT LISTED

- 1 STAMP AMP APPROX AS SHOWN
- 2 0.00254 [.000100] MIN TIN PER ASTM B-545
- 3 CLEANED, UNPLATED
- 4 0.00254 [.000100] MIN EXT THK GOLD PL PER ASTM B-488 OVER 0.00076 [.000030] MIN NICKEL PER QQ-N-290.
- 5 COPPER PER ASTM B-152, ANNEALED
- 6 PREPRODUCTION - FASR REQUIRED

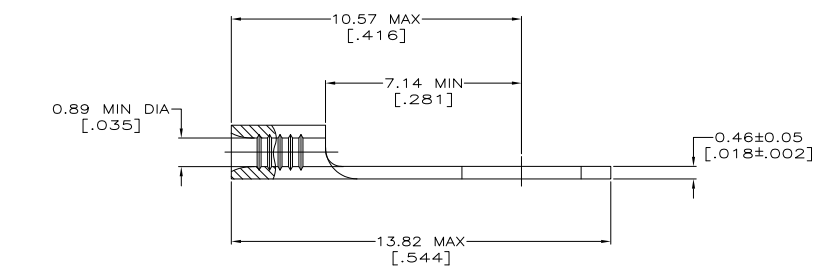

4	6	2-32859-5
3		32859-1
2		32859
FINISH		PART NO.

AMP INCORPORATED CUSTOMER SERVICE SYSTEMS		MAX RECOMMENDED OPERATING TEMPERATURE: 170°C	THIS DRAWING IS A CONTROLLED DOCUMENT.		DR: J.A. BRINKMAN 2-2-93 OK: J.A. PATTERSON 2-2-93	Tyco Electronics Corporation Harrisburg, PA 17105-3608					
FOR ADDITIONAL PRODUCT INFORMATION OR COPIES OF DRAWINGS AND TECHNICAL DOCUMENTS	PRODUCT INFORMATION CENTER 1-800-522-6752	VOLTAGE RATING: N/A	DIMENSIONS: [MM/INCHES]	OTHER FINISHES: OTHER FINISHES:	DR: J.L. MECKLEY 2-2-93	TERMINAL, RING TONGUE, BUDGET					
FOR APPLICATION	TOOLING ASSISTANCE CENTER 1-800-722-1111	CIRCULAR MIL AREA: 0.1-0.41mm <sup>2</sup> [200-810] STRANDED	MATERIAL - 3	FINISH -	APPLICATION SPEC	SIZE	CAGE CODE	DRAWING NO.	RESTRICTED TO		
TOOLING INFORMATION	1-800-722-1111	HEIGHT			A2	00779	C=32859				
FOR ORDER ENTRY	1-800-526-5142	THIS DRAWING IS A CONTROLLED DOCUMENT FOR AMP INCORPORATED. IT IS SUBJECT TO CHANGE AND THE CONTROLLING ENGINEERING ORGANIZATION SHOULD BE CONTACTED FOR THE LATEST REVISION.		CUSTOMER DRAWING		SCALE	10:1	SHEET	1 of 1	REV	D1

1471-9 (1/08)

32859

A