

4

3

2

1

THIS DRAWING IS UNPUBLISHED. RELEASED FOR PUBLICATION  
 COPYRIGHT BY TYCO ELECTRONICS CORPORATION. ALL RIGHTS RESERVED.

LOC	DIST	REVISIONS			
P	LR	DESCRIPTION	DATE	BY	APP'D
AF	50	0	TRANSFERRED TO TYCO FORMAT	04NOV02	MF EH

- 1 CRIMPBAND MATERIAL PROVIDED IN CONTINUOUS STRIP.
- 2 REFERENCE DESCRIPTIVE PART NUMBER G125/16510R25TB.
- 3 BLANK LENGTH DETERMINED BY 125/165 TOOLSET.
- 4 108 METERS PER REEL.

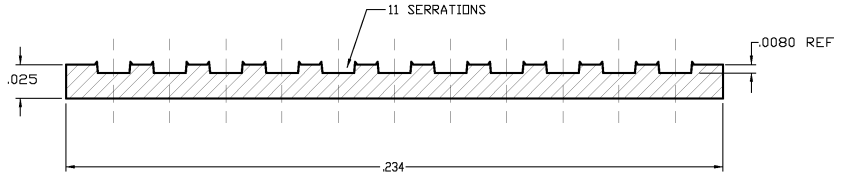
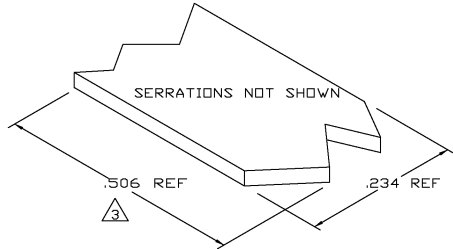

TYP. CROSS SECTION

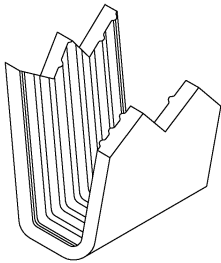

PARTIAL FORMED VIEW (REF)  
FORMED BY APPLICATION TOOLING

1601705-1  
PART NUMBER

THIS DRAWING IS A CONTROLLED DOCUMENT.		DRW: MICHAEL S. FEHLER CHK: EDWARD HOWARD APP'D: EDWARD HOWARD	04NOV2002 04NOV2002 04NOV2002	<b>Tyco Electronics</b> Tyco Electronics Corporation Harrisburg, PA 17105-3608	1601705-1 PART NUMBER
DIMENSIONS: INCHES	UNLESS OTHERWISE SPECIFIED:	PRODUCT SPEC	APPLICATION SPEC	WEIGHT	SHEET ONE CODE DRAWING NO
0 PLG ±	1 PLG ±	2 PLG ±	3 PLG ± .005	4 PLG ±	ANGLES ±
MATERIAL: UNS C26000 BRASS	FINISH: TIN	CUSTOMER DRAWING	SCALE: 1:1	SHEET 1 OF 1	REV 0

AMP 1471-9 REV 31MAR2000

H:\dm\lecard\

1601705

B

A