

THIS DRAWING IS UNAPPROVED FOR PUBLICATION
 REVISIONS: 19
 (C) COPYRIGHT 1989 BY AMP INCORPORATED. ALL RIGHTS RESERVED. TOUT DROIT RESERVE.

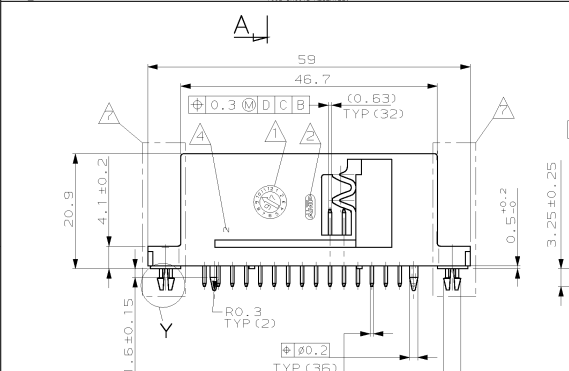

SECTION AA
(COUPE)

VIEW F
(VUE)

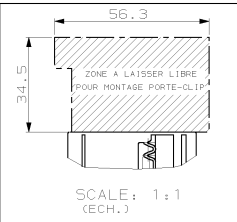
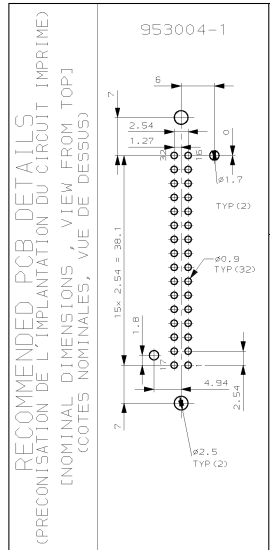
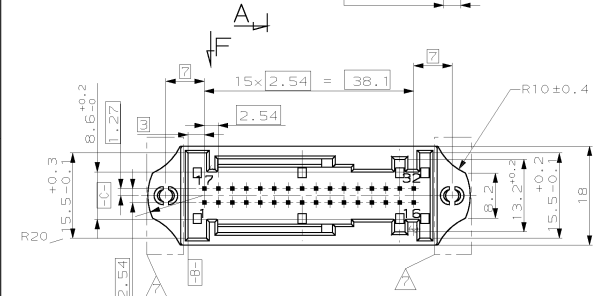
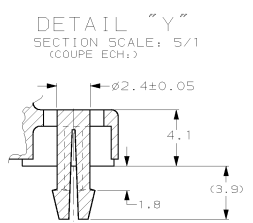
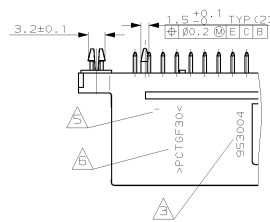

CODING (Détrompage) (SCALE : 1:1) (ECH.)	COLOR (COULEUR)	P/N ASS'Y (Référence- assemblée)
	BLACK (NOIR)	953004-1

- NOTES:
- DATE CODE DATEUR
 - AMP LOGO SIGLE D'AMP
 - ASSEMBLY PART NUMBER REFERENCE DU PRODUIT ASSEMBLE
 - CAVITY MARKING N° D'EMPREINTE
 - MOLD REVISION STATUS REVISION DU MOULE
 - HOUSING MATERIAL MATIERE DU BOITIER
 - AREA FOR OTHER FIXING SYSTEMS ZONE POUR D'AUTRES SYSTEMES DE FIXATION

PCT GF 30	BRONZE	TIN LEAD-FREE OVER NICKEL (ETAIN SANS PLOMB SUR SOUS-COUCHE NICKEL)
HOUSING MATERIAL (MATIERE DU BOITIER)	PIN MATERIAL (MATIERE DU CONTACT)	FINITION

DIVERSITE 30-MAR-90 D. Durand 04/VERIFIE 03-APR-90 11-AUGUSTE 03-APR-90 05-15167 APPLICATION SPEC PREC. APPLICATION	AMP DE FRANCE 95301 PONTOISE AMP 32 WAY MOS HEADER EMBASE 32 VOIES MOS CASE CODE 00779 DRAWING NO 953004 SCALE SHEET 1 OF 1 REV C
--	---

AMP1471-9 REV 10/93
 08-JUN-05 16:28:05 er003299/home/dept1302/er003299/edmod