

4

3

2

1

THIS DRAWING IS UNPUBLISHED. RELEASED FOR PUBLICATION
 © COPYRIGHT - BY TYCO ELECTRONICS CORPORATION. ALL RIGHTS RESERVED.

LOC	DIST	REVISIONS			
P	LTR	DESCRIPTION	DATE	DWN	APVD
G	14	D1	REV PER ECR 07-012476	30MAY07	JR TM

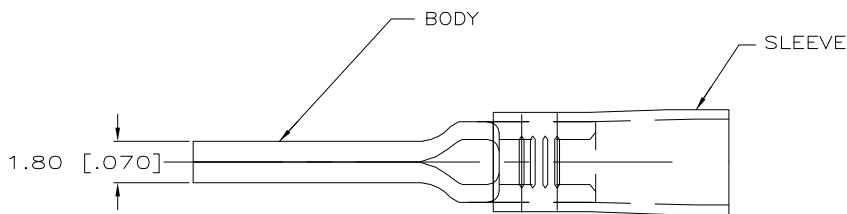

AMP WIRE RANGE	FILE E13288
22-16 AWG STRANDED	22-16 AWG STRANDED

1 WIRE INSULATION DIA.
 2.67-3.56 [.105-.140] DIA.

2 MATERIAL: BODY - CU PER ASTM B152
 SLEEVE - NYLON

3 FINISH: BODY - TIN PL ASTM B545
 SLEEVE - COLOR - RED

4 LOOSE PIECE P/N 165168

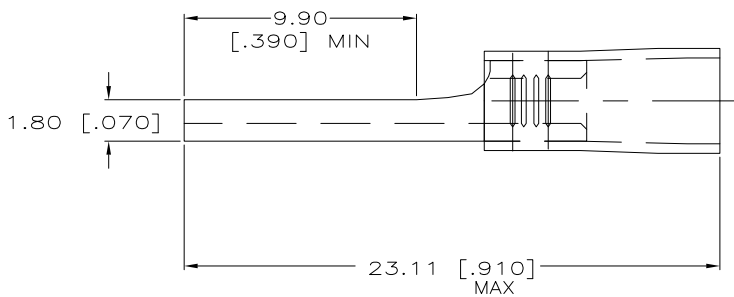

5000	ON TAPE	696273-2
QTY	PACKAGE TYPE	PART NO

AMP INCORPORATED
 CUSTOMER SERVICE SYSTEMS

MAX RECOMMENDED OPERATING TEMPERATURE:
 105°C [221°F]

THIS DRAWING IS A CONTROLLED DOCUMENT.

DWN JR RUTH 01DEC00	Tyco Electronics	Tyco Electronics Corporation Harrisburg, PA 17105-3608
CHK T MICHELUTTI 01DEC00	NAME	TERMINAL, WIRE PIN, PIDG WIRE SIZE, 22-16 AWG
APVD T MICHELUTTI 01DEC00	PRODUCT SPEC	
APPLICATION SPEC	SIZE	CAGE CODE
WEIGHT	DRAWING NO	RESTRICTED TO
A3	00779	C-696273
CUSTOMER DRAWING	SCALE	SHEET
	6:1	1 OF 1
		REV
		D1

FOR ADDITIONAL PRODUCT INFORMATION OR COPIES OF DRAWINGS AND TECHNICAL DOCUMENTS

PRODUCT INFORMATION CENTER
 1-800-522-6752

VOLTAGE RATING:
 300V MAX

DIMENSIONS:
 mm [INCHES]

0 PLC ± -
 1 PLC ± -
 2 PLC ± 0.20 [.008]
 3 PLC ± -
 4 PLC ± -
 ANGLES ± -

FOR APPLICATION TOOLING INFORMATION

TOOLING ASSISTANCE CENTER
 1-800-722-1111

CIRCULAR MIL AREA:
 0.25-1.6mm² [493-3158]
 STRANDED

MATERIAL

FINISH

FOR ORDER ENTRY

1-800-526-5142

THIS DRAWING IS A CONTROLLED DOCUMENT FOR AMP INCORPORATED. IT IS SUBJECT TO CHANGE AND THE CONTROLLING ENGINEERING ORGANIZATION SHOULD BE CONTACTED FOR THE LATEST REVISION.

2

3