

DRAWING MADE IN THIRD ANGLE PROJECTION

THIS DRAWING IS UNPUBLISHED. RELEASED FOR PUBLICATION, 19 .

© COPYRIGHT 19 BY AMP INCORPORATED. ALL INTERNATIONAL RIGHTS RESERVED.

LOC	DIST	P	F	ZONE	LTR	DESCRIPTION	DATE	APPD
AF	50					REV PER 061A-0131-98	5/13/98	JR/JW

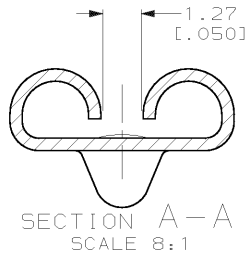
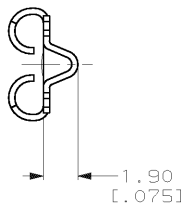
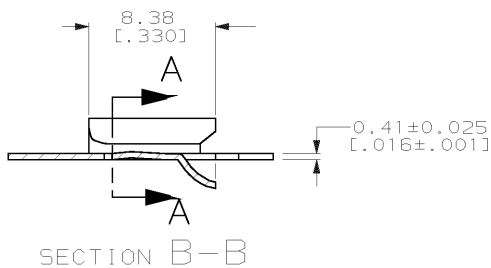
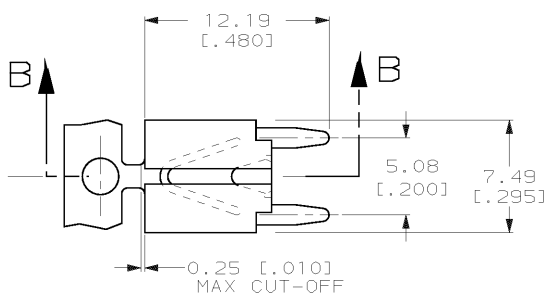

- 1 CONTINUOUS STRIP ON REELS.
- 2 0.00254 [.000100] MIN THK TIN OVER 0.00127 [.000050] MIN NICKEL.
- 3 MATING TAB THK IS 0.81±0.025 [.032±.001].

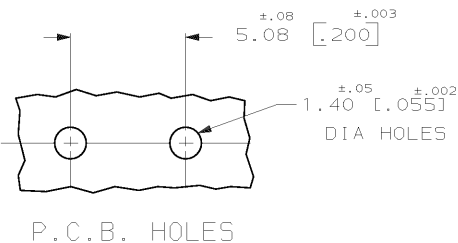

63968-1
PART NO

THIS DRAWING IS A CONTROLLED DOCUMENT FOR AMP INCORPORATED. IT IS SUBJECT TO CHANGE AND THE CONTROLLING ENGINEERING ORGANIZATION SHOULD BE CONTACTED FOR THE LATEST REVISION.

DO NOT SCALE PRINT. UNLESS SPECIFIED DIMENSIONS IN mm [INCHES] TOLERANCES ON: 1. PLC DEC ± 0.25 [.010] 2. PLC DEC ± - ANGLES ± -		DR 2/18/97 JR RUTH CHK 2/18/97 MS FEHER APPD 2/18/97 P DESANTIS APPD 2/18/97 V KARABCJEVSOHY	AMP AMP Incorporated Harrisburg, PA 17105-3608	
MATERIAL H04 BRASS		PRODUCT SPEC -	NAME RECEPTACLE, L.I.F. FASTON™ 6.35/5.21 [.250/.205] SERIES, PC BOARD MOUNTED	
FINISH TIN OVER NICKEL		APPLICATION SPEC -	SIZE B	CAGE CODE 00779
		WEIGHT -	DRAWING NO C=63968	SHEET 1 OF 1
			SCALE 4:1	SHEET 1 OF 1