

4

3

2

1

THIS DRAWING IS UNPUBLISHED. RELEASED FOR PUBLICATION  
 © COPYRIGHT - BY TYCO ELECTRONICS CORPORATION. ALL RIGHTS RESERVED.

LOC	DIST	REVISIONS					
AF	50	P	LTR	DESCRIPTION	DATE	DWN	APVD
		H1		REV PER ECR-06-018933	11AUG06	HMR	KR

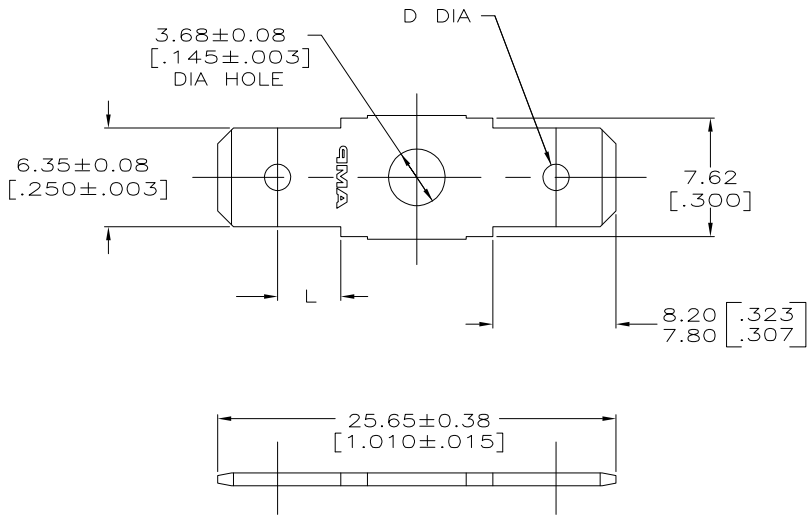

- 1 SUPPLIED IN LOOSE PIECE.
- 2 ELECTRICAL TEST TAB ONLY.
- 3 PRELIMINARY - NOT FOR PRODUCTION

2.03 [.080] 1.93 [.076] DIA HOLE	4.01±0.08 [.158±.003]	0.002032 [.000080] MIN TIN	0.813±0.012 [.032±.0005] CR STEEL	62627-4 <sup>3</sup>
2.03 [.080] 1.65 [.065] DIA HOLE	3.40±0.08 [.134±.003]	-	0.813±0.007 [.032±.0003] BRASS	62627-3
2.03 [.080] 1.65 [.065] DIA DIMPLE	4.06±0.08 [.160±.003]	0.002032 [.000080] MIN TIN	0.813±0.012 [.032±.0005] CR STEEL	62627-2
DIM D	DIM L	FINISH	MATERIAL	PART NO.

THIS DRAWING IS A CONTROLLED DOCUMENT.

DIMENSIONS: mm [INCHES]

TOLERANCES UNLESS OTHERWISE SPECIFIED:

0 PLC	± -
1 PLC	± -
2 PLC	± 0.25 [.010]
3 PLC	± -
4 PLC	± -
ANGLES	± -

MATERIAL: SEE TABLE

FINISH: SEE TABLE

OWN: JR RUTH 8/6/96

CHK: MS FEHER 8/6/96

APVD: P DESANTIS 8/6/96

NAME: Tyco Electronics Corporation, Harrisburg, PA 17105-3608

PRODUCT SPEC: -

APPLICATION SPEC: -

WEIGHT: -

SIZE: A3 CAGE CODE: 00779 DRAWING NO: C=62627 RESTRICTED TO: -

CUSTOMER DRAWING SCALE: 4:1 SHEET: 1 of 1 REV: H1