

THIS DRAWING IS UNPUBLISHED. RELEASED FOR PUBLICATION
 © COPYRIGHT - By - ALL RIGHTS RESERVED.

LOC	DIST	REVISIONS					
AF	50	P	LTR	DESCRIPTION	DATE	DWN	APVD
		F		REVISED PER ECR-11-018063	22DEC11	KH	PD

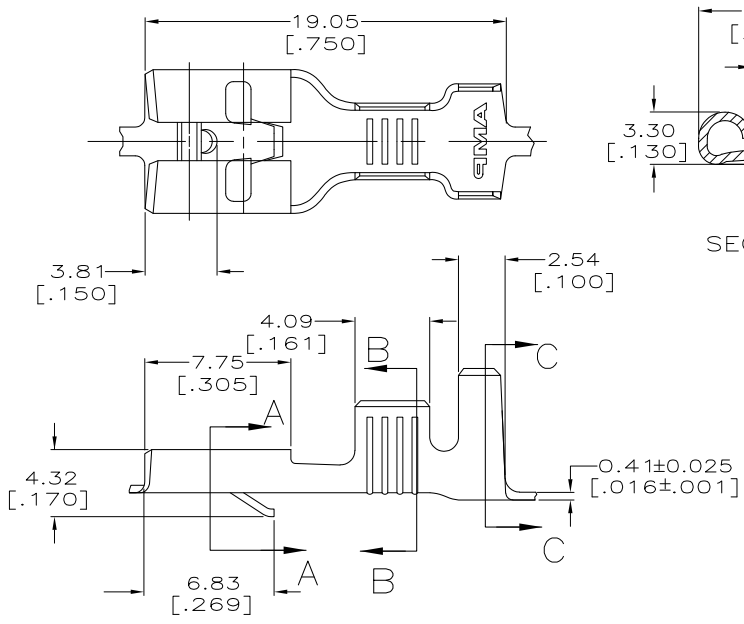

SECTION A-A

- CONTINUOUS STRIP ON REELS.
 - ACCEPTS WIRE SIZE [#16-#12 OR TWO #16'S].
 - INSULATION RANGE TO BE 4.06-5.33 [.160-.210] OR TWO 3.30 [.130] MAX DIA.
 - MATING TAB THK IS 0.81±0.025 [.032±.001].
- ⚠ INTERLEAVING PAPER REQUIRED.
 ⚠ PRELIMINARY - NOT FOR PRODUCTION

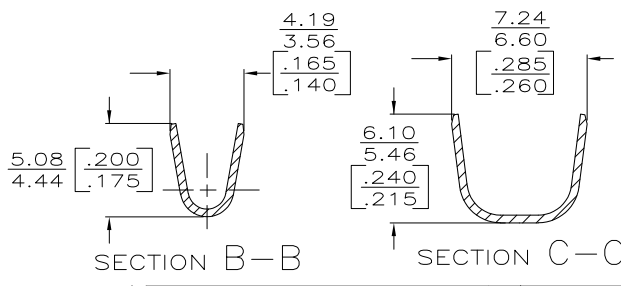

⚠ 5	0.002032 [.000080] MIN TIN	⚠ 6	60249-5
	0.000381 [.000015] THK SILVER		60249-3
	TIN		60249-2
	-		60249-1
	FINISH		PART NO

THIS DRAWING IS A CONTROLLED DOCUMENT.		DWN	JR RUTH	7/14/95	TE Connectivity RECEPTACLE, FASTIN-FASTON, 6.35 [.250] SERIES
DIMENSIONS: mm [INCHES]		CHK	MS FEHER	7/14/95	
TOLERANCES UNLESS OTHERWISE SPECIFIED:		APVD	J GILLESPIE	7/14/95	
0 PLC ±- 1 PLC ±- 2 PLC ±- 3 PLC ± 0.38 [.015] 4 PLC ±- ANGLES ±-		NAME			
MATERIAL	H04 BRASS	FINISH	SEE TABLE	APPLICATION SPEC	114-2025
		WEIGHT	-	SIZE	A3
		CUSTOMER DRAWING		CAGE CODE	C=60249
		SCALE	5:1	DRAWING NO	C=60249
		SHEET	1 of 1	RESTRICTED TO	-
		REV	F		