

DRAWING NUMBER C-160.762

DRAWING MADE IN AMERICAN PROJECTION

LTR	DESCRIPTION	DATE	DR	APD
L2	ECO-11-005140	31MAR11	RK	HMR

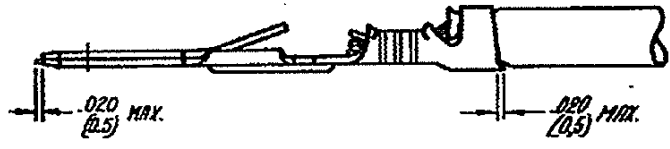

2 OBSOLETE PARTS: OBSOLETE CIS STREAMLINING PER D.RENAUD/D.SINISI

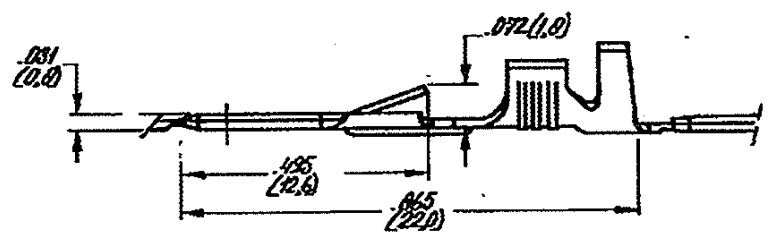
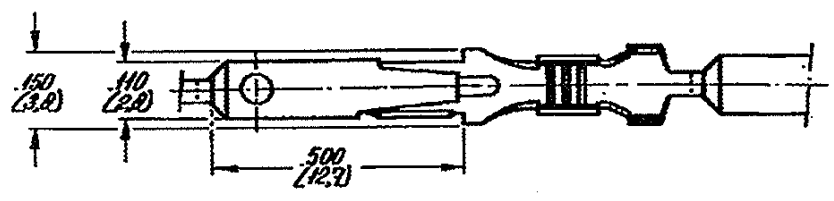

NOTE: REELED WITH PAPER COVER

DIMENSIONS IN (IN) DO NOT SCALE PRINT

160762-6	BRASS	UNPLATED
160762-5	PHOSPH. BRZ.	UNPLATED/2
160762-4	BRASS	PRE-TIN PL.
160762-3	BRASS	
160762-2	PHOSPH. BRZ.	PRE-TIN PL.
160762-1	PHOSPH. BRZ.	

**CUSTOMER COPY FOR REFERENCE ONLY**

**TE** TE Connectivity

WIRE RANGE 0.5-1.5mm <sup>2</sup>	WIRE RANGE 28-30 AWG	FIRST USED
SCALE 4:1	SIZE A	NO C-160.762
ORDER NO.	MATERIAL	PLATING
DATE 24.8.20	DATE 24.8.20	DATE 24.8.20

NAME  
**.110 SER. FASTIN-FASTON TAB.**