

THIS DRAWING IS UNPUBLISHED.		RELEASED FOR PUBLICATION		2010	
COPYRIGHT 2010		BY TYCO ELECTRONICS CORPORATION, ALL RIGHTS RESERVED.			

LOC	DIST	REVISIONS					
E	B	P	LTR	DESCRIPTION	DATE	DWN	APVD
		BA		NEW RELEASE	04-MAR-10	MRS	ST.P

FOR FURTHER INFORMATION SEE DATA SHEET FOR SERIES SC - AXIAL LEADED POWER INDUCTORS

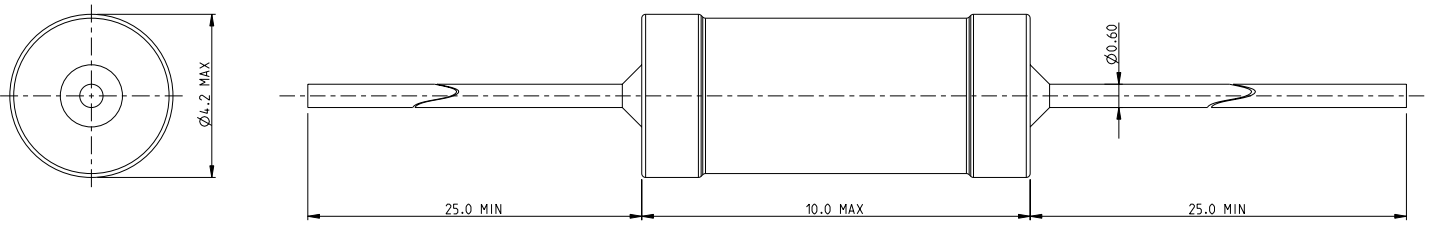

RoHS Compliant

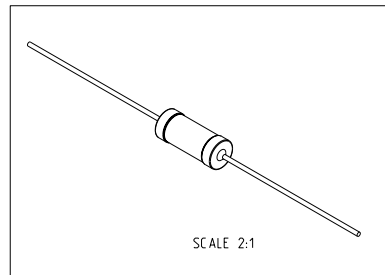

<small>THIS DRAWING IS A CONTROLLED DOCUMENT FOR TYCO ELECTRONICS CORPORATION. IT IS SUBJECT TO CHANGE AND THE CONTROLLING ENGINEERING ORGANIZATION SHOULD BE CONTACTED FOR THE LATEST REVISION.</small>		DWN MAHARUDRA 04-MAR-10 CHK ALLAN.P 04-MAR-10 APVD STEPHEN.P 04-MAR-10	Tyco Electronics Corporation Dorcan, Swindon, SN3 5HH
DIMENSIONS: mm	TOLERANCES UNLESS OTHERWISE SPECIFIED: 0 PLC ±0.2 1 PLC ±0.1 2 PLC ± 3 PLC ± 4 PLC ± ANGLES ±5°	NAME AXIAL LEADED POWER INDUCTORS SERIES SC10	RESTRICTED TO -
MATERIAL - FINISH -	APPLICATION SPEC - WEIGHT -	SIZE A3	CAGE CODE 00779
CUSTOMER DRAWING		DRAWING NO C-1623958	SCALE 10:1
		SHEET 1	OF 1
		REV BA	

AMP 1470-19 REV 31MAR2000
 Pro/ENGINEER DRAWING