

THIS DRAWING IS UNPUBLISHED  
 ALL RIGHTS RESERVED

REV	DATE	DESCRIPTION	BY	CHK	APP
64	7/24	REVISED PER EDD-11-004917	11MM11	RK	HMR

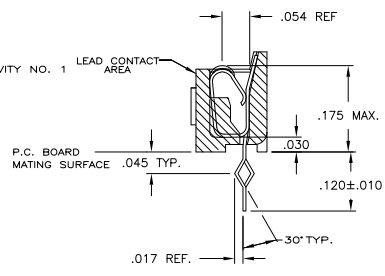

SECTION A-A  
 ROTATED 90° CW  
 SCALE 10:1  
 FOR -6, -7 & -8 ONLY

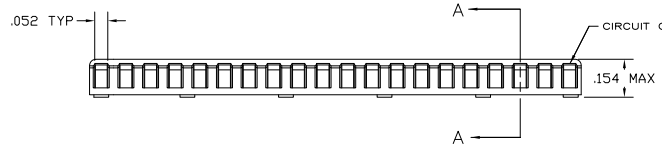
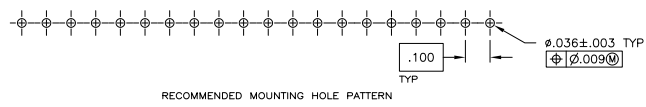
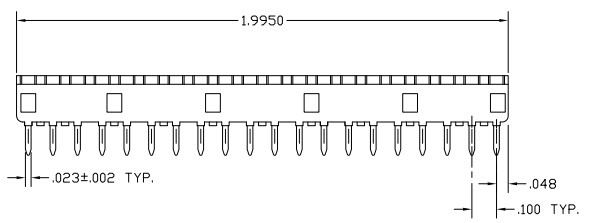

- 1. RECEPTACLE ACCEPTS AN .008-.014 THK. I.C. LEAD.
- ⚠ TWO .000030 MIN. THK. GOLD STRIPES IN CONTACT AREA, TIN-LEAD(93-7) ON CONTACT LEGS, BALANCE OF CONTACT NICKEL PLATED.
- ⚠ TWO .000015 MIN. THK. GOLD STRIPES IN CONTACT AREA, TIN-LEAD(93-7) ON CONTACT LEGS, BALANCE OF CONTACT NICKEL PLATED.
- ⚠ TUBE LOADED.

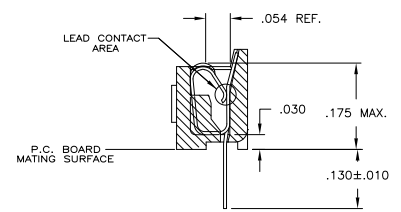

SECTION A-A  
 ROTATED 90° CW  
 SCALE 10:1  
 FOR -1, -2 & -3 ONLY

CONTACT FINISH	CONTACT MAT'L	HOUSING MATERIAL	PART NO.
⚠ OBSOLETE	TINNED	PHOS.BRZ. GLASS-FILLED THERMOPLASTIC, 94V-0, BLACK	2-643652-3
⚠ OBSOLETE	TINNED	PHOS.BRZ. GLASS-FILLED THERMOPLASTIC, 94V-0, BLACK	643652-8
	⚠	BE.CU. GLASS-FILLED THERMOPLASTIC, 94V-0, BLACK	643652-7
	TINNED	BE.CU. GLASS-FILLED THERMOPLASTIC, 94V-0, BLACK	643652-6
SUPSD BY 643652-2	⚠	PHOS.BRZ. GLASS-FILLED THERMOPLASTIC, 94V-0, BLACK	643652-4
	TINNED	PHOS.BRZ. GLASS-FILLED THERMOPLASTIC, 94V-0, BLACK	643652-3
⚠ OBSOLETE	⚠	BE.CU. GLASS-FILLED THERMOPLASTIC, 94V-0, BLACK	643652-2
	TINNED	BE.CU. GLASS-FILLED THERMOPLASTIC, 94V-0, BLACK	643652-1

THIS DRAWING IS A CONTROLLED DOCUMENT. DATE: 8-11-84

DESIGNED BY: J. JONES DATE: 7-3-84

WORKS: 108-1066

REVISED BY: 114-1049 DATE: 108-1066

REVISED BY: A1 00779 DATE: 8-11-84

REVISED BY: G=643652

REVISED BY: CUSTOMER DRAWING

TE Connectivity  
 SOCKET ASSY, SIP, 20 POS, DIPLOMATE DL

SIZE: 5.1 SHEET 1 OF 1