

THIS DRAWING IS UNPUBLISHED. ALL RIGHTS RESERVED.  
 © AMP ELECTRONICS CORPORATION. ALL RIGHTS RESERVED.

REV	DESCRIPTION	DATE	BY	APP
K	REV PER 03-0214-99	24M000	BH	HW
K1	REVISED PER ECO-10-000443	15M010	KK	AEG

- RECEPTACLE ACCEPTS AN .008-.014 THK. I.C. LEAD.
- TWO .000030 MIN. THK. GOLD STRIPES IN CONTACT AREA, TIN-LEAD(93-7) ON CONTACT LEGS, BALANCE OF CONTACT NICKEL PLATED.
- TWO .000015 MIN. THK. GOLD STRIPES IN CONTACT AREA, TIN-LEAD(93-7) ON CONTACT LEGS, BALANCE OF CONTACT NICKEL PLATED.
- OBsolete PARTS: OBSOLETE CIS STREAMLINING PER D.RENAUD/D.SINISI

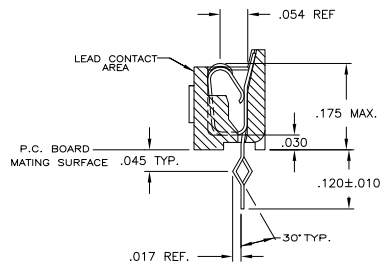
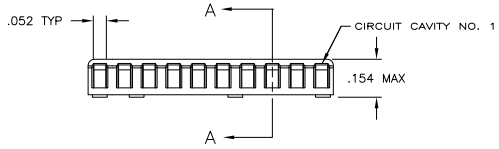

SECTION A-A  
 ROTATED 90° CW  
 SCALE 10:1  
 FOR -6, -7 & -8 ONLY

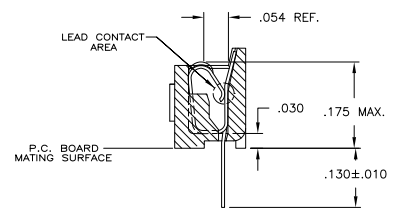

SECTION A-A  
 ROTATED 90° CW  
 SCALE 10:1  
 FOR -1, -2 & -3 ONLY

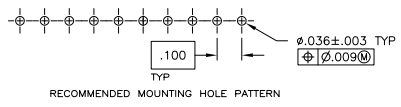
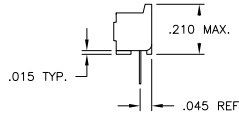
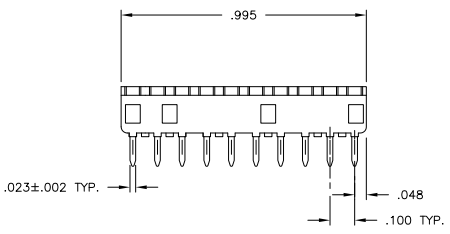

CONTACT FINISH	CONTACT MAT'L	HOUSING MATERIAL	PART NO.
TINNED	PHOS.BRZ.	GLASS-FILLED THERMOPLASTIC, 94V-0, BLACK	643642-9
OBsolete	A	BE.CU.	GLASS-FILLED THERMOPLASTIC, 94V-0, BLACK
TINNED	PHOS.BRZ.	GLASS-FILLED THERMOPLASTIC, 94V-0, BLACK	643642-7
OBsolete	A	BE.CU.	GLASS-FILLED THERMOPLASTIC, 94V-0, BLACK
SUPSD BY 643642-2	TINNED	PHOS.BRZ.	GLASS-FILLED THERMOPLASTIC, 94V-0, BLACK
OBsolete	A	BE.CU.	GLASS-FILLED THERMOPLASTIC, 94V-0, BLACK
TINNED	PHOS.BRZ.	GLASS-FILLED THERMOPLASTIC, 94V-0, BLACK	643642-4
OBsolete	A	BE.CU.	GLASS-FILLED THERMOPLASTIC, 94V-0, BLACK
TINNED	PHOS.BRZ.	GLASS-FILLED THERMOPLASTIC, 94V-0, BLACK	643642-3
OBsolete	A	BE.CU.	GLASS-FILLED THERMOPLASTIC, 94V-0, BLACK
TINNED	PHOS.BRZ.	GLASS-FILLED THERMOPLASTIC, 94V-0, BLACK	643642-8
OBsolete	A	BE.CU.	GLASS-FILLED THERMOPLASTIC, 94V-0, BLACK
TINNED	PHOS.BRZ.	GLASS-FILLED THERMOPLASTIC, 94V-0, BLACK	643642-1
OBsolete	A	BE.CU.	GLASS-FILLED THERMOPLASTIC, 94V-0, BLACK

THIS DRAWING IS A CONTROLLED DOCUMENT.

AMP ELECTRONICS CORPORATION  
 Harrisburg, PA 17105

SOCKET ASSY, SIP, 10 POS, DIPLOMATE DL

108-1066

114-1049

DATE 00779

CUSTOMER DRAWING