

THIS DRAWING IS UNPUBLISHED.		RELEASED FOR PUBLICATION	
© COPYRIGHT - By -		ALL RIGHTS RESERVED.	
PART NUMBER	PACKAGE TYPE	QTY	
8-320383-3	LOOSE PIECE, BOX	25	⚠

LOC	DIST	REVISIONS					
G	14	P	LTR	DESCRIPTION	DATE	DWN	APVD
		J1		REVISED PER ECO-11-004820	11MAR11	RK	HMR

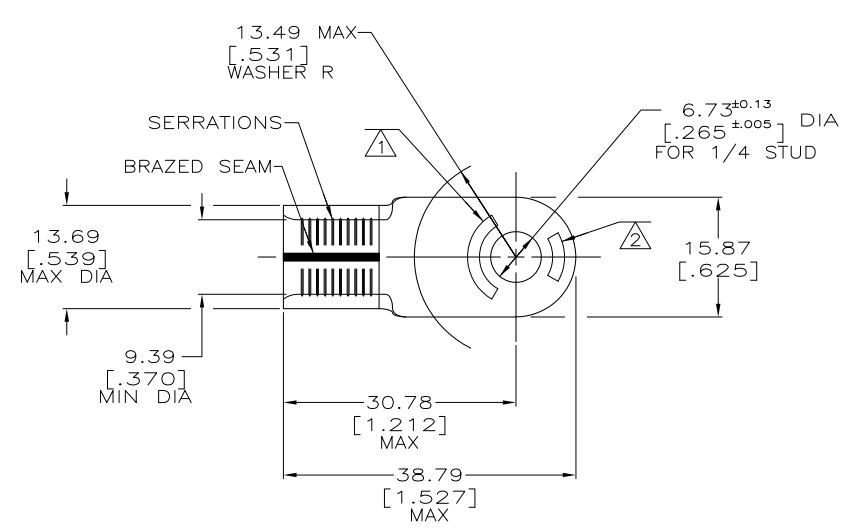

AMP WIRE RANGE	E13288 Listed
2 AWG SOLID OR STRANDED	2 AWG STRANDED
LR7189 Certified	MILITARY P/N AND CLASS
2 AWG SOLID OR STRANDED	MS 20659-113 CLASS 2 ⚠

- ⚠1 STAMP AMP 2W* APPROX AS SHOWN
- ⚠2 STAMP 60-75 APPROX AS SHOWN
- 3 MATERIAL THK: 1.78 ±0.08 [.070 ±0.003]
- ⚠4 TIN PL 0.00254 [.000100] MIN THK PER MIL-T-10727
- ⚠5 GOLD PL 0.00127 [.000050] MIN THK PER MIL-G-45204 OVER NICKEL PL 0.00076 [.000030] MIN THK PER QQ-N-290

260° C MAX	⚠	2-320383-1
170° C MAX	⚠	320383
TEMPERATURE RATING	FINISH	PART NO

AMP INCORPORATED CUSTOMER SERVICE SYSTEMS		MAX RECOMMENDED OPERATING TEMPERATURE: SEE TABLE
FOR ADDITIONAL PRODUCT INFORMATION OR COPIES OF DRAWINGS AND TECHNICAL DOCUMENTS	PRODUCT INFORMATION CENTER 1-800-522-6752	VOLTAGE RATING: NOT APPLICABLE
FOR APPLICATION TOOLING INFORMATION	TOOLING ASSISTANCE CENTER 1-800-722-1111	WIRE CROSS SECTIONAL AREA RANGE: 26.7-42.4mm ² [52,600-83,700] CIR MILS SOLID OR STRANDED
FOR ORDER ENTRY	1-800-526-5142	

THIS DRAWING IS A CONTROLLED DOCUMENT.	
DIMENSIONS: mm [INCHES]	TOLERANCES UNLESS OTHERWISE SPECIFIED:
	0 PLC ± -
	1 PLC ± -
	2 PLC ± -
	3 PLC ± 0.20 [.008]
	4 PLC ± -
	ANGLES ± -
MATERIAL COPPER PER ASTM B-152 ANNEALED	FINISH SEE TABLE

DWN DK SCHRUM 5/24/93	CHK RD HEIM 1/27/94	STE TE Connectivity	
APVD RE ROSER 1/27/94	NAME	TERMINAL, RING TONGUE, SOLISTRAND™	
PRODUCT SPEC	APPLICATION SPEC	SIZE	CAGE CODE
WEIGHT	—	A3	00779
CUSTOMER DRAWING	SCALE	DRAWING NO	RESTRICTED TO
	2:1	C=320383	—
	SHEET	1 of 1	REV
			J1