

DRAWING MADE IN THIRD ANGLE PROJECTION

THIS DRAWING IS UNPUBLISHED. RELEASED FOR PUBLICATION
 © COPYRIGHT 19 BY AMP INCORPORATED, HARRISBURG, PA. ALL INTERNATIONAL RIGHTS
 RESERVED. AMP PRODUCTS MAY BE COVERED BY U.S. AND FOREIGN PATENTS AND/OR PATENTS PENDING.

LOC		DIST		REVISIONS			
ZONE	LTR	DESCRIPTION	DATE	APPROVED			
AF	50	P	F	G	REVISED SLOT PER AF-7315	3/26/91	MSF/NN

IDENTIFICATION NUMBER 24
FOR MAGNET WIRE RANGE.



FITS .187 SERIES
FASTON RECEPTACLE

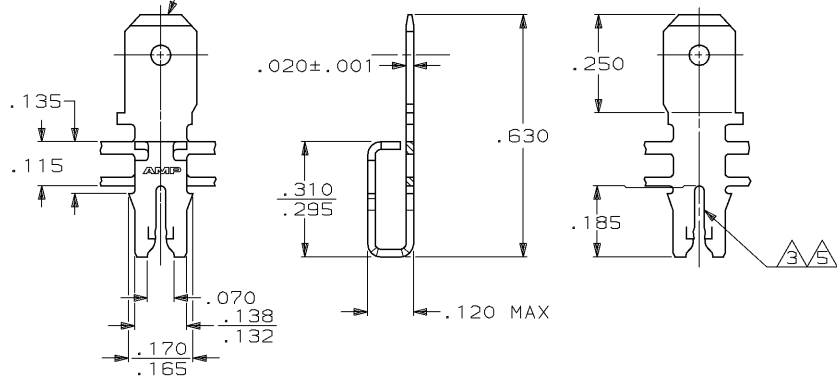

- ① MAG-MATE CAVITY SPECIFICATION.
- ② CONTINUOUS STRIP ON REELS WITH TERMINALS LOCATED ON .220 CENTERS.
- ③ SLOT ACCEPTS #19-#17 COPPER MAGNET WIRE.
- ④ AFTER INSERTION INTO PLASTIC HOLDER TAB PORTION MUST BE BENT OVER 45° TO 90° OR POTTED TO PREVENT PULL-OUT WHEN MATING RECEPTACLE IS DISCONNECTED.
- ⑤ #18-#16.5 AWG ALUMINUM MAGNET WIRE WITH CAVITY ANVIL HEIGHT OF .090 ± .005.

63273-1

PART NO

UNLESS OTHERWISE SPECIFIED DIMENSIONS ARE IN INCHES TOLERANCES ON:		DR 11/7/88 MICHAEL S. FEHER	AMP INCORPORATED Harrisburg, Pa. 17105
2 PL DEC ± .010		CHK 11/9/88 JEFF R. RUTH	
3 PL DEC ± .010		APPD 11/9/88 NELSON E. NEFF	NAME TAB, 187 FASTON, MAG-MATE™
ANGLES ± 1°		APPD 11/10/88 CHARLIE G. ATHERTON	
MATERIAL	#4M HARD BRASS	PRODUCT SPEC	SIZE B
FINISH	.000080 MIN TIN	APPLICATION SPEC 114-2046	FSCM NO 00779
		WEIGHT	DRAWING NO 63273
			SCALE 4:1
			SHEET 1 OF 1

AMP 1470-15 REV 10-84

26 MAR 1991 09:36:38 AMP02614 451284DEPT2127-DWG122-AL-MG-MATE-U.300

CUSTOMER DRAWING