

DRAWING MADE IN THIRD ANGLE PROJECTION

THIS DRAWING IS UNPUBLISHED. RELEASED FOR PUBLICATION, 19 .  
 © COPYRIGHT 19 BY AMP INCORPORATED. ALL INTERNATIONAL RIGHTS RESERVED.

LOC	DIST	REVISIONS				DATE	APPD
P	F	ZONE	LTR	DESCRIPTION			
AF	50		J	REV PER 0191-94	7/13/94	JR/MP	

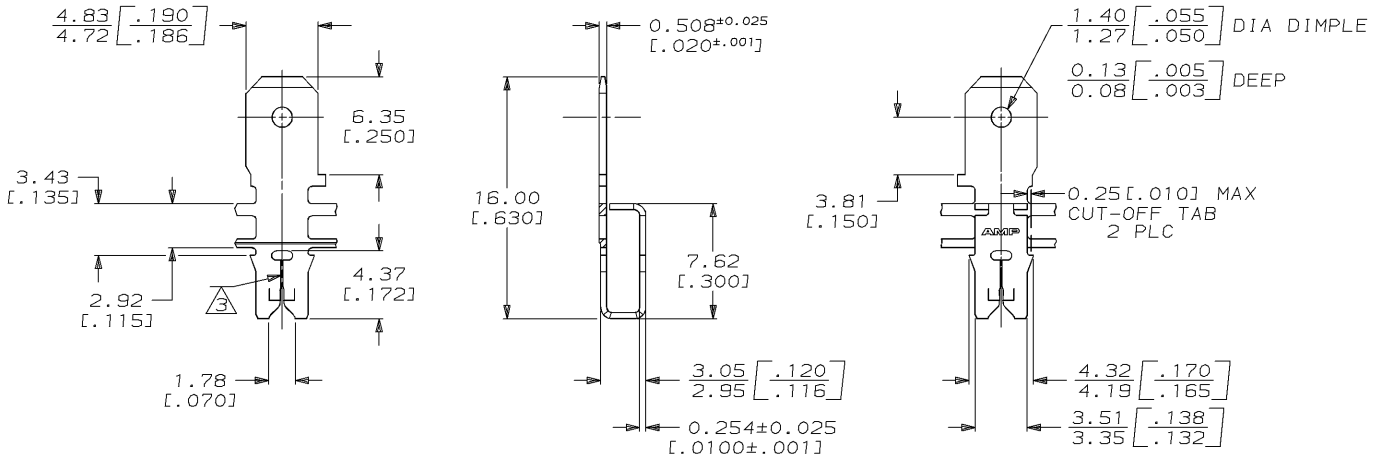

1 CONTINUOUS STRIP ON REELS WITH TERMINALS LOCATED ON 5.59 [.220] CENTERS

△ SLOT TERMINATES EITHER SINGLE OR DOUBLE MAGNET WIRE OF THE SAME SIZE, COPPER 0.18-0.23mm [#33-#31 AWG]

2 AFTER INSERTION INTO PLASTIC HOLDER TAB PORTION MUST BE BENT OVER 45° TO 90° OR POTTED-IN TO PREVENT PULL-OUT WHEN MATING RECEPTACLE IS DISCONNECTED

**METRIC**

DO NOT SCALE PRINT. UNLESS SPECIFIED DIMENSIONS IN mm (INCHES) TOLERANCES ON: 2 PLC DEC ± 0.25(.010) ANGLES ± -		DR 12/4/88 D.E. SCHLUM	62513-1 PART NO	
MATERIAL #4M HARD PRE-MILLED BRASS	FINISH 0.002032 [.000080] MIN TIN PER MIL-T-10727	CHK 12/19/89 M.S. FEHER	APPD 12/19/89 N.E. NEFF	AMP INCORPORATED Harrisburg, Pa. 17105
PRODUCT SPEC 108-2012		NAME TAB, .187 FASTON™, MAG-MATE™		
APPLICATION SPEC 114-2046		SIZE B	CAGE CODE 00779	DRAWING NO 62513
WEIGHT -		SCALE 4:1	SHEET 1 OF 1	

AMP 1470-15 REV 6-89  
13-JUL-94 10:05:10 amp13469 /files/dept2127/dwg2127/u.mag-mate/u.300

CUSTOMER DRAWING