

4

3

2

1

THIS DRAWING IS UNPUBLISHED. RELEASED FOR PUBLICATION 2011
 © COPYRIGHT 2011 ALL RIGHTS RESERVED.

LOC	DIST	REVISIONS			
P	LTR	DESCRIPTION	DATE	DWN	APVD
A		INITIAL RELEASE	18JUL2011	PKS	RRP
A1		CAVITY DWG INFO CORRECTED	29SEP2011	PKS	RRP

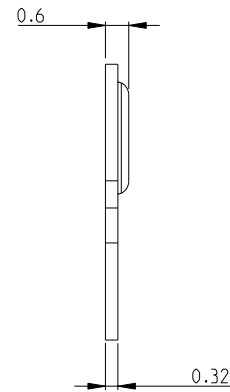
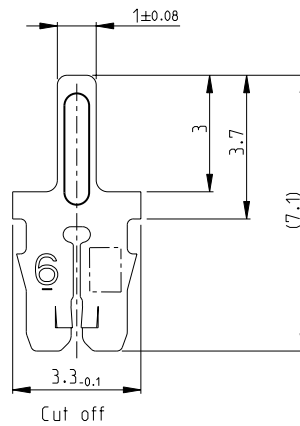
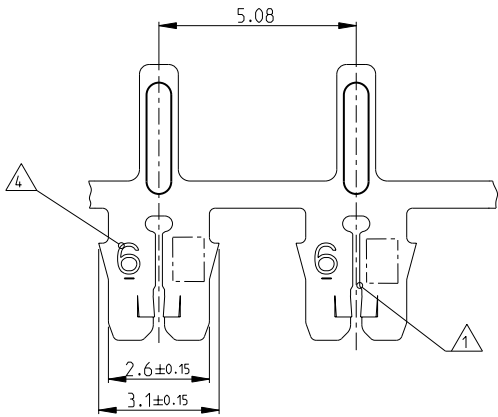

Bemerkungen:
NOTES

- 1 Geeignet fuer Kupferlackdraht Ø0.265...0.335mm
Einzeldraht oder zwei Draehle gleichen Durchmessers
SLOT ACCEPTS:
SINGLE OR DOUBLE MAGNET WIRE
SAME DIAMETERS 0.265...0.335mm DIA
- 2 Anlieferungszustand: Kontakte fortlaufend mit
Papierzwichentlage auf Kunststoffspule aufgewickelt
Max. 5 Splice Stellen pro Spule
Splice Stellen nicht miteinander verbunden
DELIVERYSTATE: CONTACTS CONTINUOUS REELED WITH PAPER
INTERLAYER ON PLASTIC-REEL.
MAX. 5 SPLICES PER REEL
SPLICES BE NOT BONDED TOGETHER.
- 3 Kontaktkammer nach Zeichnung } Spec. 411-18513
CAVITY ACCORDING DWG.
- 4 Kennziffer fuer Drahtgroessenbereich (6)
IDENTIFICATION NO. FOR MAGNET WIRE RANGE (6)
- 5 Materialdicke } 0.32±0.02
STOCK THICKNESS }

1987500-1	A	CuSn	PRETINNED	MAG-MATE .187 mod.
PART NO	REV.	MATERIAL	SURFACE COLOR	DESCRIPTION

THIS DRAWING IS A CONTROLLED DOCUMENT.

DIMENSIONS: mm	TOLERANCES UNLESS OTHERWISE SPECIFIED:	0 PLC ±0.2 1 PLC ±0.2 2 PLC ±0.2 3 PLC ±0.2 4 PLC ±0.2 ANGLES ±1°	FINISH	SEE TABLE	WEIGHT	-	SIZE	A3	CAGE CODE	00779	DRAWING NO	©=1987500	RESTRICTED TO	-
MATERIAL	SEE TABLE													

DWN: J. Kohle 28 Jul 08
 CHK: S. Zabeck 30 Jul 08
 APVD: T. Klenner 04 Aug 2008
 NAME: **STE** TE Connectivity
 PRODUCT SPEC: MAG-MATE Kontakt mit Loetpin
 APPLICATION SPEC: -
 CUSTOMER DRAWING: -
 SCALE: 10:1 SHEET 1 OF 1 REV A1