

4

3

2

1

THIS DRAWING IS UNPUBLISHED. RELEASED FOR PUBLICATION
 © COPYRIGHT - BY TYCO ELECTRONICS CORPORATION. ALL RIGHTS RESERVED.

| LDC | | DIST | | REVISIONS | | | |
|-----|-----|----------------------------|---------|-----------|------|--|--|
| P | LTR | DESCRIPTION | DATE | DWN | APVD | | |
| 0 | | TRANSFERRED TO TYCO FORMAT | 16SEP02 | MF | EH | | |

- 1 CRIMPBAND MATERIAL PROVIDED IN CONTINUOUS STRIP.
 - 2 REFERENCE DESCRIPTIVE PART NUMBER L125D18B.
- △ 3 BLANK LENGTH DETERMINED BY 125 TOOLSET.

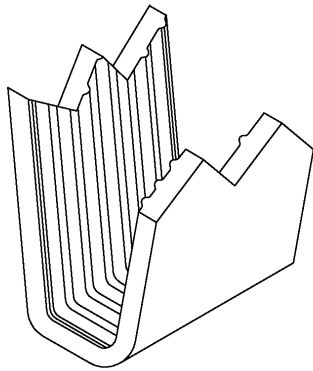
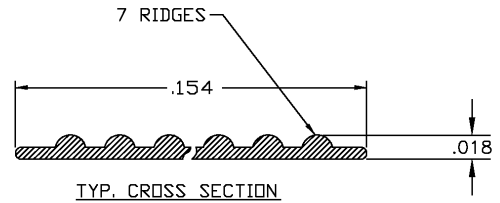
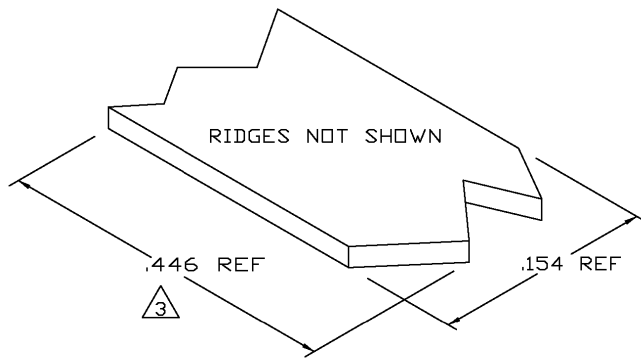

PARTIAL FORMED VIEW (REF)
 FORMED BY APPLICATION TOOLING

1601726-1
 PART NUMBER

| | | | | |
|--|--|--------------------------------------|---|--------------------|
| THIS DRAWING IS A CONTROLLED DOCUMENT. | | DWN MICHAEL S. FEHER 16SEP2002 | Tyco Electronics Corporation Harrisburg, PA 17105-3608 | |
| DIMENSIONS: INCHES | TOLERANCES UNLESS OTHERWISE SPECIFIED: | CHK EDWARD HOWARD 16SEP2002 | NAME EDWARD HOWARD | |
| | 0 PLC ± - | APVD EDWARD HOWARD | PRODUCT SPEC | |
| | 1 PLC ± - | | APPLICATION SPEC | |
| | 2 PLC ± - | | WEIGHT | |
| | 3 PLC ± .005 | | SIZE A3 | CAGE CODE 00779 |
| | 4 PLC ± - | | DRAWING NO 1601726 | RESTRICTED TO |
| | ANGLES ± - | | | |
| MATERIAL UNS C26000 BRASS | FINISH NONE | CUSTOMER DRAWING | | SCALE 1:1 |
| | | SHEET 1 OF 1 | | REV 0 |