

4 3 2 1

THIS DRAWING IS UNPUBLISHED. RELEASED FOR PUBLICATION
 © COPYRIGHT BY TYCO ELECTRONICS CORPORATION. ALL RIGHTS RESERVED.

LOC	QTY	REVISIONS		
P	LN	DESCRIPTION	DATE	BY
E		REVISED PER DS11-0088-03	6-4-03	JB KK

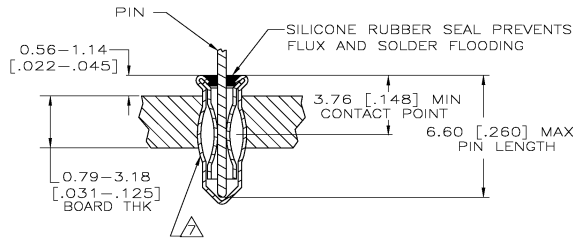
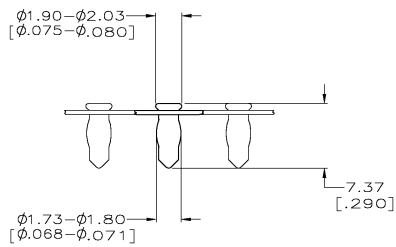
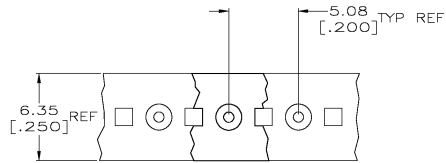

- △ MATERIAL:
 EYELET - COPPER (QQ-C-576)
 SPRING - BERYLLIUM COPPER (QQ-C-533)
 SEALANT - SILICONE RUBBER
- △ TIN PLATE (MIL-T-10727)0.00381 [.000150] MIN THK.
- △ TIN PLATE(MIL-T-10727)0.00254 [.000100] MIN THK.
- △ GOLD PL(MIL-G-45204)0.00076 [.000030] MIN THK ON CONTACT AREA.
- △ PACKAGED 50,000 PER REEL
- △ TO INSURE 1/2 OZ MIN RETENTION DO NOT EXCEED 0.10 [.004] DIFFERENCE IN PIN DIA WHEN CHANGING TO A SMALLER DIA PIN
- △ PRODUCT IS OVALIZED FOR RETENTION IN THE P.C. BOARD. THE RECOMMENDED HOLE DIAMETER IS 0.57 [0.062] MINIMUM, +0.08 [.003] MAX. PRIOR TO SOLDERING.
- △ PACKAGED 10,000 PER REEL
- △ TIN PER ASTM B 545, 0.00254 [.000100] MIN THK.

3.76-6.60 [.148-.260]	0.71-0.84 [0.028-0.033]	TIN △	TIN △	△ 6-645986-1
3.76-6.60 [.148-.260]	0.71-0.84 [0.028-0.033]	GOLD △	TIN △	△ 1-645986-2
3.76-6.60 [.148-.260]	0.71-0.84 [0.028-0.033]	TIN △	TIN △	△ 1-645986-1
3.76-6.60 [.148-.260]	0.71-0.84 [0.028-0.033]	GOLD △	TIN △	△ 645986-2
3.76-6.60 [.148-.260]	0.71-0.84 [0.028-0.033]	TIN △	TIN △	△ 645986-1
LENGTH	DIA △	EYELET	SPRING	PART NO.
PIN		FINISH		

DIMENSIONS:		TOLERANCES UNLESS OTHERWISE SPECIFIED:		APPLICABLE SPECIFICATIONS:		MATERIAL:		FINISH:	
INCHES	0.0005	0.0005	0.0005	0.0005	0.0005	0.0005	0.0005	0.0005	0.0005
SEE TABLE									

CUSTOMER DRAWING