

THIS DRAWING IS UNPUBLISHED  
 ALL RIGHTS RESERVED

| REVISES |    | DATE | BY | APP'D |
|---------|----|------|----|-------|
| AD      | 00 |      |    |       |
| B2      |    |      |    |       |

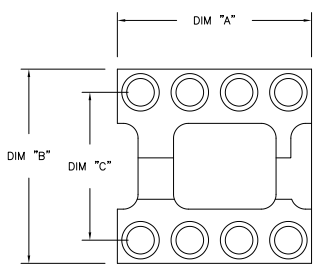

FIG. 1

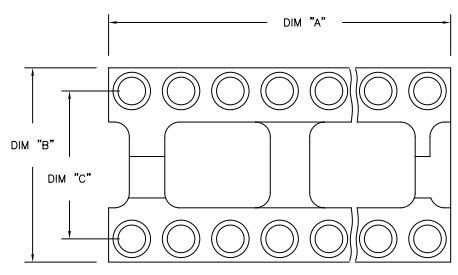

FIG. 2

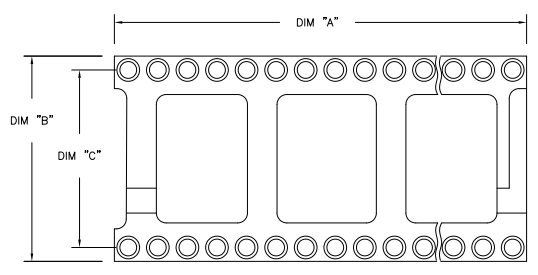
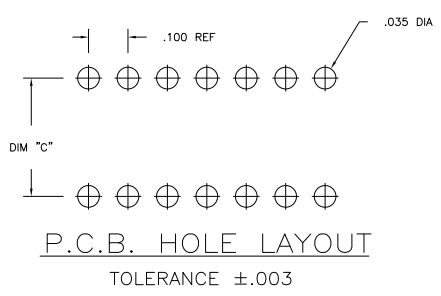
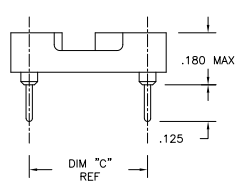
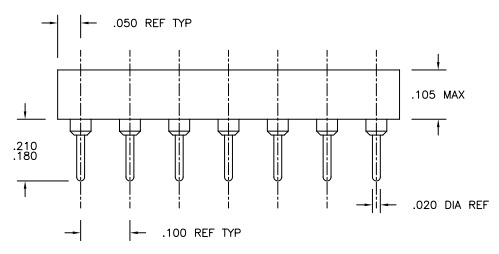

FIG. 3



- 1. INSULATOR MATERIAL - THERMOPLASTIC POLYESTER, PCT, BLACK, UL94 V-0
- ⚠ MACHINED CONTACT - BECU, PLATED WITH 80-200.1" TIN (LEAD FREE) OVER 75-100.1" COPPER.
- ⚠ SLEEVE - COPPER, PLATED WITH 180-340.1" THK TIN (LEAD FREE) OVER 75-125 MIN NICKEL.
- ⚠ MACHINED CONTACT - BECU, PLATED WITH 25.1" MIN. GOLD OVER 30-100.1" NICKEL.
- ⚠ ELECTRICAL:
  - CONTACT RESISTANCE: 10 MILLIOHMS MAX
  - CONTACT RATING: 3 AMPS
  - CAPACITANCE: 1.0 pF PER MIL-STD-202, METHOD 305
  - INSULATION RESISTANCE: 5000 OHMS MIN @ 500 VDC PER MIL-STD-1344, METHOD 3003.1
  - DIELECTRIC WITHSTANDING VOLTAGE: 1000 VOLTS (RMS) PER MIL-STD-1344, METHOD 3001.1
- ⚠ MECHANICAL:
  - INSERTION FORCE: 134 GRAMS AVG
  - WITHDRAWAL FORCE: 63 GRAMS AVG
  - \*ACCEPTS IC PIN - .009"X.015" THROUGH .011"X.020", OR .016" TO .021" DIAMETER, .150/.105 LONG\*
- ⚠ ENVIRONMENTAL:
  - OPERATING TEMPERATURE: -55°C TO -105°C
- ⚠ OBSOLETE PARTS: OBSOLETE CIS STREAMLINING PER D.RENAUD/D.SINISI

|  |  |            |      |            |      |
|--|--|------------|------|------------|------|
| THIS DRAWING IS A CONTROLLED DOCUMENT.   |  | REVISED BY | DATE | REVISED BY | DATE |
| DRAWING NO. 000779   |  | REVISED BY | DATE | REVISED BY | DATE |
| DESCRIPTION: OPEN FRAME DIP, PREMIUM (MACHINE CONTACT), LEAD FREE (REF ALUMINUM ROOF SERIES) |  | REVISED BY | DATE | REVISED BY | DATE |
| PART NO. 1571586   |  | REVISED BY | DATE | REVISED BY | DATE |
| CUSTOMER DRAWING   |  | REVISED BY | DATE | REVISED BY | DATE |

THIS DRAWING IS UNPUBLISHED  
 ALL RIGHTS RESERVED

| REV | DATE | DESCRIPTION | BY | APP |
|-----|------|-------------|----|-----|
| AD  | 00   | SEE SHEET 1 | -  | -   |

| QTY | DESCRIPTION | UNIT | WGT       | LEN   | WID   | HT | REF | REV         |
|-----|-------------|------|-----------|-------|-------|----|-----|-------------|
| △△△ | OBsolete    | TIN  | .400±.005 | .500  | 1.200 | 2  | 24  | 3-1571586-7 |
| △△△ | GOLD        | TIN  | .300±.005 | .400  | 1.200 | 2  | 24  | 3-1571586-6 |
| △△△ | GOLD        | TIN  | .900±.005 | 1.000 | 3.200 | 3  | 64  | 3-1571586-5 |
| △△△ | GOLD        | TIN  | .600±.005 | .700  | 2.400 | 3  | 48  | 3-1571586-4 |
| △△△ | GOLD        | TIN  | .600±.005 | .700  | 2.100 | 3  | 42  | 3-1571586-3 |
| △△△ | GOLD        | TIN  | .600±.005 | .700  | 2.000 | 3  | 40  | 3-1571586-2 |
| △△△ | GOLD        | TIN  | .600±.005 | .700  | 1.800 | 3  | 36  | 3-1571586-1 |
| △△△ | GOLD        | TIN  | .600±.005 | .700  | 1.600 | 3  | 32  | 3-1571586-0 |
| △△△ | GOLD        | TIN  | .600±.005 | .700  | 1.400 | 2  | 28  | 2-1571586-9 |
| △△△ | GOLD        | TIN  | .600±.005 | .700  | 1.200 | 2  | 24  | 2-1571586-8 |
| △△△ | GOLD        | TIN  | .400±.005 | .500  | 1.100 | 2  | 22  | 2-1571586-7 |
| △△△ | GOLD        | TIN  | .300±.005 | .400  | 1.000 | 2  | 20  | 2-1571586-6 |
| △△△ | GOLD        | TIN  | .300±.005 | .400  | .900  | 2  | 18  | 2-1571586-5 |
| △△△ | GOLD        | TIN  | .300±.005 | .400  | .800  | 2  | 16  | 2-1571586-4 |
| △△△ | GOLD        | TIN  | .300±.005 | .400  | .700  | 2  | 14  | 2-1571586-3 |
| △△△ | GOLD        | TIN  | .300±.005 | .400  | .400  | 1  | 8   | 2-1571586-2 |
| △△△ | TIN         | TIN  | .400±.005 | .500  | 1.200 | 2  | 24  | 1-1571586-7 |
| △△△ | TIN         | TIN  | .300±.005 | .400  | 1.200 | 2  | 24  | 1-1571586-6 |
| △△△ | OBsolete    | TIN  | .900±.005 | 1.000 | 3.200 | 3  | 64  | 1-1571586-5 |
| △△△ | OBsolete    | TIN  | .600±.005 | .700  | 2.400 | 3  | 48  | 1-1571586-4 |
| △△△ | OBsolete    | TIN  | .600±.005 | .700  | 2.100 | 3  | 42  | 1-1571586-3 |
| △△△ | OBsolete    | TIN  | .600±.005 | .700  | 2.000 | 3  | 40  | 1-1571586-2 |
| △△△ | OBsolete    | TIN  | .600±.005 | .700  | 1.800 | 3  | 36  | 1-1571586-1 |
| △△△ | OBsolete    | TIN  | .600±.005 | .700  | 1.600 | 3  | 32  | 1-1571586-0 |
| △△△ | OBsolete    | TIN  | .600±.005 | .700  | 1.400 | 2  | 28  | 1571586-9   |
| △△△ | OBsolete    | TIN  | .600±.005 | .700  | 1.200 | 2  | 24  | 1571586-8   |
| △△△ | OBsolete    | TIN  | .400±.005 | .500  | 1.100 | 2  | 22  | 1571586-7   |
| △△△ | OBsolete    | TIN  | .300±.005 | .400  | 1.000 | 2  | 20  | 1571586-6   |
| △△△ | OBsolete    | TIN  | .300±.005 | .400  | .900  | 2  | 18  | 1571586-5   |
| △△△ | OBsolete    | TIN  | .300±.005 | .400  | .800  | 2  | 16  | 1571586-4   |
| △△△ | OBsolete    | TIN  | .300±.005 | .400  | .700  | 2  | 14  | 1571586-3   |
| △△△ | OBsolete    | TIN  | .300±.005 | .400  | .400  | 1  | 8   | 1571586-2   |

| FINISH CONTACT/SLEEVE | "C" MAX | "B" MAX | "A" MAX | FIG | NO. OF POSN | PART NO. |
|-----------------------|---------|---------|---------|-----|-------------|----------|
|                       |         |         |         |     |             |          |

THIS DRAWING IS A CONTROLLED DOCUMENT. **TE Connectivity**

DATE: 007790 **Q=1571586**

CUSTOMER DRAWING

SIZE: 1:1 SHEET 2 OF 2