

REVISED PER		DESCRIPTION	DATE	BY	APP'D
E4	REVISED PER EDD-11-004587		11MAR11	RK	HMR

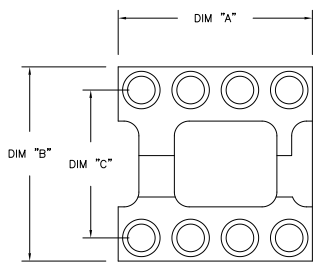

FIG. 1

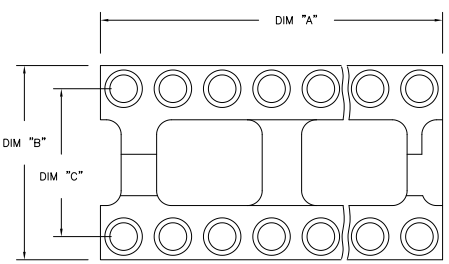

FIG. 2

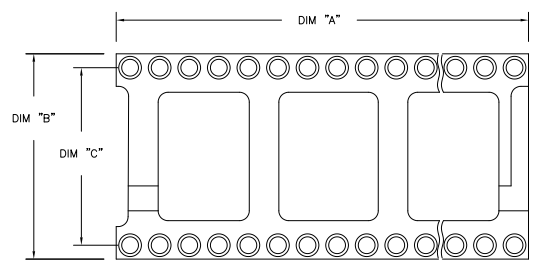
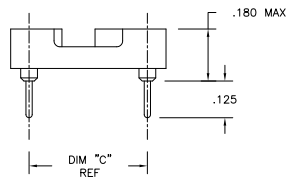
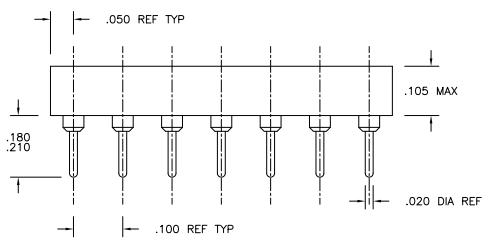
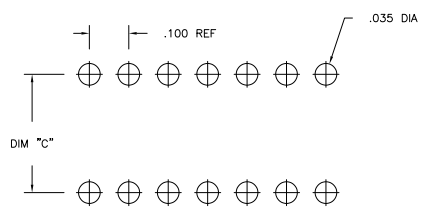

FIG. 3



- 1. INSULATOR MATERIAL - THERMOPLASTIC POLYESTER, PCT, BLACK, UL94 V-0
- △ STAMPED CONTACT - BECU, PLATED WITH 80-200.1" TIN (LEAD FREE) OVER 75-100.1" COPPER.
- △ SLEEVE - COPPER, PLATED WITH 180-340.1" THK TIN (LEAD FREE) OVER 75-125μ" MIN NICKEL.
- △ STAMPED CONTACT-BECU, PLATED WITH GOLD FLASH OVER 50-100.1" NICKEL
- △ STAMPED CONTACT-BECU, PLATED WITH 20μ" MIN GOLD OVER 30-100.1" NICKEL.
- △ ELECTRICAL:
 - CONTACT RESISTANCE: 10 MILLIOHMS MAX
 - CONTACT RATING: 3 AMPS
 - CAPACITANCE: 1.0 pF PER MIL-STD-202, METHOD 305
 - INSULATION RESISTANCE: 5000 OHMS MIN @ 500 VDC PER MIL-STD-1344, METHOD 3003.1
 - DIELECTRIC WITHSTANDING VOLTAGE: 1000 VOLTS (RMS) PER MIL-STD-1344, METHOD 3001.1
- △ MECHANICAL:
 - INSERTION FORCE: 179 GRAMS AVG
 - WITHDRAWAL FORCE: 63 GRAMS AVG
 - *ACCEPTS IC PIN - .009"X.015" THROUGH .011"X.020", OR .016" TO .021" DIAMETER, .150/.105 LONG"
- △ ENVIRONMENTAL:
 - OPERATING TEMPERATURE: -55°C TO +105°C
- △ OBSOLETE PARTS: OBSOLETE CIS STREAMLINING PER D.RENAUD/D.SINISI



P.C.B. HOLE LAYOUT
 TOLERANCE ±.003

THIS DRAWING IS A CONTROLLED DOCUMENT.		REV	DATE	BY	APP'D
REVISIONS		00			
WORKS		AD			
DRAWING LABELS:		REV	DATE	BY	APP'D
A. REV		01			
B. REV		02			
C. REV		03			
D. REV		04			
E. REV		05			
F. REV		06			
G. REV		07			
H. REV		08			
I. REV		09			
J. REV		10			
K. REV		11			
L. REV		12			
M. REV		13			
N. REV		14			
O. REV		15			
P. REV		16			
Q. REV		17			
R. REV		18			
S. REV		19			
T. REV		20			
U. REV		21			
V. REV		22			
W. REV		23			
X. REV		24			
Y. REV		25			
Z. REV		26			
AA. REV		27			
AB. REV		28			
AC. REV		29			
AD. REV		30			
AE. REV		31			
AF. REV		32			
AG. REV		33			
AH. REV		34			
AI. REV		35			
AJ. REV		36			
AK. REV		37			
AL. REV		38			
AM. REV		39			
AN. REV		40			
AO. REV		41			
AP. REV		42			
AQ. REV		43			
AR. REV		44			
AS. REV		45			
AT. REV		46			
AU. REV		47			
AV. REV		48			
AW. REV		49			
AX. REV		50			
AY. REV		51			
AZ. REV		52			
BA. REV		53			
BB. REV		54			
BC. REV		55			
BD. REV		56			
BE. REV		57			
BF. REV		58			
BG. REV		59			
BH. REV		60			
BI. REV		61			
BJ. REV		62			
BK. REV		63			
BL. REV		64			
BM. REV		65			
BN. REV		66			
BO. REV		67			
BP. REV		68			
BQ. REV		69			
BR. REV		70			
BS. REV		71			
BT. REV		72			
BU. REV		73			
BV. REV		74			
BW. REV		75			
BX. REV		76			
BY. REV		77			
BZ. REV		78			
CA. REV		79			
CB. REV		80			
CC. REV		81			
CD. REV		82			
CE. REV		83			
CF. REV		84			
CG. REV		85			
CH. REV		86			
CI. REV		87			
CJ. REV		88			
CK. REV		89			
CL. REV		90			
CM. REV		91			
CN. REV		92			
CO. REV		93			
CP. REV		94			
CQ. REV		95			
CR. REV		96			
CS. REV		97			
CT. REV		98			
CU. REV		99			
CV. REV		100			
CW. REV		101			
CX. REV		102			
CY. REV		103			
CZ. REV		104			
DA. REV		105			
DB. REV		106			
DC. REV		107			
DD. REV		108			
DE. REV		109			
DF. REV		110			
DG. REV		111			
DH. REV		112			
DI. REV		113			
DJ. REV		114			
DK. REV		115			
DL. REV		116			
DM. REV		117			
DN. REV		118			
DO. REV		119			
DP. REV		120			
DQ. REV		121			
DR. REV		122			
DS. REV		123			
DT. REV		124			
DU. REV		125			
DV. REV		126			
DW. REV		127			
DX. REV		128			
DY. REV		129			
DZ. REV		130			
EA. REV		131			
EB. REV		132			
EC. REV		133			
ED. REV		134			
EE. REV		135			
EF. REV		136			
EG. REV		137			
EH. REV		138			
EI. REV		139			
EJ. REV		140			
EK. REV		141			
EL. REV		142			
EM. REV		143			
EN. REV		144			
EO. REV		145			
EP. REV		146			
EQ. REV		147			
ER. REV		148			
ES. REV		149			
ET. REV		150			
EU. REV		151			
EV. REV		152			
EW. REV		153			
EX. REV		154			
EY. REV		155			
EZ. REV		156			
FA. REV		157			
FB. REV		158			
FC. REV		159			
FD. REV		160			
FE. REV		161			
FF. REV		162			
FG. REV		163			
FH. REV		164			
FI. REV		165			
FJ. REV		166			
FK. REV		167			
FL. REV		168			
FM. REV		169			
FN. REV		170			
FO. REV		171			
FP. REV		172			
FQ. REV		173			
FR. REV		174			
FS. REV		175			
FT. REV		176			
FU. REV		177			
FV. REV		178			
FW. REV		179			
FX. REV		180			
FY. REV		181			
FZ. REV		182			
GA. REV		183			
GB. REV		184			
GC. REV		185			
GD. REV		186			
GE. REV		187			
GF. REV		188			
GG. REV		189			
GH. REV		190			
GI. REV		191			
GJ. REV		192			
GK. REV		193			
GL. REV		194			
GM. REV		195			
GN. REV		196			
GO. REV		197			
GP. REV		198			
GQ. REV		199			
GR. REV		200			
GS. REV		201			
GT. REV		202			
GU. REV		203			
GV. REV		204			
GW. REV		205			
GX. REV		206			
GY. REV		207			
GZ. REV		208			
HA. REV		209			
HB. REV		210			
HC. REV		211			
HD. REV		212			
HE. REV		213			
HF. REV		214			
HG. REV		215			
HH. REV		216			
HI. REV		217			
HJ. REV		218			
HK. REV		219			
HL. REV		220			
HM. REV		221			
HN. REV		222			
HO. REV		223			
HP. REV		224			
HQ. REV		225			
HR. REV		226			
HS. REV		227			
HT. REV		228			
HU. REV		229			
HV. REV		230			
HW. REV		231			
HX. REV		232			
HY. REV		233			
HZ. REV		234			
IA. REV		235			
IB. REV		236			
IC. REV		237			
ID. REV		238			
IE. REV		239			
IF. REV		240			
IG. REV		241			
IH. REV		242			
II. REV		243			
IJ. REV		244			
IK. REV		245			
IL. REV		246			
IM. REV		247			
IN. REV		248			
IO. REV		249			
IP. REV		250			
IQ. REV		251			
IR. REV					

THIS DRAWING IS UNAPPROVED FOR FABRICATION ALL RIGHTS RESERVED

REV	DATE	DESCRIPTION	BY	CHK	APP
AD	00	SEE SHEET 1	-	-	-

REV	DATE	DESCRIPTION	BY	CHK	APP					
△△△	△	OBsolete	GOLD	TIN	.400±.005	.500	1.200	2	24	5-1571552-7
△△△	△		GOLD	TIN	.300±.005	.400	1.200	2	24	5-1571552-6
△△△	△		GOLD	TIN	.900±.005	1.000	3.200	3	64	5-1571552-5
△△△	△		GOLD	TIN	.600±.005	.700	2.400	3	48	5-1571552-4
△△△	△		GOLD	TIN	.600±.005	.700	2.100	3	42	5-1571552-3
△△△	△		GOLD	TIN	.600±.005	.700	2.000	3	40	5-1571552-2
△△△	△		GOLD	TIN	.600±.005	.700	1.800	3	36	5-1571552-1
△△△	△		GOLD	TIN	.600±.005	.700	1.600	3	32	5-1571552-0
△△△	△		GOLD	TIN	.600±.005	.700	1.400	2	28	4-1571552-9
△△△	△		GOLD	TIN	.600±.005	.700	1.200	2	24	4-1571552-8
△△△	△		GOLD	TIN	.400±.005	.500	1.100	2	22	4-1571552-7
△△△	△		GOLD	TIN	.300±.005	.400	1.000	2	20	4-1571552-6
△△△	△		GOLD	TIN	.300±.005	.400	.900	2	18	4-1571552-5
△△△	△		GOLD	TIN	.300±.005	.400	.800	2	16	4-1571552-4
△△△	△		GOLD	TIN	.300±.005	.400	.700	2	14	4-1571552-3
△△△	△		GOLD	TIN	.300±.005	.400	.600	2	12	4-1571552-2
△△△	△		GOLD	TIN	.300±.005	.400	.500	2	10	4-1571552-1
△△△	△	OBsolete	G F	TIN	.400±.005	.500	1.200	2	24	3-1571552-7
△△△	△		G F	TIN	.300±.005	.400	1.200	2	24	3-1571552-6
△△△	△		G F	TIN	.900±.005	1.000	3.200	3	64	3-1571552-5
△△△	△		G F	TIN	.600±.005	.700	2.400	3	48	3-1571552-4
△△△	△		G F	TIN	.600±.005	.700	2.100	3	42	3-1571552-3
△△△	△		G F	TIN	.600±.005	.700	2.000	3	40	3-1571552-2
△△△	△		G F	TIN	.600±.005	.700	1.800	3	36	3-1571552-1
△△△	△		G F	TIN	.600±.005	.700	1.600	3	32	3-1571552-0
△△△	△		G F	TIN	.600±.005	.700	1.400	2	28	2-1571552-9
△△△	△		G F	TIN	.600±.005	.700	1.200	2	24	2-1571552-8
△△△	△		G F	TIN	.400±.005	.500	1.100	2	22	2-1571552-7
△△△	△		G F	TIN	.300±.005	.400	1.000	2	20	2-1571552-6
△△△	△		G F	TIN	.300±.005	.400	.900	2	18	2-1571552-5
△△△	△		G F	TIN	.300±.005	.400	.800	2	16	2-1571552-4
△△△	△		G F	TIN	.300±.005	.400	.700	2	14	2-1571552-3
△△△	△		G F	TIN	.300±.005	.400	.600	2	12	2-1571552-2
△△△	△		G F	TIN	.300±.005	.400	.500	2	10	2-1571552-1
△△△	△		TIN	TIN	.300±.005	.400	1.200	2	24	1-1571552-6
△△△	△	OBsolete	TIN	TIN	.900±.005	1.000	3.200	3	64	1-1571552-5
△△△	△	OBsolete	TIN	TIN	.600±.005	.700	2.400	3	48	1-1571552-4
△△△	△	OBsolete	TIN	TIN	.600±.005	.700	2.100	3	42	1-1571552-3
△△△	△	OBsolete	TIN	TIN	.600±.005	.700	2.000	3	40	1-1571552-2
△△△	△	OBsolete	TIN	TIN	.600±.005	.700	1.800	3	36	1-1571552-1
△△△	△		TIN	TIN	.600±.005	.700	1.600	3	32	1-1571552-0
△△△	△		TIN	TIN	.600±.005	.700	1.400	2	28	1571552-9
△△△	△		TIN	TIN	.600±.005	.700	1.200	2	24	1571552-8
△△△	△	OBsolete	TIN	TIN	.400±.005	.500	1.100	2	22	1571552-7
△△△	△		TIN	TIN	.300±.005	.400	1.000	2	20	1571552-6
△△△	△		TIN	TIN	.300±.005	.400	.900	2	18	1571552-5
△△△	△		TIN	TIN	.300±.005	.400	.800	2	16	1571552-4
△△△	△		TIN	TIN	.300±.005	.400	.700	2	14	1571552-3
△△△	△		TIN	TIN	.300±.005	.400	.600	2	12	1571552-2
△△△	△		TIN	TIN	.300±.005	.400	.500	2	10	1571552-1

FINISH CONTACT/SLEEVE	"C" MAX	"B" MAX	"A" MAX	FIG	NO. OF POSN	PART NO.

THIS DRAWING IS A CONTROLLED DOCUMENT. DATE: 01/01/00

TE Connectivity
 OPEN FRAME DIP ECONOMY (STAMPED CONTACT) (REF AUGAT 800 SERIES)

REV: 001 DATE: 01/01/00 DRAWN BY: A1 007791G-1571552

CUSTOMER DRAWING