

4

3

2

1

THIS DRAWING IS UNPUBLISHED. RELEASED FOR PUBLICATION. BY TYCO ELECTRONICS CORPORATION. ALL INTERNATIONAL RIGHTS RESERVED.

LOC	DIST	REVISIONS		
F	LR	DESCRIPTION	DATE	BY
AF	50			
	E2	REVISED PER ECR-10-013120	24JUN10	HMR GJ

- SPECIFICATIONS:  
MAGNET WIRE #18 - #34 AWG.  
1.02 [0.40]-0.16 [0.06] DIA COPPER.  
OTHER SIZES MAY BE ACCOMMODATED.  
CONSULT TYCO ELECTRONICS FOR APPROVAL.
- POCKET RECOMMENDATION: #1601424
- TERMINAL APPLICATION TO COMPLY WITH TYCO ELECTRONICS SPECIFICATION 114-13166 FIGURE 5.
- TWO(2) TERMINALS SHOWN FOR ILLUSTRATION PURPOSES ONLY.

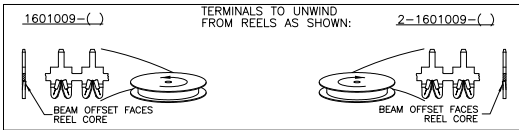
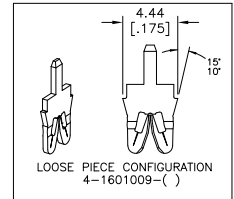
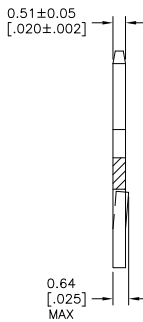
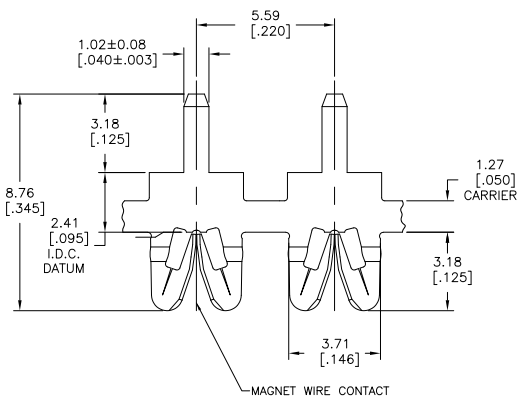

OBSELETE  
SUPERSEDED BY 4-1601009-4  
SUPERSEDED BY 1601009-4

POST TIN PLATE OVER NICKEL	-	4-1601009-4
POST TIN PLATE OVER NICKEL	-	1601009-4
<del>SELECTIVE POST TIN-LEAD PLATE OVER NICKEL</del>	<del>031-020-124</del>	<del>4-1601009-3</del>
POST TIN-LEAD PLATE OVER NICKEL	031-020-024	4-1601009-2
POST TIN-LEAD PLATE OVER NICKEL	131-020-024	1601009-2
UNPLATED	131-020-000	1601009-1
FINISH	REFERENCE PART NUMBER	TE PART NUMBER

THIS DRAWING IS A CONTROLLED DOCUMENT.		DN J. WELLS 11JAN2002	Tyco Electronics Corporation Harrisburg, PA 17105-3608
DIMENSIONS: mm [INCHES]		CHK M. FEHR 11JAN2002	
TOLERANCES UNLESS OTHERWISE SPECIFIED:		APPC K. RANDOLPH 11JAN2002	STANDARD RANGE WIRE TO 1.01 X 0.51 P.C.B. SIAMEZE TERMINAL
0 PLC ± .01		PRODUCT SPEC 108-2085	
1 PLC ± .015		APPLICATION SPEC	SIZE CASE CODE DRAWING NO
2 PLC ± .015 (0.05)		ANGLE	A2 00779 C=1601009
3 PLC ± .015		RESTRICTED TO	
4 PLC ± .015			
MATERIAL BRASS, SPRING HARD		FINISH	
SEE TABLE		WEIGHT	
		CUSTOMER DRAWING	SCALE 9:1 SHEET 1 of 1 REV E2