

4

3

2

1

THIS DRAWING IS UNPUBLISHED. RELEASED FOR PUBLICATION
 © COPYRIGHT BY TYCO ELECTRONICS CORPORATION. ALL RIGHTS RESERVED.

LOC		DIBT		REVISIONS		
F	LTR	DESCRIPTION	DATE	BY	APP'D	
AF	50					
	C	REVISED PER ECR-06-010423	13SEP06	HMR	KR	

1 CONTINUOUS STRIP ON REELS WITH TERMINALS LOCATED ON 6.86±0.08 [.270±.003] CENTERS

- △1 SLOT ACCEPTS 0.57-0.81mm [#23-#20] AWG COPPER MAGNET WIRE. TWO WIRES OF THE SAME SIZE MAX PER SLOT FOR #23 GAGE. ONE WIRE MAX PER SLOT FOR #22-#20 AWG
- △3 IDENTIFICATION NUMBER 15 FOR THE MAGNET WIRE SLOT SIZE
- △4 0.25[.010] MAX CARRIER CUT-OFF TABS

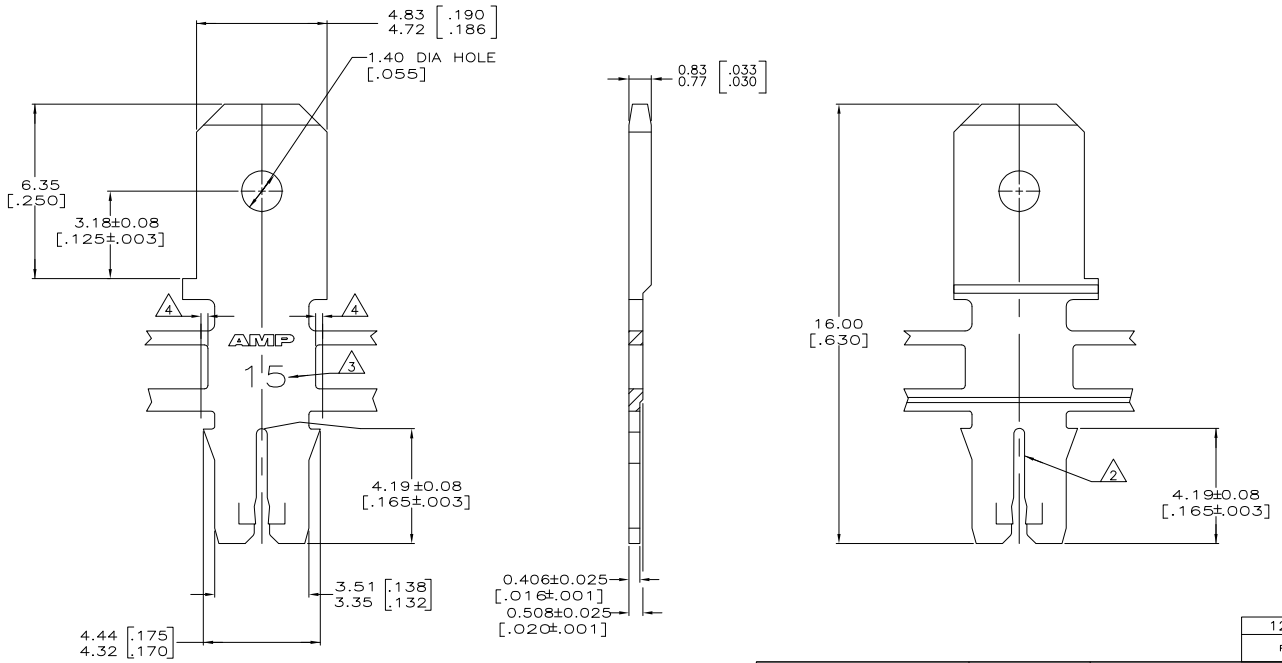

1217516-1
PART NUMBER

THIS DRAWING IS A CONTROLLED DOCUMENT.		DRW: MICHAEL S. FEYER 200012000	Tyco Electronics Corporation	
DIMENSIONS: mm [INCHES]		CHK: KURT A. RANDOLPH 200012000	Harrisburg, PA 17105-3608	
TOLERANCES UNLESS OTHERWISE SPECIFIED:		APP'D: KURT A. RANDOLPH 200012000	NAME: TAB, 4.75[.187] FASTON™ MAG-MATE™ Slim Line	
0 PLC ± .01		PRODUCT SPEC: 108-1484	APPLICATION SPEC: 114-2140	
1 PLC ± 0.1%(.005)		SIZE: A2	CAGE CODE: 00779	DRAWING NO: C=1217516
2 PLC ± .001		WEIGHT: -	RESTRICTED TO: -	
3 PLC ± .0005		MATERIAL: OR2 PRE-MILLED BRASS		
4 PLC ± .0002		FINISH: 0.002032[.00080] MIN TIN PLATE		
ANGLES ± .001		CUSTOMER DRAWING		
		SCALE: 10:1 SHEET: 1 of 1 REV: C		

AMP 1471-9 REV 31MM2000

1217516

A