

4

3

2

1

THIS DRAWING IS UNPUBLISHED. RELEASED FOR PUBLICATION  
 © COPYRIGHT BY TYCO ELECTRONICS CORPORATION. ALL RIGHTS RESERVED.

LOC		DIST		REVISIONS			
F	LR	DESCRIPTION	DATE	BY	APP'D		
AF	50	D	REVISED PER ECR-06-010412	31OCT06	HMR	KR	

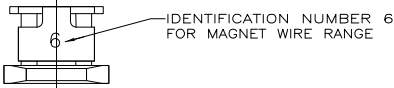

- △ SLOT TERMINATES EITHER A SINGLE OR DOUBLE MAGNET WIRE OF THE SAME SIZE AND TYPE. COPPER RANGE: 0.25-0.36mm [#30-#27] AWG.
- 2 AFTER INSERTION INTO PLASTIC HOLDER TAB PORTION MUST BE BENT OVER 45° TO 90° OR POTTED-IN TO PREVENT PULL-OUT WHEN MATING RECEPTACLE IS DISCONNECTED.

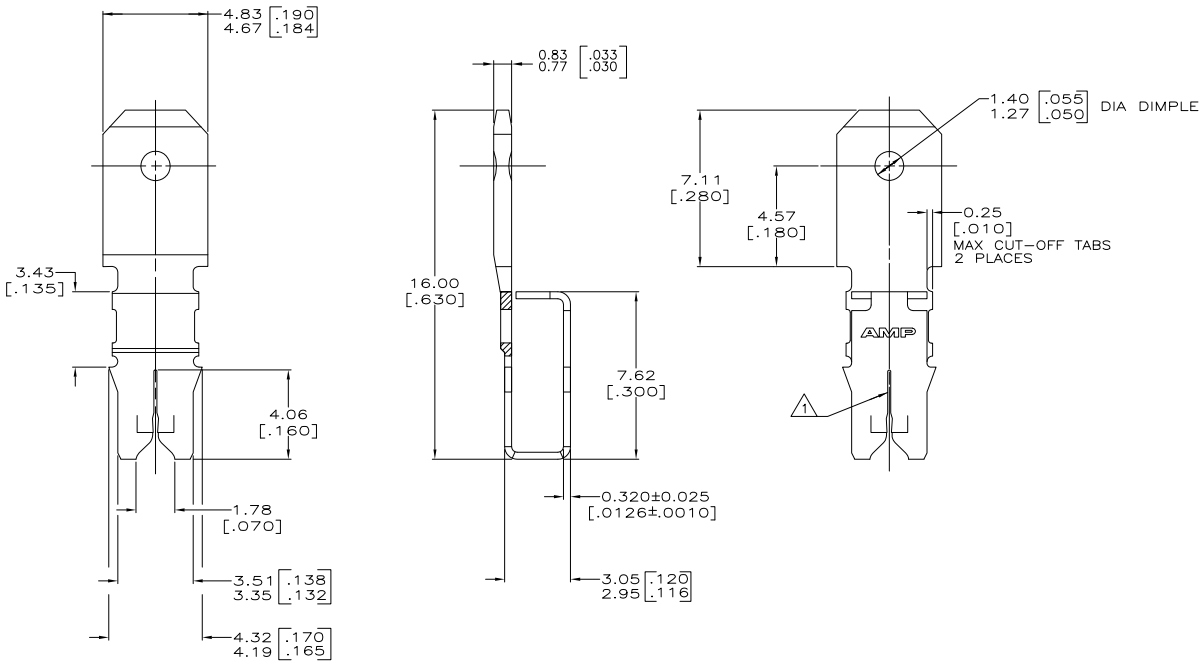

1217178-1  
PART NUMBER

THIS DRAWING IS A CONTROLLED DOCUMENT.		DRW: MICHAEL S. FEYER 06JUN1999	Tyco Electronics Corporation Harrisburg, PA 17105-3608	1217178-1	
		CHK: KURT A. RANDOLPH 06JUN1999		PART NUMBER	
DIMENSIONS: mm [INCHES]		APPC: KURT A. RANDOLPH 06JUN1999	TERMINAL, TAB, 4.75[.187]		
TOLERANCES UNLESS OTHERWISE SPECIFIED:		PRODUCT SPEC: 108-2012	FASTON, LOOSE PIECE, 300 SERIES MAG-MATE		
0 PLC ± -		APPLICATION SPEC: 114-2046	SIZE: A2	CAGE CODE: 00779	DRAWING NO: C=1217178
1 PLC ± .010		WEIGHT: -	RESTRICTED TO: -		
2 PLC ± 0.25 (.010)		MATERIAL: H02 PRE-MILLED BRASS		CUSTOMER DRAWING	
3 PLC ± -		FINISH: 0.002032[.00080] MIN TIN PLATE		SCALE: 8:1 SHEET: 1 of 1 REV: D	
4 PLC ± -		ANGLES: -			

AMP 1471-9 REV 31MMR2000

1217178

A