

4

3

2

1

THIS DRAWING IS UNPUBLISHED. RELEASED FOR PUBLICATION  
 (C) COPYRIGHT IS BY AMP INCORPORATED. ALL RIGHTS RESERVED.

REV	DATE	BY	APP'D	DESCRIPTION
D	24JUL00	HF	KR	REVISED PER 053A-0451-00

- 1 CONTINUOUS STRIP ON REELS WITH TERMINALS LOCATED ON 5.59±0.08 [.220±.003] CENTERS.
- 2 SLOT TERMINATES EITHER A SINGLE OR DOUBLE MAGNET WIRE OF THE SAME SIZE AND TYPE. COPPER WIRE RANGE: 0.23-0.32mm [#31-28] AWG.
- 3 MATES WITH STANDARD MAG-MATE STYLED POKE-IN TAB TERMINAL.
- 4 WHEN FREE STATE IS COMPRESSED TO 3.23 [.127] DIMENSION, GAP BETWEEN SPRING AND CARRIER IS TO 0.30 [.012] MAX.

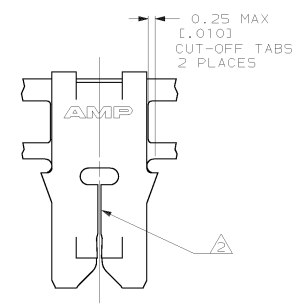
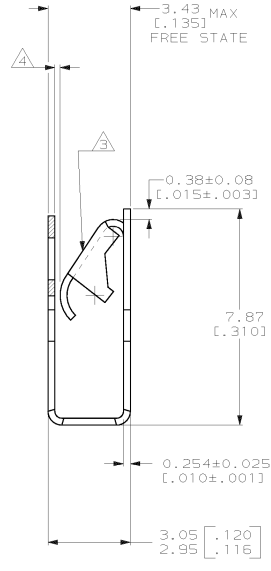
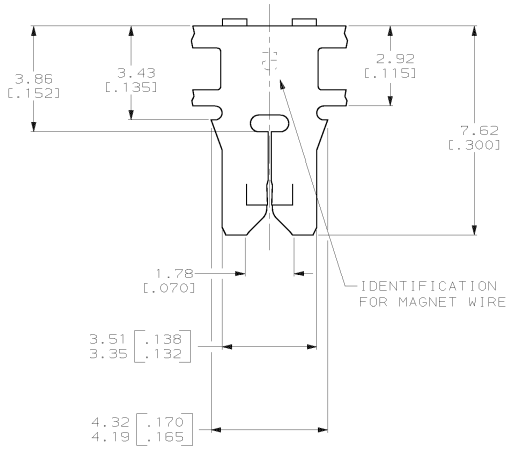
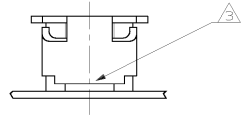

1217026-1  
PART NUMBER

THIS DRAWING IS A CONTROLLED DOCUMENT.		DATE: 200793	AMP Incorporated Harrisburg, PA 17105-3608	
DRAWN BY: MICHAEL S. FEHNER		DATE: 200793		
CHECKED BY: GARY B. RUTH		DATE: 200793		
DIMENSIONS: mm (INCHES)		DESIGNED BY: GARY BORTA	PROJECT SPEC: 108-2012	
TOLERANCES UNLESS SPECIFIED:		APPLICATION SPEC: 114-2046	SHEET: 1 OF 1	
MATERIAL: 4M BRASS		FINISH: 0.002032 [.000080] MIN TIN PLATE	CUSTOMER DRAWING	
		SCALE: 10:1	SHEET: 1 OF 1	