

4

3

2

1

THIS DRAWING IS UNPUBLISHED. RELEASED FOR PUBLICATION
 © COPYRIGHT BY TYCO ELECTRONICS CORPORATION. ALL RIGHTS RESERVED.

LOC	DIST	REVISIONS			
P	LTR	DESCRIPTION	DATE	MIN	APD
AF	50				
B		REVISED PER 0G3A-0067-05	7FEB05	MF	KR

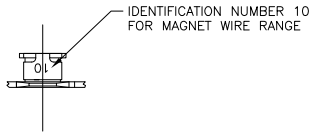

- 1 CONTINUOUS STRIP ON REELS WITH TERMINALS LOCATED ON 5.59±0.08 [.220±.003] CENTERS.
 - 2 AFTER INSERTION INTO PLASTIC HOLDER TAB PORTION MUST BE BENT 45° TO 90° OR POTTED-IN TO PREVENT PULL-OUT WHEN MATING RECEPTACLE IS DISCONNECTED.
- △ 3 SLOT TERMINATES EITHER SINGLE OR DOUBLE MAGNET WIRE OF THE SAME SIZE AND TYPE.
 COPPER RANGE: 0.36-0.57mm [#27-#23] AWG.
- △ 4 0.002032 [.000080] MIN TIN PLATE.

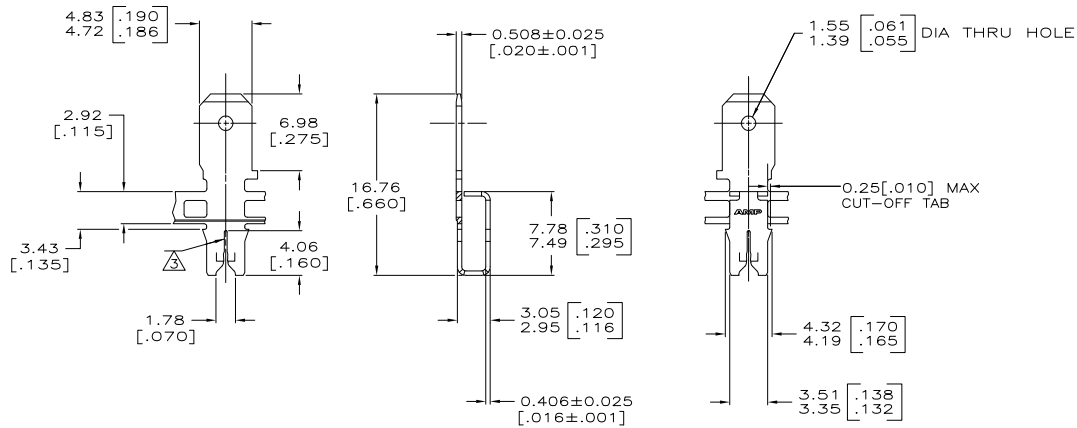

△ 4	63585-1
FINISH	PART NUMBER
Tyco Electronics Corporation Harrisburg, Pa 17105-3608	
TAB, 4.75 [.187] FASTON, 300 SERIES MAG-MATE	
SIZE	CHG CODE DRAWING NO
A2	00779C-63585
RESTRICTED TO	
SCALE	SHEET
4:1	1 OF 1
REV	B

THIS DRAWING IS A CONTROLLED DOCUMENT.		DWG: MICHAEL S. FEHLER 7FEB02005 OK: KURT A. RANDOLPH 7FEB02005 APPD: KURT A. RANDOLPH 7FEB02005 PRODUCT SPEC: 108-2012 APPLICATION SPEC: 114-2046 HEIGHT: - FINISH: - CUSTOMER DRAWING
DIMENSIONS:	RELEASED FOR PUBLICATION	
INCHES	BY TYCO ELECTRONICS CORPORATION	
0 PLC ± - 1 PLC ± - 2 PLC ± - 3 PLC ± 0.25[.010] 4 PLC ± - ANGLES ± -	SEE TABLE	
MATERIAL	4M HARD PRE-MILLED BRASS	

63585