

SCALA NON IMPEGNATIVA
(DO NOT SCALE)
DIMENSIONI IN mm
(DIMENSIONS IN IN)

METRIC

PROIEZIONE EUROPEA
(EUROPEAN PROJECTION)

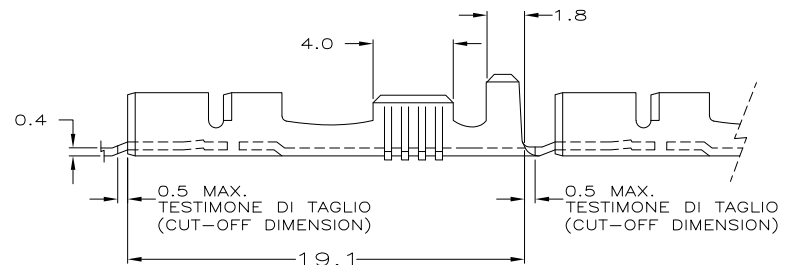
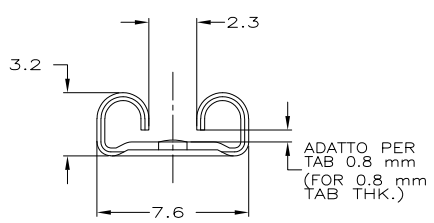
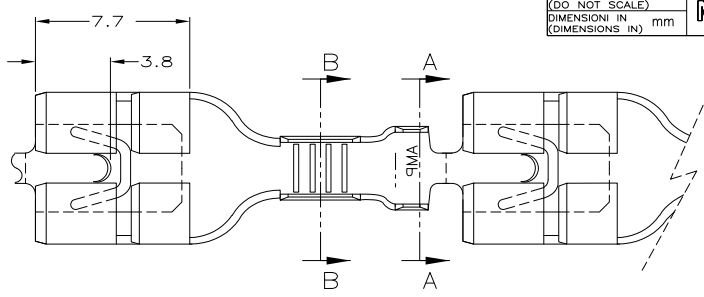

SEZIONE A-A
SECTION A-A

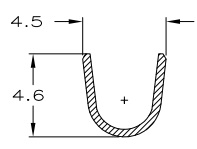

SEZIONE B-B
SECTION C-C

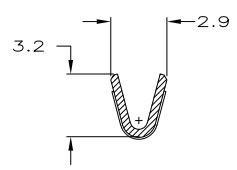

OBSOLETE	NUDO (UNPLATED)	Cu Ni Zn	0-100495-6	C
	STAGNATO (TIN PLATED)	BRONZO FOS. (PHOS. BRONZE)	0-100495-4	C
	STAGNATO (TIN PLATED)	OTTONE (BRASS)	0-100495-2	C
	NUDO (UNPLATED)	OTTONE (BRASS)	0-100495-1	C
	FINITURA / COLORE (FINISH / COLOUR)	MATERIALE (MATERIAL)	NUMERO (PART NO)	REV

CUSTOMER DWG. FOR REFERENCE ONLY
DISEGNO PER CLIENTE SOLO PER RIFERIMENTO

THIS DRAWING IS UNPUBLISHED. RELEASE FOR PUBLICATION 19
© COPYRIGHT BY ALL INTERNATIONAL RIGHT RESERVED.

TOLLERANZE: SE NON DIVERSAMENTE SPECIFICATO (TOLERANCES: UNLESS OTHERWISE SPECIFIED)	DIAM. ISOLANTE (INS. DIA. RANGE) 2.3-3.3	RANGO FILO (WIRE RANGE) 0.5-1.5	SCALA (SCALE) 5:1
ANGOLI (ANGLES) ± 0.3	TE Connectivity FASTON® Connector, .250" sr. L.I.F. FASTON CONTACT.		
DIS. H. YAALI (DR.) 10 MAR 2000			
CONT. C. TARTARI (CHK) 10 MAR 2000	LOC. SIZE	NUMERO (DWG NO) C-100495	REV. FOGLIO (SHEET) D3 1 (of 1)

1) STATO DI FORNITURA SCALA 1:1 (SUPPLY CONDITION SCALE 1:1)
 SENSO DI USCITA DEL TERMINALE DALLA BOBINA (DIRECTION OFF TOP OF REEL)

2) SPECIFICA DI PRODOTTO 108-19084 (PRODUCT SPEC. 108-19084)

OBSOLETE PARTS: OBSOLETE CIS STREAMLINING PER D.RENAUD/D.SINISI

D3	REVISED PER ECO-11-005140	RK	DISAPP.
REV.	REVISIONI (REVISION RECORD)	DIS.	DATA (APP.)

DISTRIBUZIONE (PRINT DIST.)